

Motala 2000

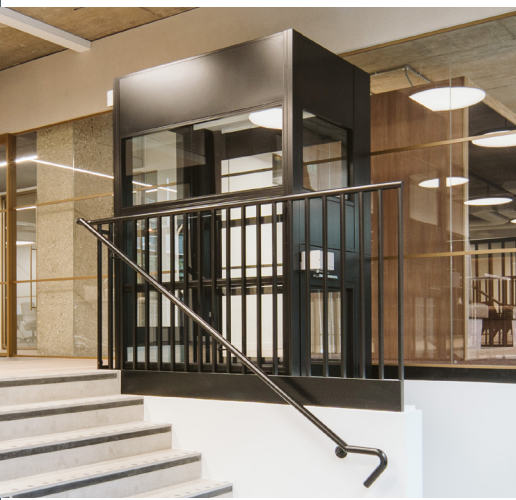

Commercial Platform Lift

Part M Compliant Platform Lift (certified to EN81-41)

The Motala 2000 platform lift is in a class of its own. No other platform lift offers the same high-quality performance, low noise level and the option to be glazed on all four sides. The Motala 2000 is unique with its dual guided chain drive system and has the largest internal platform size with the smallest external footprint on the market.



PLATFORM
LIFT COMPANY
EST. 2001

Motala 2000

Standard Features

Fully clad shaft on all four sides (no structural fixing required)
Glazed doors - manually operated with self closer
Energy-saving LED lighting in ceiling
Stainless steel door handles
Energy efficient 0.55kW motor
Electrical emergency lowering
Soft start
Telephone
240v frequency drive operation
Constant pressure tactile pushes
Large clear buttons
Handrail and door handles - stainless steel

Optional Features

Glazing to all four sides
Mix of glazed and solid panels
Special platform sizes
Fire doors (30/60 minutes)
Automatic doors
1300mm high doors at top floor - half height
Choice of four digit RAL colours
School locking facility
Auto dialler
Choice of door design
Handrail and door handles - wooden (teak or oak)
Voice annunciation

Specifications

Drive	Dual Chain Driven
Capacity	500kg
Speed	0.15m/s
Travel	Up to six levels, up to 15 metres

SPACE REQUIREMENT / FLOOR APERTURE

Pit	60mm
Headroom	2230mm minimum

SIZES (bespoke sizes available)

Platform	Shaft footprint
1020mm x 1450mm	1150mm x 1560mm
1120mm x 1480mm	1250mm x 1560mm *
1200mm x 1480mm	1350mm x 1560mm
1020mm x 1680mm	1150mm x 1760mm
1120mm x 1680mm	1250mm x 1760mm
1220 mm x 1680mm	1350mm x 1760mm

*Part M compliant

LIFT ENCLOSURE

Construction	Cladding on four sides in vinyl coated double skinned steel panels or glazing
Lighting	Ceiling on top of shaft enclosure with LED lighting

LIFTING PLATFORM

Height	1100mm console to one long side
Handrail	Stainless steel to one side on console
Flooring	Vinyl light grey
Safety Edge	Three sides of platform floor & top edge of console
Lighting	Controls illuminated (battery backup)

DOORS

Door Frame	Integral to shaft enclosure
Finishes	Door and frames white powder coated (RAL 9010)
Door Operation	Manual opening with self closer. Electrically and mechanically interlocked.

ELECTRICAL DETAILS / POWER REQUIREMENT

Supply	230-240V 1 phase 50Hz 16A
--------	---------------------------