

Product name	Gas Grade Oversite Membrane
Dimensions – supplied in rolls	30sq metre rolls: 28.6 x 1.05m
Weight	1.2Kg/m ²
Thickness	1.0mm
Tensile strength	230N
Puncture resistance	N 250 (ASTM E154)
Elongation	50%
Jointing method	Lap + integrity seal tape
Moisture vapour transmission	<0.1gm ² 24hr ⁻¹
Methane/Radon Permeability	<0.03ml/m ² /day/atmos

Use

There are two options from which to choose to provide the requisite damp and gas protection to the oversite. To provide protection across the oversite.

Solution

Type N Site-sealer Membrane may be used with conventional concrete ground-bearing slabs and suspended slab oversite construction. Type N is multi-layered membrane consisting of cross-orientated polythene laminated to a bitumen base layer with an aluminium primary sheet sandwiched between. It offers excellent performance with exceedingly low gas permeability. It is supplied in rolls on a carrier paper that upon removal exposes a self-adhesive edge strip. This permits the barrier to be applied to suitably prepared surfaces and for the adjoining widths to adhere to form a continuous presence.

OVERSITE MEMBRANES

Option 1: Type N Site-sealer Membrane

- Combined water and gas protection
- Integrates with cavity barrier
- Integral self-adhesive edge
- Reinforced
- Radon and methane gas resistant

Membrane interfaces
with Cavity Barrier

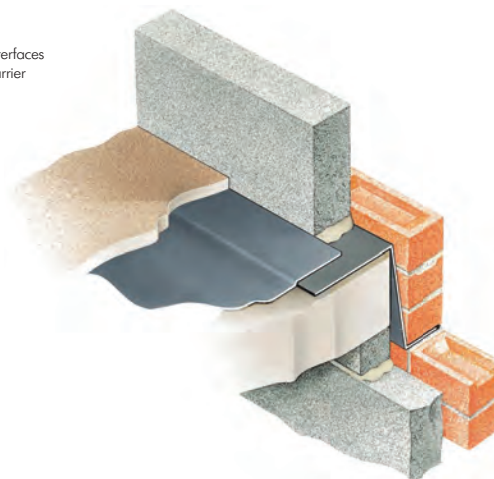

Bill of Quantity / Specification Wording

D21 -Clause 350 Gas Retardant Membrane -J40 Flexible sheet waterproofing / damp proofing.

Manufacturer: Cavity Trays Ltd, Yeovil Somerset BA22 8HU Tel: 01935 474769

Type N Site-sealer Membrane to oversite laid to manufacturers instructions with continuous integration with adjacent barriers.

Product name	Footprint Oversite Membrane - Loose Laid
Dimensions – supplied in rolls	25 x 2m and 25 x 4m
Weight	410gm ⁻²
Thickness	0.4mm
Tensile strength	750N/50mm
Tear Resistance	≤400N
Elongation	15-30%
Jointing method	Lap + integrity seal tape
Moisture vapour transmission	≥1024MNsg ⁻¹
Radon Permeability	≤10x10102 ⁻¹² m ² s ⁻¹

Use

To provide protection across the oversite against rising damp and rising gas.

Solution

Footprint Oversite Membrane is supplied in rolls and may be used loose laid with ground-supported or suspended slabs. Where medium to high concentrations of radon gas are experienced, Footprint membrane can function as a water and gas resistant oversite barrier. It may also be used where methane or carbon dioxide are present.

Footprint Membrane is multi-layered incorporating LDPE with polyester reinforcing and an aluminium foil skin. It has low gas permeability.

OVERSITE MEMBRANES

Option 2: Type LLRB Loose Laid Radon Barrier

- Combined water and gas protection
- Integrates with cavity barrier
- Radon, methane and carbon dioxide resistant

Inboard Projection of barrier interfaces with oversite membrane

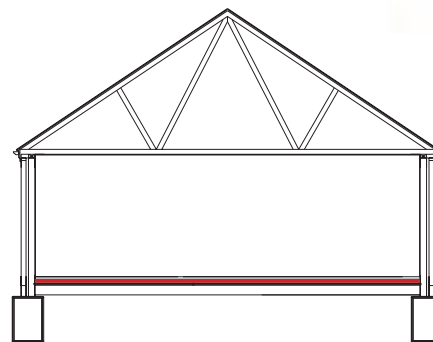
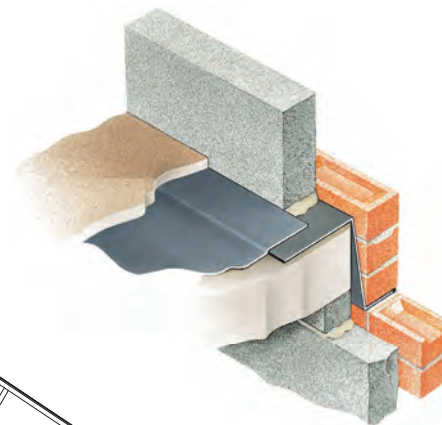

Membrane level will vary depending on flooring construction

Bill of Quantity / Specification Wording

D21 -Clause 350 Gas Retardant Membrane -J40 loose laid polythene gas retardant / damp proofing

Manufacturer: Cavity Trays Ltd, Yeovil Somerset BA22 8HU Tel: 01935 474769

Type LLRB Loose Laid Radon Barrier to oversite laid to manufacturers instructions with continuous and integration with adjacent barriers.