



BRICK FACED INTERNAL  
WALL CLADDING SYSTEM





I-Clad is a brick faced internal wall cladding system. Developed by Eurobrick specifically for interior applications, there is a backer panel to suit all substrates.

## BENEFITS

- Versatile, fast and simple to install.
- Slimline profile minimises loss of valuable interior space.
- Suitable for commercial and domestic interiors.
- Durable with a life span of at least 30 years.
- Indistinguishable from traditional brick work.
- Extensively tested with British Board of Agrément (BBA) certification. In addition, Eurobrick provides its own 25 year product guarantee.

## TECHNICAL INFO

- The composite backer panel comprises 12.5mm thick plasterboard or 17mm thick extruded polystyrene with Eurobrick's high impact polystyrene ribbed skin pre-bonded to it. The horizontal ribs align and support the brick slips so that brick courses are formed accurately and easily.
- System includes panels, fixings, adhesive, brick slips and pointing mortar. All items can be purchased separately. Ancillary products include corner bricks, and installation tools such as adhesive guns and pointing bags.
- Using the 12.5mm thick backer panel the system provides a slimline profile with a depth starting from 28mm.
- We have a wide range of kiln fired clay brick slips available. These include both cut slips (Classic Range) and extruded slips (Britannia Range), please refer to our Product Guide for more information. All are FL Grade and suitable for most applications. Extruded brick slips use approximately 60-70% less energy to manufacture than traditional sized bricks, produce far less waste and can be transported more efficiently. Slips can be cut from other bricks to suit project requirements if the standard selection is not suitable.
- Pointing mortar is available in eight standard colours to complement or contrast with the chosen brick.

## SMALL PROJECTS AND FIREPLACES

- For small areas or fireplaces and inglenooks, cement based adhesive and brick slip spacers can be supplied as an alternative fixing method to using the panel systems.

## INSTALLATION

The plasterboard backer panel can be fixed to timber or light gauge steel studs (please see diagram for required positioning of the studs) or existing plywood or plasterboard surfaces. The extruded polystyrene backer panel can be fixed directly to an existing masonry wall.

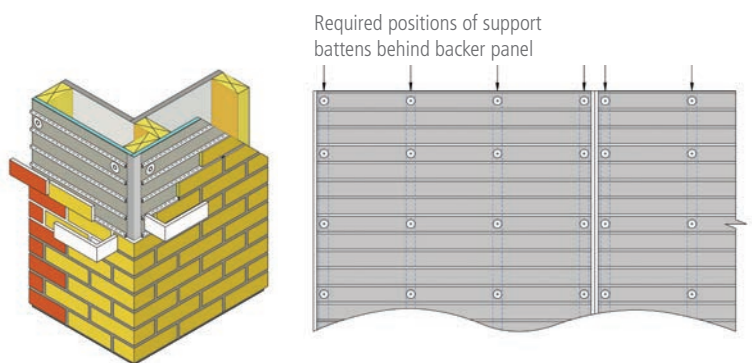

NB. Additional detail diagrams are available on our website or please refer to our Installation Guide. Please note that failure to fix in accordance with Eurobrick's instructions will invalidate the product guarantee.



1. The ribbed backing panel is fixed to the substrate. (Fixings vary according to substrate.)



2. Brick slips are attached with permanent bonding adhesive.



3. Specially formulated mortar is then piped into the brick joints.



4. Mortar is tooled in the manner of traditional pointing.



For technical queries or further advice on ordering please call +44 (0)117 971 7117



For more information please visit our website at [www.eurobrick.co.uk](http://www.eurobrick.co.uk)

