



THE SYSTEM

The SBS-450 range of tie bars are manufactured from a high quality stainless steel grade 316 with rolled threads to BS3643. Manufactured to order and available up to 6m lengths. Longer lengths are available by using bar couplers.



SBS-450 BARS ARE GENERALLY USED ON :

- Membrane Structures
- Lightweight Steel Structures
- Footbridges
- Glass Facades

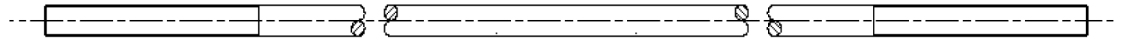

PART CODE	THREAD (METRIC)	ULTIMATE STRESS kN*	YIELD STRESS kN*	STRESS AREA mm ²	2YIELD LOAD kN*	ULTIMATE LOAD kN*
SBM10	M10 X 1.50	700	450	58	26.1	40.6
SBM12	M12 X 1.75	700	450	54	37.8	58.8
SBM16	M16 x 2.00	700	450	157	70.7	109.9
SBM20	M20 x 2.50	700	450	245	110.3	171.5
SBM24	M24 x 3.00	700	450	353	158.9	247.1
SBM27	M27 x 3.00	700	450	459	206.6	321.3
SBM30	M30 x 3.50	700	450	561	252.6	392.7
SBM33	M33 x 3.50	700	450	694	312.3	485.8
SBM36	M36 x 4.00	700	450	817	367.7	571.9
SBM39	M39 x 4.00	700	450	976	439	638.2

*in accordance with BS5950-1:2000 and EN 1993-1-8:2005

CLEVIS PIN

PART CODE	L	OD	HD	C/S SCREW
BDHP10	25mm	10mm	12.7mm	M3 x 6
BDHP12	32mm	12mm	14mm	M5 x 12
BDHP16	40mm	16mm	19mm	M5 x 12
BDHP20	50mm	20mm	24mm	M6 x 12
BDHP24	60mm	24mm	28mm	M6 x 12
BDHP27	70mm	27mm	32mm	M6 x 12
BDHP30	75mm	30mm	35mm	M8 x 16
BDHP33	80mm	33mm	38mm	M8 x 16
BDHP36	90mm	36mm	42mm	M8 x 16
BDHP39	100mm	39mm	45mm	M8 x 16



TAPER LOCK NUT

PART CODE	TH	OD	L	C
TLNM10	M10 x 1.50	15mm	17.0mm	3.5mm
TLNM12	M12 x 1.75	19mm	20.4mm	3.5mm
TLNM16	M16 x 2.00	25mm	27.2mm	3.5mm
TLNM20	M20 x 2.50	30mm	34.0mm	3.5mm
TLNM24	M24 x 3.00	36mm	40.8mm	4mm
TLNM27	M27 x 3.00	42mm	45.9mm	4mm
TLNM30	M30 x 3.50	45mm	51.0mm	4mm
TLNM33	M33 x 3.50	48mm	56.1mm	5mm
TLNM36	M36 x 4.00	54mm	61.2mm	5mm
TLNM39	M39 x 4.00	60mm	66.3mm	5mm

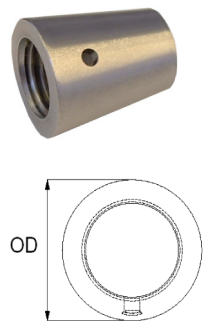

TECHNICAL DATA

The Hi-MOD SBS450 bars are manufactured from stainless steel grade 316 EN10088 1.4401/4 which offers higher corrosion resistance. The pins are designed in accordance with BS 5950-1:2000 and EN 1993-1-8:2005. All components are produced at our manufacturing facility in the North of the England using the latest technology in CNC equipment and produced in accordance with our quality systems . Bar lengths are available up to 6m. Lengths exceeding 6m are also available by utilising a bar coupler. All accessories are finished to a N4 standard (240 grit satin). Bars are produced to a bright drawn finish. ****NOTE**** If the forks are at maximum adjustment then half a diameter of thread will be visible after the Taper Nut has been fully tightened. Modulus of Elasticity 200N/mm²