



## DECORATIVE

MYSON offer a selection of DECORATIVE valves for projects that need that extra special finishing touch. Manufactured from solid brass, they are beautifully finished in highly polished chrome. The range includes compression and screwed iron connections, with straight and angle options available.

### GENERAL SPECIFICATION

-  **CERTIFICATION**  
Produced under a quality management system - ISO 9001:2008. Conforms to BS 2767-10.
-  **OPERATING PRESSURES**  
Tested to a maximum pressure of 10 bar.
-  **GUARANTEE**  
2 year guarantee from date of purchase against manufacturing defects.
-  **OPERATING TEMPERATURE**  
Maximum 120°C.
-  **COLOUR**  
Finished in polished chrome.
-  **DELIVERY**  
2 - 5 working days.
-  **CONNECTIONS**  
Compression or screwed iron.

For more general information, please see page 250.

DIMENSIONS

Handwheel

15mm & 1/2" Angle

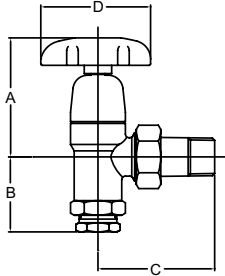

15mm & 1/2" Straight (for vertical mounting)

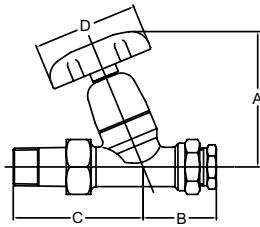

15mm & 1/2" Straight (for horizontal mounting)

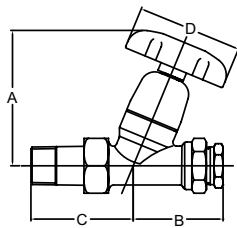

| Model                        | A    | B    | C    | D    |
|------------------------------|------|------|------|------|
|                              | (mm) | (mm) | (mm) | (mm) |
| 15mm & 1/2" Angle            | 65.0 | 41.0 | 55.0 | 60.0 |
| 15mm & 1/2" Straight (Vert)  | 74.0 | 40.0 | 71.0 | 60.0 |
| 15mm & 1/2" Straight (Horiz) | 74.0 | 49.0 | 56.0 | 60.0 |

Lockshield

15mm & 1/2" Angle

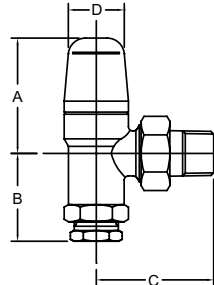

15mm & 1/2" Straight (for vertical mounting)

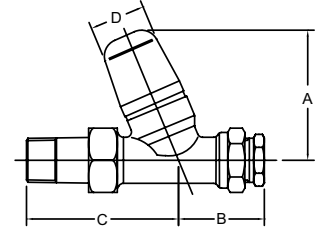

15mm & 1/2" Straight (for horizontal mounting)

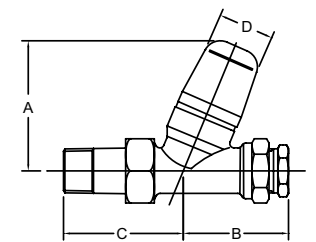

| Model                        | A    | B    | C    | D    |
|------------------------------|------|------|------|------|
|                              | (mm) | (mm) | (mm) | (mm) |
| 15mm & 1/2" Angle            | 54.0 | 41.0 | 55.0 | 26.0 |
| 15mm & 1/2" Straight (Vert)  | 61.0 | 40.0 | 71.0 | 26.0 |
| 15mm & 1/2" Straight (Horiz) | 61.0 | 49.0 | 56.0 | 26.0 |

NB: All measurements are nominal.



DEC15SHSC



DEC15LAC

| Description   | Metal Finish    | Order Code | Minimum Order Qty |
|---|-----------------|------------|-------------------|
| 15mm & 1/2" Angle Handwheel                               | Polished Chrome | DEC15HAC   | 1                 |
| 15mm & 1/2" Angle Lockshield                              | Polished Chrome | DEC15LAC   | 1                 |
| 15mm & 1/2" Straight Handwheel (for Vertical Mounting)    | Polished Chrome | DEC15HSVC  | 1                 |
| 15mm & 1/2" Straight Handwheel (for Horizontal Mounting)  | Polished Chrome | DEC15HSHC  | 1                 |
| 15mm & 1/2" Straight Lockshield (for Vertical Mounting)   | Polished Chrome | DEC15LSVC  | 1                 |
| 15mm & 1/2" Straight Lockshield (for Horizontal Mounting) | Polished Chrome | DEC15LSHC  | 1                 |