

# series 4 fire doors

FD 60; FD 60S

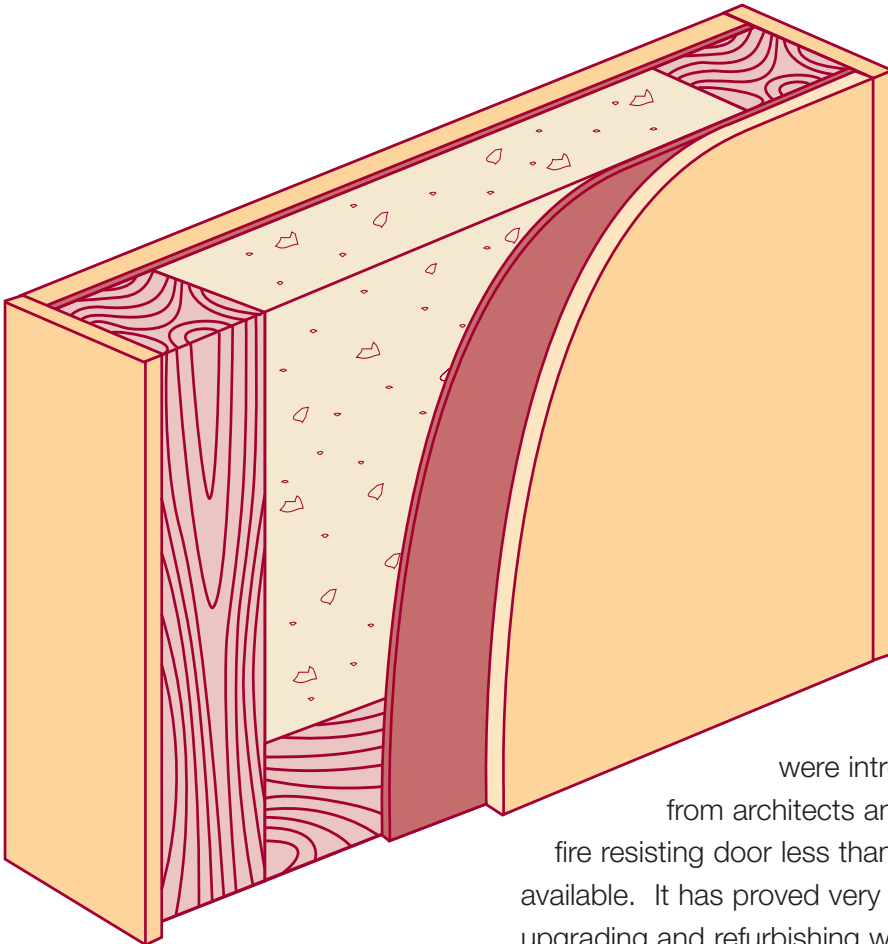

Noberne Series 4 46mm doors were introduced following requests from architects and specifiers for a one hour fire resisting door less than the 54mm thickness normally available. It has proved very popular in the fields of upgrading and refurbishing where it has enabled costs to be contained or even reduced. BM TRADA Q-Mark Quality assured construction.

Series 4 doors have been tested by Chiltern International Fire in accordance with methods specified in BS 476 PART 22 1987 and the following results obtained:

TEST REF	RF98089
INTEGRITY	68 MINUTES
INSULATION	68 MINUTES

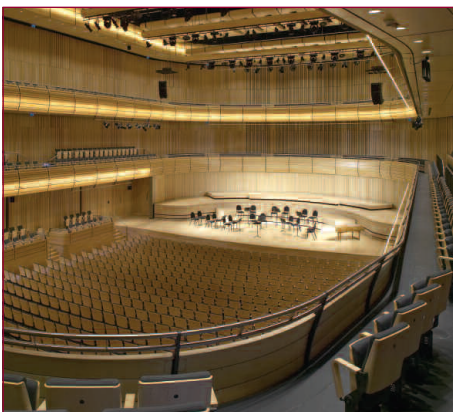

*"I wish to thank you for an excellent job, well done. Both myself and the users of the Selly Oak Hospital Post Graduate Centre are very impressed with your Doorsets."*

MAX HAYWARD, PINNEGAR SMITH ARCHITECTS

Illustrations are not to scale

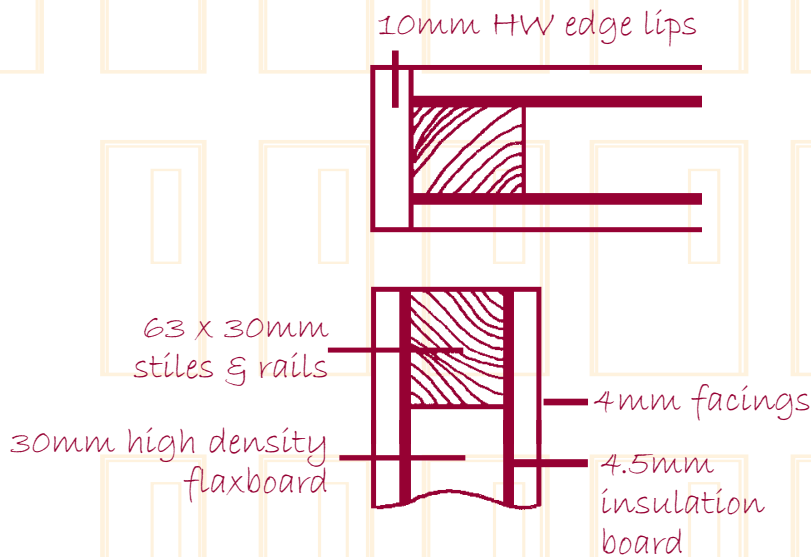

The Series 4 door can be converted into a smoke control door as specified in BS5588 by the addition of suitable flexible seals.

1 hour doors must be installed in a hardwood frame of appropriate section and density.



### Specification

Stiles, top and bottom rails of kiln dried softwood 10-12% moisture content or engineered strand timber, core of high density flaxboard, doors faced with 4.5mm non-asbestos insulation board, bonded to each face of the flaxboard and framing, doors faced with 4mm external grade plywood, MDF or veneered/laminated chipboard as required. Kiln dried hardwood lippings fixed by hot melt gluing to both long edges, lippings to top and bottom as required.

Thickness 46mm.  
TOLERANCE  $\pm 2$ mm.  
Average weight 29kg/m<sup>2</sup>.

### Acoustics

Tested to achieve a minimum 30dB Rw for single leaf, single action doorsets at Salford University in conjunction with appropriate acoustic seals.

### Availability

The Series 4 is available as large single or large pairs of doors in a wide range of sizes (details on request) and finishes to suit customer's requirements and up to 0.67m<sup>2</sup> of the door area may be glazed using various patent glazing systems.

### Noberne Doors Limited

Lupton Street, Hunslet  
Leeds LS10 2QP

**T** 0113 277 8577

**F** 0113 277 2049

**E** sales@nobervedoors.co.uk  
[www.nobervedoors.co.uk](http://www.nobervedoors.co.uk)

