



**IMAGINE  
BEYOND LIMITS**

**TECHNAL UK**  
Product Catalogue



By  Hydro

 **Imagine What's Next**





# TECHNAL

IMAGINE WHAT'S NEXT

**WHERE OTHERS JUST SEE A WINDOW, WE SEE CUTTING-EDGE TECHNOLOGY THAT BENEFITS THE USERS AND THE ENVIRONMENT. WE SEE THE FUTURE.**

## ABOUT TECHNAL

Imagination makes the world go around. Here at TECHNAL, it's our driving force and way of doing things. It allows us to move forward, innovate and inspire. Where others just see a window, we see cutting-edge technology that benefits both users and the environment. We see the future.

The TECHNAL brand by Hydro was created over 60 years ago, and is an pioneering international specialist in architectural aluminium facade systems. We have established an unrivalled reputation for innovative and inspiring design solutions, building up a portfolio of impressive, award-winning projects.

With a history in the UK spanning more than 30 years, our sustainable aluminium building systems have been used to create purpose-designed facade for diverse sectors of commercial and residential buildings.

We have a clear understanding of the requirements of architects, contractors, developers, fabricators and occupiers, which enables us to develop an innovative, technically advanced and flexible product range.

## OUR VALUES

At TECHNAL, we know that design isn't just about aesthetics. Design encompasses additional dimensions:

- functionality
- ergonomics
- environmental impact
- energy efficiency
- integration
- individuality

TECHNAL quality is based on our multidisciplinary expertise which includes all aspects of the product: raw materials, design, services and support, colour and finishes, accessories, software and more.



# CONTENTS

## 7 PRODUCT CATALOGUE

### FACADES

TENTAL 50 MULLION - TRANSOM  
TENTAL 50 TRANSOM - TRANSOM  
TENTAL 60 MULLION - TRANSOM  
TENTAL 50 SLOPED GLAZING

### WINDOWS

SOLEAL NEXT VISIBLE OPEN IN  
SOLEAL NEXT VISIBLE OPEN OUT  
SOLEAL NEXT MINIMAL OPEN IN  
PATIO WINDOW  
RESIDENTIAL DOOR  
NOTEAL LOUVRE

### DOORS

SOLEAL NEXT ENTRANCE DOOR  
SOLEAL NEXT ESCAPE DOOR  
SOLEAL NEXT FINGER-PROTECTION  
TITANE NEXT HIGH-TRAFFIC DOOR

### SLIDING & FOLDING

TIGAL  
CONFORT SMARTLINE  
AMBIAL









# ↗ FACADES

TENTAL 50 - TENTAL 60 - TENTAL SLOPED G





LAZING



# FACADE TENTAL 50

MULLION-TRANSOM

## ➤ THE CIRCULAR FACADE

The TENTAL curtain wall was created with a view to offering architects and consultants an extensive range of solutions, giving them as much creative freedom as possible when designing a facade.



### AESTHETICS AND MODULARITY

- Multiple exterior aspects:
  - Feature cap
  - Horizontal line
  - Vertical line
  - Flat cap
- Collection of caps that mark the identity of each facade
- A full palette of colours
- Facet solution up to +/- 10°
- 90° corner post

### LARGE DIMENSIONS

- Large infills up to 6 m<sup>2</sup>
- Maximum vent weight: up to 600 kg according to EN 16758 / EN 17146
- Maximum glazing thickness 62 mm

### INSTALLATION AND ASSEMBLY

- 3 glazing installation techniques:
  - Continuous pressure plate
  - Punctual pressure plate
  - Structural glazing (SG) with concealed glass fixing
- Patented dry glazing gasket connection

### SUSTAINABILITY

- Designed for assembly and disassembly
- Components are made of 75% recycled and 95% recyclable material.
- Cradle to Cradle® under certification
- Available in Hydro CIRCAL®, aluminium made with a minimum of 75% recycled end-of-life aluminium. This aluminium has one of the lowest CO<sub>2</sub> footprints worldwide: 1.9 kg of CO<sub>2</sub>/kg aluminium.
- Dynamic EPD available on TechDesign







TECHNAL®

## PERFORMANCES (according to CWCT & EN standards)

Air permeability: AE 750 Pa
Water tightness: up to RE 900 Pa
Wind pressure resistance: <ul style="list-style-type: none"><li>- Service pressure up to 2400 Pa</li><li>- Security pressure up to 3600 Pa</li></ul>
Burglary resistance: RC1N, RC2N, RC2, RC3
Impact resistance: I5/E5
Thermal performance: <ul style="list-style-type: none"><li>- <math>U_f</math> up to 0.53 W/m<sup>2</sup>K</li><li>- <math>U_{cw}</math> up to 1.4 W/m<sup>2</sup>K (with <math>U_g = 1.1</math> W/m<sup>2</sup>K)</li></ul>
Acoustic performance: $R_w (C; C_{tr}) = 43 (-1; -3)$ dB <ul style="list-style-type: none"><li>- Vertical: <math>D_{n,f,w} (C; C_{tr}) = &lt;66 (-1; -4)</math> dB</li><li>- Horizontal: <math>D_{n,f,w} (C; C_{tr}) = &lt;55 (-1; -4)</math> dB</li></ul>

FACADE  
TENTAL 50

## APPLICATIONS

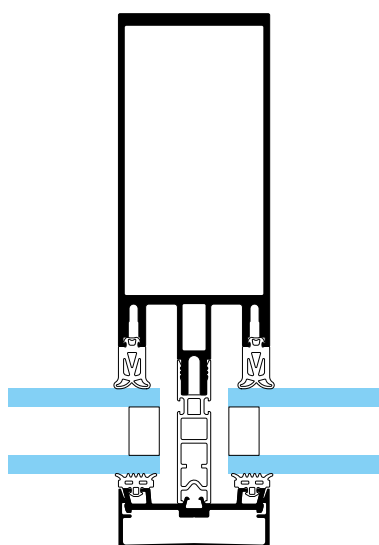

TENTAL 50 MT Feature Caps

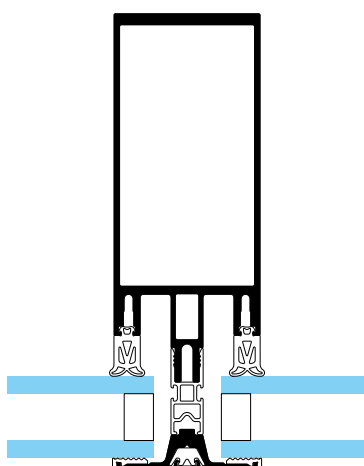

TENTAL 50 MT Flat Caps

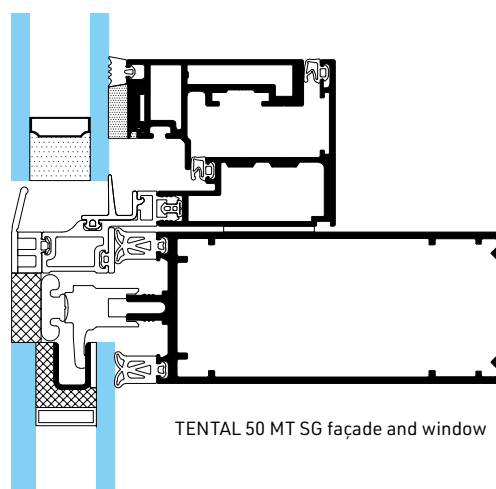

TENTAL 50 MT SG façade and window

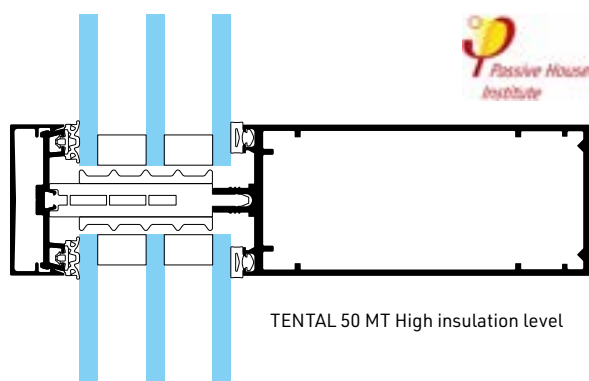

TENTAL 50 MT High insulation level

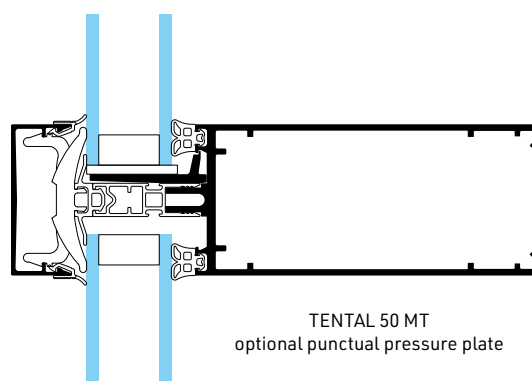

TENTAL 50 MT  
optional punctual pressure plate

# FACADE TENTAL 50

TRANSOM-TRANSOM

## ➤ THE CIRCULAR FACADE

The TENTAL curtain wall was created with a view to offering architects and consultants an extensive range of solutions, giving them as much creative freedom as possible when designing a facade.



### AESTHETICS AND MODULARITY

- Multiple exterior aspects:
  - Feature cap
  - Horizontal line
  - Vertical line
  - Flat cap
  - Structural glazing
- Collection of caps that mark the identity of each facade
- A full palette of colours
- 90° corner post

### LARGE DIMENSIONS

- Large infills up to 6 m<sup>2</sup>
- Maximum vent weight: up to 380 kg according to EN 16758 / EN 17146
- Maximum glazing thickness 56 mm

### INSTALLATION AND ASSEMBLY

- 4 glazing installation techniques:
  - Continuous pressure plate with classic pane drainage
  - Continuous pressure plate with concealed pane drainage
  - Punctual pressure plate
  - Structural Glazing (SG) with concealed glass fixing

### SUSTAINABILITY

- Designed for assembly and disassembly
- Components are made of 75% recycled and 95% recyclable material.
- Cradle to Cradle® under certification
- Available in Hydro CIRCAL®, aluminium made with a minimum of 75% recycled end-of-life aluminium. This aluminium has one of the lowest CO<sub>2</sub> footprints worldwide: 1.9 kg of CO<sub>2</sub>/kg aluminium.
- Dynamic EPD available on TechDesign





**TECHNAL®**

## PERFORMANCES (according to CWCT & EN standards)

Air permeability: AE 600 Pa
Water tightness: up to RE 600 Pa
Wind pressure resistance: <ul style="list-style-type: none"><li>- Service pressure up to 2400 Pa</li><li>- Security pressure up to 3600 Pa</li></ul>
Burglary resistance: RC1N, RC2N, RC2, RC3
Impact resistance: I5/E5
Thermal performance: <ul style="list-style-type: none"><li>- <math>U_f</math> up to <math>0.55 \text{ W/m}^2\text{K}</math></li><li>- <math>U_{cw}</math> up to <math>1.4 \text{ W/m}^2\text{K}</math> (with <math>U_g = 1.1 \text{ W/m}^2\text{K}</math>)</li></ul>
Acoustic performance: $R_w (C; C_{tr}) = 43 (-1; -3) \text{ dB}$ <ul style="list-style-type: none"><li>- Vertical: <math>D_{n,f,w} (C; C_{tr}) = &lt;66 (-1; -4) \text{ dB}</math></li><li>- Horizontal: <math>D_{n,f,w} (C; C_{tr}) = &lt;55 (-1; -4) \text{ dB}</math></li></ul>

**FACADE  
TENTAL 50**

## APPLICATIONS

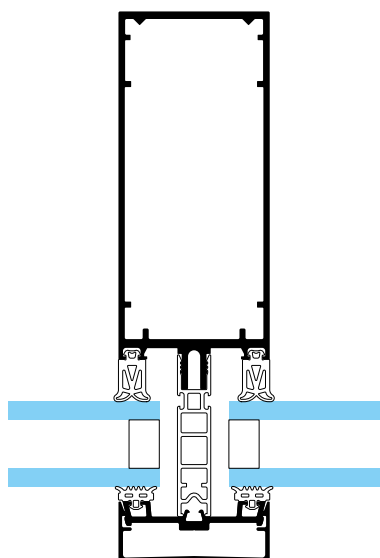

TENTAL 50 TT Feature Caps

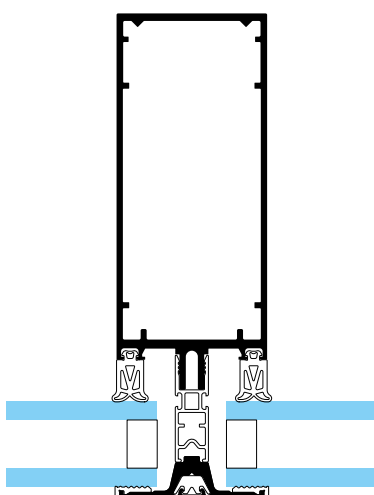

TENTAL 50 TT Flat Caps

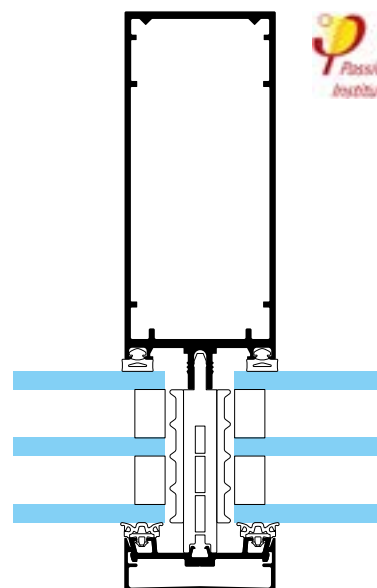

TENTAL 50 TT High insulation level

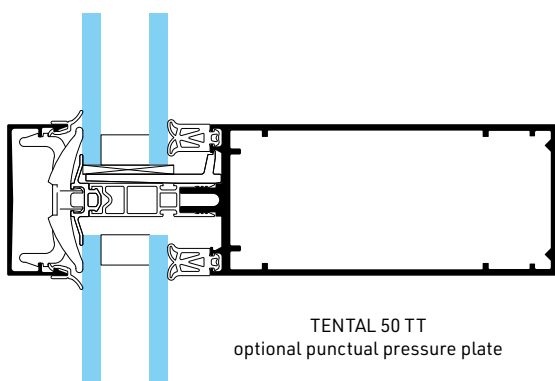

TENTAL 50 TT  
optional punctual pressure plate

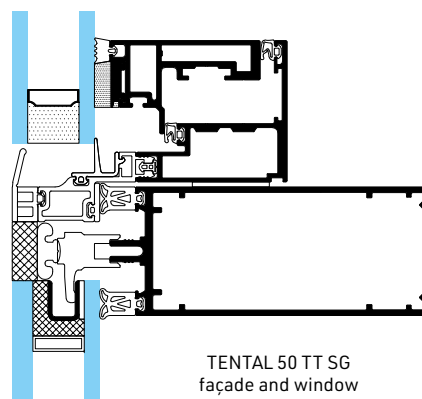

TENTAL 50 TT SG  
façade and window



# FACADE

## TENTAL 60

MULLION-TRANSOM

### ➤ THE CIRCULAR FACADE

The TENTAL curtain wall was created with a view to offering architects and consultants an extensive range of solutions, giving them as much creative freedom as possible when designing a facade.



### AESTHETICS AND MODULARITY

- Multiple exterior aspects:
  - Feature cap
  - Horizontal line
  - Vertical line
  - Flat cap
  - Structural glazing
- Collection of caps that mark the identity of each facade
- A full palette of colours
- Facet solution up to +/- 10°
- 90° corner post

### LARGE DIMENSIONS

- Large infills up to 12.25 m<sup>2</sup>
- Maximum vent weight: up to 850 kg according to EN 16758 / EN 17146
- Maximum glazing thickness 62 mm

### INSTALLATION AND ASSEMBLY

- 2 glazing installation techniques:
  - Continuous pressure plate
  - Structural glazing
- Patented dry glazing gasket connection

### SUSTAINABILITY

- Designed for assembly and disassembly
- Components are made of 75% recycled and 95% recyclable material
- Cradle to Cradle® under certification
- Available in Hydro CIRCAL®, aluminium made with a minimum of 75% recycled end-of-life aluminium. This aluminium has one of the lowest CO<sub>2</sub> footprints worldwide: 1.9 kg of CO<sub>2</sub>/kg aluminium.
- Dynamic EPD available on TechDesign



**TECHNAL®****FACADE  
TENTAL 60**

## PERFORMANCES (according to CWCT & EN standards)

Air permeability: AE 750Pa

Water tightness: RE 900 Pa

Wind pressure resistance:

- Service pressure up to 2400 Pa
- Security pressure up to 3600 Pa

Burglary resistance: RC1N, RC2N, RC2, RC3

Impact resistance: I5/E5

Thermal performance:

- $U_f$  up to  $0.52 \text{ W/m}^2\text{K}$  (fixed)
- $U_{cw}$  up to  $1.4 \text{ W/m}^2\text{K}$  (fixed) with  $U_g = 1.1 \text{ W/m}^2\text{K}$

Acoustic performance:

$R_w (C; C_{tr}) = 43 (-1 ; -3) \text{ dB}$  (fixed)

## APPLICATIONS

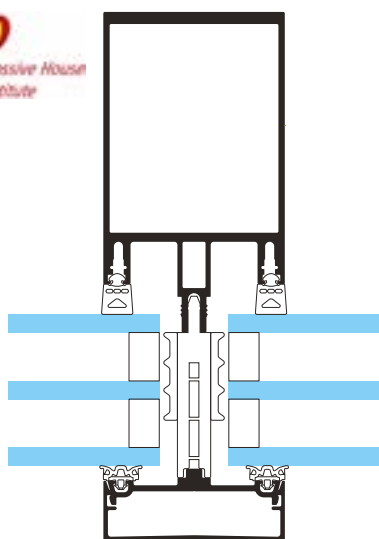

TENTAL 60 high insulation level

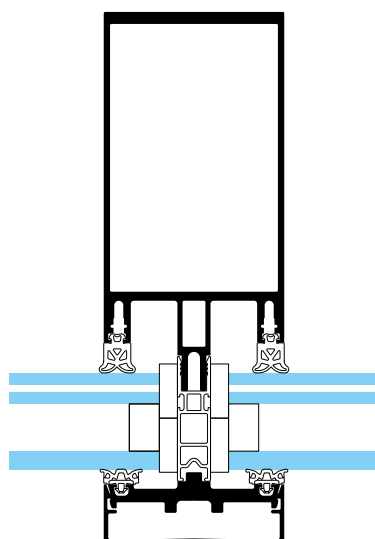

TENTAL Burglar Resistance RC2

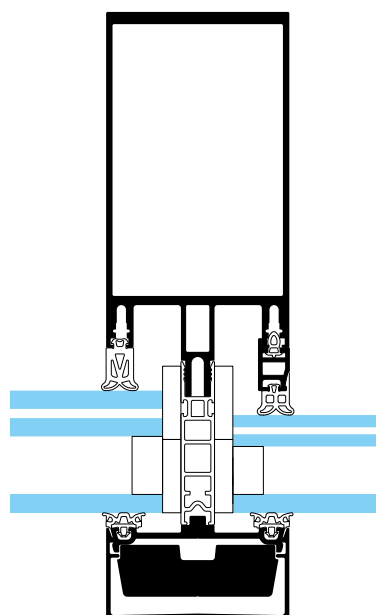

TENTAL Burglar Resistance RC3

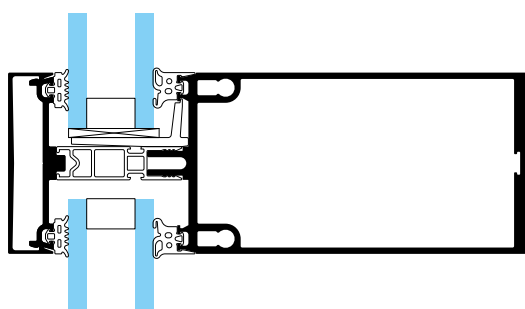

TENTAL 60 standard insulation level



# FACADE TENTAL 50

## SLOPED GLAZING

### ➤ THE CIRCULAR FACADE

The TENTAL curtain wall was created with a view to offering architects and consultants an extensive range of solutions, giving them as much creative freedom as possible when designing a facade.



### AESTHETICS AND MODULARITY

- Exterior aspects:
  - Feature cap (>45°)
  - Vertical line (>10°)
  - Structural glazing (SG)
- Collection of caps that mark the identity of each facade
- A full palette of colours

### LARGE DIMENSIONS

- Large infills up to 6 m<sup>2</sup>
- Maximum vent weight: up to 600 kg according to EN 16758 / EN 17146
- Maximum glazing thickness 62 mm

### OPENINGS

- Top hung open out
- Infills up to 3 m<sup>2</sup>
- Maximum vent weight: up to 200 kg
- Maximum glazing thickness 62 mm
- Manual opening using screw-jack
- Automated opening and locking using motors

### INSTALLATION AND ASSEMBLY

Based on the standard TENTAL 50 facade:

- Mullion-Transom back structure
- 3 drainage level profiles
- Notched and over-lapping T-connections
- Cascading Drainage

### SUSTAINABILITY

- Designed for assembly and disassembly
- Components are made of 75% recycled and 95% recyclable material.
- Cradle to Cradle® under certification
- Available in Hydro CIRCAL®, aluminium made with a minimum of 75% recycled end-of-life aluminium. This aluminium has one of the lowest CO<sub>2</sub> footprints worldwide: 1.9 kg of CO<sub>2</sub>/kg aluminium.
- Dynamic EPD available on TechDesign



**TECHNAL®****FACADE  
TENTAL 50**

## PERFORMANCES (according to EN standards)

<b>Air permeability:</b> 1500 Pa (fixed) Class 4 (Opening)
<b>Water tightness:</b> RE 1500 Pa (fixed) 1200 Pa (Opening)
<b>Wind pressure resistance:</b> <ul style="list-style-type: none"><li>- Service pressure up to 2000 Pa (fixed)</li><li>- Security pressure up to 3000 Pa (fixed)</li><li>- Class C4 (opening)</li></ul>
<b>Burglary resistance:</b> RC1N, RC2N, RC2, RC3
<b>Impact resistance:</b> I5/E5, hard body (steel ball @1.0m), SB 1200 (sand bag @2.4m)
<b>Thermal performance:</b> <ul style="list-style-type: none"><li>- <math>U_f</math> up to 0.53 W/m<sup>2</sup>K (fixed)</li><li>- <math>U_{cw}</math> up to 1.4 W/m<sup>2</sup>K (fixed) with <math>U_g = 1.1</math> W/m<sup>2</sup>K</li></ul>
<b>Acoustic performance:</b> $R_w (C; C_{tr}) = 43 (-1 ; -3)$ dB (fixed)

## APPLICATIONS

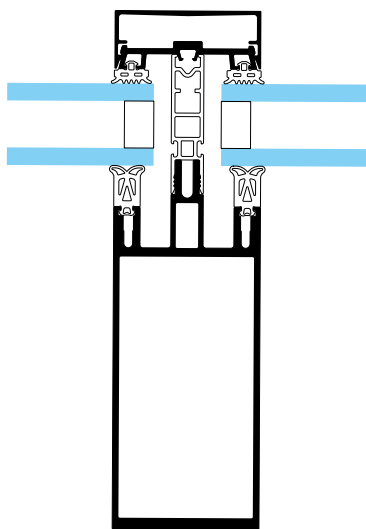

TENTAL 50 Sloped Glazing

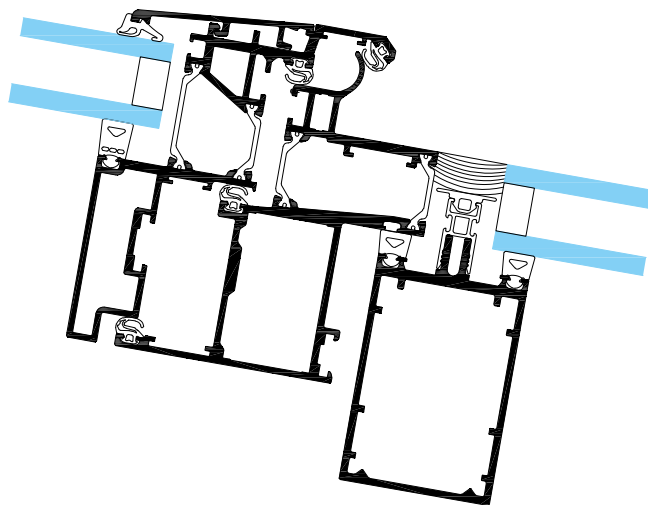

TENTAL 50 Sloped Glazing and TENTAL roof window

# 7 WINDOWS

SOLEAL NEXT - NOTEAL LOUVRE







# WINDOW

## SOLEAL NEXT

VISIBLE FRAME OPEN-IN

### ➤ THE CIRCULAR WINDOW

The SOLEAL Next Casement has high-performance for weather tightness, thermal, acoustic and sustainability to create the buildings of tomorrow, today.



### AESTHETICS AND MODULARITY

- Five frame designs
- Five vent designs
- Concealed Hardware
- Concealed Drainage
- EXCLUSIVE handle collection
- Full RAL colour palette

### LARGE DIMENSIONS

- Up to 3m in height
- Glazing thickness up to 69mm
- Vent weight up to 160kg

### APPLICATIONS

- Open-in Turn, Tilt & Turn, Tilt Before Turn and Tilt Only
- Integration with TENTAL Facade
- Composite assemblies
- Magnetic window contact
- Motorisation available
- Juliet Guarding
- NOTEAL Louvre tested to 1.5kn

### SAFETY AND ACCESSIBILITY

- Burglary Resistance up to RC2 & PAS-24 Certified
- Concealed locking sensor for use with Building Management Systems
- Antibacterial coating on handles
- Doc F compliant trickle vents
- Restrictors compliant with building regulations

### SUSTAINABILITY

- Designed for assembly and disassembly
- Components are made of 75% recycled and 95% recyclable material
- Cradle to Cradle® under certification
- Available in Hydro CIRCAL®, aluminium made with a minimum of 75% recycled end-of-life aluminium. This aluminium has one of the lowest CO<sub>2</sub> footprints worldwide: 1.9 kg of CO<sub>2</sub>/kg aluminium
- Dynamic EPD available on TechDesign



**TECHNAL®****WINDOW  
SOLEAL NEXT**

## PERFORMANCES (according to EN standards)

Air permeability: A4 (600pa)
Water tightness: AE1500 (1500pa)
Wind pressure resistance: C5 (2000pa)
Burglary resistance: PAS24 & RC2
Thermal performance: <ul style="list-style-type: none"><li>- <math>U_w</math> up to <math>0.8 \text{ W/m}^2\text{K}</math> with <math>U_g</math> <math>0.5 \text{ W/m}^2\text{K}</math></li><li>- <math>U_w</math> up to <math>1.2 \text{ W/m}^2\text{K}</math> with <math>U_g = 1.0 \text{ W/m}^2\text{K}</math></li></ul>
Acoustic performance: $R_w (C; C_{tr}) = 49 (-2 ; -6) \text{ dB}$

## APPLICATIONS

### OPEN-IN

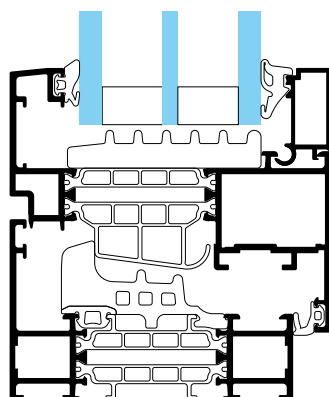

SOLEAL NEXT 75  
Visible Open-In

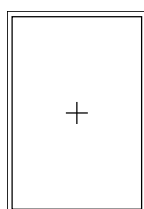

Fixed Frame

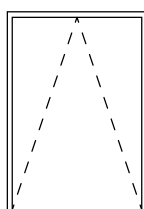

Bottom Hung

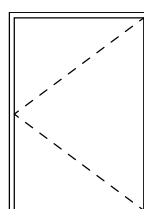

Side Hung  
1 vent

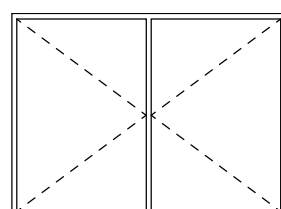

Side Hung  
2 vents

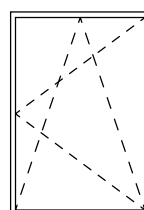

Turn/Tilt or  
Tilt/Turn  
1 vent

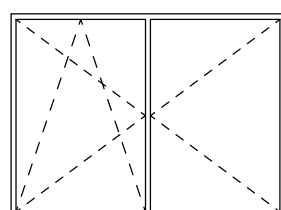

Turn/Tilt or Tilt/Turn  
2 vents

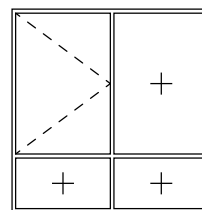

Fixed Composite  
Open-In

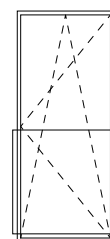

Juliet Guarding

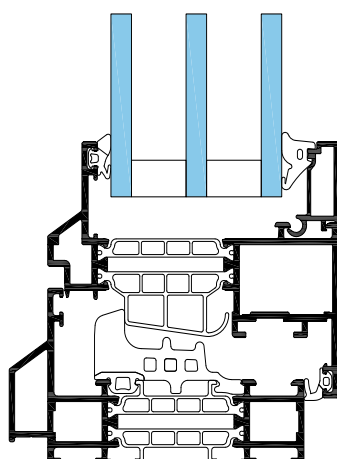

SOLEAL NEXT 75  
Visible Sloped Design

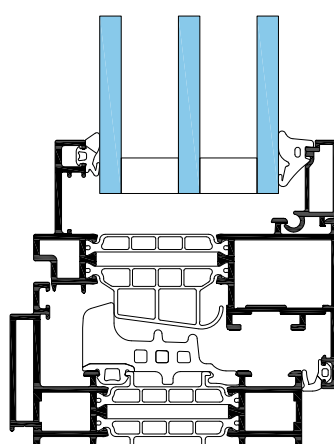

SOLEAL NEXT 75  
Visible Step Design

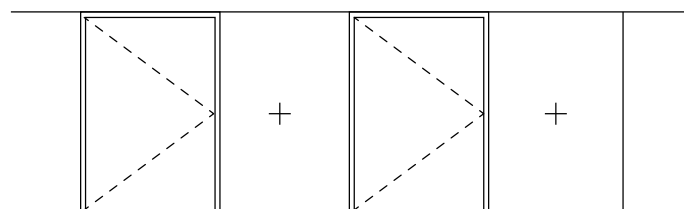

Ribbon Window



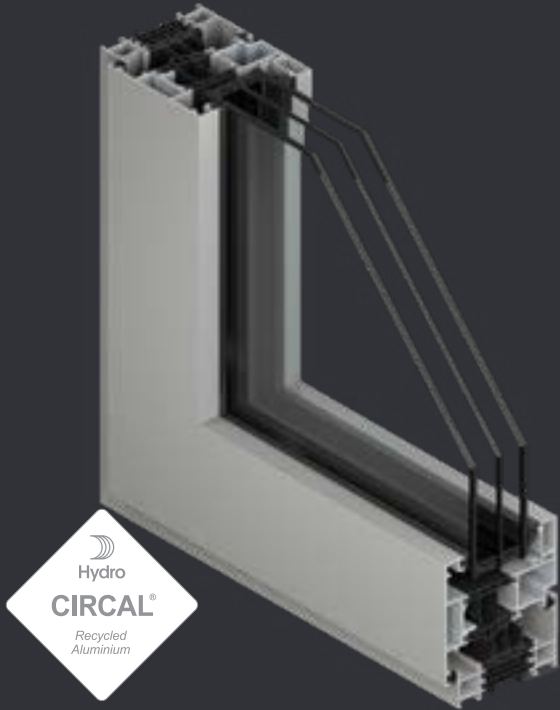

# WINDOW

## SOLEAL NEXT

VISIBLE FRAME OPEN-OUT

### ➤ THE CIRCULAR WINDOW

The SOLEAL Next Casement has high-performance for weather tightness, thermal, acoustic and sustainability to create the buildings of tomorrow, today.

#### AESTHETICS AND MODULARITY

- Three vent designs
- Concealed Hardware
- Concealed Drainage
- EXCLUSIVE handle collection
- Full RAL colour palette

#### LARGE DIMENSIONS

- Up to 1.8m in height
- Glazing thickness up to 69mm
- Vent weight up to 100kg

#### APPLICATIONS

- Top Hung, Side Hung & Double French opening
- Integration with TENTAL Facade
- Composite assemblies
- Magnetic window contact

#### SAFETY AND ACCESSIBILITY

- Burglary Resistance up to RC2 & PAS-24 certified
- PAS-24 compliant security beads for external glazing
- Concealed locking sensor for use with Building Management Systems
- Antibacterial coating on handles
- Doc F compliant trickle vents
- Restrictors compliant with building regulations

#### SUSTAINABILITY

- Designed for assembly and disassembly
- Components are made of 75% recycled and 95% recyclable material.
- Cradle to Cradle® under certification
- Available in Hydro CIRCAL®, aluminium made with a minimum of 75% recycled end-of-life aluminium. This aluminium has one of the lowest CO<sub>2</sub> footprints worldwide: 1.9 kg of CO<sub>2</sub>/kg aluminium.
- Dynamic EPD available on TechDesign



## PERFORMANCES (according to EN standards)



TECHNAL®

Air permeability: A4 (600pa)

Water tightness: AE (1800pa)

Wind pressure resistance: C5 (2000pa)

Burglary resistance: PAS24

Thermal performance:

- $U_w$  up to  $0.8 \text{ W/m}^2\text{K}$  with  $U_g = 0.5 \text{ W/m}^2\text{K}$
- $U_w$  up to  $1.2 \text{ W/m}^2\text{K}$  with  $U_g = 1.0 \text{ W/m}^2\text{K}$

Acoustic performance:

$R_w (C; C_{tr}) = 49 (-2; -6) \text{ dB}$

## APPLICATIONS

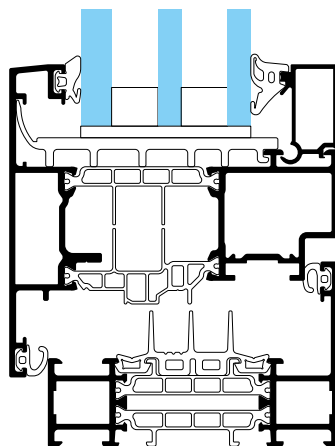

SOLEAL NEXT 75 Visible  
Open-Out

### OPEN-OUT

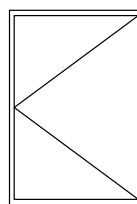

1 vent

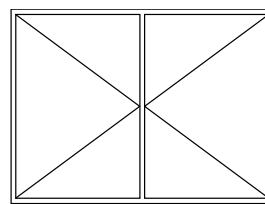

2 vents

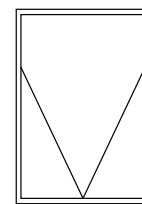

Projecting  
Top-Hung

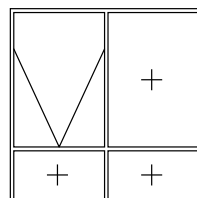

Fixed Composite  
Projecting  
Top-Hung

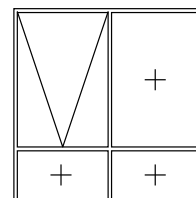

Fixed Composite  
Projecting  
butt-hinges

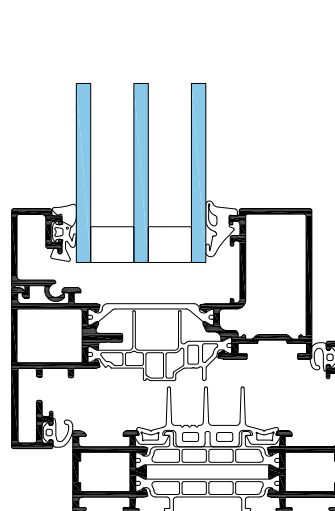

SOLEAL NEXT 75 Visible  
67mm vent

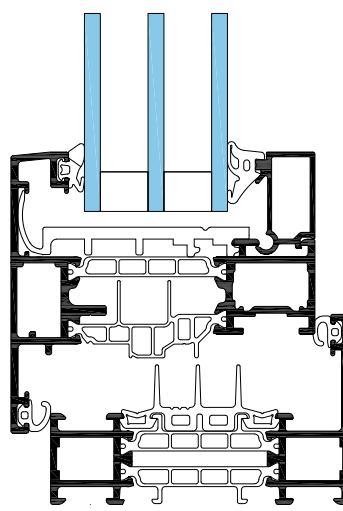

SOLEAL NEXT 75 Visible  
71mm vent

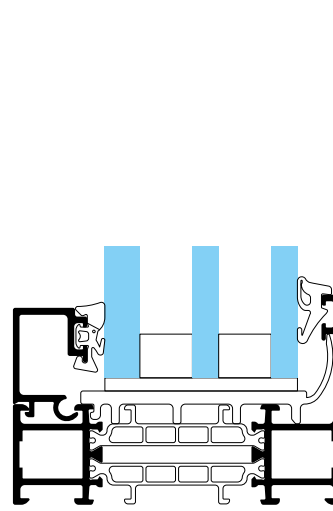

SOLEAL NEXT 75 fixed frame

WINDOW  
SOLEAL NEXT

# WINDOW

## SOLEAL NEXT

MINIMAL FRAME OPEN-IN

### ➤ THE CIRCULAR WINDOW

The SOLEAL Next Casement has high-performance for weather tightness, thermal, acoustic and sustainability to create the buildings of tomorrow, today.

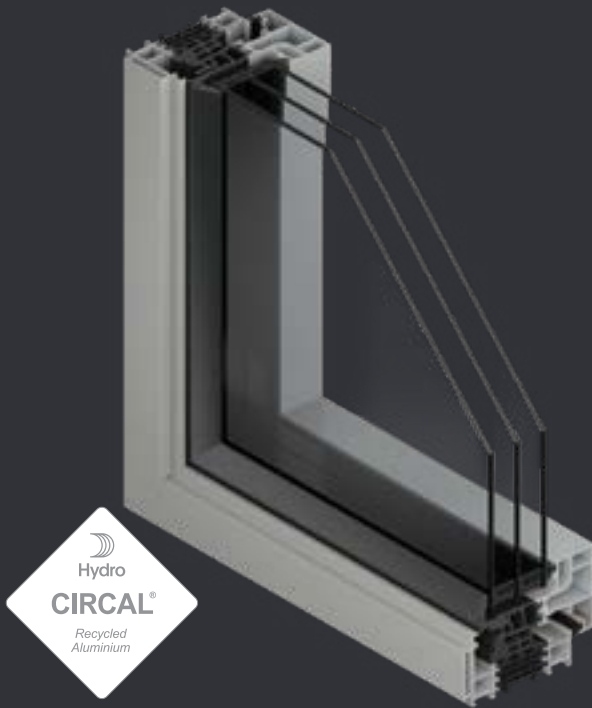

### AESTHETICS AND MODULARITY

- Five frame options
- Five vent designs
- Concealed Hardware
- Concealed Handle and Drainage
- EXCLUSIVE handle collection
- Full RAL colour palette

### LARGE DIMENSIONS

- Up to 3m in height
- Glazing thickness up to 69mm
- Vent weight up to 160kg

### APPLICATIONS

- Open-in Tilt & Turn and Tilt Before Turn
- Integration with TENTAL Facade
- Composite assemblies
- Magnetic window contact
- Motorisation available
- Juliet Guarding compatible
- NOTEAL Louvre tested to 1.5kn

### SAFETY AND ACCESSIBILITY

- Burglary Resistance up to RC2 & PAS-24 Certified
- Concealed locking sensor for use with Building Management Systems
- Antibacterial coating on handles
- Doc F compliant trickle vents

### SUSTAINABILITY

- Designed for assembly and disassembly
- Components are made of 75% recycled and 95% recyclable material.
- Cradle to Cradle® under certification
- Available in Hydro CIRCAL®, aluminium made with a minimum of 75% recycled end-of-life aluminium. This aluminium has one of the lowest CO<sub>2</sub> footprints worldwide: 1.9 kg of CO<sub>2</sub>/kg aluminium.
- Dynamic EPD available on TechDesign





## PERFORMANCES (according to EN standards)



TECHNAL®

WINDOW  
SOLEAL NEXT

Air permeability: A4 (600pa)

Water tightness: AE1500 (1500pa)

Wind pressure resistance: C5 (2000pa)

Burglary resistance: PAS24 & RC2

Thermal performance:

- $U_w$  up to  $0.8 \text{ W/m}^2\text{K}$  with  $U_g = 0.5 \text{ W/m}^2\text{K}$
- $U_w$  up to  $1.2 \text{ W/m}^2\text{K}$  with  $U_g = 1.0 \text{ W/m}^2\text{K}$

Acoustic performance:

$R_w (C; C_{tr}) = 49 (-2 ; -6) \text{ dB}$

## APPLICATIONS

### OPEN-IN

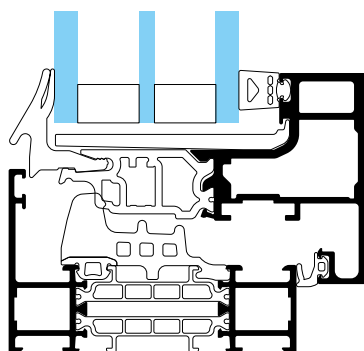

SOLEAL NEXT 75 minimal frame

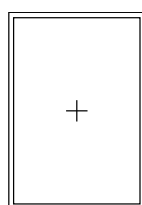

Fixed Frame

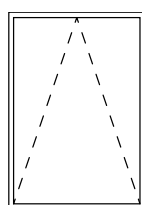

Bottom Hung

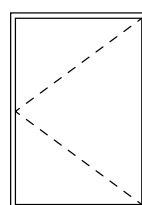

Side Hung  
1 vent

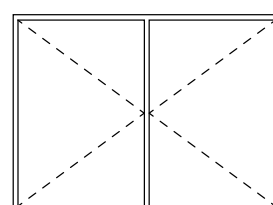

Side Hung  
2 vent

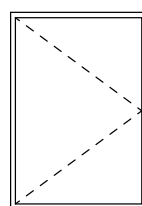

Fireman  
Access

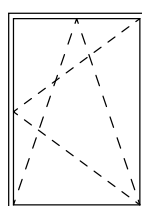

Turn/Tilt or  
Tilt/Turn  
1 vent

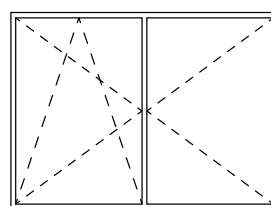

Turn / Tilt or Tilt / Turn  
2 vents

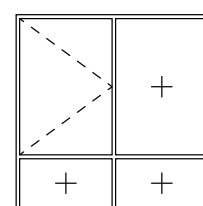

Fixed Composite  
Open-In

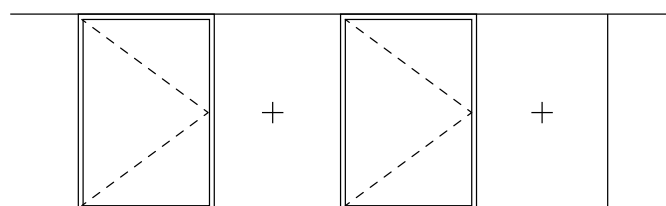

Ribbon Window

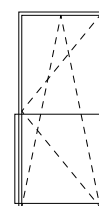

Juliet  
Guarding

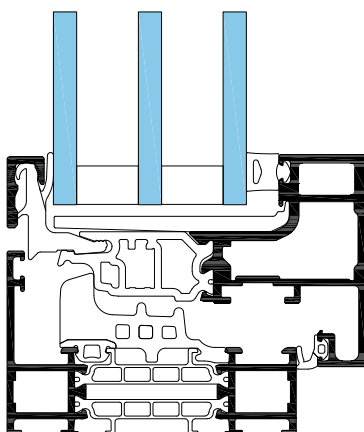

SOLEAL NEXT 75 minimal  
clip on trim

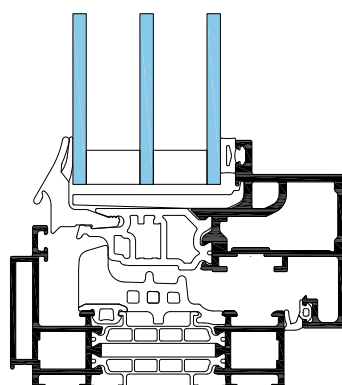

SOLEAL NEXT 75 minimal  
step design

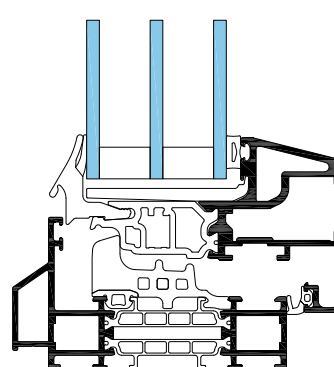

SOLEAL NEXT 75 minimal  
sloped design

# WINDOW

## SOLEAL NEXT

PATIO WINDOW

### ➤ THE CIRCULAR WINDOW

The SOLEAL Next Casement has high-performance for weather tightness, thermal, acoustic and sustainability to create the buildings of tomorrow, today.



### AESTHETICS AND MODULARITY

- Five frame designs
- Five vent designs
- Concealed Hardware
- Concealed Drainage
- EXCLUSIVE handle collection
- Full RAL colour palette

### LARGE DIMENSIONS

- Up to 3m in height
- Glazing thickness up to 69mm
- Vent weight up to 160kg

### APPLICATIONS

- Turn, Tilt & Turn and Tilt Before Turn
- Integration with TENTAL Facade
- Composite assemblies
- Magnetic window contact

### SAFETY AND ACCESSIBILITY

- Burglary Resistance up to RC2 & PAS-24 Certified
- Doc M compliant 15mm threshold
- Concealed locking sensor for use with Building Management Systems
- Antibacterial coating on handles
- Doc F compliant trickle vents

### SUSTAINABILITY

- Designed for assembly and disassembly
- Components are made of 75% recycled and 95% recyclable material.
- Cradle to Cradle® under certification
- Available in Hydro CIRCAL®, aluminium made with a minimum of 75% recycled end-of-life aluminium. This aluminium has one of the lowest CO<sub>2</sub> footprints worldwide: 1.9 kg of CO<sub>2</sub>/kg aluminium.
- Dynamic EPD available on TechDesign





TECHNAL®

WINDOW  
SOLEAL NEXT

## PERFORMANCES (according to EN standards)

Air permeability: A4 (600pa)
Water tightness: 8A (450pa)
Wind pressure resistance: C3 (1200pa)
Burglary resistance: PAS24
Thermal performance: - $U_w$ up to $0.8 \text{ W/m}^2\text{K}$ with $U_g$ $0.5 \text{ W/m}^2\text{K}$ - $U_w$ up to $1.2 \text{ W/m}^2\text{K}$ with $U_g = 1.0 \text{ W/m}^2\text{K}$
Acoustic performance: $R_w (C; C_{tr}) = 49 (-2 ; -6) \text{ dB}$

## APPLICATIONS

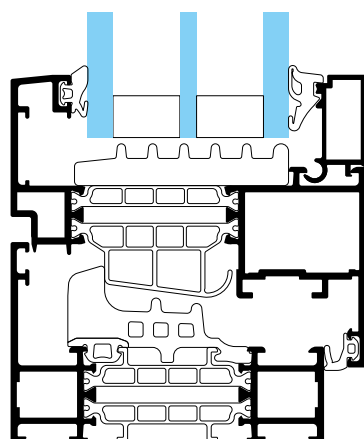

SOLEAL NEXT 75 Visible Open-In

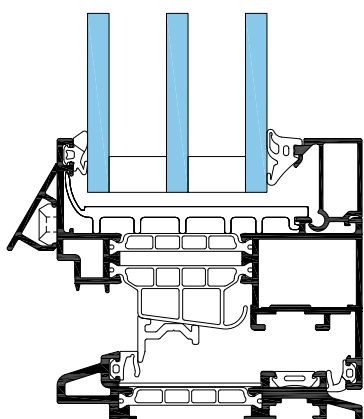

SOLEAL NEXT 75 threshold

### OPEN-IN

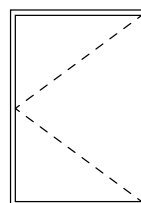

Side-hung  
1 vent

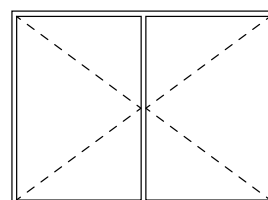

Side-hung  
2 vents

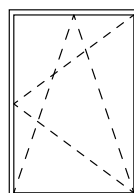

Turn/tilt or tilt/  
turn  
1 vent

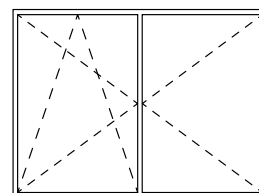

Turn/tilt or tilt/turn  
2 vents

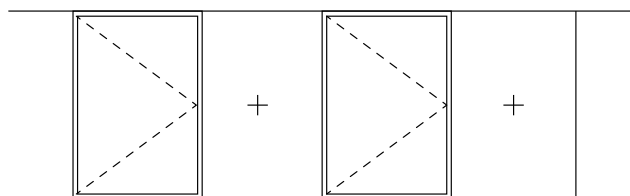

Ribbon window

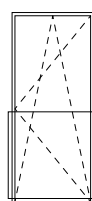

Juliet Guarding

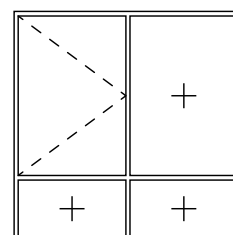

Fixed composite  
open-in window



# WINDOW

## SOLEAL NEXT

RESIDENTIAL DOOR

### ➤ THE CIRCULAR WINDOW

The SOLEAL Next Casement has high-performance for weather tightness, thermal, acoustic and sustainability to create the buildings of tomorrow, today.

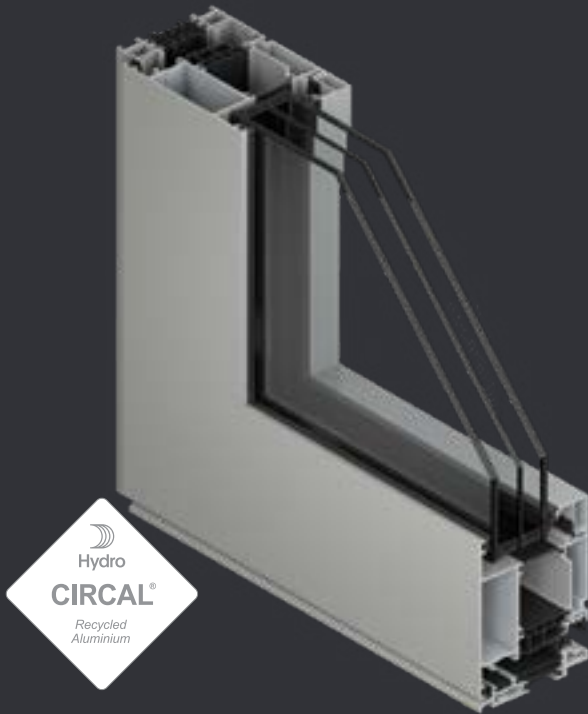

### AESTHETICS AND MODULARITY

- Five frame options
- Designated door vent design
- Visible Door Hardware
- EXCLUSIVE handle collection
- Full RAL colour palette

### LARGE DIMENSIONS

- Up to 2.7m in height
- Glazing thickness up to 69mm
- Vent weight up to 160kg

### APPLICATIONS

- Open-in and Open-out
- Residential door to door locking hardware
- Integration with TENTAL Facade
- Composite assemblies

### SAFETY AND ACCESSIBILITY

- Doc M compliant 15mm threshold
- Concealed locking sensor for use with Building Management Systems
- Antibacterial coating on handles

### SUSTAINABILITY

- Designed for assembly and disassembly
- Components are made of 75% recycled and 95% recyclable material.
- Cradle to Cradle® under certification
- Available in Hydro CIRCAL®, aluminium made with a minimum of 75% recycled end-of-life aluminium. This aluminium has one of the lowest CO<sub>2</sub> footprints worldwide: 1.9 kg of CO<sub>2</sub>/kg aluminium.
- Dynamic EPD available on TechDesign



**TECHNAL®****WINDOW  
SOLEAL NEXT**

## PERFORMANCES (according to EN standards)

Air permeability: A4 (600pa)
Water tightness: 5A (200pa)
Wind pressure resistance: C3 (1200pa)
Burglary resistance: None
Thermal performance: <ul style="list-style-type: none"><li>- <math>U_w</math> up to <math>0.8 \text{ W/m}^2\text{K}</math> with <math>U_g = 0.5 \text{ W/m}^2\text{K}</math></li><li>- <math>U_w</math> up to <math>1.2 \text{ W/m}^2\text{K}</math> with <math>U_g = 1.0 \text{ W/m}^2\text{K}</math></li></ul>
Acoustic performance: $R_w (C; C_{tr}) = 49 (-2 ; -6) \text{ dB}$

## APPLICATIONS

### OPEN-OUT

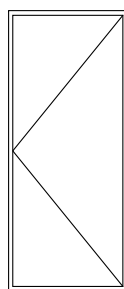
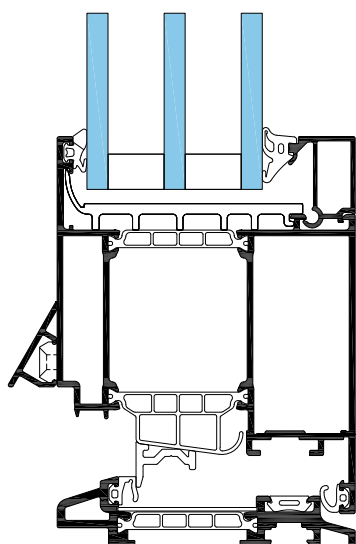

Residential Door  
1 - vent

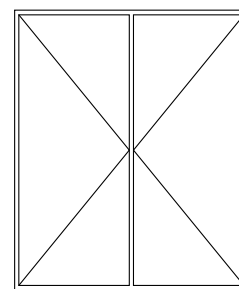

Residential Door  
2 - vents

### OPEN-IN

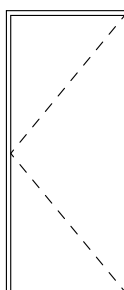
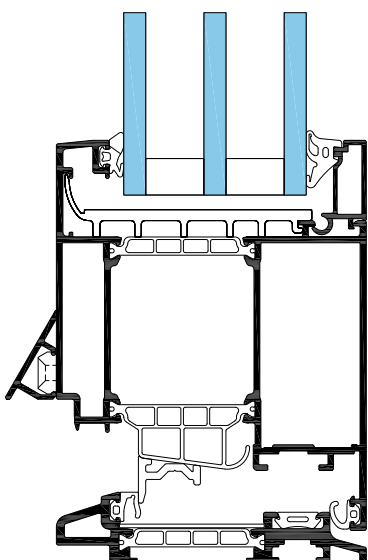

Residential Door  
1 - vent

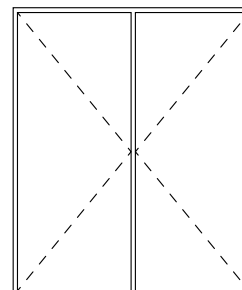

Residential Door  
2 - vents

# LOUVRE NOTEAL

## FIXED GUARDING

### ➤ THE VENTILATION BARRIER

The NOTEAL Barrier Load Louvre protects occupants from falling through open windows in high-rise applications, such as student housing, retail and commercial buildings.

This product is vertical load tested to 0.3kN and horizontal load tested to 1.5kNm<sup>2</sup> which has been tested with our window systems for maximum fall protection.

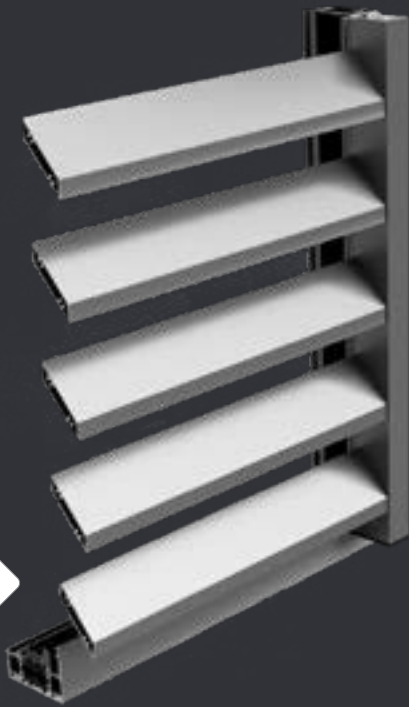

### AESTHETICS AND MODULARITY

- Concealed Fixings
- Optional Fly Screen
- RAL Colour Palette
- Minimalist design for sleek aesthetics

### LARGE DIMENSIONS

- Blade spans up to 1000mm
- Vent sizes up to 3m

### APPLICATIONS

- Suitable for most BS6180 applications:
  - Domestic & Residential buildings
  - Offices & Commercial sectors
  - Retail & Leisure Areas
- Compatible with SOLEAL Next windows

### SAFETY AND ACCESSIBILITY

- Fully tested to BS6180 standards
- Horizontal Load Tested
- Vertical Load Tested
- Impact tested to CWCT TN76
- Fast and hassle-free installation
- Systems tested solution

Secured by Design



Official Police Security Initiative







TECHNAL®

## PERFORMANCES (according to EN standards)

**Horizontal Line Loads:** up to 1.5kN/m

Serviceability: 1.5kN/m

Safety: 2.25kN/m

**Distributed Infill Load:** up to 1.5kNm<sup>2</sup>

Serviceability: 1.5kNm<sup>2</sup>

Safety: 2.25kNm<sup>2</sup>

**Point Load:** up to 1.5kN

Serviceability: 1.5kN

Safety: 2.25kN

**Vertical Load:** 0.3kN

**Impact Resistance:** 0.3kN CWCT TN76 - 500J

## APPLICATIONS

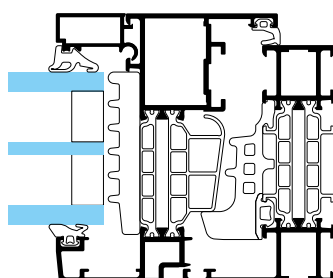
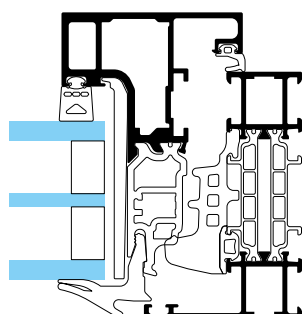
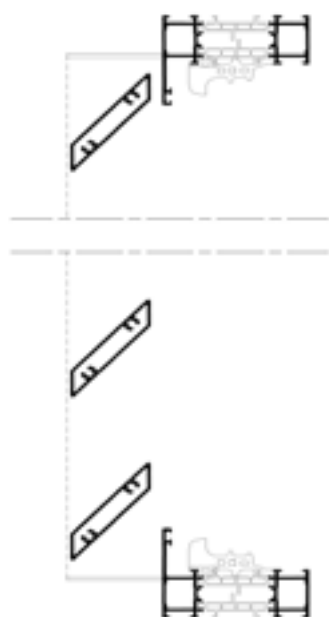

LOUVRE  
NOTEAL

# ↗ DOORS

SOLEAL NEXT - TITANE NEXT







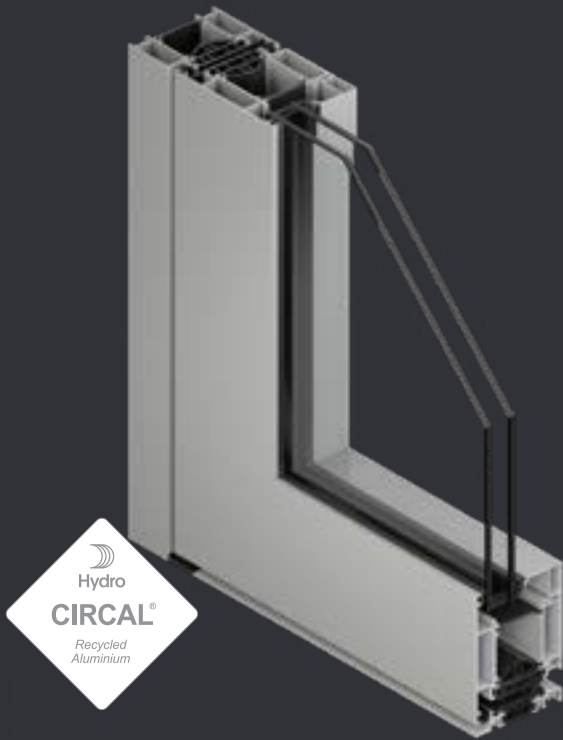

# DOOR

## SOLEAL NEXT

### ENTRANCE DOOR

#### ➤ THE CIRCULAR DOOR

SOLEAL Next is an aesthetic and modular system with excellent safety features. High performance levels for thermal, weather tightness, acoustic and sustainability comply with most international standards.

#### AESTHETICS AND MODULARITY

- Concealed & Visible Hinges
- EXCLUSIVE handle collection
- Full RAL colour palette

#### LARGE DIMENSIONS

- Up to 3m in height
- Glazing thickness up to 59mm
- Vent weight up to 200kg

#### APPLICATIONS

- Multiple opening options:
- Open-in and open-out, 1-leaf or 2-leaves
- Single action, with or without fixed field
- Push-pull
- Simultaneous action door
- Pivoting door
- Facade integration
- Compatible with TENTAL facade, and SOLEAL Next window ranges

#### SAFETY AND ACCESSIBILITY

- Burglary Resistance up to RC2 & PAS-24 compliant
- Bullet Resistant top FB4
- Barrier free threshold & low threshold
- Mechatronics (technical mullion)
- Antibacterial coating on handles

#### SUSTAINABILITY

- Designed for assembly and disassembly
- Components are made of 75% recycled and 95% recyclable material.
- Cradle to Cradle® under certification
- Available in Hydro CIRCAL®, aluminium made with a minimum of 75% recycled end-of-life aluminium. This aluminium has one of the lowest CO<sub>2</sub> footprints worldwide: 1.9 kg of CO<sub>2</sub>/kg aluminium.
- Dynamic EPD available on TechDesign





TECHNAL®

DOOR  
SOLEAL NEXT

## PERFORMANCES (according to EN standards)

Air permeability: A4 (600pa)
Water tightness: 7A (300pa)
Wind pressure resistance: C2 (800pa)
Burglary resistance: PAS24 & RC2
Thermal performance: - $U_w$ up to $0.8 \text{ W/m}^2\text{K}$ with $U_g = 0.5 \text{ W/m}^2\text{K}$ - $U_w$ up to $1.2 \text{ W/m}^2\text{K}$ with $U_g = 1.0 \text{ W/m}^2\text{K}$
Acoustic performance: $R_w (C; C_{tr}) = 43 (-2 ; -6) \text{ dB}$

## APPLICATIONS

### OPEN-IN

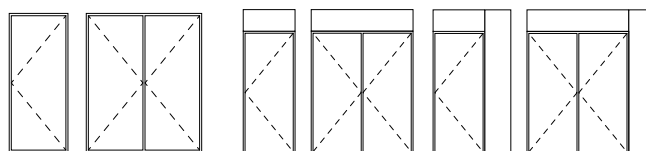
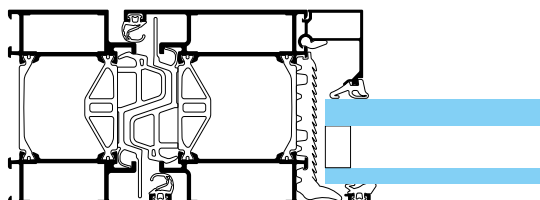

stand alone

compositions with fixed light

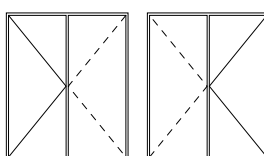

push pull

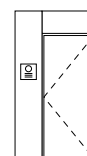
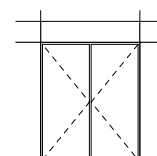
integration with  
technical mullionintegration in  
TENTAL facade

### OPEN-OUT

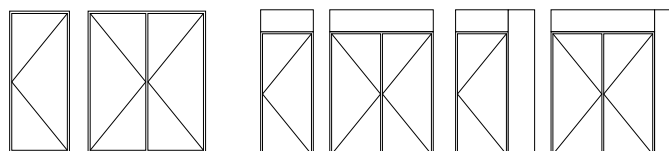
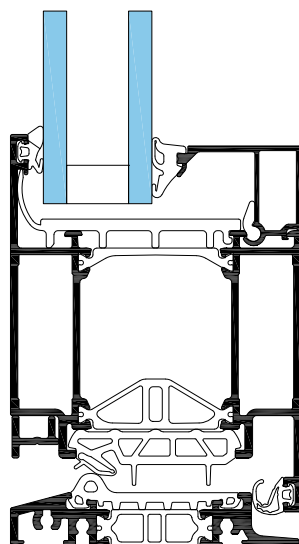

stand alone

compositions with fixed light

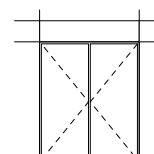
integration with  
technical mullionintegration in  
TENTAL facade

# DOOR

## SOLEAL NEXT

ESCAPE DOOR

### ➤ THE CIRCULAR DOOR

SOLEAL Next is an aesthetic and modular system with excellent safety features. High performance levels for thermal, weather tightness, acoustic and sustainability comply with most international standards.



### AESTHETICS AND MODULARITY

- Concealed Hinges
- EXCLUSIVE handle collection
- Full RAL colour palette

### LARGE DIMENSIONS

- Up to 3m in height
- Glazing thickness up to 59mm
- Vent weight up to 200kg

### APPLICATIONS

- Multiple opening options:
- Open-in and open-out, 1-leaf or 2-leaves
- Single action, with or without fixed field
- Push-pull
- Simultaneous action door
- Panel door
- Pivoting door
- Facade integration
- Compatible with TENTAL facade, and SOLEAL Next window ranges

### SAFETY AND ACCESSIBILITY

- Emergency exit to EN179
- Panic exit to EN1125
- Burglary Resistance up to RC2
- Barrier free threshold & low threshold
- Mechatronics (technical mullion)
- Antibacterial coating on handles

### SUSTAINABILITY

- Designed for assembly and disassembly
- Components are made of 75% recycled and 95% recyclable material.
- Cradle to Cradle® under certification
- Available in Hydro CIRCAL®, aluminium made with a minimum of 75% recycled end-of-life aluminium. This aluminium has one of the lowest CO<sub>2</sub> footprints worldwide: 1.9 kg of CO<sub>2</sub>/kg aluminium.
- Dynamic EPD available on TechDesign







TECHNAL®

## PERFORMANCES (according to EN standards)

Air permeability: A4 (600pa)
Water tightness: 7A (300pa)
Wind pressure resistance: C2 (800pa)
Burglary resistance: PAS24 & RC2
Thermal performance: <ul style="list-style-type: none"><li>- <math>U_w</math> up to <math>0.8 \text{ W/m}^2\text{K}</math> with <math>U_g = 0.5 \text{ W/m}^2\text{K}</math></li><li>- <math>U_w</math> up to <math>1.2 \text{ W/m}^2\text{K}</math> with <math>U_g = 1.0 \text{ W/m}^2\text{K}</math></li></ul>
Acoustic performance: $R_w (C; C_{tr}) = 43 (-2 ; -6) \text{ dB}$

## APPLICATIONS

### OPEN-IN

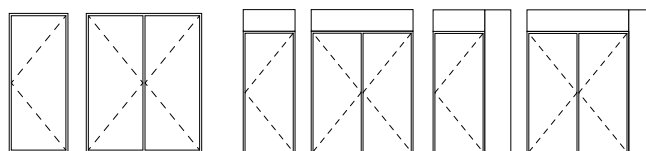
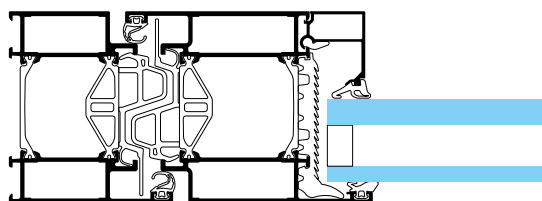

stand alone

compositions with fixed light

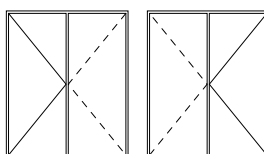

push pull

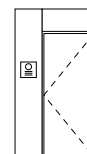

integration with  
technical mullion

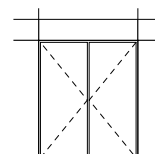

integration in  
TENTAL facade

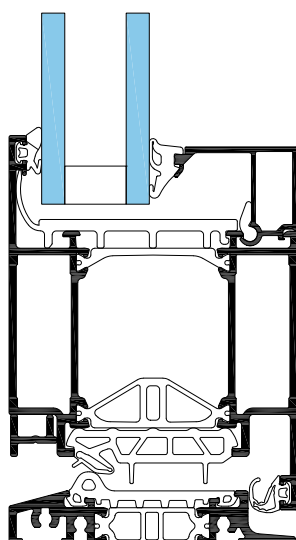

### OPEN-OUT

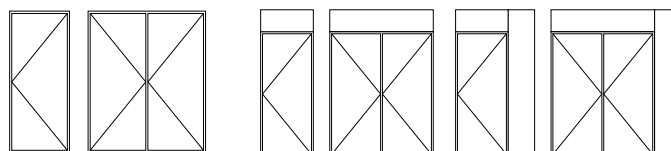

stand alone

compositions with fixed light



integration with  
technical mullion

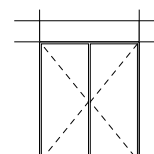

integration in  
TENTAL facade

DOOR  
SOLEAL NEXT



# DOOR

## SOLEAL NEXT

### FINGER PROTECTION

#### ➤ THE CIRCULAR DOOR

SOLEAL Next is an aesthetic and modular system with excellent safety features. High performance levels for thermal, weather tightness, acoustic and sustainability comply with most international standards.

#### AESTHETICS AND MODULARITY

- Concealed Hinges
- EXCLUSIVE handle collection
- Full RAL colour palette

#### LARGE DIMENSIONS

- Up to 3m in height
- Glazing thickness up to 59mm
- Vent weight up to 200kg

#### APPLICATIONS

- Multiple opening options:
- Open-in and open-out, 1-leaf or 2-leaves
- Single action, with or without fixed field
- Simultaneous action door
- Facade integration
- Compatible with TENTAL facade, and SOLEAL Next window ranges

#### SAFETY AND ACCESSIBILITY

- Finger protection
- Barrier free threshold & low threshold
- Mechatronics (technical mullion)
- Antibacterial coating on handles

#### SUSTAINABILITY

- Designed for assembly and disassembly
- Components are made of 75% recycled and 95% recyclable material.
- Cradle to Cradle® under certification
- Available in Hydro CIRCAL®, aluminium made with a minimum of 75% recycled end-of-life aluminium. This aluminium has one of the lowest CO<sub>2</sub> footprints worldwide: 1.9 kg of CO<sub>2</sub>/kg aluminium.
- Dynamic EPD available on TechDesign



## PERFORMANCES (according to EN standards)

Air permeability: A4 (600pa)
Water tightness: 6A (250pa)
Wind pressure resistance: C2 (800pa)
Burglary resistance: None
Thermal performance: - $U_w$ up to $0.8 \text{ W/m}^2\text{K}$ with $U_g = 0.5 \text{ W/m}^2\text{K}$ - $U_w$ up to $1.2 \text{ W/m}^2\text{K}$ with $U_g = 1.0 \text{ W/m}^2\text{K}$
Acoustic performance: $R_w (C; C_{tr}) = 43 (-2 ; -6) \text{ dB}$

## APPLICATIONS

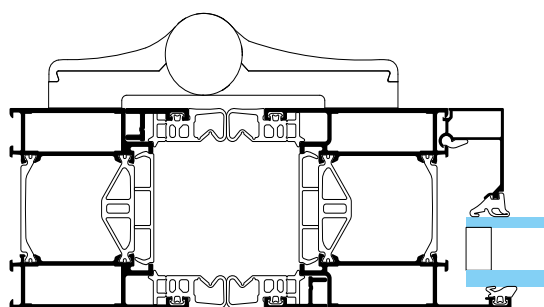

Finger protection on the hinge side

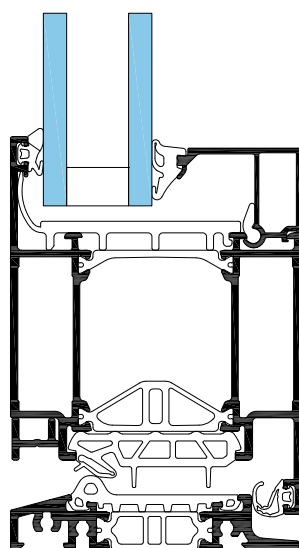

### OPEN-IN

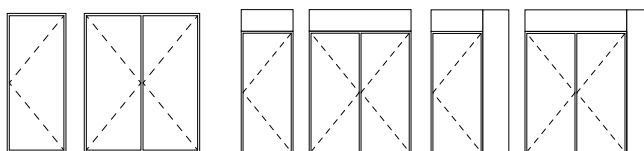

stand alone

compositions with fixed light

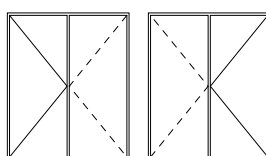

push pull

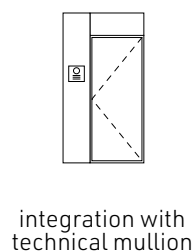

integration with technical mullion

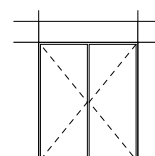

integration in TENTAL facade

### OPEN-OUT

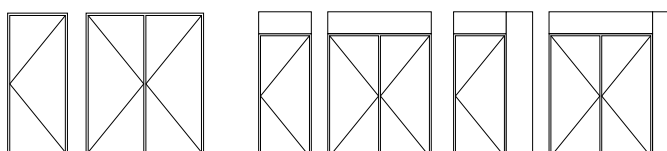

stand alone

compositions with fixed light



integration with technical mullion

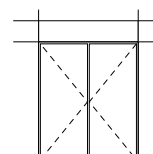

integration in TENTAL facade



TECHNAL®

DOOR  
SOLEAL NEXT

# DOOR

## TITANE NEXT

HIGH-TRAFFIC DOOR

### ➤ THE COMMERCIAL DOOR

Easy to manufacture and assemble, TITANE NEXT 75 is a state-of-the-art shop front and commercial building aluminium door solution.

Offering exceptional thermal performance and larger dimensions, a seamless blend of functionality, aesthetics, and energy efficiency is provided.



### AESTHETICS AND DESIGN

- Concealed hinges, electromagnetic locks and transom closers
- Full RAL colour palette
- Available in Dual Colour option

### LARGE DIMENSIONS

- Doors
  - 75mm module
  - Up to 3m in height
  - Up to 1.2m in width
  - Up to 60mm glazing thickness
  - Up to 110kg Leaf weight
- Fixed Parts:
  - 100mm module
  - Up to 3m Height
  - Glazing Thickness:
    - Pocket Rebate up to 32mm
    - Open Rebate up to 46mm
  - Up to 200kg glass infill weight

### APPLICATIONS

- Standard door: double action, 1-leaf or 2-leaf
- Panic Exit door: single action, 1-leaf, 2-leaf
- Door with electromagnetic lock: single action, 1-leaf or 2-leaf
- Side light and other composite framing options

### SAFETY AND ACCESSIBILITY

- Low threshold - 15mm
- Panic Exit door according to EN1125
- Finger-Protection system
- PAS-24 Burglary Resistance
- Optional electromagnetic locks

### SUSTAINABILITY

- Available in Hydro CIRCAL®, aluminium made with a minimum of 75% recycled end-of-life aluminium.
- PVC-free components
- Dynamic EPD available on TechDesign
- 75% recycled and 95% recyclable
- Easily dismantled at end-of-life for circularity and recycling

Secured by Design



Official Police Security Initiative







TECHNAL®

DOOR  
TITANE NEXT

## PERFORMANCES (according to EN standards)

Air permeability: Up to A2
Water tightness: Up to 3A
Wind pressure resistance: Up to C3
Burglary resistance: PAS24
Thermal performance: - $U_w$ up to $0.79 \text{ W/m}^2\text{K}$
Endurance test for heavy traffic on transom closer: up to 500,000 cycles

## APPLICATIONS

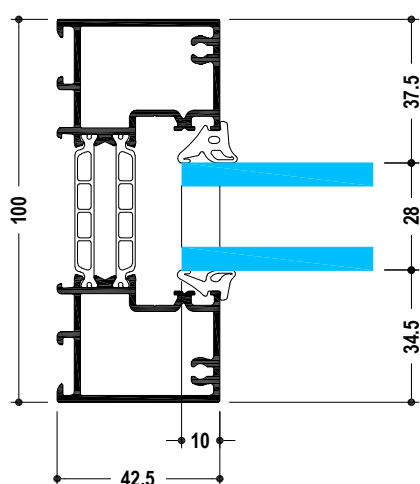

Pocket framing for glass up to 32 mm

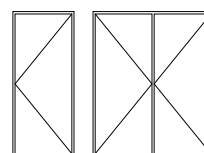

stand alone

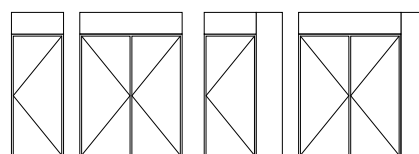

compositions with fixed light

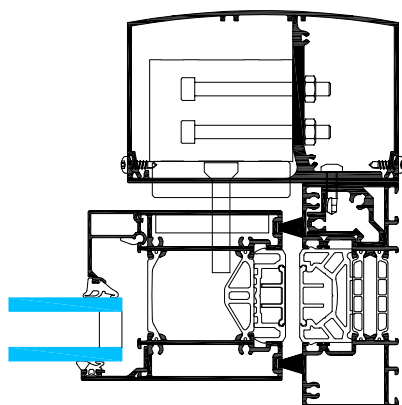

Integrated electro magnetic lock

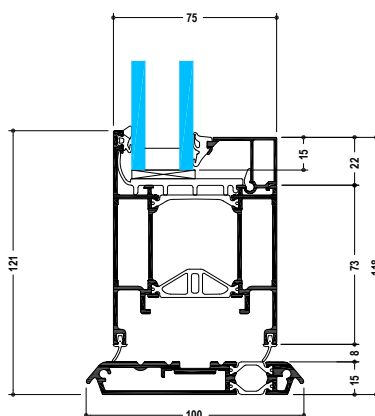

Low threshold 15 mm

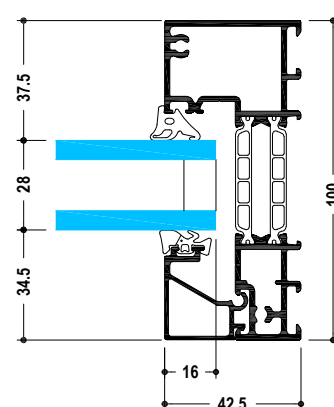

Open rebate for glass up to 51 mm

# ↗ SLIDING &

TIGAL - CONFORT SMARTLINE - AMBIAL





# FOLDING



# SLIDER TIGAL

## PULL-SLIDE DOOR

### ➤ THE HYBRID SLIDER

TIGAL has all the benefits of a sliding door with the high-performance of a window. With multi-point locking around the perimeter and patented water-tightness, the vent operates by moving inwards 6mm perpendicularly and then sliding in parallel with the fixed frame.



### AESTHETICS AND DESIGN

- Concealed Hardware
- Concealed Drainage
- Innovative micro-ventilation system
- Patented central sealing system guarantees exceptional water tightness
- EXCLUSIVE handle collection
- Full RAL colour palette

### LARGE DIMENSIONS

- Up to 2.7m in height
- Glazing thickness up to 52mm
- Vent weight per sash up to 300kg

### APPLICATIONS

- Visible or concealed opening
- Integration with TENTAL Facade

### SAFETY AND ACCESSIBILITY

- Recessed threshold offers accessible access of 15mm high with no decline in performance
- Burglary Resistance up to RC2 & PAS-24 certified
- Full Perimeter Locking

### SUSTAINABILITY

- Available in Hydro CIRCAL®, aluminium made with a minimum of 75% recycled end-of-life aluminium. This aluminium has one of the lowest CO<sub>2</sub> footprints worldwide: 1.9 kg of CO<sub>2</sub>/kg aluminium.
- Dynamic EPD available on TechDesign





## PERFORMANCES (according to EN standards)

Air permeability: Class 4
Water tightness: E1200
Wind pressure resistance: - Class 5
Burglary resistance: RC2 & PAS24
Impact resistance:
Thermal performance: - $U_w$ up to $0.85 \text{ W/m}^2$ ( $U_g$ : $0.5 \text{ W/m}^2\text{K}$ ) triple glazing, concealed opening $TL_w = 0.63$ , $S_w = 0.51$ 1 leaf + fixed, L x H = 2.30 x 2.18
Acoustic performance: - $RA_{tr}$ : 40 dB sound attenuation, double glazing 50 mm: 88.2 Si / 20 / 66.2 Si - Micro-ventilation position: $RA_{tr} = 20 \text{ dB}$ attenuation

## APPLICATIONS

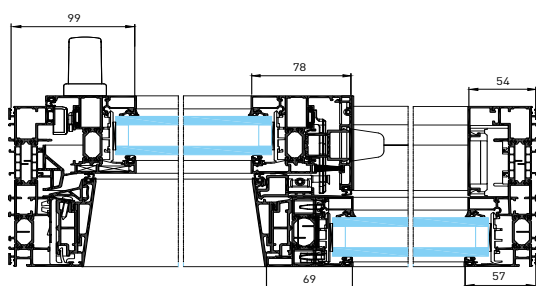

Horizontal section - 1 leaf & fixed

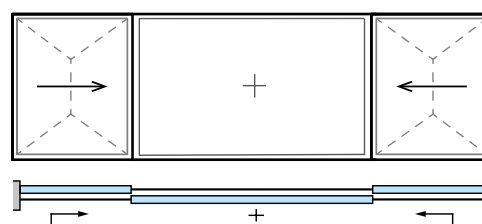

2 leaves & 1 fixed

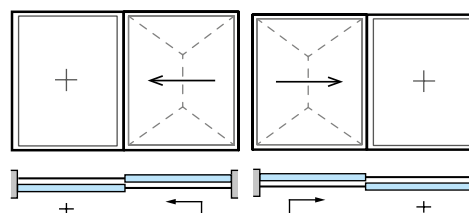

1 leaf & 1 fixed

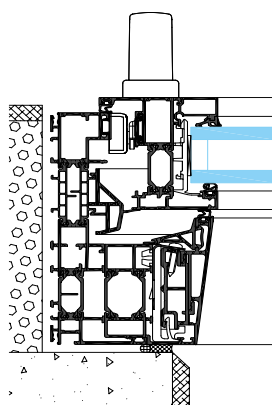

Horizontal section -  
concealed opening

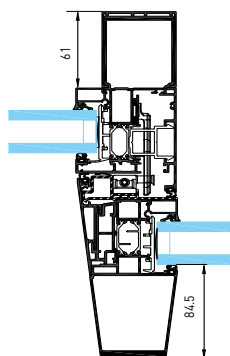

Reinforced Interlock

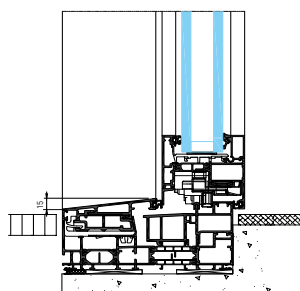

Vertical Section -  
leaf section, low threshold



# SLIDER

# CONFORT

# SMARTLINE

LIFT-SLIDE DOOR

## THE MINIMAL SLIDER

The Confort Smartline Slider is an optimised, high-performing sliding door with a slim sightline. Combining an attractive aesthetic line with remarkable energy-efficiency, design innovation and technical performance are both addressed.

### AESTHETICS AND DESIGN

- Patented Slim 35mm interlock
- 1, 2 & 3 rail options
- 3 Thermal levels
- Innovative reverse locking system
- EXCLUSIVE handle collection
- Full RAL colour palette

### LARGE DIMENSIONS

- Up to 2.8m in height
- Glazing thickness up to 53mm
- Vent weight per sash up to 330kg

### APPLICATIONS

- Fixed slide
- Slide slide
- Bi parting option
- Open corner solution

### SAFETY AND ACCESSIBILITY

- Recessed threshold offers accessible access of 15mm high with no decline in performance
- Burglary Resistance up to RC2 & PAS-24 certified
- Full Perimeter Locking

### SUSTAINABILITY

- Available in Hydro CIRCAL®, aluminium made with a minimum of 75% recycled end-of-life aluminium. This aluminium has one of the lowest CO<sub>2</sub> footprints worldwide: 1.9 kg of CO<sub>2</sub>/kg aluminium.
- Dynamic EPD available on TechDesign



## PERFORMANCES (according to EN standards)

Air permeability: 600 Pa

Water tightness: E900

Wind pressure resistance:

- Class 3

Burglary resistance: RC2 & PAS24

Thermal performance:

- Confort Smartline Basic:

- Uf up to 1.88 W/m<sup>2</sup>K for 1 rail
- Uf up to 2.64 W/m<sup>2</sup>K for 2 rail slide version

- Confort Smartline SI

- Uf up to 1.75 W/m<sup>2</sup>K for 1 rail
- Uf up to 2.59 W/m<sup>2</sup>K for 2 rail slide version

- Confort Smartline SHI

- Uf up to 1.40 W/m<sup>2</sup>K for 1 rail
- Uf up to 2.48 W/m<sup>2</sup>K for 2 rail slide version



TECHNAL®

SLIDER  
CONFORT SMARTLINE

## APPLICATIONS

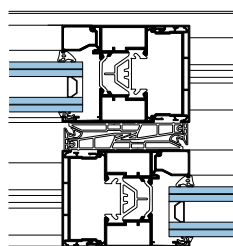
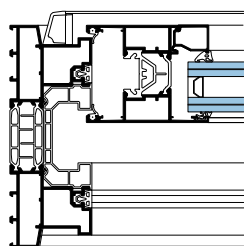

Confort Smartline Basic

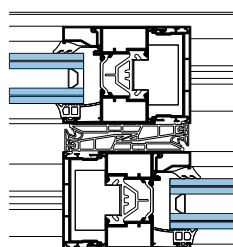
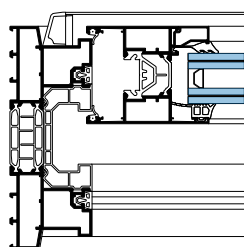

Confort Smartline SI

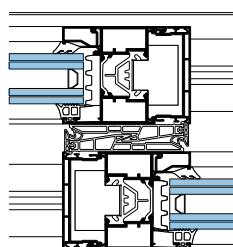
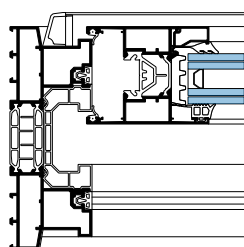

Confort Smartline SHI

SLIDING VERSION, 1-RAIL

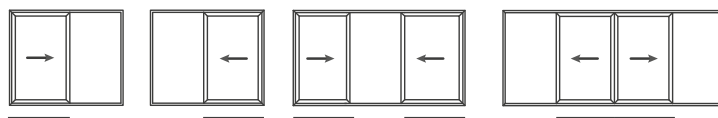

SLIDING VERSION, 2-RAIL

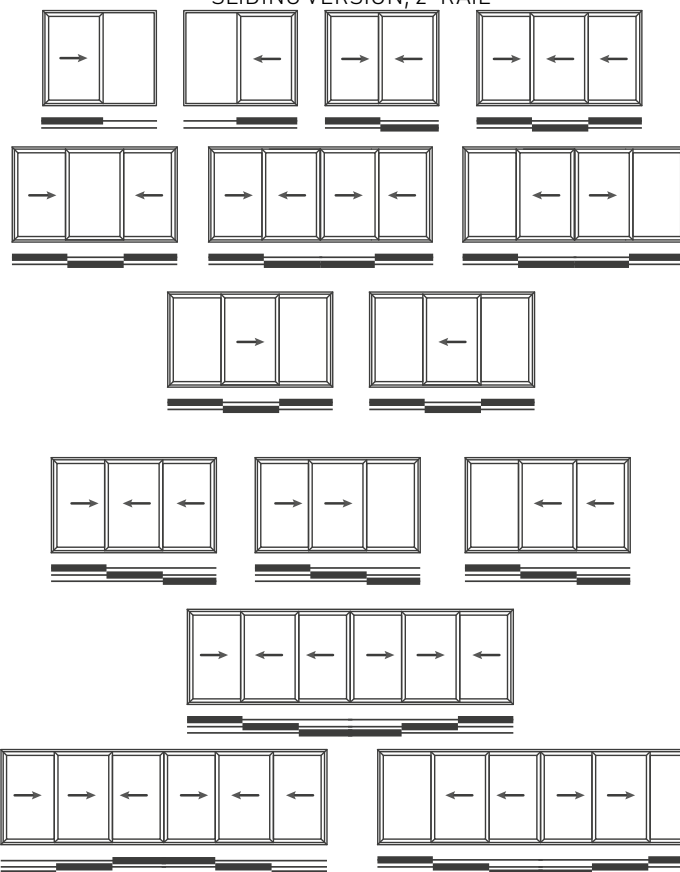

Sliding version, 3-rail



# FOLDING AMBIAL

## FOLDING DOOR

### ➤ THE DURABLE FOLDING DOOR

Designed to be durable and easy to use, AMBIAL can support up to 10-leaf configurations to blur the boundaries between inside and out.



### AESTHETICS AND COMFORT

- Wide choice of configurations including 1 - 10 leaf, straight or open corner, inward or outward opening from the centre or one of the sides
- Flush appearance in closed position
- Concealed drainage in all applications
- Ultra-flat handle and key design
- Pull handle mounted on hinges or support for ease of closure

### LARGE DIMENSIONS

- 75mm frame width
- 2 vent heights:
  - 63mm standard version
  - 73mm reinforced version for larger dimensions
- Maximum dimensions: WxH 1200 x 3000m per leaf
- Maximum vent weight of 150kg

### SAFETY AND ACCESSIBILITY

- 3-point locking system with insulated key
- Threshold:
  - Standard double brush
  - Flush mounted rebate for lifetime homes and disabled access
  - Threshold with rebate for improved weather performance

### SUSTAINABILITY

- Cradle to Cradle® under certification
- Available in Hydro CIRCAL®, aluminium made with a minimum of 75% recycled end-of-life aluminium. This aluminium has one of the lowest CO<sub>2</sub> footprints worldwide: 1.9 kg of CO<sub>2</sub>/kg aluminium.
- Dynamic EPD available on TechDesign





## PERFORMANCES (according to EN standards)

Air permeability: Class 4
Water tightness: Class 8A
Wind pressure resistance: Class C3
Operational Force: Class 1 (less than 100 N)
Mechanical Strength: Class 3
Thermal performance: - $U_w = 0.95 \text{ W/m}^2\text{K}$ - $U_g = 0.5 \text{ W/m}^2\text{K}$
Acoustic performance: Up to 43dB

## APPLICATIONS

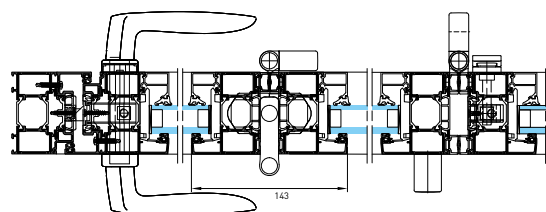

3 leaves  
outward opening

### FOLDING

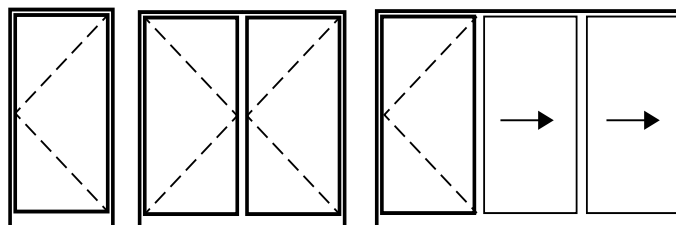

From 1 to 10 leaves, inward or outward opening with identical configuration

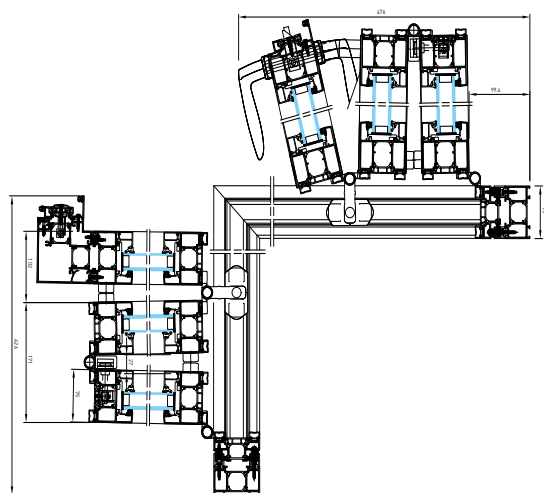

3x3 leaves  
outward opening in corner

### CORNER SOLUTION

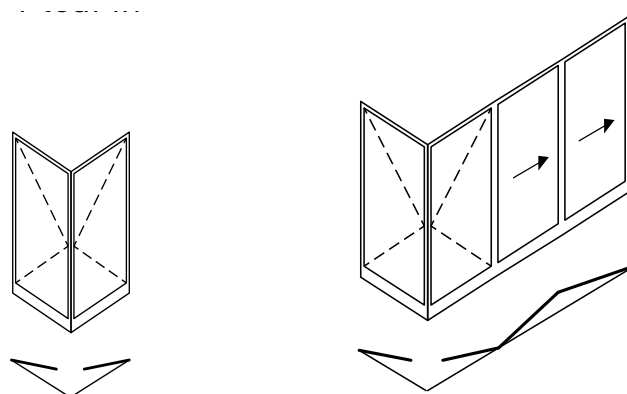

From 2 to 10 leaves in corner solution, inward or outward opening with identical configuration



TECHNAL®

FOLDING  
AMBIAL



## LESS IMPACT

➤ IMAGINE BEYOND LIMITS

The building and construction sector represents 39% of global energy-related carbon emissions.

The carbon footprint of a building is made of two stages:

**USE:** “operational” emissions caused by heating, cooling and powering buildings &

**CONSTRUCTION:** “upfront” emissions caused by materials extraction and production, delivery, waste management...

We go beyond materials to provide you with high-performance and circular products which contribute to reducing the carbon emissions caused in the **use** phase of a building.

At the same time, we go beyond products to focus on upfront emissions, contributing to the reduction of carbon emissions during both the **production and construction** phase of your project.





# COMMITMENT AND SUSTAINABILITY

## ➤ DRIVING DECARBONISATION PATHWAY

TECHNAL demonstrates our strong commitment to the environment in all areas: by using recycled and low-carbon materials, with a product design that is adapted to a circular economy, and produced within a responsible supply chain. In addition, these statements are certified by external organisations to ensure maximum transparency.

### HYDRO CIRCAL®

We are demonstrating our focus on sustainability by using Hydro CIRCAL® for our system solutions, one of the most sustainable aluminium alloys in our sector. Hydro CIRCAL® is a range of prime quality aluminium made with a minimum of 75% recycled end-of-life aluminium (post-consumer scrap). Hydro CIRCAL® also has **one of the smallest CO<sup>2</sup> footprint worldwide: 1.9 kg CO<sup>2</sup> per kg of aluminium** – an 85% reduction vs the world global primary average.

We are also able to offer Hydro CIRCAL® 100R in project specific cases. **Containing 100% post-consumer recycled, end-of-life material, this alloy has a CO<sup>2</sup> footprint of just 0.5 kg CO<sup>2</sup> per kg of aluminium.**

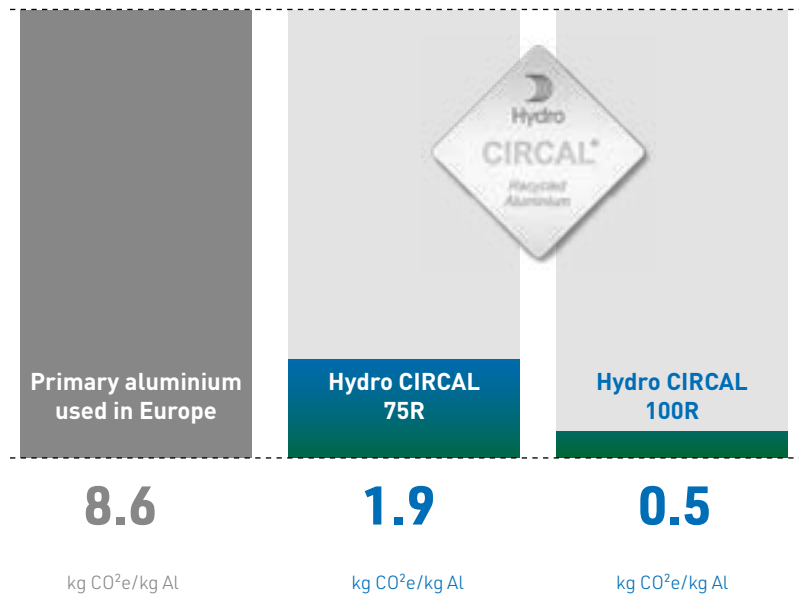

### OUR CERTIFICATIONS



Tental 60 has been certified Cradle to Cradle silver.



100% of our extrusion plants are ASI Performance Standard Certified.



Thanks to TechDesign, it's possible to generate a dynamic EPD according specified dimensions, applications and with any type of glazing.







## 75% RECYCLED AND 95% RECYCLABLE CONTENT

Following our path to the certified circular economy, all of our systems are made with a majority of materials and components that can be infinitely recycled. These also come from raw materials that are recyclable, or are components that can be reused at the end of the building's lifecycle.

In rough figures, we're talking about 75% recycled content and 95% recyclable content. It's an efficient way to drastically reduce the environmental impact

of materials on the life cycle of a building. Finally, our greener approach goes a step further thanks to the recycled thermal strips used in our 75 mm modules.

By closing the loop on projects, we are able to work alongside the key players in the industry and collect material from old windows, doors and facades. This is then reintegrated into our supply chain and sorted and remelted into new products.

## TARGET 2025 VS 2018: REDUCE OUR COMPANY CO<sub>2</sub> EMISSIONS BY 50%

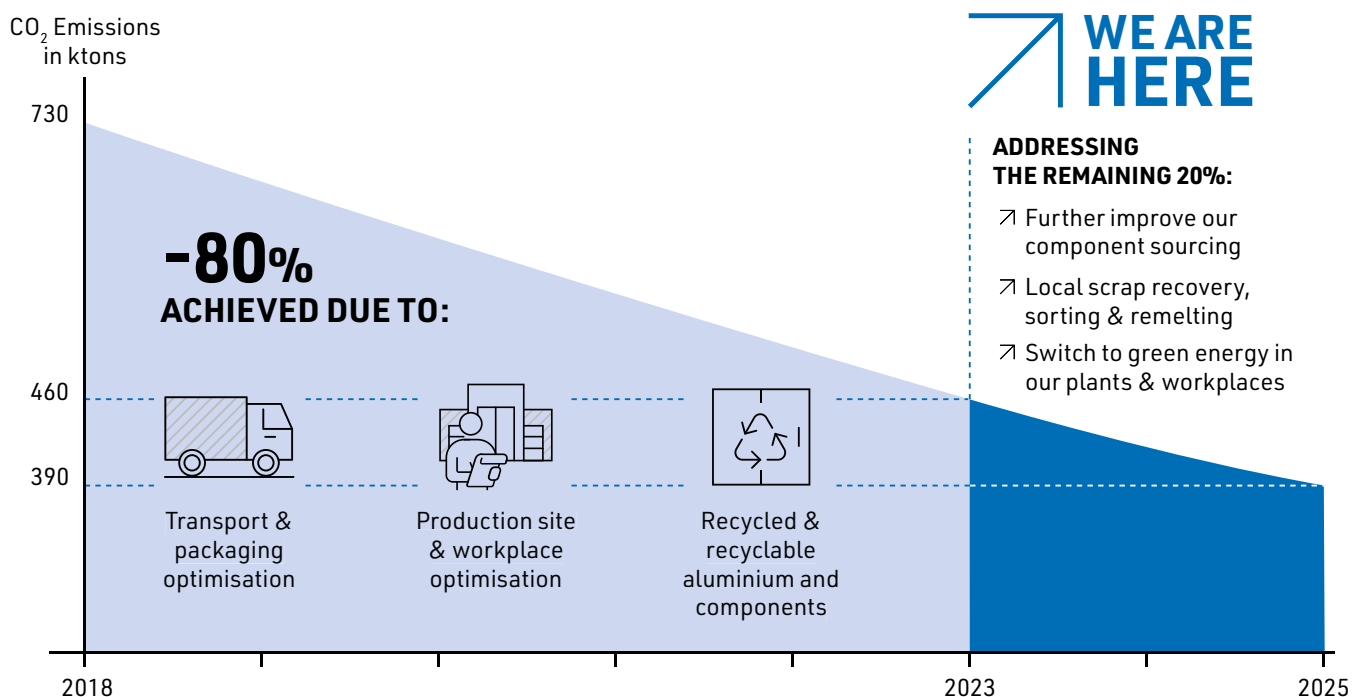



IMAGINE WHAT'S NEXT

Head Office  
Severn Drive, Tewkesbury  
Gloucestershire  
GL20 8SF

Tel+44 1684 853500

Northern Office  
Cedar Court Office Park,  
Denby Dale Road, Wakefield  
WF4 3FU

[info.uk@hydro.com](mailto:info.uk@hydro.com)

London Office  
The Building Centre  
26 Store Street, London  
WC1E 7BT

[www.technal.co.uk](http://www.technal.co.uk)

