

HeartFelt® Baffles

Create Atmosphere - Control Sound

MODULAR FELT CEILING SYSTEM



Project: Agristo office, Belgium
Product: HeartFelt® Baffles

CONTENT

HeartFelt® Baffles	3
Product Properties	4
Colours	5
Installation	6
Hunter Douglas Architectural	7

HeartFelt® Baffles

Inspirational Design

Baffles ceilings have long been recognised as a system that can transform the spatial design, atmosphere and acoustic performance of a space. Following the introduction of our successful product HeartFelt®, Hunter Douglas Architectural developed a new ceiling concept with the range of HeartFelt® Baffles.

This exciting combination of proven ceiling elements provides designers and architects with a bold flexible ceiling in a material that is sustainable, has a tough structure, soft appearance and great acoustic properties.

Create Atmosphere - Control Sound

HeartFelt® Baffles will create atmosphere in almost any interior space and at the same time significantly reduce the acoustic energy that reverberates in a ceiling void. They are suited for a range of environments including offices, meeting rooms, auditoriums, retail spaces or any space where airborne sound needs to be controlled.

HeartFelt® as a modular baffle ceiling provides the designer a variety of choices to create elegant lines and eye-catching designs across large ceilings. Baffles can add visual appeal and underscore the magnitude of open spaces, and even create design gestures that aid with wayfinding.

HeartFelt® in a nutshell

- **Modular felt baffle ceiling**
- **5 shades of grey and 5 earth tones**
- **Easily reusable or 100% recyclable**
- **Easy to maintain: dirt and dust resistant**
- **Cradle to Cradle Certified™ Bronze**

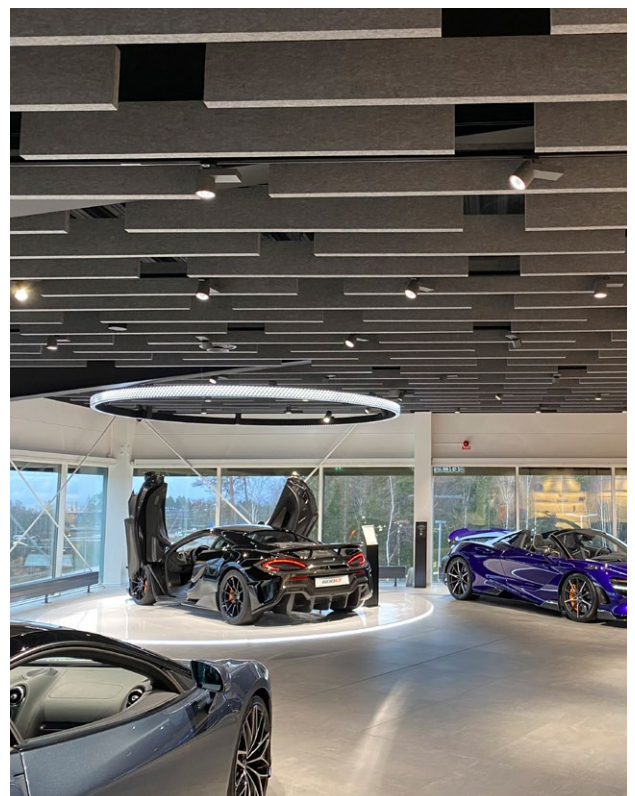

*Project above and cover: Mc Laren Showroom Stockholm, Sweden
Product: HeartFelt® Baffles*



Project: Architect office TOA HR, France - Product: HeartFelt® Baffles

Product properties

Stunning Acoustics

There is a natural synergy between baffle ceiling systems and HeartFelt® material that make the development of HeartFelt® Baffles so appealing to designers. Baffle ceilings are ideal for mitigating noise pollution and reverberating sound in most building sectors. Excellent acoustic absorption values, lightweight system and ease of installation make HeartFelt® Baffles a truly winning combination.



Project: Anthura office, The Netherlands
Product: HeartFelt® Baffles

Create amazing spaces

HeartFelt® Baffles measure 40 to 80 mm in width, between 100 - 500 mm in height and can be specified in lengths up to 2000 mm. These new baffle dimensions and modular options give the architect tremendous flexibility to allow sound absorption to be controlled in virtually any interior space.

The carrier system allows for variations in the modules and colours, enabling the designer to create a truly creative ceiling space for its occupants to look up to.

Sustainability at its core

HeartFelt® Baffles are produced from non-woven, thermoformed PES fibres and have a Cradle to Cradle bronze certificate. No painting or coating of the material is involved, making the baffles 100% recyclable and reusable. The carrier rail system is produced from steel and is together with the steel fixing clips 100% recyclable.

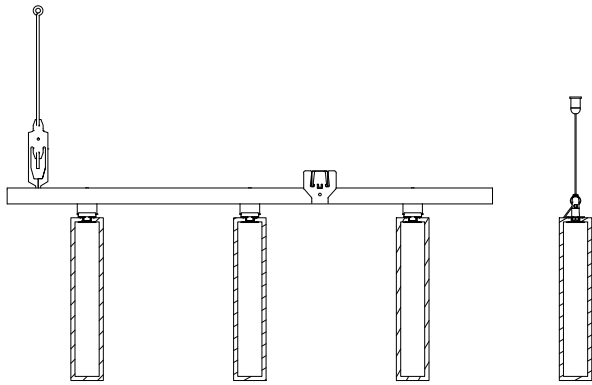

Hunter Douglas Architectural's HeartFelt® Baffle ceiling system offers the designer a multitude of options.

A free design service is available to help designers combine different widths, heights and colours at fixed modulation.

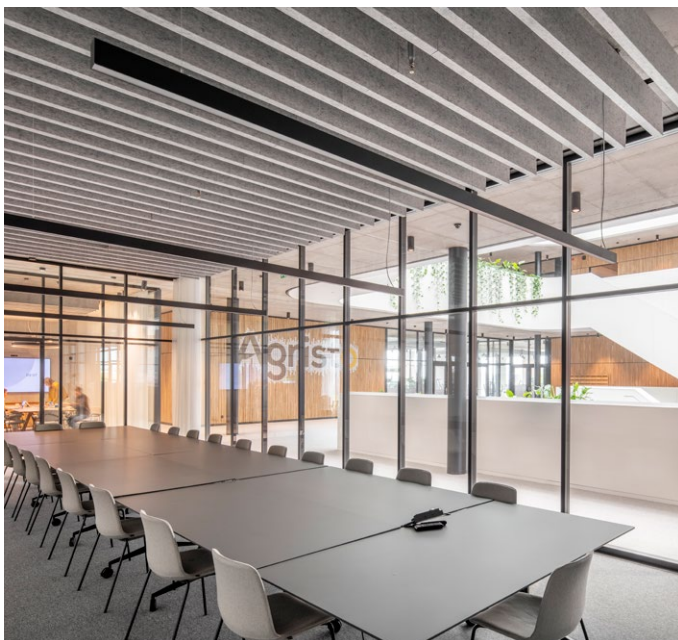

Project: Agristo office, Belgium
Product: HeartFelt® Baffles

Colours

HeartFelt® Baffle ceiling systems are available in five shades of grey, ranging from white to black and in five earth tones. The proportion of the white, black and coloured PES fibres determines the colour of the panels.

SHADES OF GREY

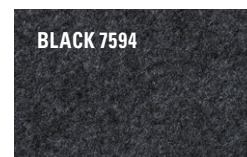
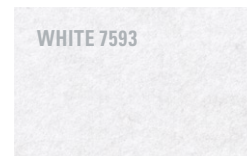

EARTH TONES

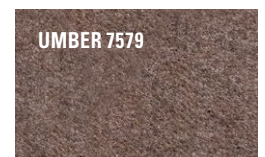
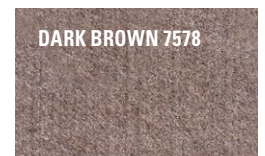
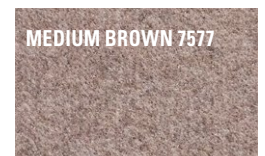
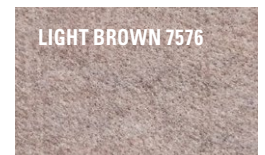
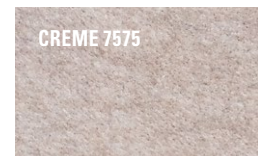

Installation

HeartFelt® Baffles are attached to our combi carrier rail system. Each felt panel is attached with a steel clip that clicks into the carrier rail. Panels are then locked into place using a sliding clip on each connection with the carrier rail. The individual baffles are assembled on site.

Joining and finishing

The individual baffles can be joined using a splice. There are 2 options for the baffle ends:

- 1 No end cap
- 2 Separate end cap



Integrated technology

The HeartFelt® baffles modular nature makes it easy to integrate building systems such as lighting, ventilation and fire safety systems.

Suspension

The carrier rail system is made of coated steel and consists of steel clips and sliding clips that connect securely to the carrier rail.

Layout options

Baffle ceilings can be used to help with orientation and wayfinding or simply to add drama to the ceiling.

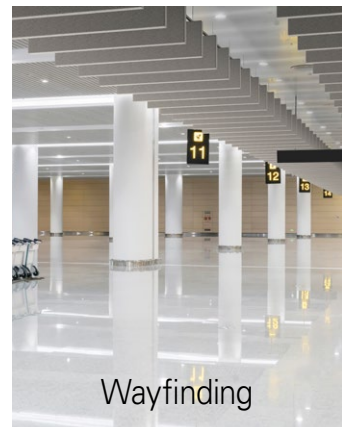

C2C certification



- Cradle to Cradle Certified™ Bronze
- The product meets the 'Low' requirements for use in low-polluting buildings.

Cradle to Cradle Certified™ is a certification mark licensed by the Cradle to Cradle Products Innovation Institute.

Building certification

- Suitable for BREEAM and Leed

VOC emissions

- Indoor Air Comfort Gold
- VOC emissions class A+
- M1: approved
- French regulations for CMR substances: approved

Easy to maintain

HeartFelt®'s Baffle felt ceiling panels are easy to clean with a duster or vacuum cleaner.

Hunter Douglas is a global player within the field of modern architecture. We understand the conflict between form and function better than anyone, and enrich the market with inspiring solutions that strengthen the aesthetics of buildings and their functionality in terms of indoor climate, energy use and acoustics.



HEARTFELT® LINEAR ▲



HEARTFELT® PAREAULUX CLIMATE CEILING ▲



HEARTFELT® ORIGAMI PYRAMID ▲



HEARTFELT® ORIGAMI WEAVE ▲

Our felt ceilings offer outstanding acoustics and a unique appearance, ranging from linear ceiling panels and baffles to creative origami shapes, all in various sizes.



Hunter Douglas adopts the cradle to cradle (C2C) product philosophy to the design of products that fit the circular paradigm. They are designed for longevity, using materially healthy technical nutrients that can be reused at end of life as a high-quality source for something new.

Cradle to Cradle Certified™ is a certification mark licensed by the Cradle to Cradle Products Innovation Institute.



All steel products are 100% recyclable at the end of their lifecycle.



All aluminium products are 100% recyclable at the end of their lifecycle.

Architectural services

We support our business partners with a wide range of technical consulting and support services for architects and installers. We assist architects and developers with recommendations for materials, shapes, dimensions, colours and finishes.

We also help creating design proposals, visualisations and installation drawings. Our services to installers range from providing detailed installation drawings and instructions to training installers and advising on the building site.

More information

Contact our **Project Support** for further help and advice on the design possibilities our applications can create.

Call us:
+44 (0)1604 648 229

Send us an e-mail:
info@hunterdouglas.co.uk

Visit our website:
www.hunterdouglas.co.uk

ASIA | AUSTRALIA | LATIN AMERICA | NORTH AMERICA

Austria
Belgium
Bulgaria
Croatia / Slovenia
Czech Republic
Denmark
Finland

France
Germany
Greece
Hungary
Israel
Italy
The Netherlands

Norway
Poland
Portugal
Romania
Serbia
Slovakia
Spain

Sweden
Switzerland
Turkey
United Kingdom
South Africa
Middle East

CEILINGS



WALLS



SUN LOUVRES



FAÇADES



HUNTER DOUGLAS ARCHITECTURAL UNITED KINGDOM

Suite 2, Newton House, Northampton Science Park
Kings Park Road, Moulton Park Industrial Estate
Northampton, NN3 6LG
Tel: +44 (0)1604 648 229
info@hunterdouglas.co.uk
www.hunterdouglas.co.uk