

# Cavity Trays for Door and Window Openings

Tailor-made cavity tray systems for all types of door/window arches and circular windows

## Use

- Around the opening of an external door or window with an arched top or a circular external window
- On external walls - built from brick, block or stone as well as timber frame constructions - of any thickness and any cavity width

## Features and Benefits

- One piece seamless mouldings eliminate the need for site fabrication to prevent errors through poor workmanship
- Tailor-made to order - manufactured to suit exact customer requirements with delivery to site usually within 10-14 working days
- Any size, type or radius of curve can be fabricated
- Can be supplied in two or more sections to allow adjustment on site and easily compensate for building tolerances
- Easy to handle, flexible, tough, durable and puncture resistant
- Fully compatible with all Timloc DPC and cavity tray systems
- Can be used for multi-storey or high loading applications - will not extrude under loads up to the point of compressive failure of wall
- Wide range of standard components with special, tailor-made accessories also readily available

## Quality

- Satisfies all NHBC requirements
- Manufactured to BS EN ISO 9001 and BS EN ISO 14001
- Complies with all relevant Building Regulations
- Meets all relevant British Standards

## Material and Colour Choice

- All products are vacuum formed in 2.0mm thick medium density polyethylene
- Available in black only

## Installation Advice

- Under normal circumstances the arch and bullseye cavity tray is positioned so that the upstand fits between the door/window frame and the external brickwork. After installation the upstand can be trimmed back flush with the frame and sealed with exterior mastic in the normal way
- Weep holes must be provided at the base of the arch cavity tray at both sides of the opening. These can be formed by installing a purpose made Timloc plastic wall weep unit (product 1143/Invisiweep)
- When the arch and bullseye cavity tray is supplied in two or more sections, each section fits to the next by means of a lapped joint that is sealed with butyl mastic tape. Surfaces must be clean and dry otherwise a good seal will not be formed
- Arch and bullseye cavity trays are usually supplied with an integral flap which builds in to the inner leaf to ensure it is held securely in position. If building-in is not possible. e.g. with a timber frame construction, the cavity tray flap should be mechanically fixed to the inner leaf.

Contact Timloc Technical department for installation guidance.

## How to Order

Arch cavity trays are made to order, so please supply full construction details. Ideally these will include a fully dimensioned drawing showing door/window opening size and wall construction details. If this is not possible the minimum information required is:

- Thickness of outer leaf and cavity width
- Clear opening width and height of door/window opening
- Radius of curvature
- Position of spring line
- With this data Timloc will be able to produce and despatch a dimensioned drawing for your approval.

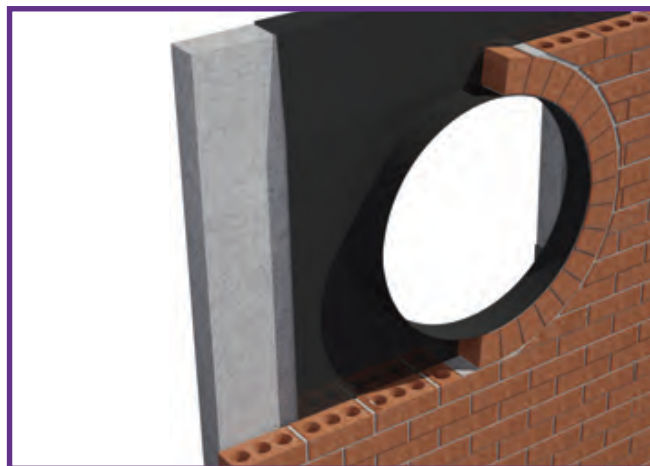
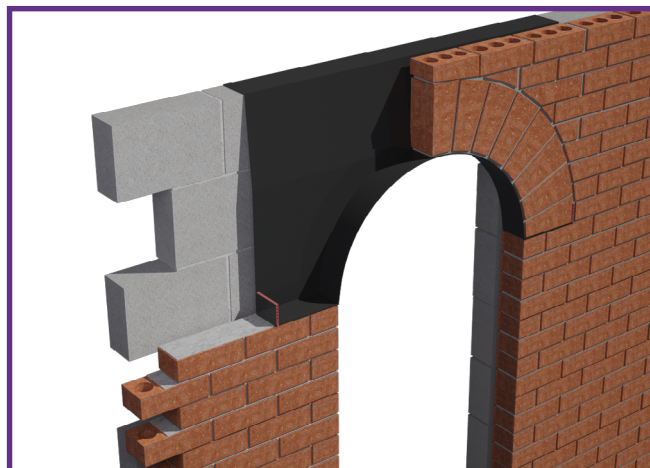

## Bill of Quantity

F30 Accessories/sundry items for brick/block/stone walling  
Clause

385 | PREFORMED DPC / CAVITY TRAY JUNCTION CLOAKS / STOPENDS

- Manufacturer: Timloc Building Products, Timloc House, Ozone Park, Howden, East Yorkshire, DN14 7SD. T: 01405 765567, W: [www.timloc.co.uk](http://www.timloc.co.uk)
- Type(s) and location(s): Preformed Arch Cavity Tray to be positioned directly over external arch window features/lintels.
- Seal all laps with dpc and/or cavity trays using adhesive/mastic in accordance with manufacturers recommendations to ensure a fully watertight installation.
- Reference: SPA Arch Dpc Cavity Tray
- Diameter: Types & sizes as shown on drawings/window schedule.

## Bill of Quantity

F30 Accessories/sundry items for brick/block/stone walling  
Clause

385 PREFORMED DPC / CAVITY TRAY JUNCTION CLOAKS / STOPENDS

- Manufacturer: Timloc Building Products, Timloc House, Ozone Park, Howden, East Yorkshire, DN14 7SD. T: 01405 765567, W: [www.timloc.co.uk](http://www.timloc.co.uk)
- Type(s) and location(s): Preformed Circular Cavity Tray to be positioned directly around external circular window features/lintels.
- Seal all laps with dpc and/or cavity trays using adhesive/mastic in accordance with manufacturers recommendations to ensure a fully watertight installation.
- Reference: SPB Bullseye Dpc Cavity Tray
- Diameter: Types & sizes as shown on drawings/window schedule.