

60-Minute Fire-Rated Party Wall Cavity Stop Sock Masonry-Masonry

Use

- To restrict the spread of smoke and flames within timber-masonry cavity walls
- To provide a cavity barrier at party wall junctions
- To minimise heat loss and the effect of flanking noise pollution through the cavity wall

Features and Benefits

- PWFRSTOP cavity stop socks comprise a length of non-combustible mineral wool insulation sleeved in a polythene outer layer for on-site weather protection
- 60-minute fire integrity and insulation performance
- Sized to cover a maximum party wall
- Available to suit cavity widths from 50mm up to 300mm

Quality

- Complies with Building regulations Approved Document B and Robust Detail part E
- Independently tested by Warringtonfire in accordance with EN1366-4 principles
- Satisfies NHBC technical requirements
- Manufactured using mineral wool insulation classified as Euroclass A1 for fire according to BS EN 13501-1
- Mineral Wool Insulation is compliant with BS EN 13162 Thermal insulation products for buildings, ISO 50001 Energy Management Systems, ISO 14001 Environmental Management Systems and ISO 9001 Quality Management Systems
- The product contains no CFCs, HCFCs or other ozone-depleting substances

Material and Colour

- The thermal conductivity of the Mineral wool insulation is 0.037 W/mK
- Supplied in 1200mm lengths
- For individual product colours refer to the product code table

Bill of Quantity

Uniclass: Pr_25_80_81_51 Mineral wool fire-stopping

CAWS: P12/360 Mineral wool rigid batts | P12/40 Mineral wool rigid batts

- Manufacturer: Timloc Building Products, Timloc House, Ozone Park, Howden, East Yorks. DN14 7SD. T: 01405 765 567 W: www.timloc.co.uk
- Reference: PWFRSTOP
- Types(s) and location(s): Thermal and acoustic fire stops to be installed vertically and horizontally as work proceeds. Position at party wall to cavity wall junctions or at floor level. Supplied in 1200mm lengths and butt jointed.
- Colour: Yellow, Blue, Green, Red

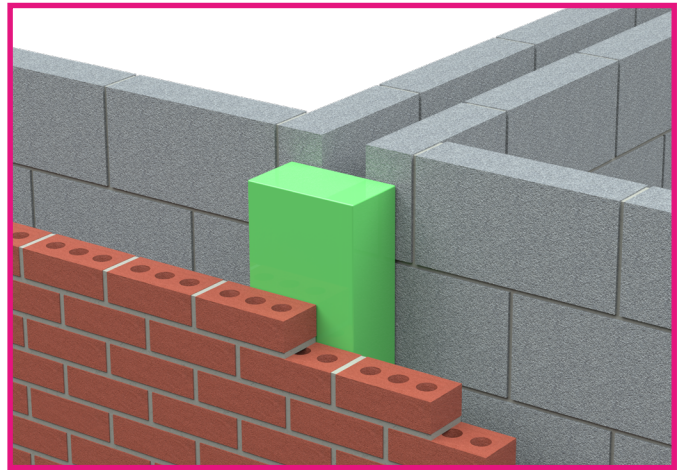

PWFRSTOP Vertical Installation

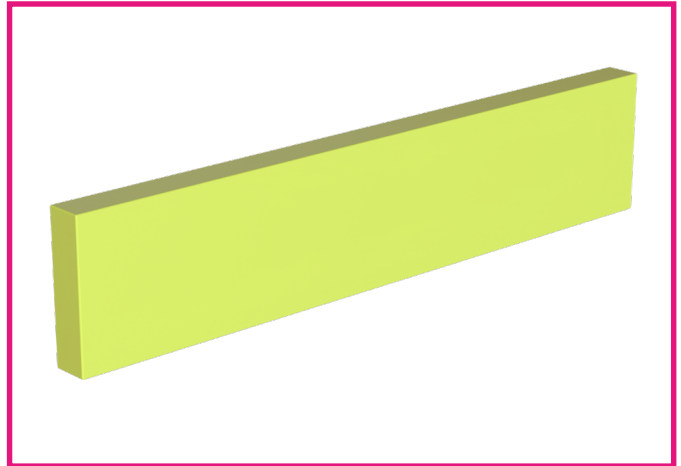

PWFRSTOP50

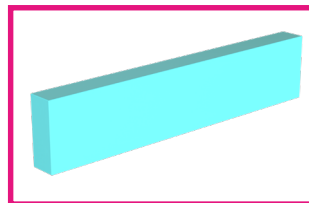

PWFRSTOP65-100

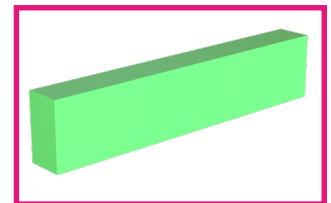

PWFRSTOP115-140

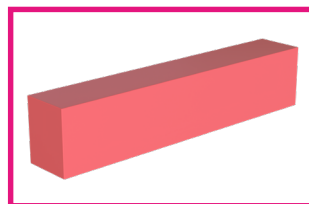

PWFRSTOP150-200

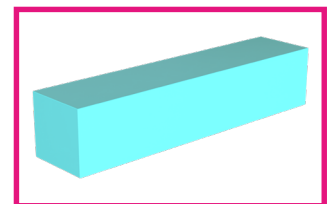

PWFRSTOP210-300

How to Order

- PWFRSTOP available in pallet quantities only

To calculate required quantities:

- Divide the overall length of the cavity wall run (measured in mm) by 1200mm
- Allow one additional length for each corner for trimming
- Determine and specify the cavity width that the product needs to fit into

Product Codes

Product Code	To Suit Cavity Width	Dimensions	Minimum Compression	Bag Colour	Pallet Quantity	Lead Time
PWFRSTOP50	50mm	65 x 250 x 1200mm	15mm	Yellow	80	3-5 working days
PWFRSTOP65	51-65mm	85 x 250 x 1200mm	20mm	Blue	60	3-5 working days
PWFRSTOP75	66-75mm	85 x 250 x 1200mm	10mm	Blue	60	3-5 working days
PWFRSTOP85	76-85mm	100 x 250 x 1200mm	15mm	Blue	68	3-5 working days
PWFRSTOP90	86-90mm	100 x 250 x 1200mm	10mm	Blue	68	3-5 working days
PWFRSTOP100	91-100mm	110 x 250 x 1200mm	10mm	Blue	60	3-5 working days
PWFRSTOP115	101-115mm	130 x 250 x 1200mm	15mm	Green	52	3-5 working days
PWFRSTOP125	116-125mm	140 x 250 x 1200mm	15mm	Green	48	3-5 working days
PWFRSTOP130	126-130mm	150 x 250 x 1200mm	20mm	Green	48	3-5 working days
PWFRSTOP140	131-140mm	160 x 250 x 1200mm	20mm	Green	44	3-5 working days
PWFRSTOP150	141-150mm	160 x 250 x 1200mm	10mm	Red	40	3-5 working days
PWFRSTOP160	151-160mm	185 x 250 x 1200mm	25mm	Red	36	3-5 working days
PWFRSTOP170	161-170mm	195 x 250 x 1200mm	25mm	Red	32	3-5 working days
PWFRSTOP180	171-180mm	200 x 250 x 1200mm	20mm	Red	32	3-5 working days
PWFRSTOP190	181-190mm	210 x 250 x 1200mm	20mm	Red	32	3-5 working days
PWFRSTOP200	191-200mm	220 x 250 x 1200mm	15mm	Red	28	3-5 working days
PWFRSTOP210	201-210mm	230 x 250 x 1200mm	20mm	Blue	28	3-5 working days
PWFRSTOP220	211-220mm	240 x 250 x 1200mm	20mm	Blue	28	3-5 working days
PWFRSTOP230	221-230mm	250 x 250 x 1200mm	20mm	Blue	24	3-5 working days
PWFRSTOP240	231-240mm	260 x 250 x 1200mm	20mm	Blue	24	3-5 working days
PWFRSTOP250	241-250mm	270 x 250 x 1200mm	20mm	Blue	24	3-5 working days
PWFRSTOP260	251-260mm	280 x 250 x 1200mm	20mm	Blue	24	3-5 working days
PWFRSTOP270	261-270mm	290 x 250 x 1200mm	20mm	Blue	24	3-5 working days
PWFRSTOP280	271-280mm	300 x 250 x 1200mm	20mm	Blue	20	3-5 working days
PWFRSTOP290	281-290mm	310 x 250 x 1200mm	20mm	Blue	20	3-5 working days
PWFRSTOP300	291-300mm	320 x 250 x 1200mm	20mm	Blue	20	3-5 working days

*Pallet quantities may vary slightly from the values stated above. Contact Timloc Sales for confirmation.