

Plastic Access Panels

The answer to unsightly controls and fittings

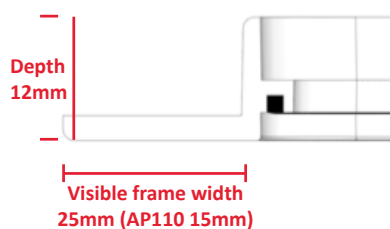

Can be used to provide access in ceilings

*excludes AP450 & AP450KL



Use

- Cost effective yet reliable and simple method for providing access to services and connections behind dry lined walls, ducts, ceilings (exc. AP450 and AP450KL) and cupboard units
- An ideal solution for meeting the gas safety industry and Building Regulation Part J's concealed boiler blue inspection access requirements (non-fire rated applications)

Features and Benefits

- Purpose made product saves time and money compared with traditional joiner-made or steel access doors
- Excellent aesthetic appearance and finish
- Textured finish allows painting if required
- Visible picture frame surround smartly conceals cut out edges and contributes to a faster installation
- Universal door handing
- Flush fitting door panel can be fully removed for maximum access
- Installed in minutes using basic hand tools and silicon/flexible sealant
- Catch clip closing mechanism across the range as standard
- Key lock options available
- Acoustic performance of 26dB

Quality

- Manufactured to BS EN ISO 9001 and BS EN ISO 14001
- Helps to meet Building Regulation document Part J (2010 edition)

Material and Colour Choice

- Tough and UV stabilised injection moulded HIPS plastic
- White finish

Installation Advice

- Cut hole to size, making sure that it is straight and level
- Apply silicon or other suitable grade building adhesive to the back of the frame
- Check which way that you want the door to hinge
- Press the frame firmly into place, checking it is straight and level
- Do not operate until the adhesive has set completely
- To open the door, use a screw driver in the slot and lever up (Fig. 1)
- To remove the door, open the door slightly (Fig 2.) and pull away from the hinge position maintaining the door at a slight angle (Fig. 3). This does not apply to panels AP110 and AP200 which are clip fit door panels
- To replace the door, reverse the removal process

Care and Maintenance

- Clean using a soft cloth with a mild detergent

How to Order

- State which size of panel is required and confirm the frame fitting size
- State if the key lock option is required

Bill of Quantity

L20 Doors/Shutters/Hatches

Clause

630^A HATCHES

- Manufacturer: Timloc Building Products, Timloc House, Ozone Park, Howden, East Yorkshire, DN14 7SD. T: 01405 765567 W: www.timloc.co.uk
- Type: Plastic access panels
- Product code: AP300 (see other product codes/variations of sizes)
- Frame fitting size: 305 x 305mm
- Application: Wall, ceiling or voids
- Frame type: Picture
- Colour: Textured white HIPS plastic

Product Codes

| Frame Fitting Size | Clear Opening Size | Overall Panel & Frame Size | Door Type | Key Lock | Product Codes |
|--------------------|--------------------|----------------------------|-----------|----------|---------------|
| 115 x 165mm | 100 x 150mm | 135 x 185mm | Clip fit | N/A | AP110 |
| 155 x 235mm | 140 x 220mm | 195 x 275mm | Hinged | N/A | AP150 |
| 205 x 205mm | 190 x 190mm | 245 x 245mm | Clip fit | N/A | AP200 |
| 305 x 305mm | 290 x 290mm | 345 x 345mm | Hinged | N/A | AP300 |
| 470 x 470mm | 455 x 455mm | 510 x 510mm | Hinged | N/A | AP450* |
| 155 x 235mm | 140 x 220mm | 195 x 275mm | Hinged | Yes | AP150KL |
| 305 x 305mm | 290 x 290mm | 345 x 345mm | Hinged | Yes | AP300KL |
| 470 x 470mm | 455 x 455mm | 510 x 510mm | Hinged | Yes | AP450KL* |

*Not suitable for ceiling installations

AP150

Fig.1

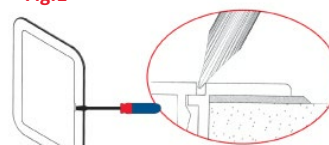
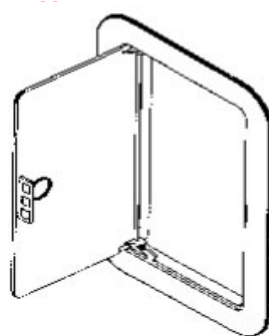

Fig.2



Fig.3

