

FOAMGLAS[®] PC[®] 58

Bitumen Cold Adhesive

Product Data Sheet

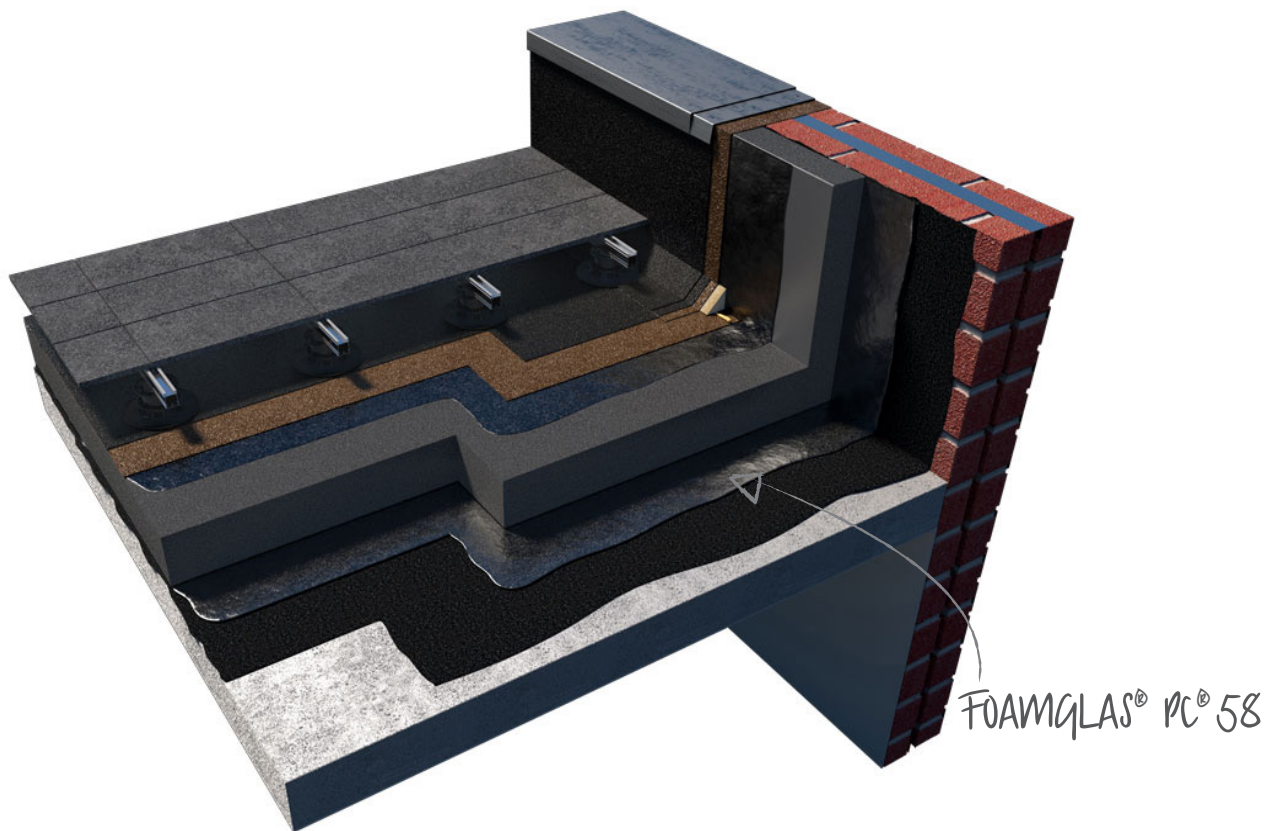

FOAMGLAS® PC® 58

Bitumen Cold Adhesive

General Information

FOAMGLAS® PC® 58 is a two-component modified bitumen based cold adhesive without solvents.

It is used as an adhesive and as a coating. After complete drying, the adhesive is flexible and resistant to numerous salty solutions, water and weak acids. PC® 58 is used to apply FOAMGLAS® slabs to horizontal concrete and porous concrete surfaces. It is also used to coat the surface of FOAMGLAS® slabs; prior to the application of bitumen based torch-on or self-adhesive membranes.

Processing

Pre-treatment of the subsurface

The substrate must be clean, dry and free from grease, dust, oil and humidity. A primer coat of PC® EM (diluted 1 to 10) is required on the substrate. Alternatively use a diluted liquid component of the PC® 58 (diluting rate 1 vol. part of the liquid component, which must be diluted with 10 parts of water).

Preparing the glue or contact layer

To avoid waste and to maintain the desired properties, certain basic rules should be observed:

- Setting and pot time are influenced by the temperature (typically approx. 15-20 mins).
- Application temperature + 5 °C to + 35 °C.
- Have water and solvent ready to clean the tools.
- Mix the whole quantity of adhesive in the PC® 58 container
- The powder component must be continuously added in the stated ratio to the liquid component and carefully stirred while using an electric or pneumatic mixer (750 W, idle run 500 to 1000 r/min) until a homogenous and lump-free mixture is achieved.
- PC® 58 must be poured out of the container onto the substrate and spread with a rubber squeegee over the width of the FOAMGLAS® materials being laid, approx 600mm.
- Dip the edges of the FOAMGLAS® slabs in PC® 58 to ensure the edges are fully coated.
- Lay the FOAMGLAS® slab in the PC® 58 adhesive at a distance of approx. 10 cm from the already installed slabs and push diagonally into the open corner so that the joints are completely filled with adhesive and butted up tightly.
- To use as a surface coating; pour the mixed PC® 58 on the installed FOAMGLAS® slabs and spread over the surface with a rubber scraper. Note: Curing time at 20 °C and 65 % relative humidity is approx 90 min, after which the PC® 58 will shed water.
- After complete drying of the surface coating, a bitumen membrane waterproofing can be torched on. Make sure that the flame uses the bitumen mass of the membrane for adhering. A direct flaming on the coating has to be avoided. Alternatively a self-adhesive, cold applied, or hot melt membrane may be applied with a suitable and recommended primer.

Cleaning the tools

If the adhesive is still fresh, clean with water; if it is already dry, use white spirit.

Product Safety Notice

All material safety data sheets (MSDS) are available. They aim to ensure a safe handling of the product and correct disposal by the customer.

FOAMGLAS® PC® 58

Bitumen Cold Adhesive

Type of delivery and storage

Container with 28 kg (net content) – consisting of 21 kg of bitumen emulsion and 7 kg of powder component.

- Store in a cool and dry place in well-sealed packages.
- Protect from heat and direct sunlight.
- Protect from frost.

See label for date of expiry

Consumption

As bonding layer: approx. 5 – 7 kg/m²

As scratch coat: approx. 2 kg/m²

These quantities must be considered as guide values; they depend on the subsurface properties, the thickness of the insulation material, the dimensions of the FOAMGLAS® Materials, the application and the site conditions, etc.

DECLARED PERFORMANCE

Type	Two-component adhesive, hydraulically setting
Basis	Component A: Bitumen emulsion Component B: calcium silicates, calcium aluminate, calcium aluminate ferrit
Consistency	Pasty
Service temperature	- 15 °C to + 45 °C on non-frozen subsurface
Application temperature (air + subsurface)	+ 5 °C to + 35 °C
Application time	At 20 °C: approx. 90 mins
Surface drying time	Approx. 3 hours
Depth drying time	1 to 3 days
Mass density	Approx. 1.20 kg/dm ³
Colour	Black/brown
Water vapour diffusion resistance number	μ = approx. 25,000
Water solubility	Mixable
Solvent	None
Reaction to fire (EN 13501-1)	E
VOC	-
Giscode	BBP 10

The physical properties indicated above are average values, which are measured under typical conditions. These values may be influenced by insufficient mixing, the type of laying, the layer thickness and the atmospheric conditions during and after application. In particular drying times are affected by temperature, air humidity, sun irradiation, wind, etc.

This information given in good faith and is based on the latest knowledge available to Radmat Building products Ltd. Whilst every effort has been made to ensure that the contents of the publication are current while going to press, customers are advised that products, techniques and codes of practice are under constant review and liable to change without notice.

For further information on Radmat products and services please call **01858 410372**, email technquiries@radmat.com or visit our website www.radmat.com

OCT 23