

ParaFlex Polyester Fleece G165/G225

Product Data Sheet

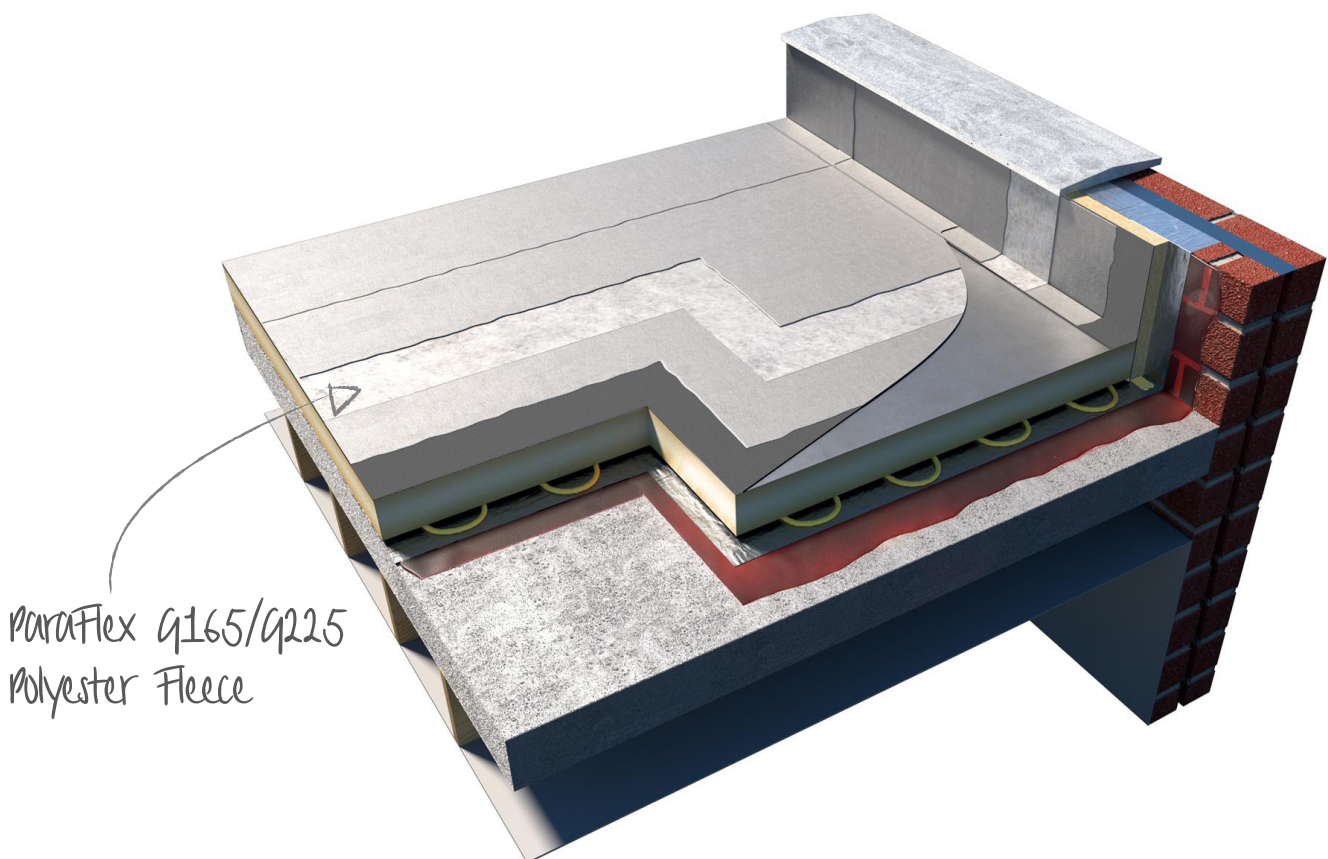

ParaFlex

Polyester Fleece G165/G225

General Information

ParaFlex Polyester Fleece is a special polyester mesh fabric that helps regulate layer thickness of the ParaFlex FD Liquid Applied Waterproofing Membranes and improves the cured breaking strength.

The sewn-in polyester mesh provides good directional stability, ensuring no changes in length occur during application and cuts can be prepared with precision.

In addition to its excellent technical properties, ParaFlex polyester mesh fabric is quickly and completely impregnation capacity during use, enabling it to fit tightly at upstands and transitions.

Directions of application

Unroll into first layer of ParaFlex FD Liquid Applied Waterproofing Membrane on flat areas prior to application of 2nd coat.

Saturate prior to application on upstands.

Curing time

ParaFlex FD can be applied after approx. 15 - 60 minutes (depending on temperature).

Consumption

Approx. 300 - 500 g/m² depending on porosity of the substrate.

Delivery conditions

Delivery form

Roll length 50 m

Widths in cm: 10/15/20/25/30/35/50/70/105.

Declared Performance

ESSENTIAL CHARACTERISTICS GI65	PERFORMANCE	UNIT
Density / specific weight	165	g/m ²
Maximum tensile force longitudinal	1250	N/5 cm
Maximum tensile force transverse	900	N/5 cm
Strain – longitudinal	25	%
Strain transverse	35	%

Declared Performance

ESSENTIAL CHARACTERISTICS G225	PERFORMANCE	UNIT
Density / specific weight	225	g/m ²
Maximum tensile force longitudinal	1250	N/5 cm
Maximum tensile force transverse	1000	N/5 cm
Strain - longitudinal	25	%
Strain - transverse	35	%

This information given in good faith and is based on the latest knowledge available to Radmat Building products Ltd. Whilst every effort has been made to ensure that the contents of the publication are current while going to press, customers are advised that products, techniques and codes of practice are under constant review and liable to change without notice.

For further information on Radmat products and services please call **01858 410372**, email techenquiries@radmat.com or visit our website www.radmat.com

FEB 23