

oasis

GLASS VERANDA



INSTALLATION GUIDE

Issue 1

CONTENTS

1.	Introduction	2
2.	Safety precautions and warnings	2
3.	Product description	3
4.	Parts overview	4-6
5.	Preparation for assembly	7-12
6.	Assembly	13-32
7.	Maintenance	33
8.	Disposal of waste	33
9.	Guarantee	33
10.	Contact	33

If in doubt at any stage

Please contact our Customer Care Team for additional support or advice



0333 321 2353

eurocell

INTRODUCTION

Congratulations on the purchase of your Eurocell patio roof!

Before you can start enjoying your patio roof it must be assembled properly. This manual provides clear instructions for all the steps you must complete for correct assembly of your Eurocell patio roof. We recommend that you take the time to read the entire manual before you begin assembly. Check whether you have received all the necessary parts before you begin assembly. For your safety, follow all the applicable instructions. This also guarantees the safety of the installed roof. If you should have any questions, please feel free to contact your Eurocell dealer.

This manual should be kept in a safe, dry and shady place. In the event of damage or loss, the user must request a new copy of the manual from the supplier.

SAFETY PRECAUTIONS AND WARNINGS

Important:

Please read the safety precautions and warnings before assembling the patio roof.

- ▶ During assembly, carefully follow the instructions and guidelines as described in this manual. Never change the order of the steps to be performed. If any aspect of the assembly procedure is unclear, please contact your Eurocell dealer. We reserve the right to make technical changes without written notice.
- ▶ We normally recommend that the patio roof be installed by two people (qualified technicians/authorized installers) working together.
- ▶ Check the delivery immediately upon receipt. In the event of damage or an incomplete delivery please contact your dealer immediately.
- ▶ The materials must be stored in a dry, ventilated area, not exposed to direct sunlight.
- ▶ Open the packaging carefully. Make sure you do not damage the product.
- ▶ To prevent damage to your patio roof, place the parts on a soft, clean, flat surface. Never place the glass panels directly on the ground! Laminated glass is easily scratched. Make sure it does not get scratched. Be particularly careful with the edges and corners of the glass panels.
- ▶ **Never** stand on the glass panels.
- ▶ The addition or removal of parts, or the use or installation of materials other than in the prescribed manner, may adversely affect the safety of the patio roof and is therefore strongly discouraged!
- ▶ Cordon off the assembly location so that others are kept at a distance.
- ▶ Always wear the correct protective clothing (work gloves, dust mask, safety glasses, shoes with non-slip soles, etc.) when performing the work.
- ▶ Always place a ladder on a firm, stable surface.
- ▶ Mount the system against a firm, flat wall and on a flat, stable foundation or stone surface. Ensure that wall and ground are clean and dry.
- ▶ Make sure all fasteners are properly tightened. Check this regularly.
- ▶ Make sure you have caulked the patio roof so it is completely waterproof.
- ▶ You must maintain and clean your patio roof at least once a year.
- ▶ Use plenty of water, soft material and a sponge for cleaning. Use only neutral cleansers. No acids or alkalis. Solvents (washing-up liquid and glass cleaner) can be used for removing greasy contamination.
- ▶ Dispose of the product in accordance with local laws and regulations.
- ▶ Eurocell accepts no liability for damage or injury caused by failure to strictly follow the safety regulations and instructions in this manual or exercise due caution during assembly, use and maintenance of the product and any related accessories. Eurocell is not responsible for any form of damage.

PRODUCT DESCRIPTION

The aluminium patio roof type Pigato is composed of posts, gutter profile, wall profile, rafters, glass panels, cover strips and the necessary assembly materials. The gutter is fitted with a 20x100mm steel strip to hold the glass panels. As standard, you have the choice between a round or traditional (Victorian style) decorative gutter and semicircular or square posts.

The Eurocell Pigato patio roof is available as standard in widths of 4060, 5060 or 6060 as a single section; there is no limit to the number of sections that can be joined end to end. The roof can have a length of 2500, 3000, 3500 or 4000mm (measured horizontally).

The glass panels are made of 44.2 laminated safety glass. These consist of two 4mm layers of non-tempered glass with two layers of transparent film between them. This film ensures that in the event of breakage the shards remain attached so there is no risk of injury.

Details

Gutter	Round or traditional
Posts	Semicircular or square
Colours	Cream (RAL9001) or Graphite grey, structure (RAL7024)
Roof covering	44.2 laminated clear glass
Width (mm)	4060/5060/6060 or a multiple thereof.
Length (mm)	2500/3000/3500/4000

A Eurocell patio roof can be installed on any existing foundation or stone surface. For added strength or when there is no good foundation present, foundation blocks can be used. These foundation blocks can be easily installed out of sight under the posts with the supplied bolts.

The foundation blocks are available with or without a rainwater discharge opening.

As an alternative to foundation blocks, ground screws can be used. This way there is no need to dig in the garden. These make installation faster and easier than foundation blocks. Your Eurocell dealer can provide you with more information about this.

4. PARTS OVERVIEW

4.1 EXPLODED VIEW

4.1

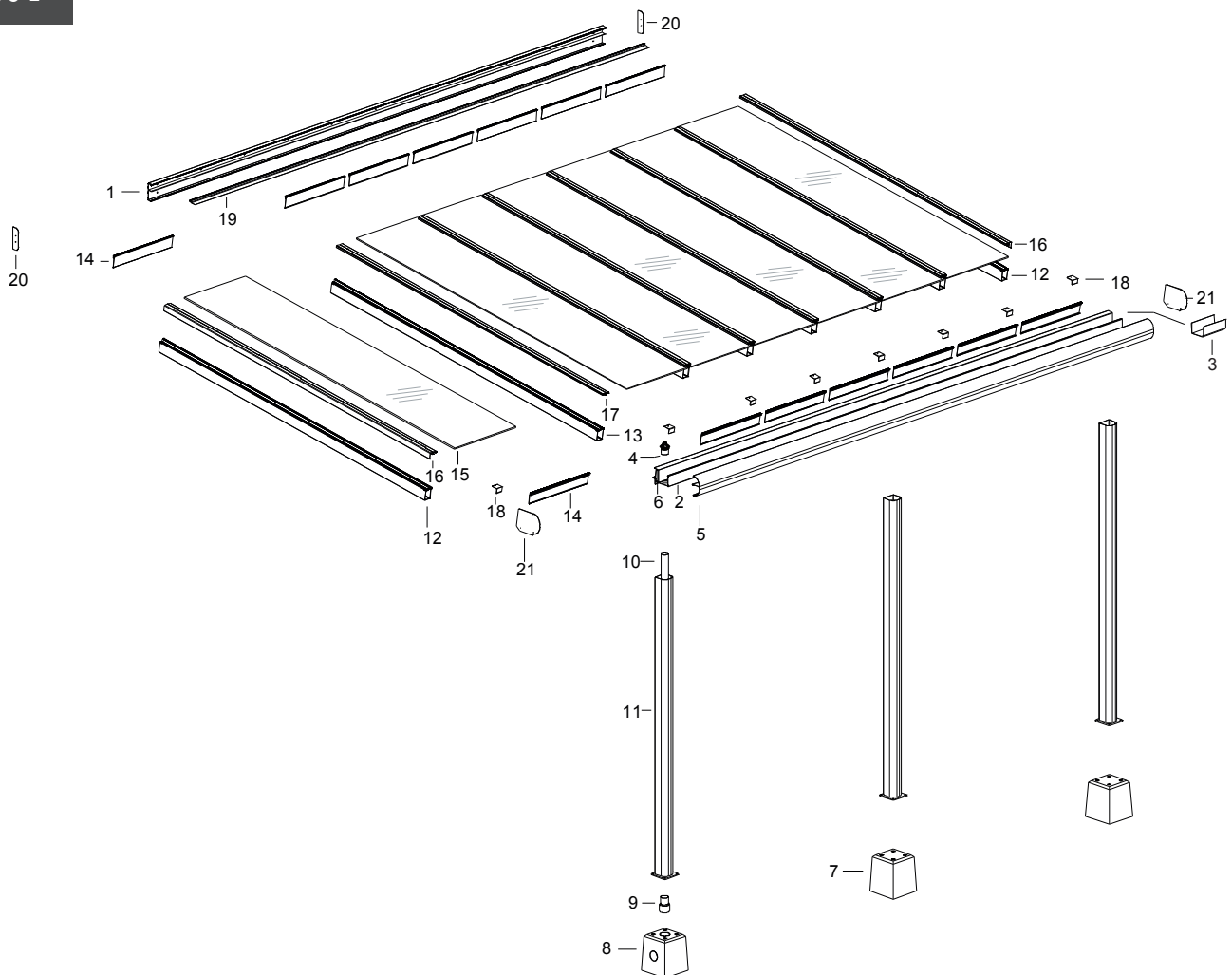

4.2

DELIVERY INSPECTION



The patio roof shown in this manual is a 5x3 metre Pigato with the posts on foundation blocks. This merely serves as an example. The type and number of components supplied depends on your order.

Note: Always carefully check the delivered items against the accompanying delivery note to ensure that the quantity and quality are correct. Any visible defects must be reported in writing within 7 days of delivery.

4.3 PARTS LIST

4.3

The following overview shows which parts are packed together. Carefully check the individual packaging units against the order form for quantity and quality.

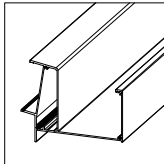

02. Gutter profile

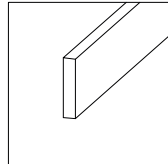

6. Steel strip
20x100 mm

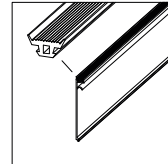

14. Trim click strip

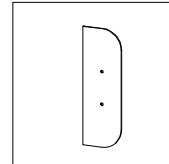

20. Trim cover
wall profile

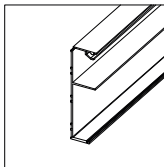

01. Wall profile

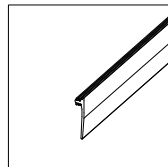

19. Wall profile
rubber

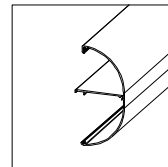

05. Round
decorative profile

or

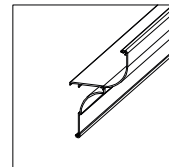

05A. Traditional
decorative

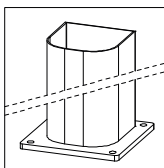

11. Post round
with or without base

or

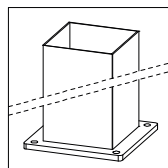

11A. Post square
with or without base

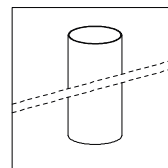

10. Rainwater
discharge
pipe $\varnothing 60$ mm

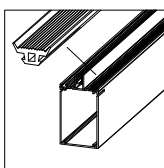

12. End rafter
1x sealing rubber

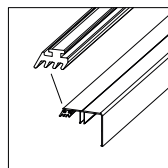

16. End cover strip
1x sealing rubber

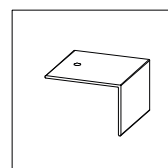

18. Sheet stopper

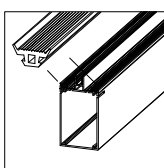

13. Middle rafter
2x sealing rubber

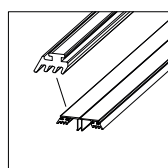

17. Top cover strip
2x sealing rubber

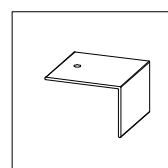

18. Sheet stopper

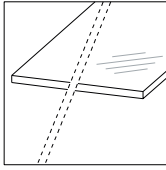

15. 44.2 laminated glass

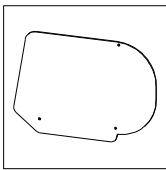

21. Trim cover gutter profile round

or

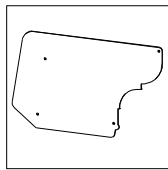

21A. Trim cover gutter profile traditional

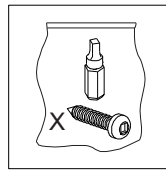

1x bag of screws short 4.2x16 + bit

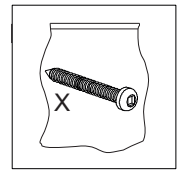

1x bag of screws long 4.2x40

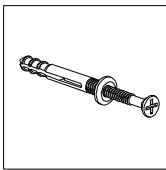

1x set frame fixing screws

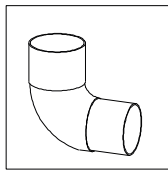

9. 90° rainwater discharge sleeve

or

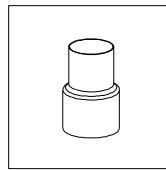

09A. Rainwater discharge sleeve Adapter 60-80 (option)

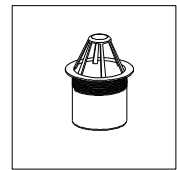

04. Leaf catcher 60mm

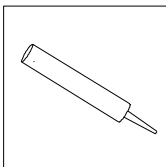

1x coloured caulk

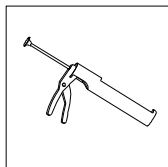

1x caulking gun

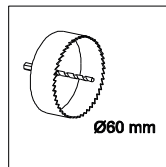

1x hole saw 60mm

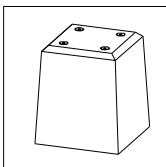

07. Foundation block

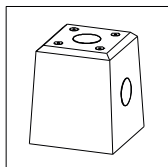

08. Foundation block with rainwater

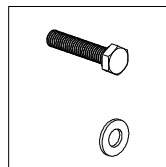

Hex bolt M8x40 Washer (Option at foundation block)

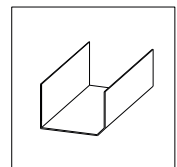

03. Gutter connector (Option)

5. PREPARATION FOR ASSEMBLY

5.1 CONDITIONS FOR ASSEMBLY

Note: The optimal processing temperature for the caulk is +5°C to +40°C.

Ground & façade

- ▶ A good flat stable surface is required for construction of the patio roof.
- ▶ The location where the roof will be placed must be construction-ready and free of obstacles (garden furniture, flower boxes, etc.) so installers can perform their work without hindrance.
- ▶ Any obstacles, including utility lines (such as power cables, etc.), roots and debris, must have been removed from the ground.
- ▶ The façade must be free of sun shades, etc.
- ▶ The place where the wall profile will be placed must be firm, even and flat.

Dimensions & slope

- ▶ A Eurocell roof should be installed with a slope of 120mm per metre. The height of the wall profile and the passage height (distance from bottom of gutter to the ground) are completely dependent on each other and determined by this slope.
- ▶ The maximum length of the roof is 4 metres. However, keep in mind the requirements concerning the maximum free span and number of posts.

Posts & joined patio roofs

- ▶ Maximum distance between the posts is 4 metres.
- ▶ When patio roofs are joined, a post is always placed under the coupling.
- ▶ The rainwater discharge cannot be placed inside a post above which gutters are joined.

Attachments at walls

- ▶ Due to expansion of the materials, the patio roof may not be placed tightly between two walls; there must be a gap of 1.5mm per metre of width of the patio roof.
- ▶ When foundation blocks are used the posts cannot be placed against the wall, because the block is wider than the post.
- ▶ If you want to place a post against a wall, you must saw the flange off of one side and drill two new holes in the flange so that you can secure the post in four places.

Screws and drilling

- ▶ Eurocell supplies special 4.2x19mm and 4.2x40mm stainless steel screws with the patio roof. **Note:** Pre-drill a hole for each screw with a 3mm drill bit! If you continue to turn them after they are tight, the screw head may break off. It is recommended that you screw carefully, with the torque limiter on your drill set properly.
- **Note:** Never drill and screw through the PVC rainwater discharge pipe in one of the posts.

Caulk

- ▶ Eurocell supplies caulk in the colours cream and graphite grey. This supplied caulk has been specially selected for the waterproof sealing of aluminium to aluminium or to most common construction materials, such as walls, concrete, etc. Follow the instructions on the tube.
- ▶ **Note:** This caulk is not suitable for sealing the polycarbonate sheets. If you need to seal your sheets, because you have a rainwater discharge (downspout) pipe run through it for example, we have special transparent caulk in our range. This caulk is available from retailers.

Rubber seals

- ▶ A Eurocell patio roof is standard equipped with pre-assembled, colour-matched rubber seals. Before installation, the rubber seals for both the aluminium cover strips and the rafters must be cut to length.
- ▶ If the rubber seals are deformed, they can be straightened again with a little heat, from a hot air heater or hair dryer for example.

Remove protective film

- ▶ It is recommended that the protective film be removed from the aluminium parts at the last possible moment, to prevent damage. During installation the protective film must be pulled back a few centimetres from the edge so the film does not get stuck in the profiles; otherwise it will be difficult to remove later.

Warranty is void if the Pigato patio roof is not assembled and installed in accordance with the instructions.

5.2 INSPECTION OF TOOLS AND ACCESSORIES

5.2

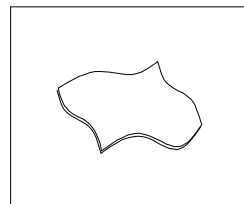
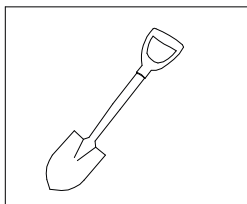
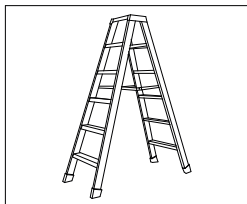
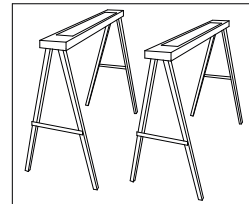
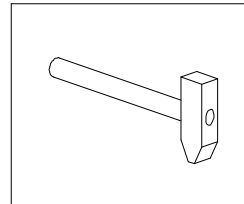
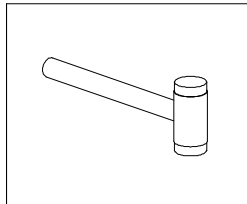
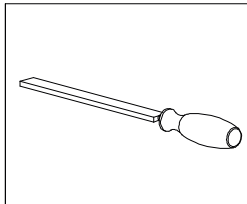
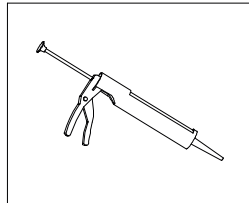
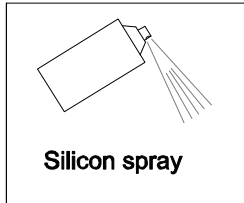
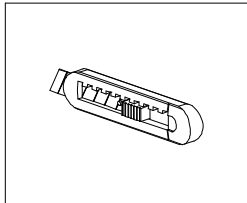
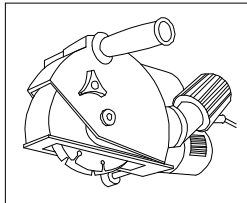
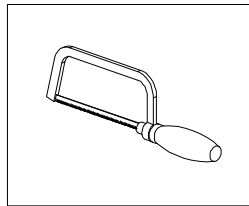
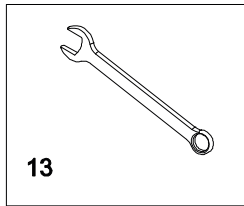
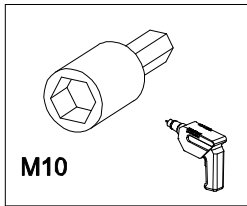
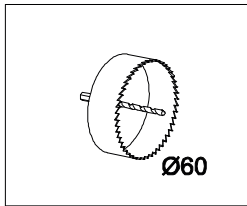
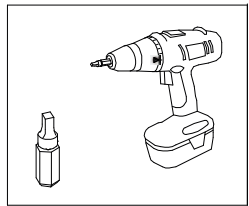
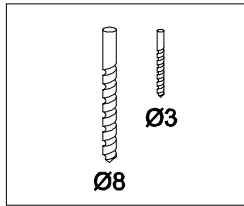
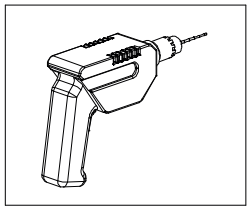
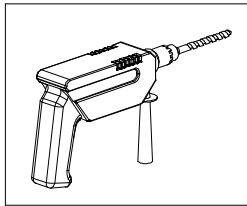
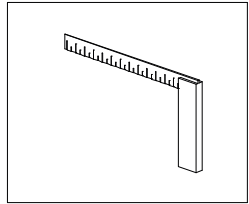
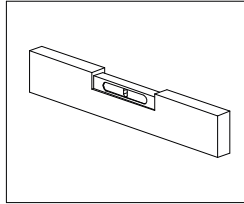
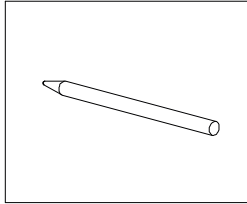
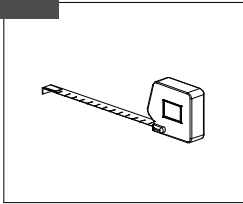

5.3 MEASURING & DETERMINING DIMENSIONS

5.3

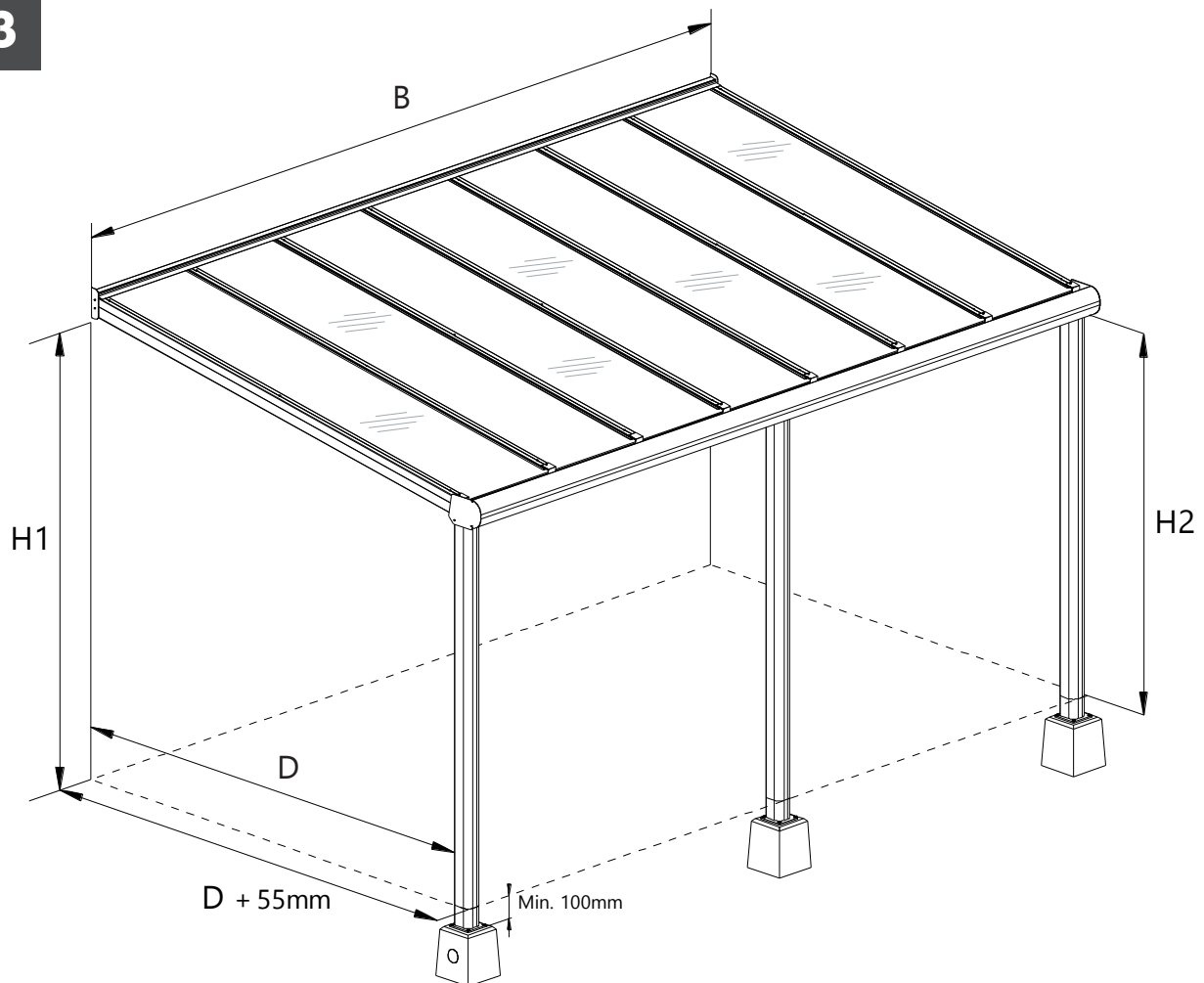

The Eurocell patio roof is available in a large range of sizes. Moreover, the roof has a modular design and can be quickly and easily made to size. However, please note that our current and future modular options are based on standard sizes. If you do not install your roof using the standard sizes, your options will also have to be adapted to size.

W:	Length of wall profile, gutter profile and decorative profile.
H1:	Height from ground to bottom of wall profile.
H2:	Height from ground to bottom of gutter profile (= passage height).
D:	Distance from back of wall profile to inside of post (= length).
D + 55mm:	Distance from back of wall profile to centre of rainwater discharge pipe.

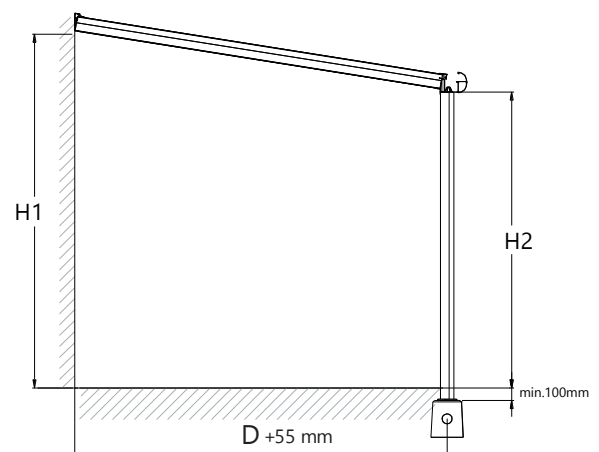

5.3.1 HEIGHT ADJUSTMENTS

A Eurocell patio roof is designed for a slope of 120mm per metre. All the static strength calculations, as well as all sizes and dimensions in this manual, are based on this. The height of the wall profile and the passage height (distance from bottom of gutter to the ground) are completely dependent on each other and determined by this slope. However, these heights can be adjusted very easily while maintaining the slope.

If you are going to install your patio roof based on the standard dimensions, you can use the dimension table below.

Horizontal roof length (L)	Height to bottom of gutter profile (H2)	Height to bottom of wall profile (H1)
2500mm	2500mm	2800mm
3000mm	2500mm	2860mm
3500mm	2500mm	2920mm
4000mm	2500mm	2980mm

If you choose to place the wall profile lower or make the passage height of the gutter lower, you must:

Subtract the same number of centimetres from both of these measurements. So if your wall profile is mounted 300mm lower, you must also shorten your posts by 300mm. If you want to reduce the passage height, you can easily shorten the length of the posts by making a square cut. However, you must then also mount the wall profile the same distance lower on the wall. The same applies if you decide to mount the wall profile lower on the wall.

Calculation example 1: You have a roof with a length of 3000mm and you want to reduce the standard passage height from 2500mm to 2200mm. You therefore shorten your posts by 300mm or you place the posts 300mm in the ground, so the bottom of your gutter is at a height of 2200mm. Your wall profile must therefore be lowered by 300mm, which means that the bottom of the wall profile must be placed at $2860\text{mm} - 300\text{mm} = 2560\text{mm}$.

Calculation example 2: You have a roof with a length of 4000mm and you want to place the standard wall profile 250mm lower on the wall, at 2730mm instead of 2980mm. You must therefore also place the bottom of the gutter profile 250mm lower, which means that you either have to cut 250mm off your posts, reducing their length to 2250mm ($2500\text{mm} - 250\text{mm}$) or you have to place your posts 250mm in the ground.

5.3.2 ROOF LENGTH

The total length of a Eurocell patio roof is measured from the back of the wall profile to the inside of the post.

5.4 JOINING PATIO ROOFS

There is no limit to the width in which the Eurocell patio roofs can be delivered. This is because the patio roofs can be joined end to end. In this case the gutter profile, wall profile and decorative profile are supplied in multiple lengths of 4060, 5060 or 6060mm. The centre-to-centre distance of the rafters, the number of sections and the glass width depend on the width of the Eurocell patio roof.

The dimensions are shown in the table below.

Dimensions width x length	Sections	C-to-C dimension rafters	Glass width
4060 x 2500	6	667	637
4060 x 3000	6	667	637
4060 x 3500	6	667	637
4060 x 4000	6	667	637
5060 x 2500	7	714	684
5060 x 3000	7	714	684
5060 x 3500	7	714	684
5060 x 4000	7	714	684
6060 x 2500	8	750	720
6060 x 3000	8	750	720
6060 x 3500	8	750	720
6060 x 4000	8	750	720

The centre-to-centre distance between the rafters of a Eurocell patio roof (5060 x 3000) is 714mm. A roof with seven 714mm sections has a total width of 5060mm. The extra 60mm is the distance from the centre of the rafter to the outside of the rafter, which is 30mm; this extra width is at both ends, for a total of 60mm.

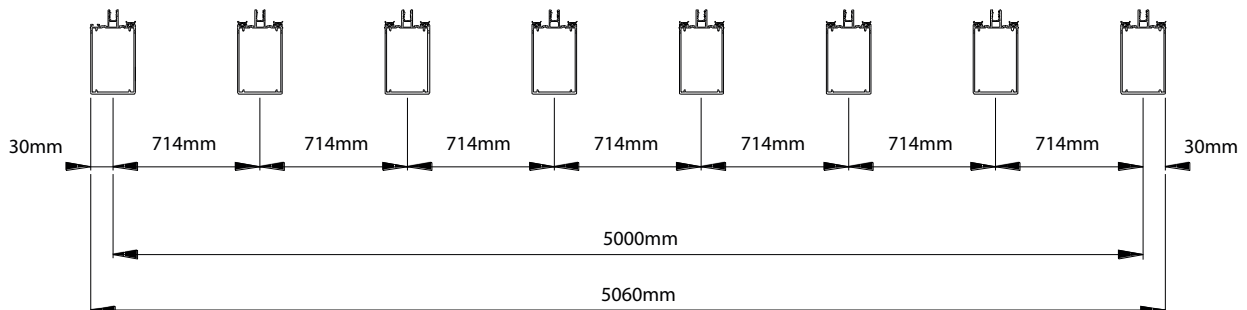

When standard size sheets are used, the total width of joined roofs must therefore also end with 60mm, e.g. 8060, 9060, 10060, etc. So if you have ordered a roof with a width of 9060mm, the delivery will consist of one 5060mm gutter section and one 4060mm gutter section. Together this is 9120mm. You must ensure that the width ends with xx60, so these profiles must be shortened by a total of 60mm before installation. This can be done by removing 30mm from both sections: 5030mm + 4030mm = 9060mm. You can also choose to shorten one profile by 60mm. 5060mm + 4000mm = 9060mm. This shortening applies to the wall profile, gutter profile and decorative profile.

After this shortening the further assembly is identical to that for a normal roof.

5.4 JOINING PATIO ROOFS (CONTINUED)

It is recommended that you join the gutter sections with the supplied gutter connector before installation. The installation steps are shown below:

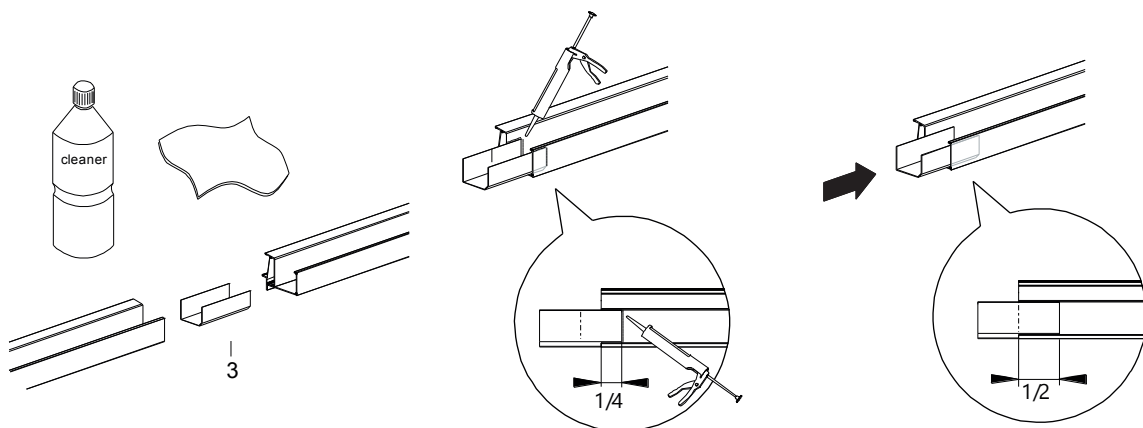
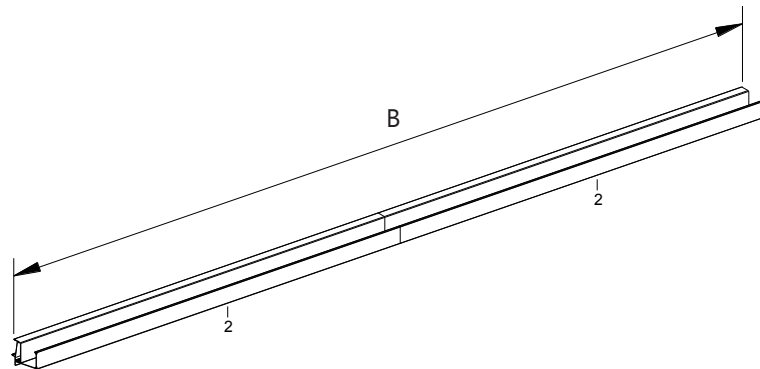

1. Clean and degrease the gutter and gutter connector.

2. Insert the gutter connector $\frac{1}{4}$ of the way into the gutter and silicone the inside edge.

3. Now press the gutter connector further until it is half way into the gutter.

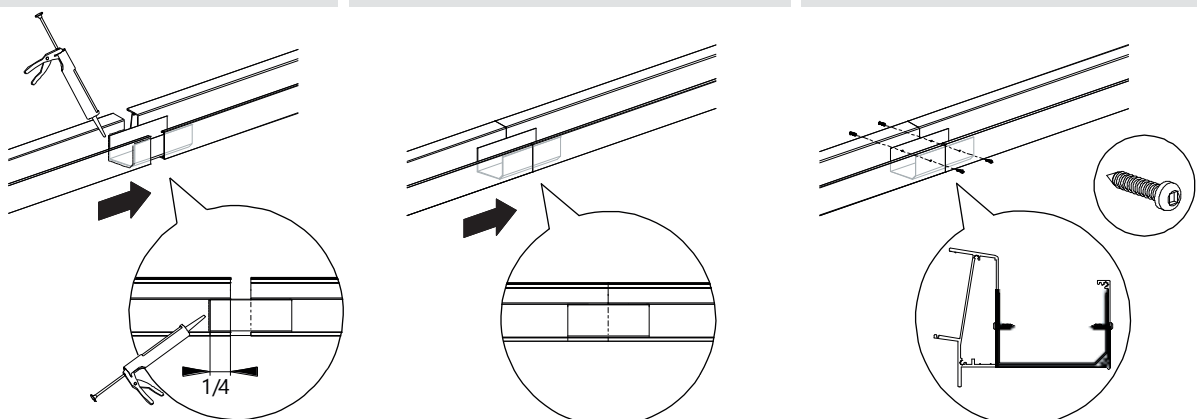

4. Insert the second gutter $\frac{1}{4}$ of the way into the other side of the connector and caulk the edge.

5. Now press the second gutter completely over the gutter connector to form a seamless joint between the gutters.

6. The gutter connector can now be secured with the short stainless steel screws in the chamber of the gutter and on the front side under the decorative profile. Caulk the assembly so it is smooth and waterproof!

6. ASSEMBLY

6.1 MOUNTING THE WALL PROFILE

If the wall profile does not need to be shortened, you can mount it straight away. Otherwise you must first cut the wall profile to the desired length. Do not place the supplied rubber strip in the wall profile yet; this rubber strip is fit in place after mounting.

6.1

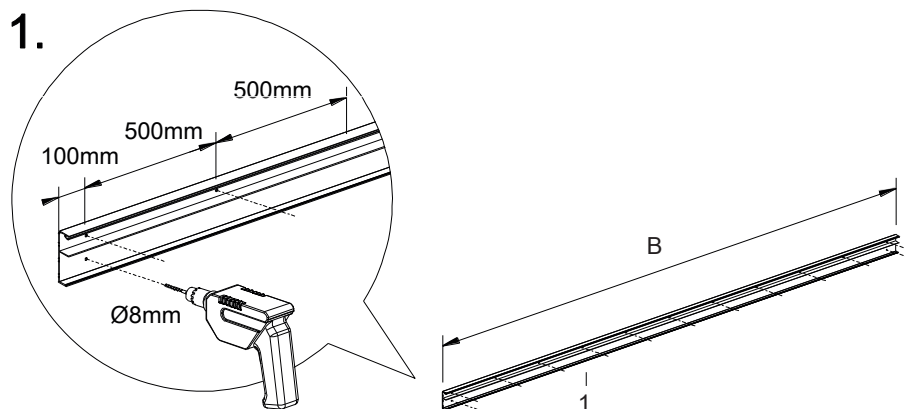

1. Drill holes in the wall profile at 500mm intervals. Begin approximately 100mm from one end and finish approximately 100mm from the other end. Use a metal drill bit with a diameter of 8mm.

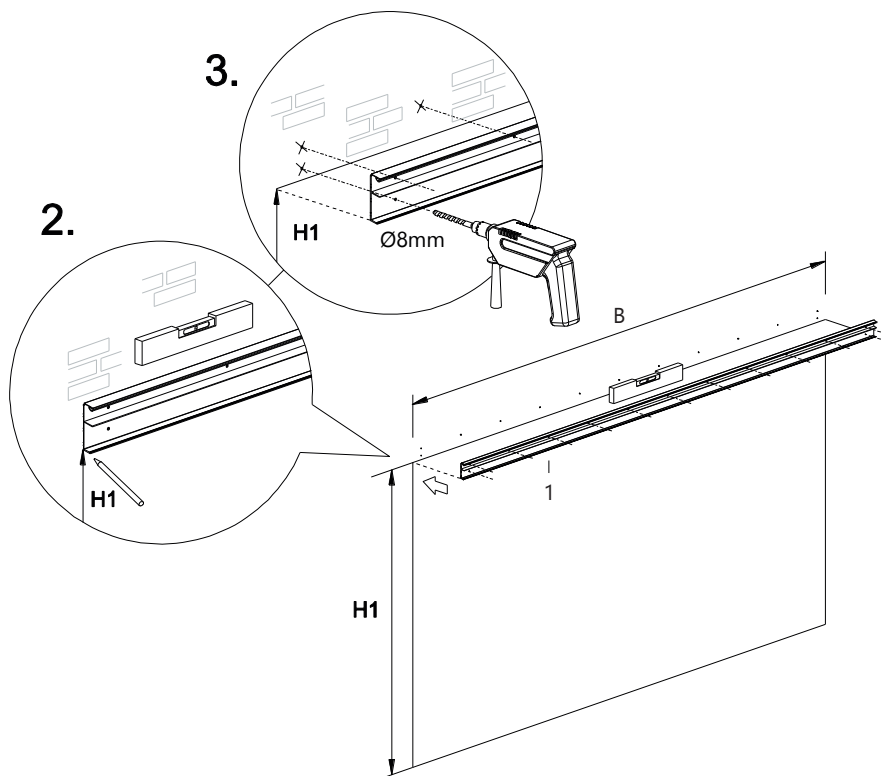

2. Now mark the wall with a line to indicate where the bottom of the wall profile should be. Place the wall profile on the line and then mark the holes that you pre-drilled in your wall profile.
3. Now use a concrete drill bit with a diameter of 8mm to drill the holes. Make sure the wall profile is level.

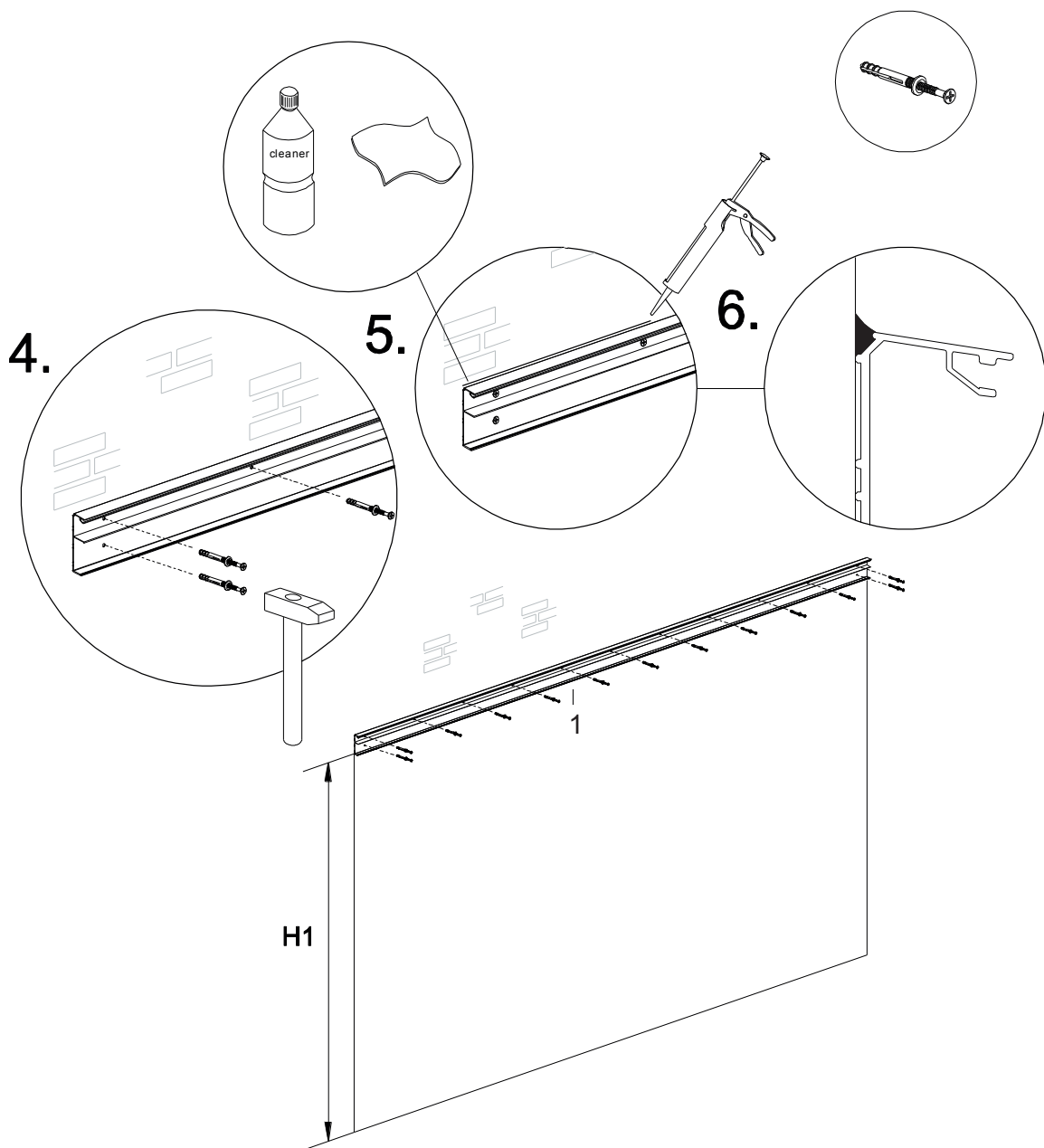

4. Fasten the wall profile with the supplied frame fixing screws (these should only be used if appropriate for the wall material).
5. Degrease the top edge of the wall profile along the wall.
6. Caulk the top edge of the wall profile (between the wall and the wall profile) to make a good seal. Strike off the caulk to make it smooth and waterproof.

6.2 PRE-INSTALLING THE GUTTER

If the standard gutter length is correct, you can pre-install it straight away. If not, you must first cut the gutter profile and decorative profile to the desired length.

6.2

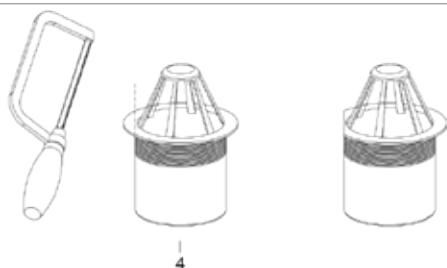

6.2.1 Installing the leaf catcher in the gutter

1. Cut/saw off one end of the leaf catcher so it fits in the gutter profile.

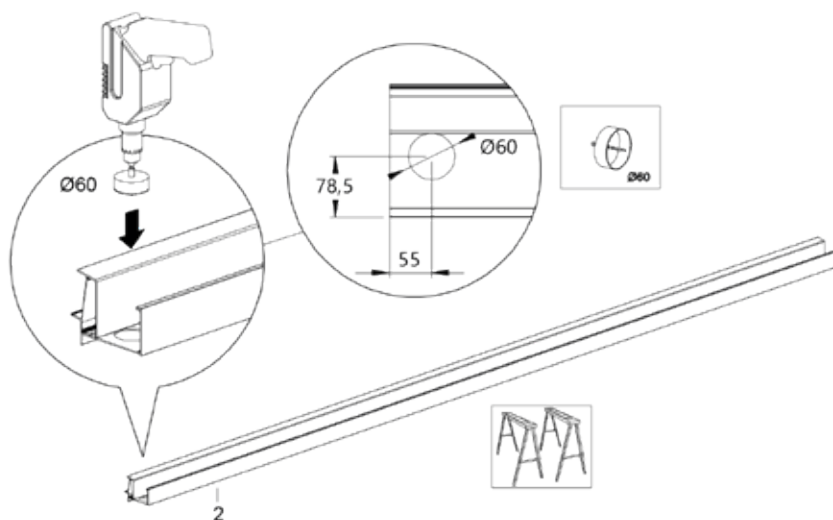

2. Place the gutter flat and firm on a table or sawhorses. Determine where the rainwater discharge post (and leaf catcher) will be placed, i.e. at the left or right end of the gutter. Mark the position of the hole for the leaf catcher in the gutter. Now carefully drill the hole in the gutter with the $\varnothing 60$ mm hole saw.

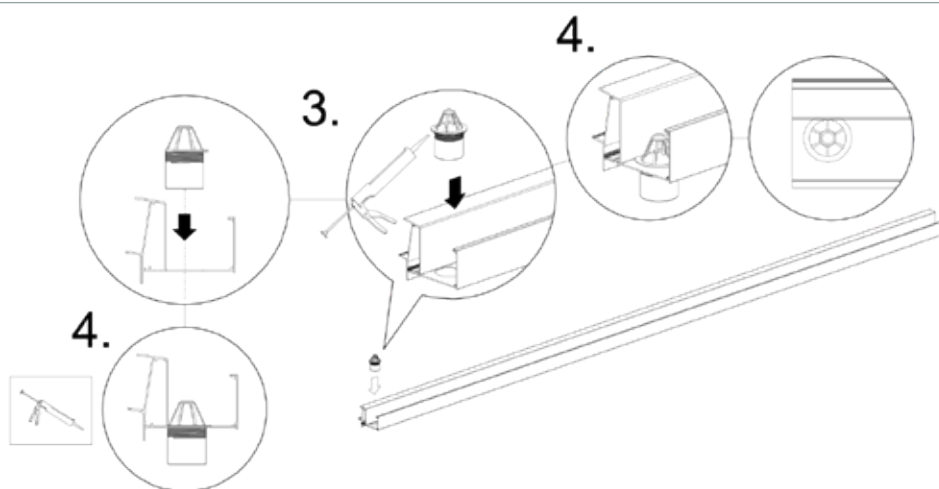

3. Apply caulk to the underside of the leaf catcher.
4. Place the leaf catcher in the hole in the gutter (with the cut side towards the side of the gutter profile with the open chambers). Caulk to form a waterproof seal around the leaf catcher.

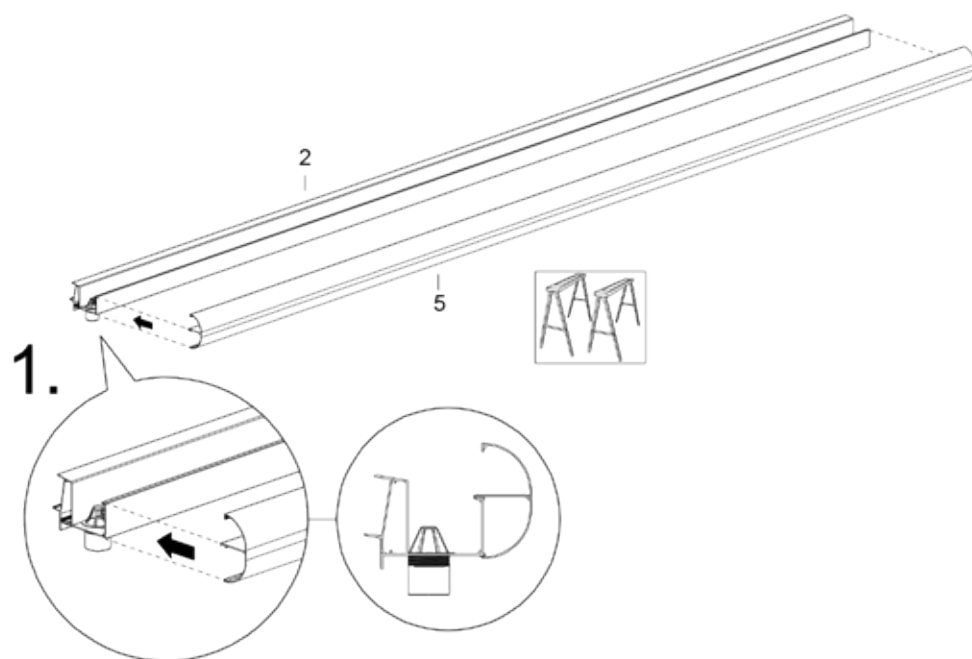

6.2.2 Attaching the decorative profile to the gutter

1. Place the gutter flat and firm on a table or sawhorses. Place the decorative profile on the top of the gutter and click the bottom of the decorative profile under the gutter.

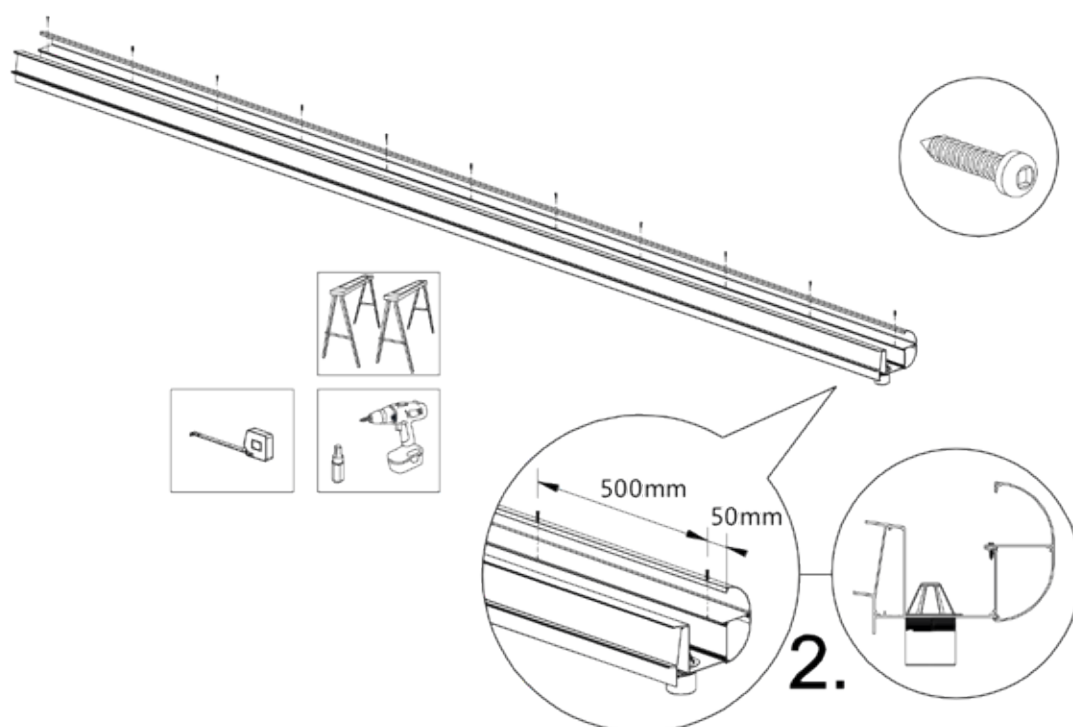

2. Secure the decorative profile with the supplied short 19mm stainless steel screws. Begin approximately 50mm from the end and place a screw approximately every 500mm. The last screw should be placed approximately 50mm from the end.

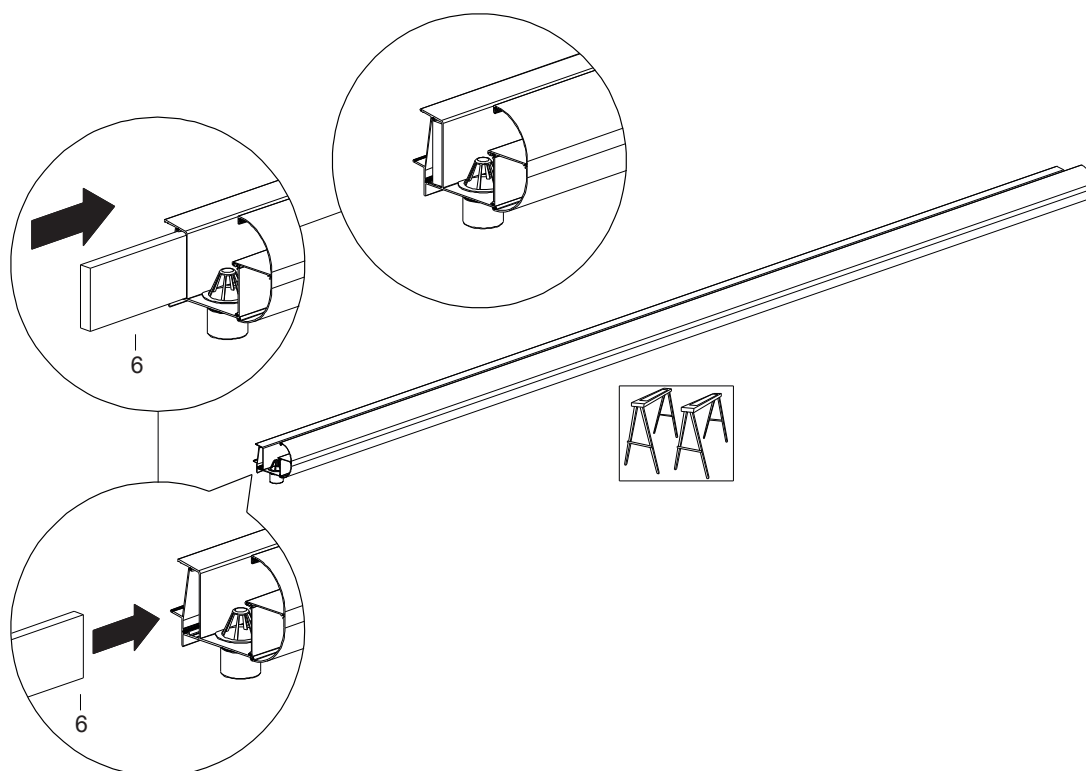

6.2.3 Installing the steel strip in the gutter

The gutter is fitted with a 20x100mm steel strip to hold the glass.

1. Place the gutter flat and firm on a table or sawhorses.
2. Slide the steel strip into the gutter. Use a lubricant.

Tip: the steel strip can be 'ratcheted' in place with a lashing strap.

6.3 INSTALLING POSTS, GUTTER AND END RAFTERS

6.3

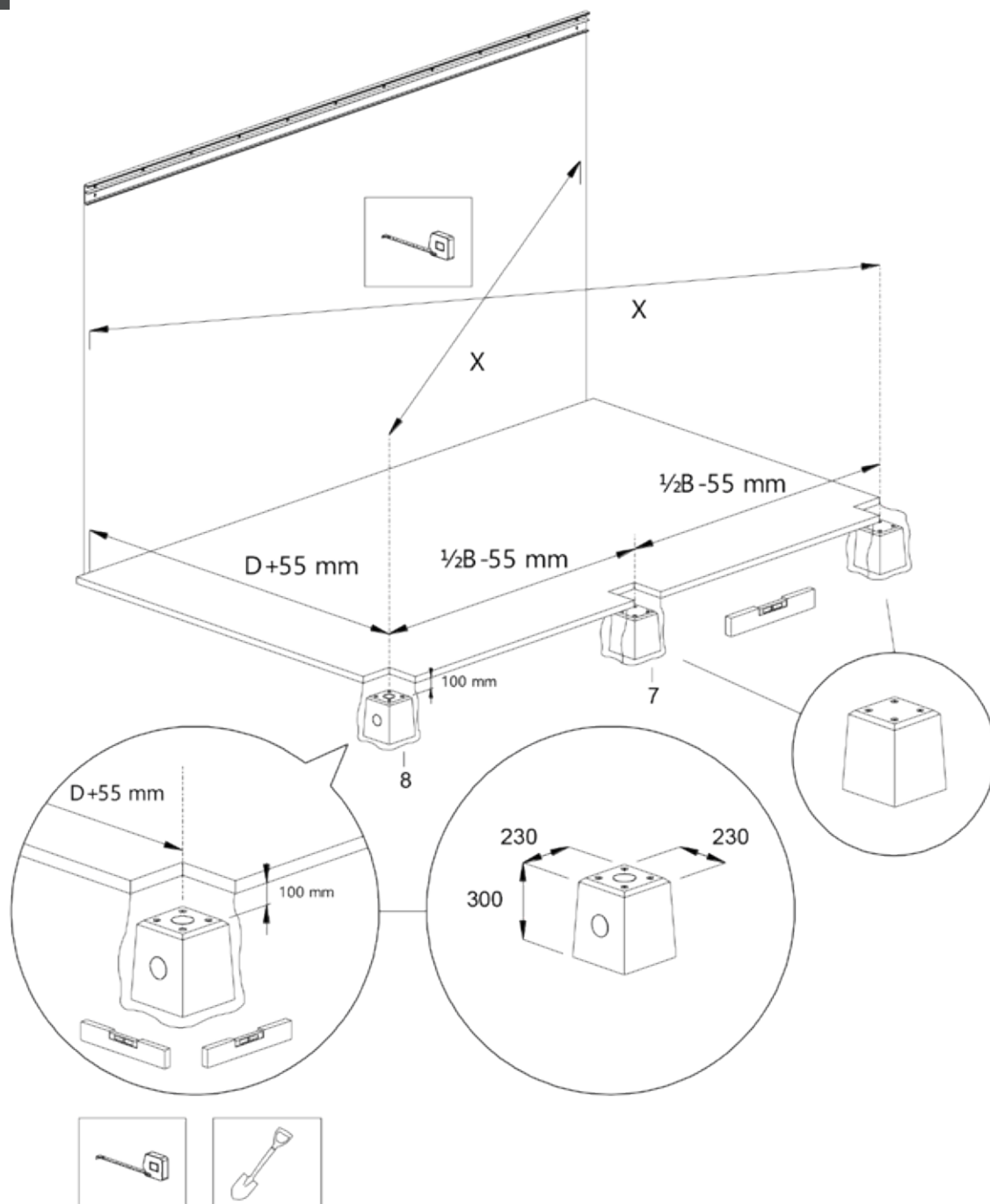

6.3.1 Installing posts on foundation blocks

Determine the positions of the foundation blocks and the foundation block with the rainwater discharge. Place the foundation blocks in the ground as accurately as possible. Make sure that the top of the foundation block is placed at least 100mm below ground level, and place them level. Place the centre of the foundation block at distance $D + 55\text{mm}$ from the rear of the wall profile. Make sure that the foundation blocks are positioned perfectly square. Connect the drain to the side outlet of the rainwater discharge foundation block.

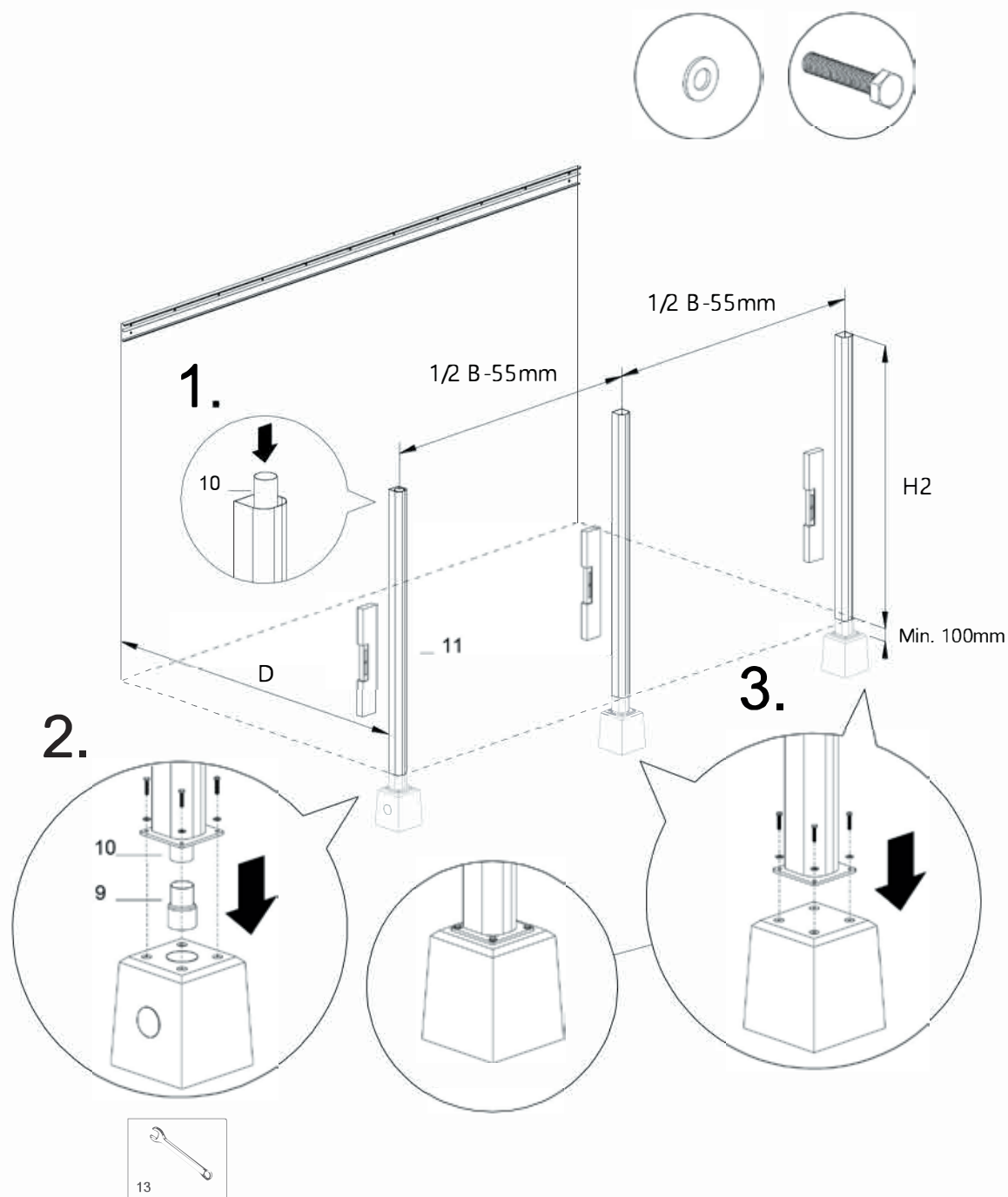

Note: If you shorten any of the posts, take into account the depth of the foundation blocks and the bottom end of the post.

1. Place the post with the PVC rainwater discharge pipe at the location of the rainwater discharge foundation block.
2. Place the rainwater discharge adapter in the rainwater discharge foundation block and connect the rainwater discharge pipe to the sleeve. Place the post with the rainwater discharge pipe on top of the rainwater discharge foundation block and fasten the post with M8x40 hex bolts (incl. washers). Make sure the post is level.
3. Place the other posts on the foundation blocks and secure them so they are plumb.

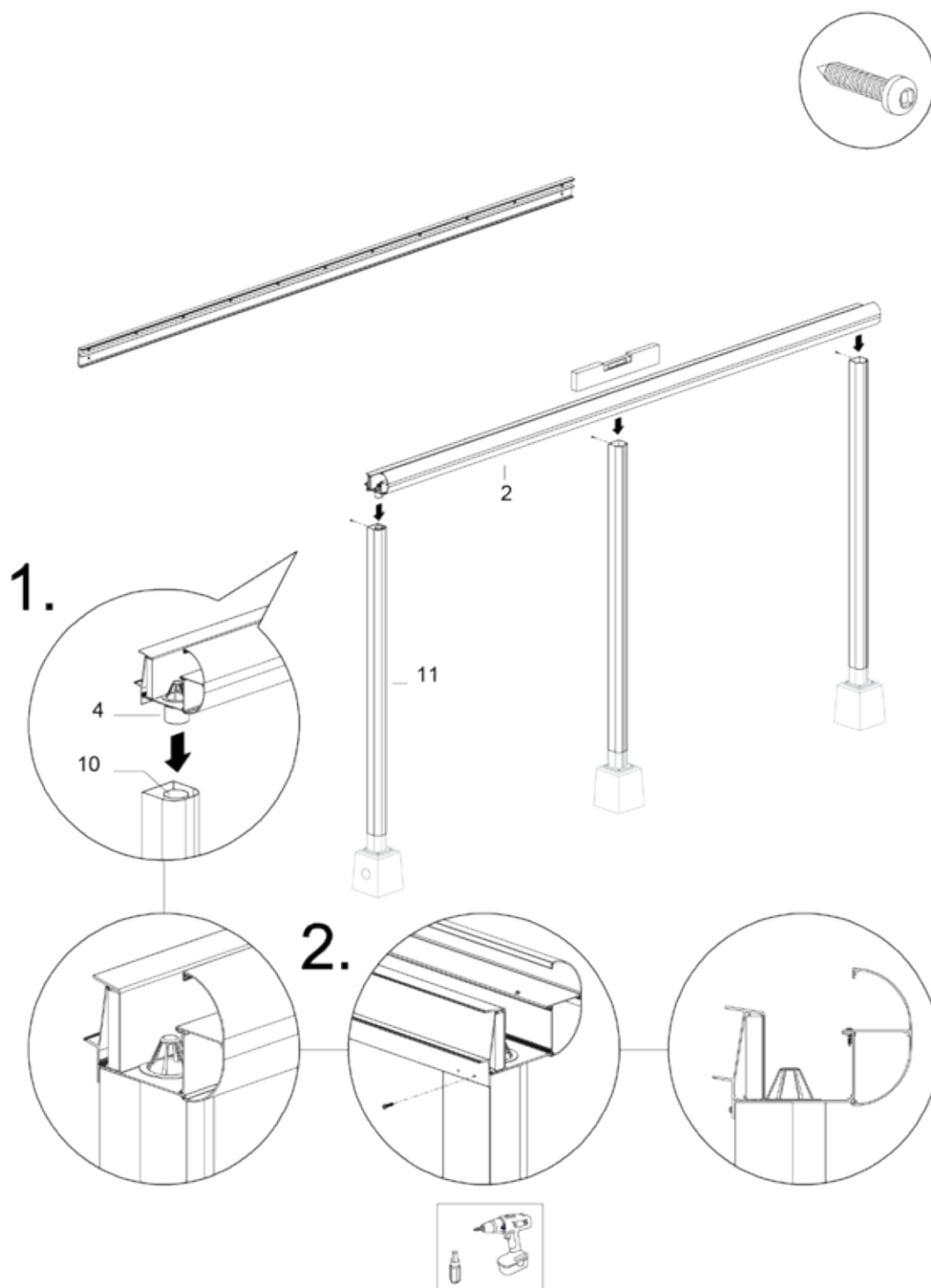

6.3.2 Installing the gutter

1. Now place the pre-assembled gutter profile on the posts. Make sure the leaf catcher is positioned properly in the PVC rainwater discharge pipe.
2. Screw the posts to the gutter with one short screw through the lower lip of the gutter profile and into the post. This way you can adjust the position of the gutter later, if necessary.

Note: ultimately the posts will be secured with two screws. The first screw should not be placed in the middle of the post but rather approximately a third of the way in from the edge. Be careful not to drill and screw through the PVC pipe in one of the posts!

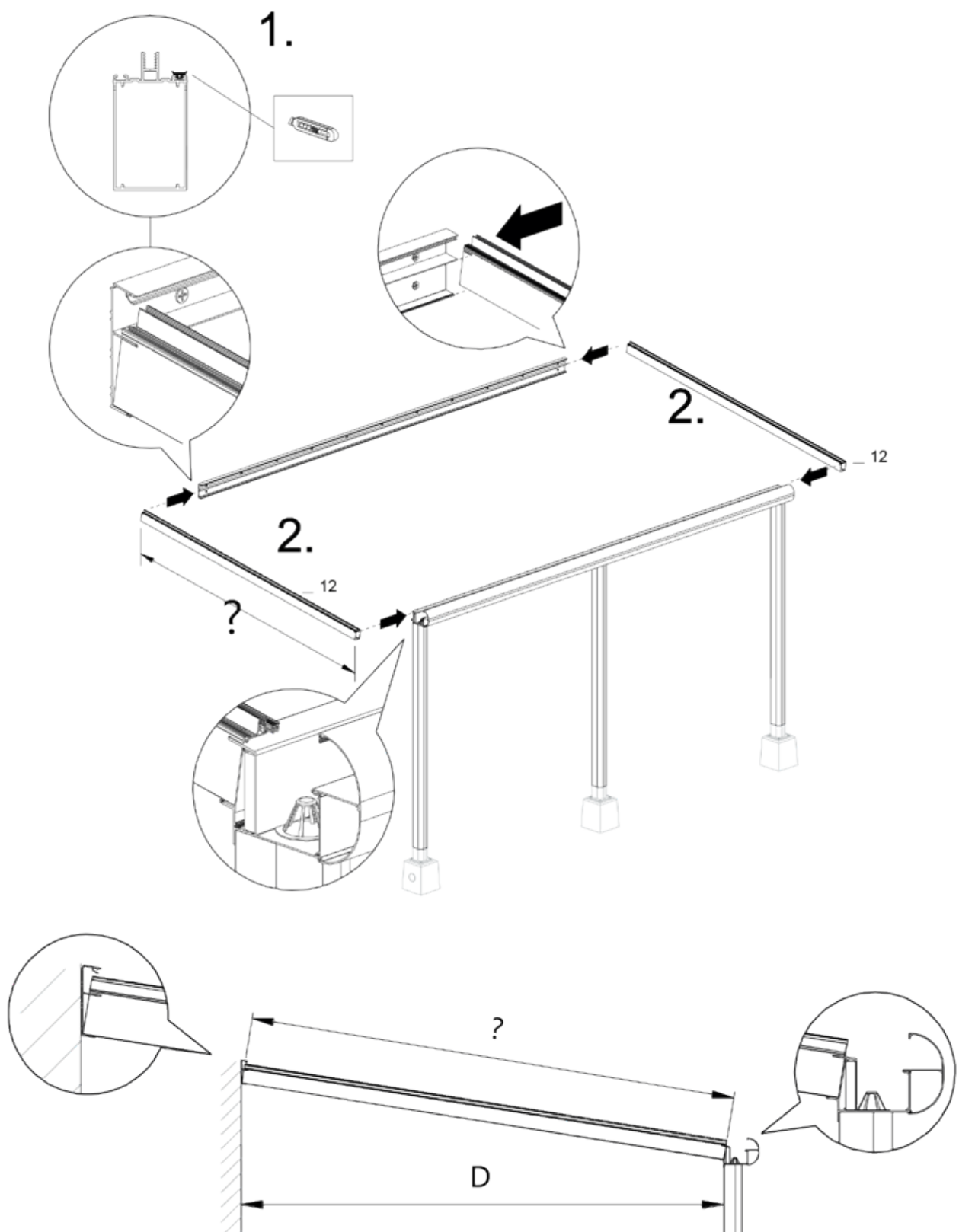

6.3.3 Installing the end rafters

1. Carefully cut the pre-fitted rubber seals in the end rafters to size.
2. Place the left and right end rafters in both the gutter profile and the wall profile, one by one. Make sure that the outer edges of the end rafters are flush with the ends of the gutter profile and wall profile.

6.4 INSTALLING THE MIDDLE RAFTERS

6.4

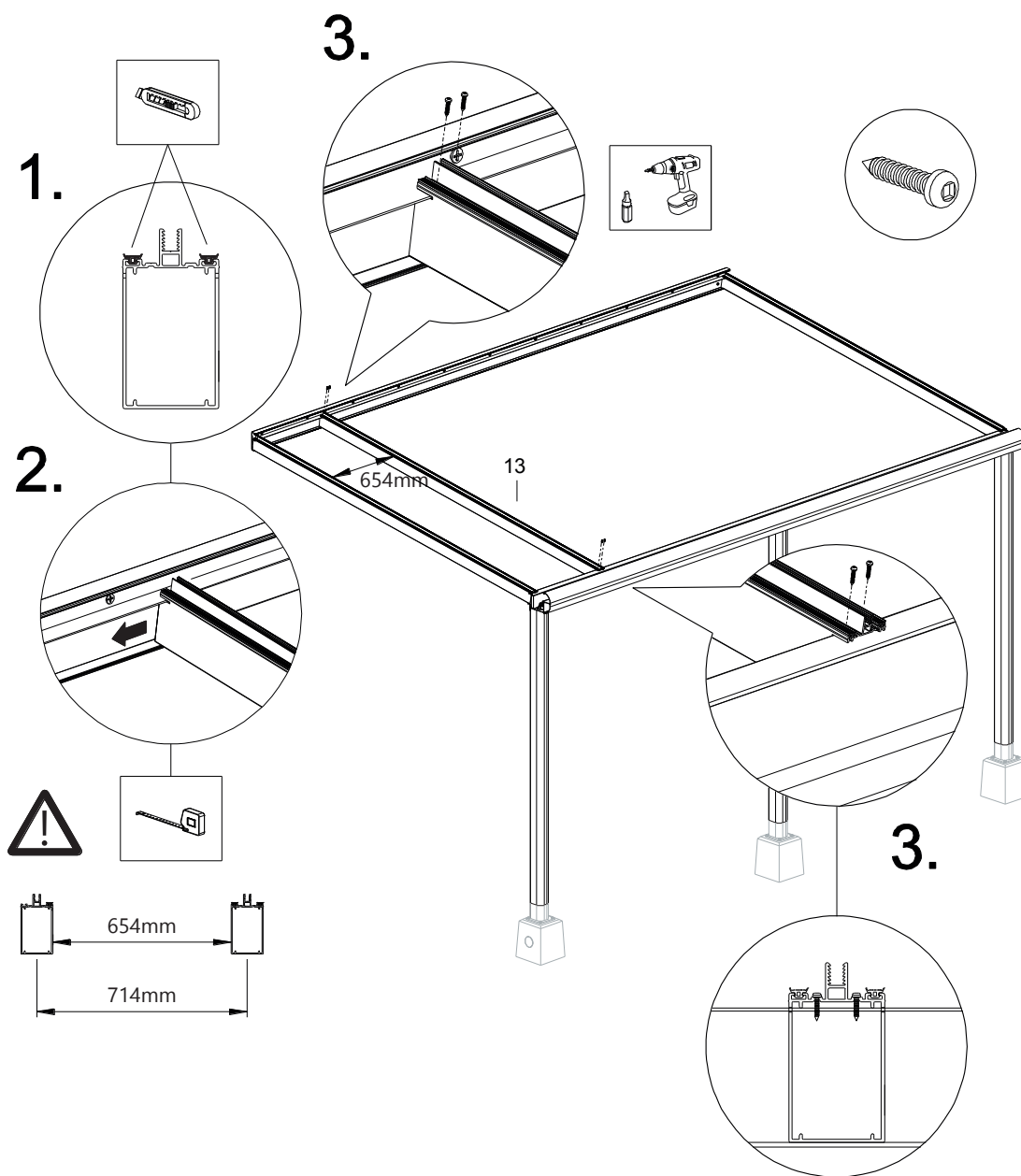

Note: if you install Eurocell LED lighting, we recommend performing the installation before placing the middle rafters.

If you do not shorten the width of your patio roof, you can use the trim elements for the gutter as spacers between the rafters. The standard panel width is 684mm, so the middle rafters will be spaced exactly 714mm centre to centre.

Note: see table on page 11 for the correct dimensions.

1. Carefully cut the pre-fitted rubber seals in the middle rafters to size.
2. Place the first middle rafter in the wall profile and gutter profile at the desired distance.
3. Screw the middle rafter to both the gutter profile and wall profile with 2 short screws.

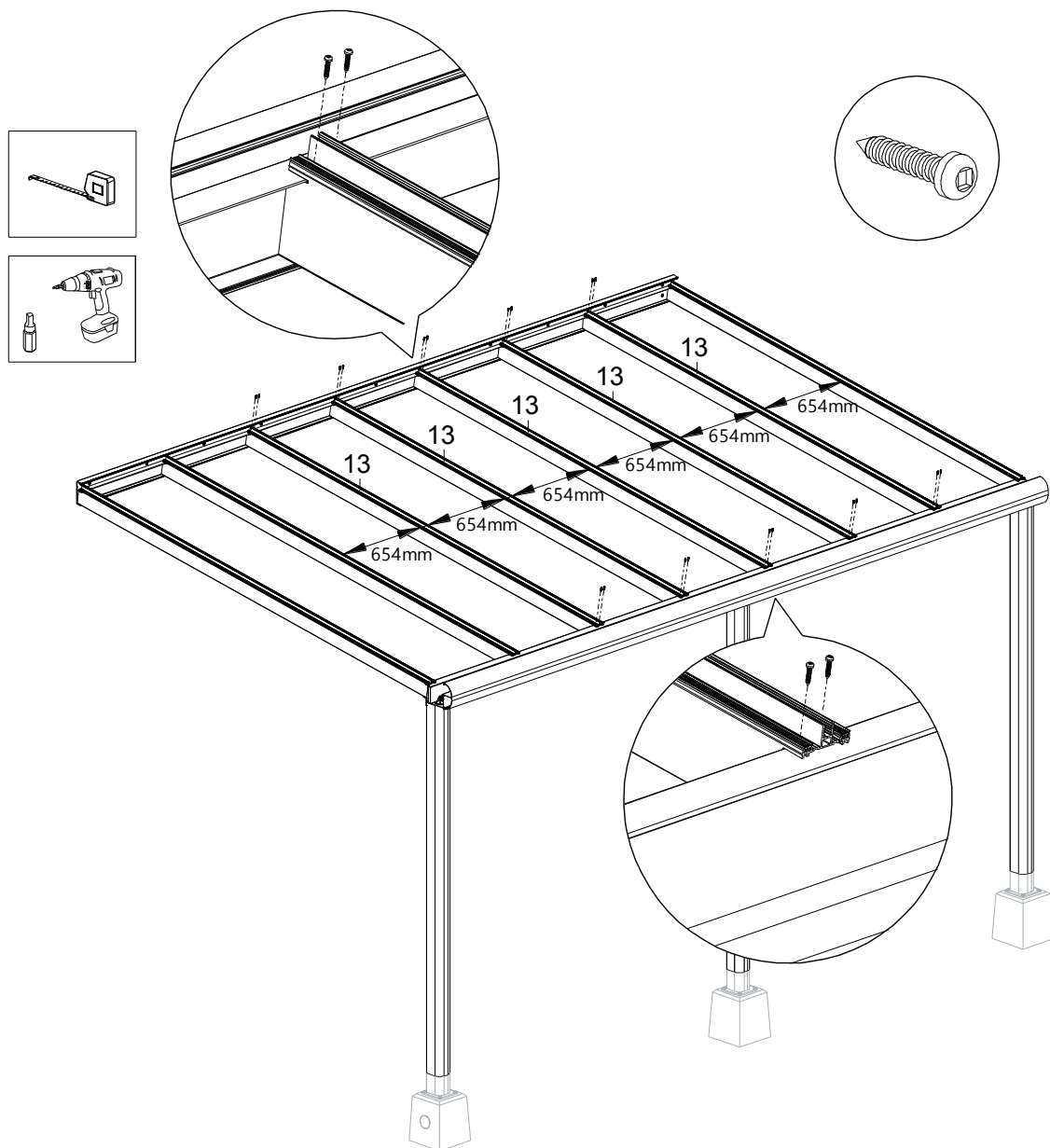

4. Then place the remaining middle rafters in the wall profile and gutter profile at the desired distance.

Note: see table on page 11 for the correct dimensions.

5. Screw the middle rafters to both the gutter profile and wall profile with two short screws.

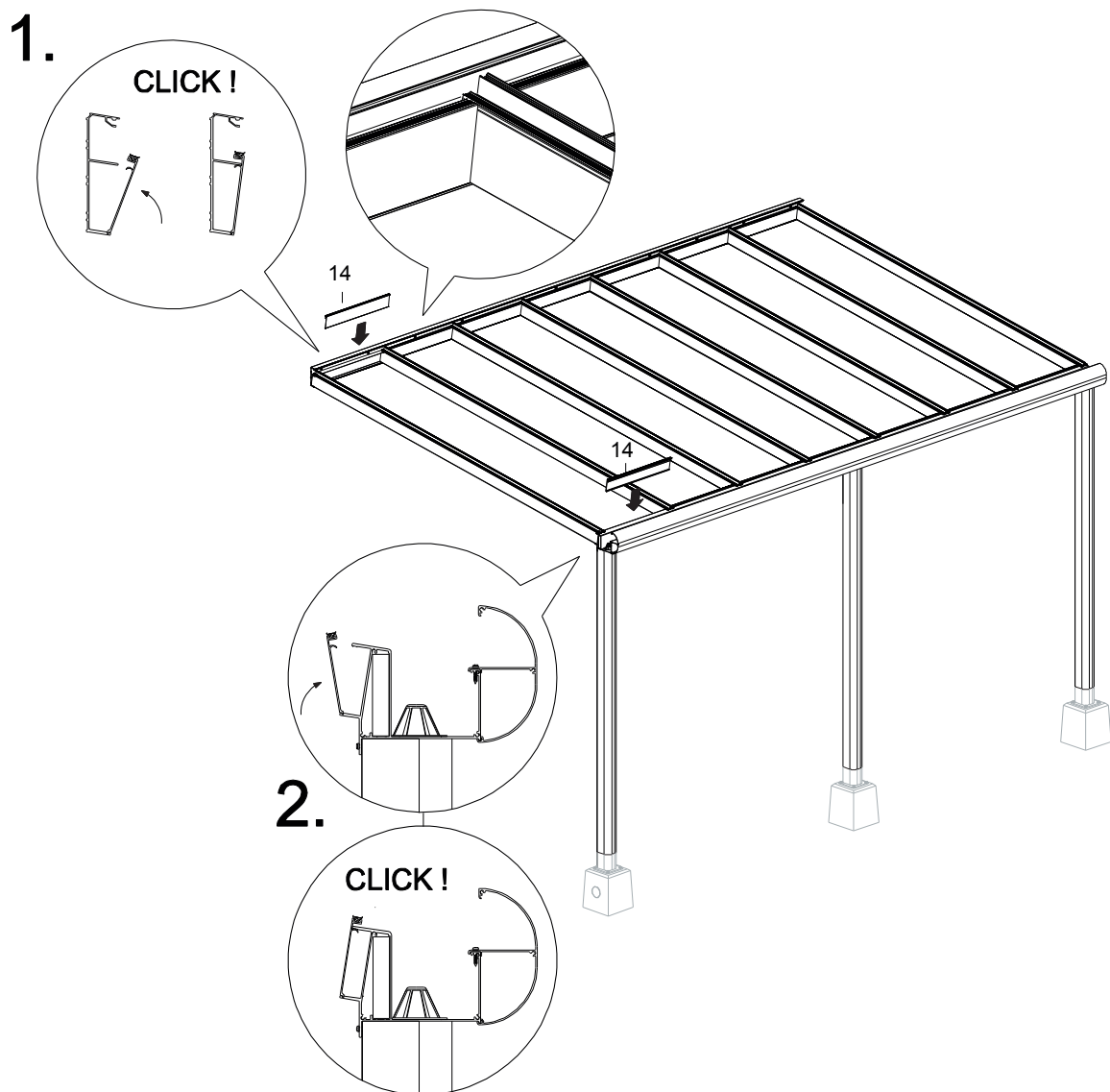

Note: if Eurocell LED lighting is installed, make sure all the cabling is properly positioned and connected before the inside trim covers are fitted. We recommend placing the transformer behind a trim click strip so it will be easily accessible for future service.

1. Place the inside trim covers on the wall profile.
2. Place the inside trim covers on the gutter profile.

6.5 INSTALLING THE GLASS PANELS

6.5

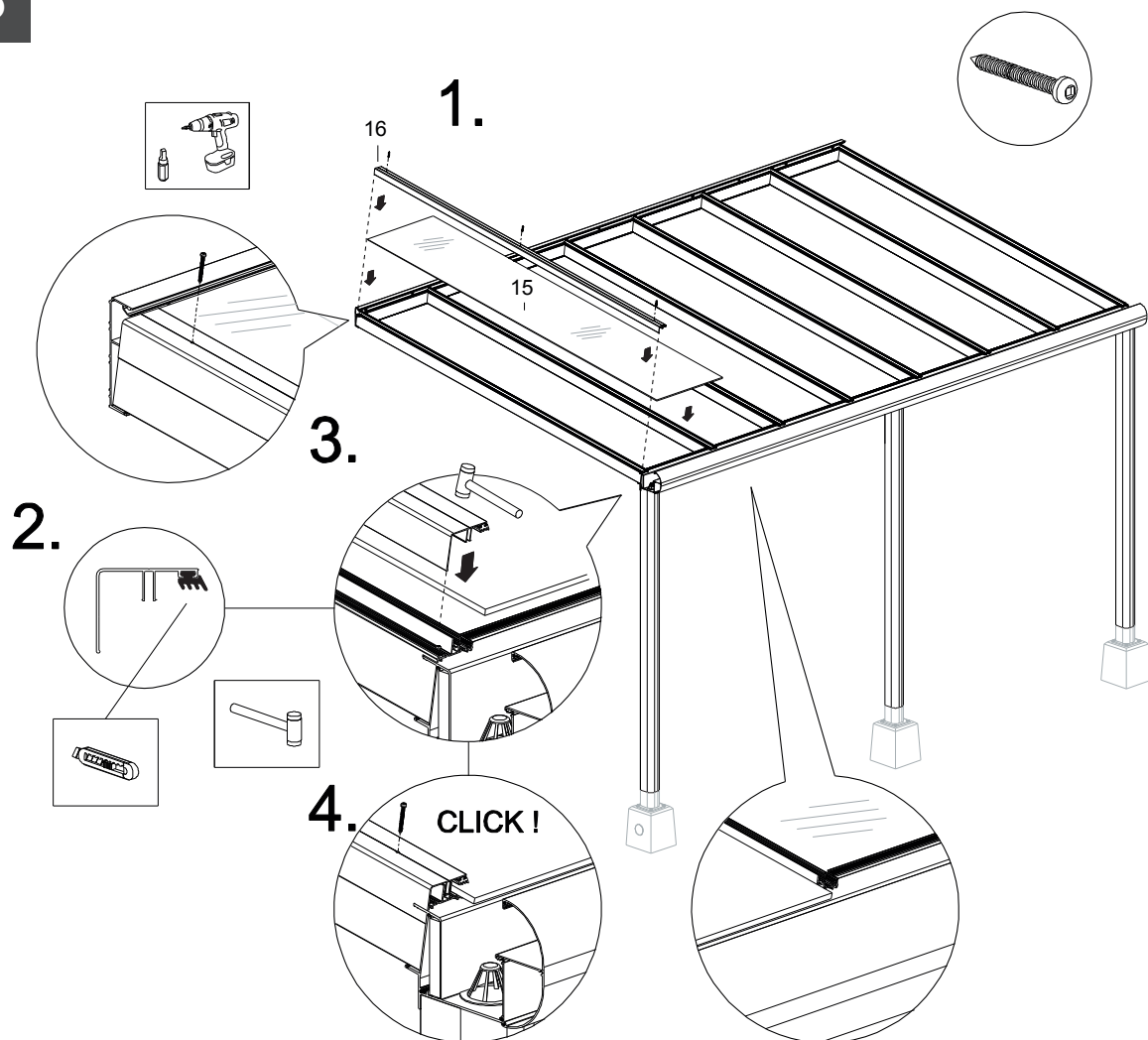

1. Place the first glass panel between the rafters.

Note: The length of the glass is equal to the length of the roof + 20mm. The glass panel extends approximately 25mm beyond the rafter on both sides.

2. Carefully cut the pre-fitted rubber seals in the aluminium end cover strip to size.

3. Pre-drill the end cover strip with a 3mm drill bit (1 top – 1 bottom – 1 middle). Fit the end cover strip. Position the cover strip flush with the rafter at the wall and gutter ends. At the wall end the cover strip fits just a bit under the wall profile for extra anchoring. Once the strip is positioned correctly, click the trim click strip into the end rafter (use a rubber mallet).

4. Now screw the end cover strip to three points on the end rafter with long stainless steel screws (1 top – 1 bottom – 1 middle).

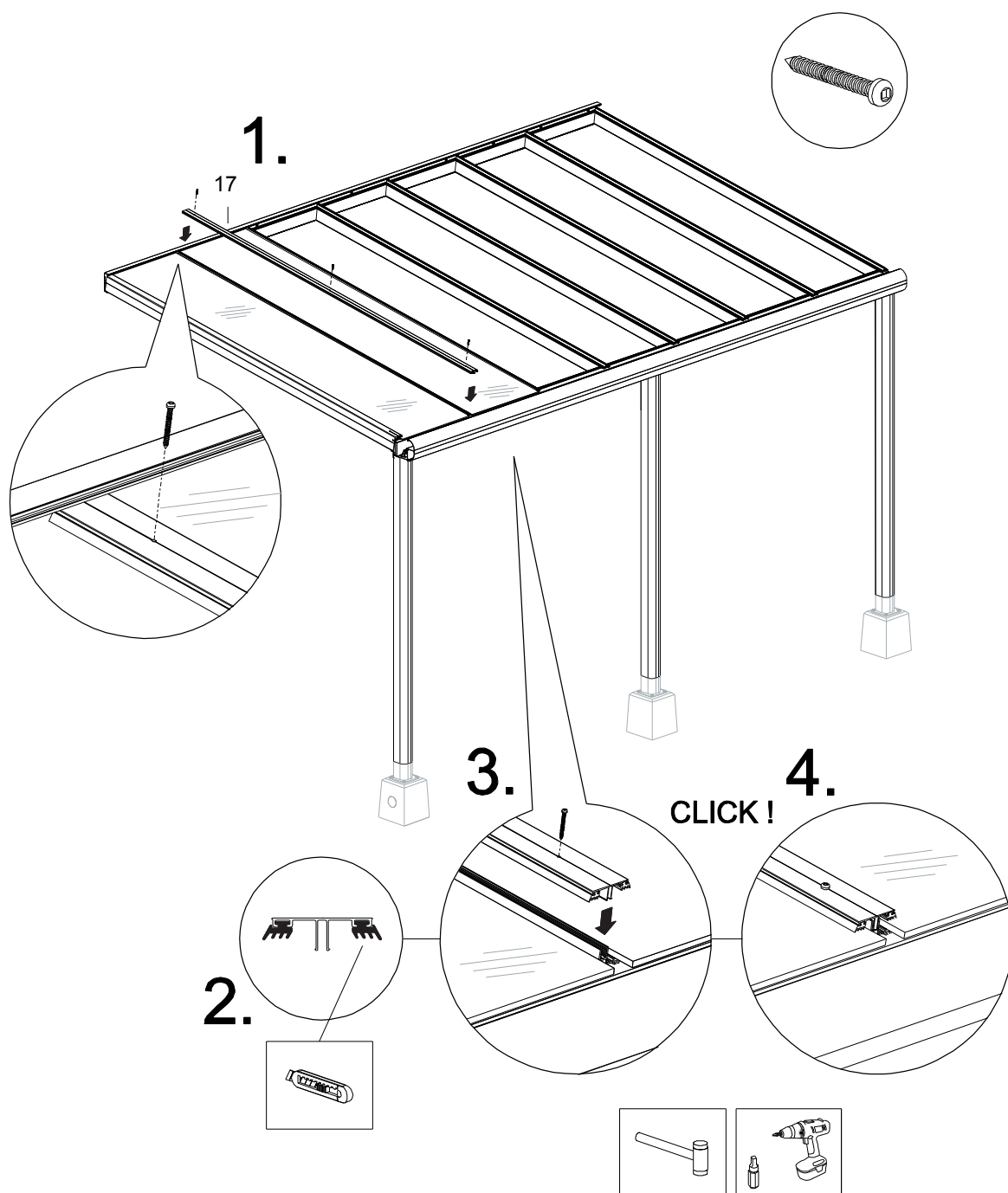

1. Place the second glass panel between the rafters.
2. Carefully cut the pre-fitted rubber seals in the aluminium middle cover strip to size.
3. Pre-drill the middle cover strip with a 3mm drill bit (1 top – 1 bottom – 1 middle). Fit the middle cover strip. At the wall end the cover strip fits just a bit under the wall profile for extra anchoring. Once the strip is positioned correctly, click the trim click strip into the middle rafter (use a rubber mallet).
4. Now screw the middle cover strip to three points on the middle rafter with long stainless steel screws (1 top – 1 bottom – 1 middle).

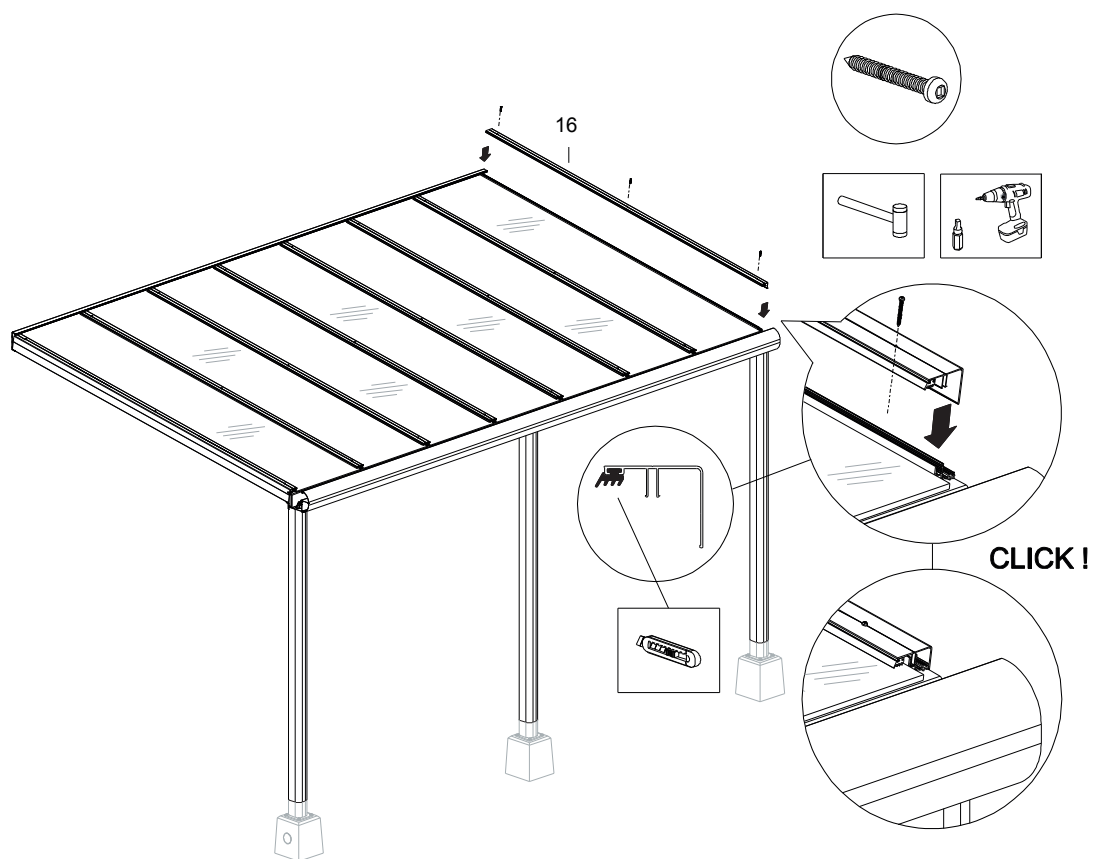

5. Repeat steps 1 to 4 on pages 26 & 27 for installation of the other cover strips.

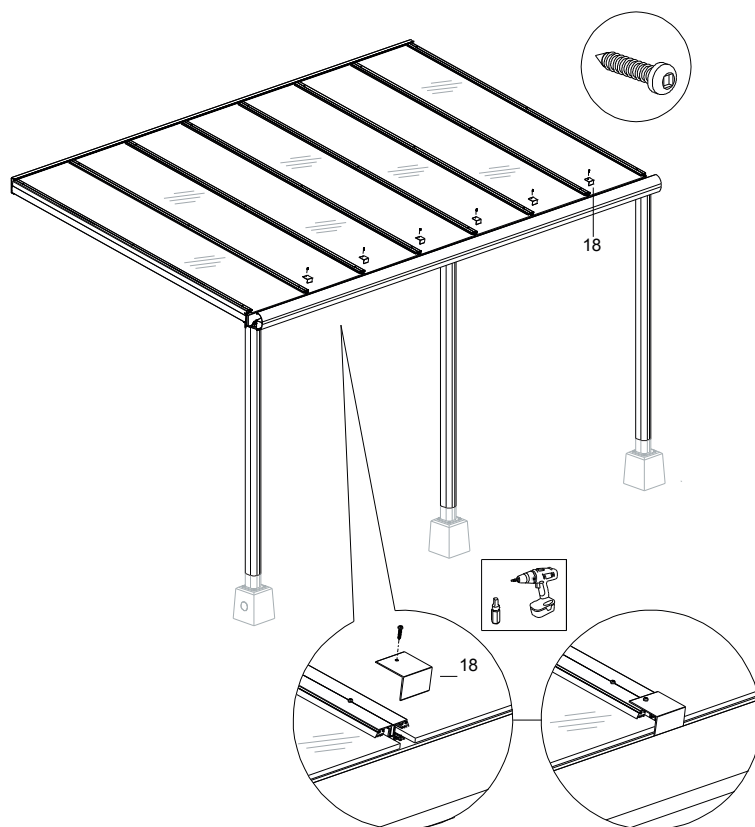

6. Now screw a sheet stopper at the gutter end of each middle rafter to ensure secure attachment.

Note: securing the end cover strips comes later.

6.6 FINISHING

6.6

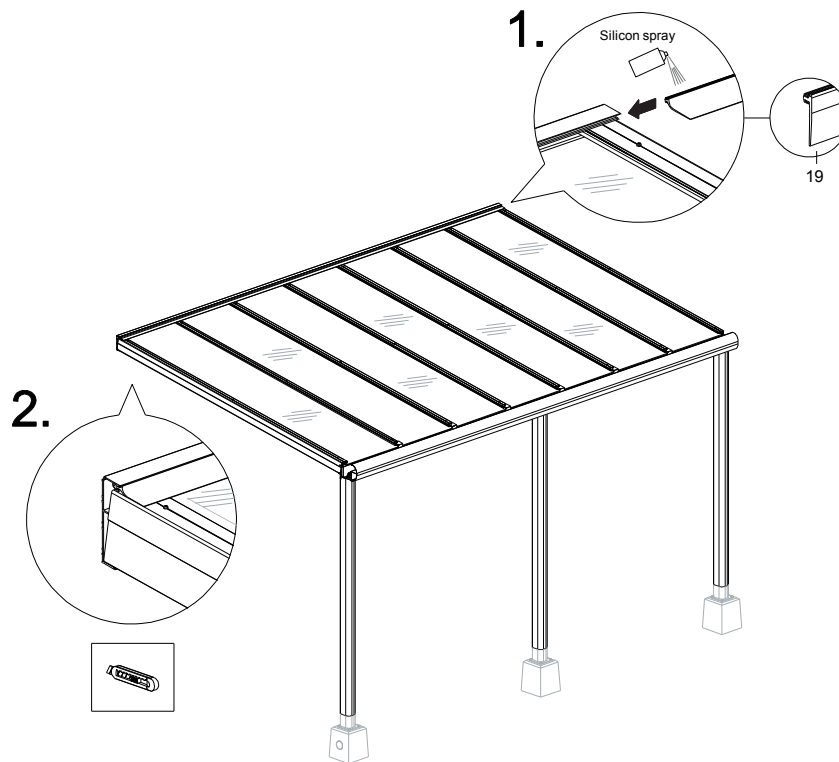

1. Position the rubber strip in the wall profile properly so it covers the sheets and cover strips.
2. Carefully cut the rubber strip to size at both ends.

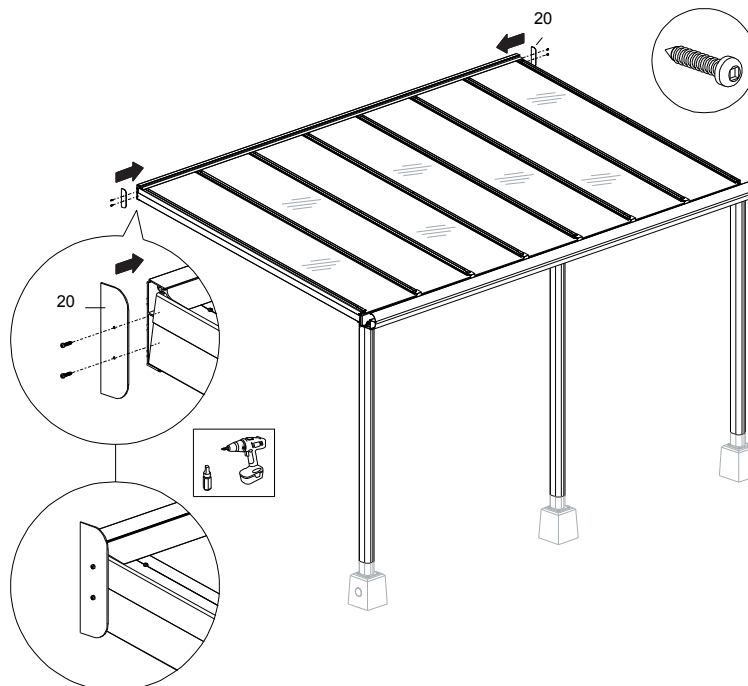

3. Screw the wall profile trim cover onto wall profile with two short screws.

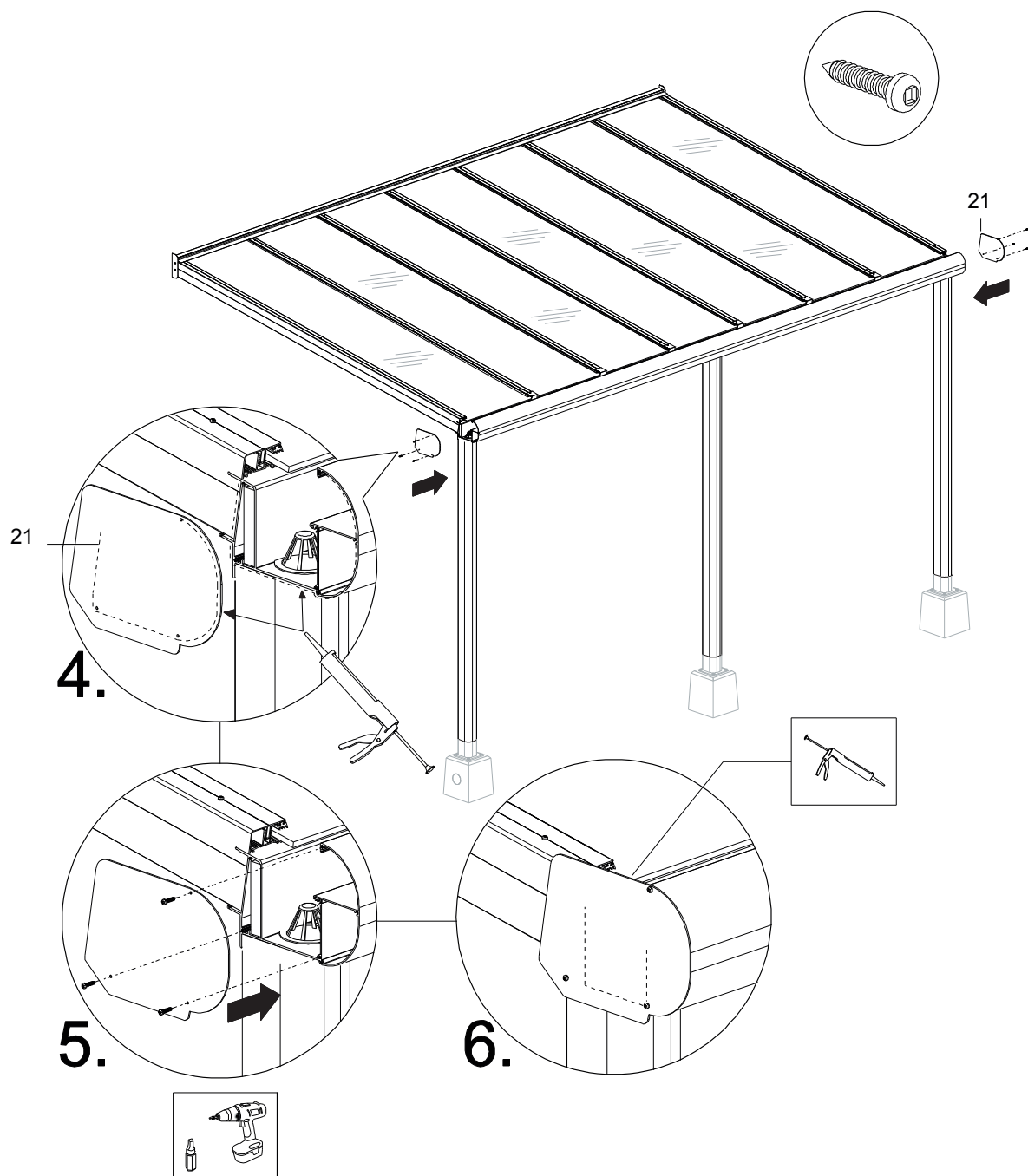

4. Apply caulk to both ends of the gutter profile and decorative profile.

5. Carefully screw the decorative profile trim cover to the gutter profile and the decorative profile with the short screws in the guides provided for this purpose.

6. Caulk the inside of the gutter so it is waterproof.

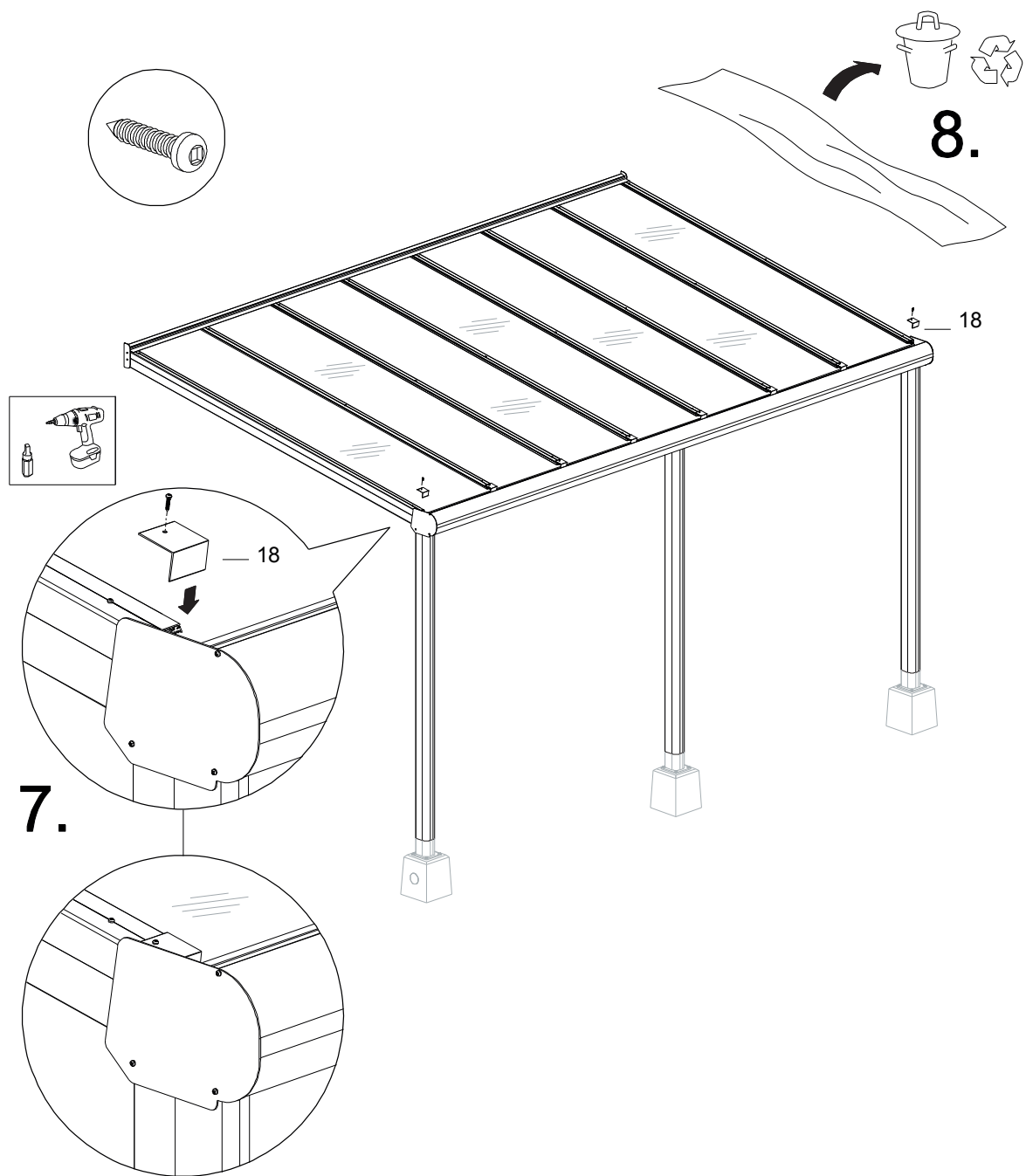

7. Now attach the sheet stoppers to the cover strips of the end rafters with the short screws.

8. Remove the remaining protective film from the aluminium parts.

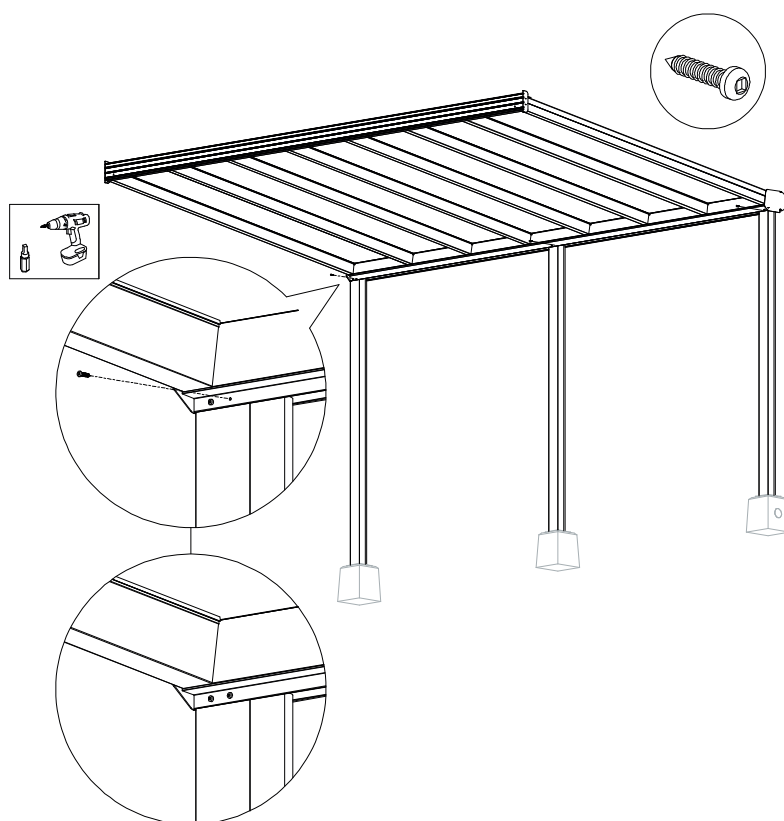

9. Secure your posts with the second short screw.

10. If there is a small gap between the top of the posts and the gutter you can seal it with caulk.

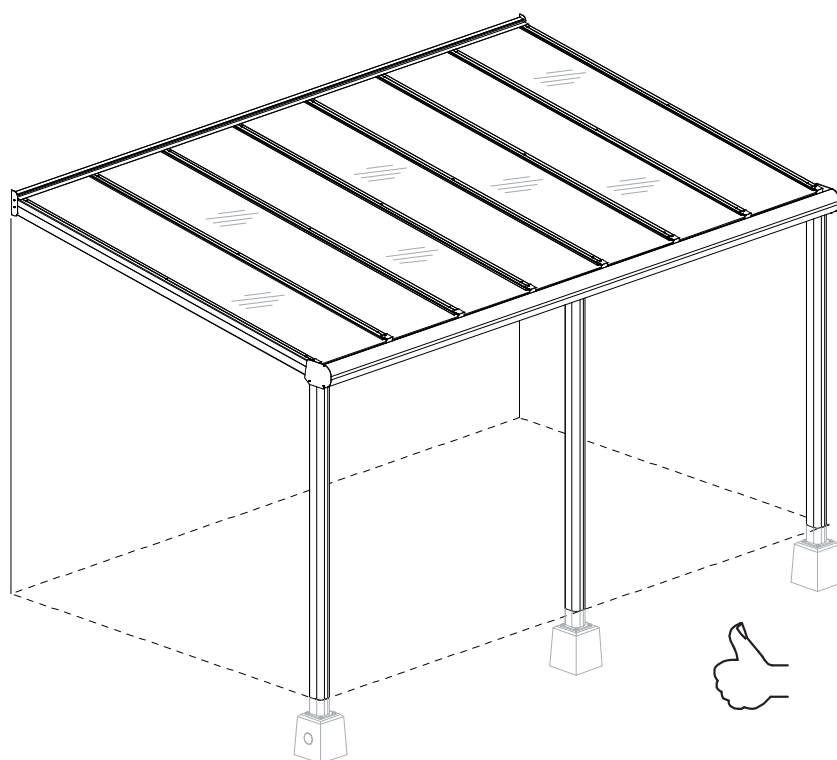

11. Congratulations! The roof is now finished!

7. MAINTENANCE

We recommend that you maintain and clean your patio roof at least once a year.

Check whether the screw connections are tight. If not, tighten them firmly.

The aluminium profiles and glass panels that are dirty can be cleaned with lukewarm water and a cleaning product.

- ▶ Use plenty of water, soft material and a sponge for cleaning and washing.
- ▶ Never use abrasives or aggressive solvents (no acids or alkalis). Solvents (washing-up liquid and glass cleaner) can be used for removing greasy contamination.
- ▶ Never use a pressure washer

Eurocell has a special cleaning product available. Ask your dealer for more details.

8. DISPOSAL OF WASTE

Dispose of the product according to local laws and regulations.

9. GUARANTEE

For a copy of the Eurocell product guarantee certificate please visit the following web page:
<https://www.eurocell.co.uk/technical-support/guarantee-certificates/conservatory-certificates>



10. CONTACT

Your dealer is your first point of contact for questions and comments.

DESIGN GRID

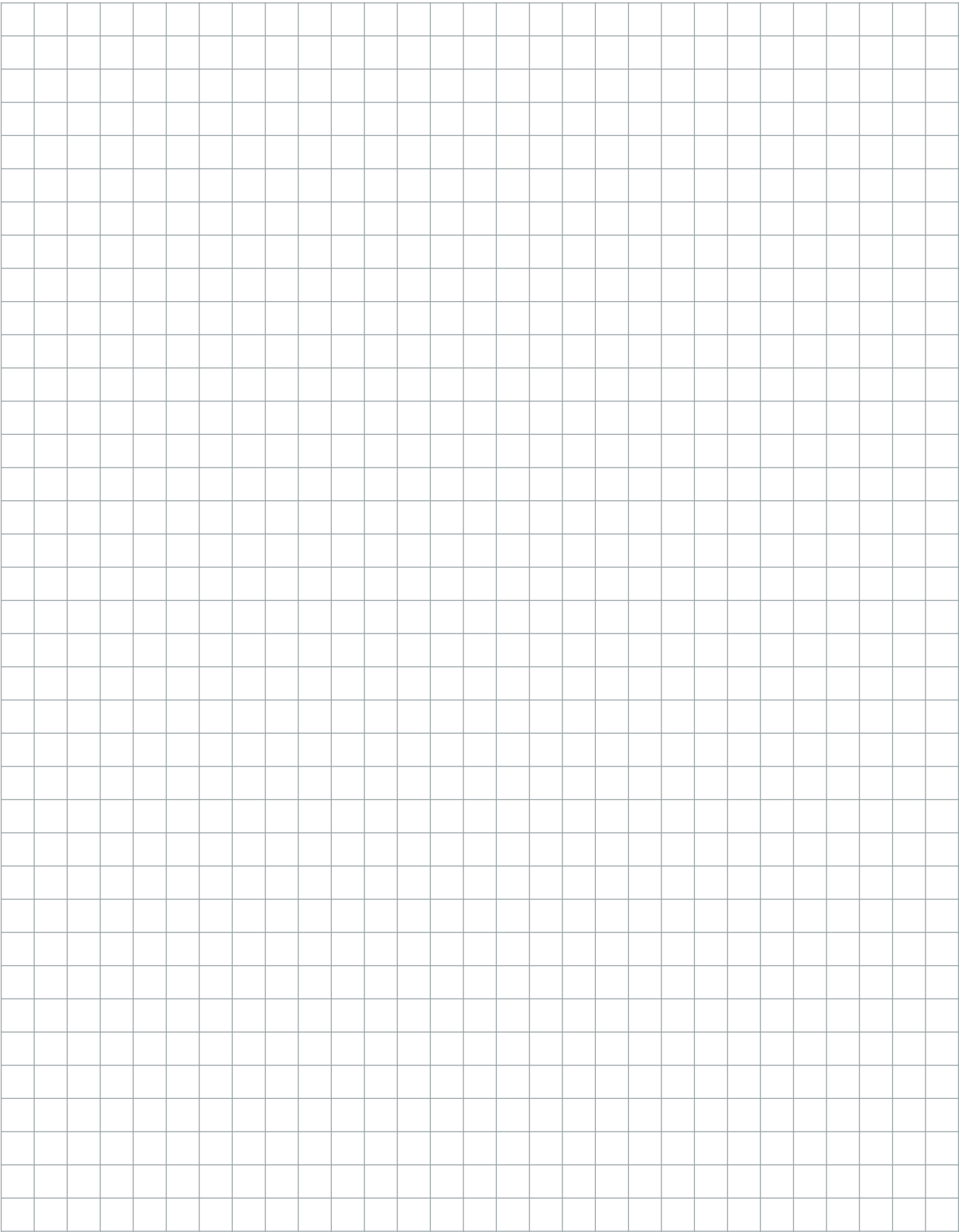



Please contact our Customer Care Team for additional support or advice:



0333 321 2353



eurocell.co.uk/technical-hub

eurocell.co.uk

