

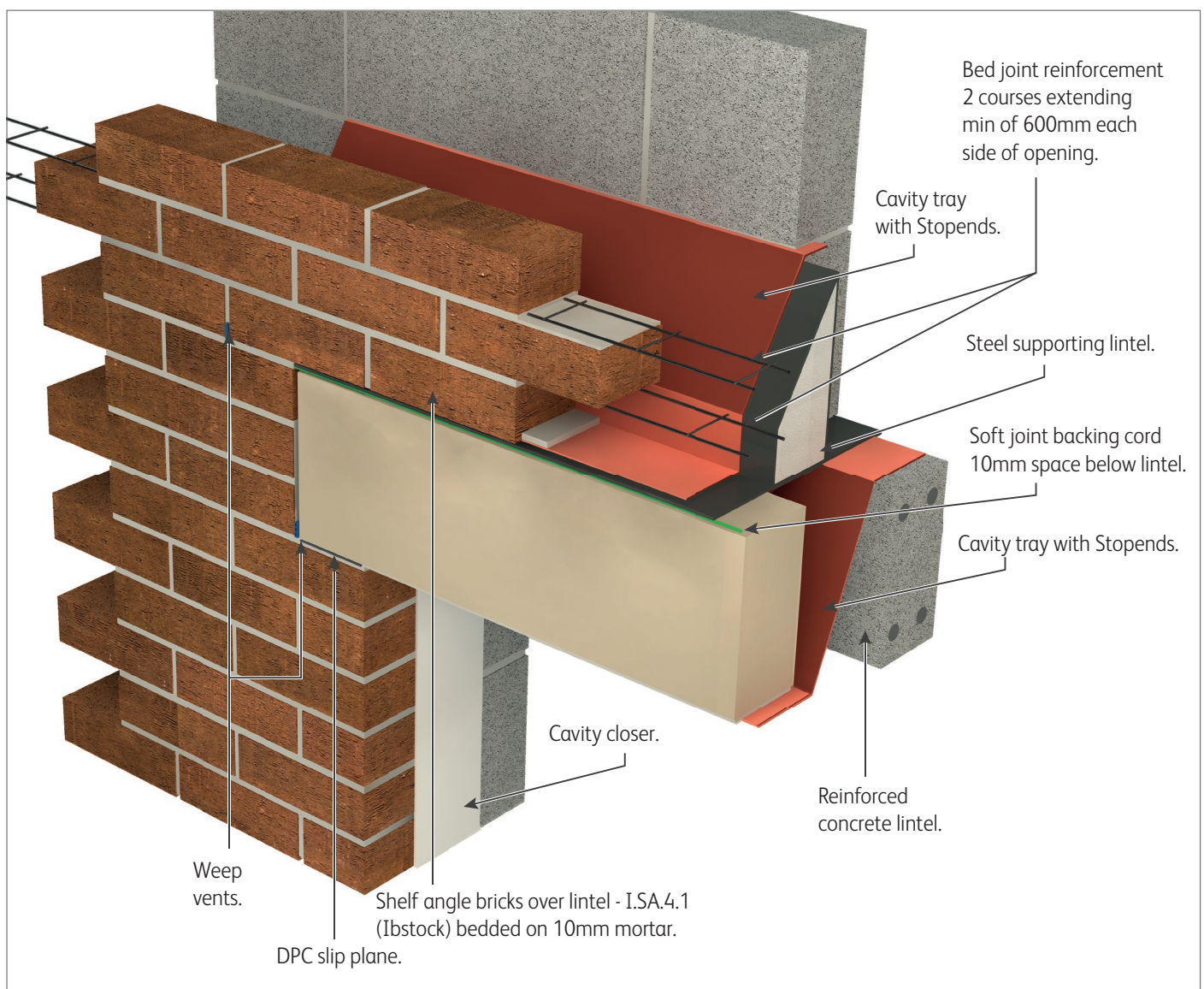

CAST STONE DECORATIVE HEAD WITH STEEL RELIEVING LINTEL

Decorative heads are not load bearing therefore suitable support will be required for the masonry above. A 10mm soft joint will be required between the lintel and decorative head.

Therefore it is important to specify a lintel robust enough not to deflect and impose a load on the decorative head and also does not have the angled flange designed to shed water over a window as this would prevent the formation of a 10mm soft joint above the decorative head. Lintels are available with a flat edge. The opening of the internal leaf will require bridging by a reinforced concrete lintel or similar.





CAST STONE DECORATIVE HEAD WITH STEEL RELIEVING LINTEL

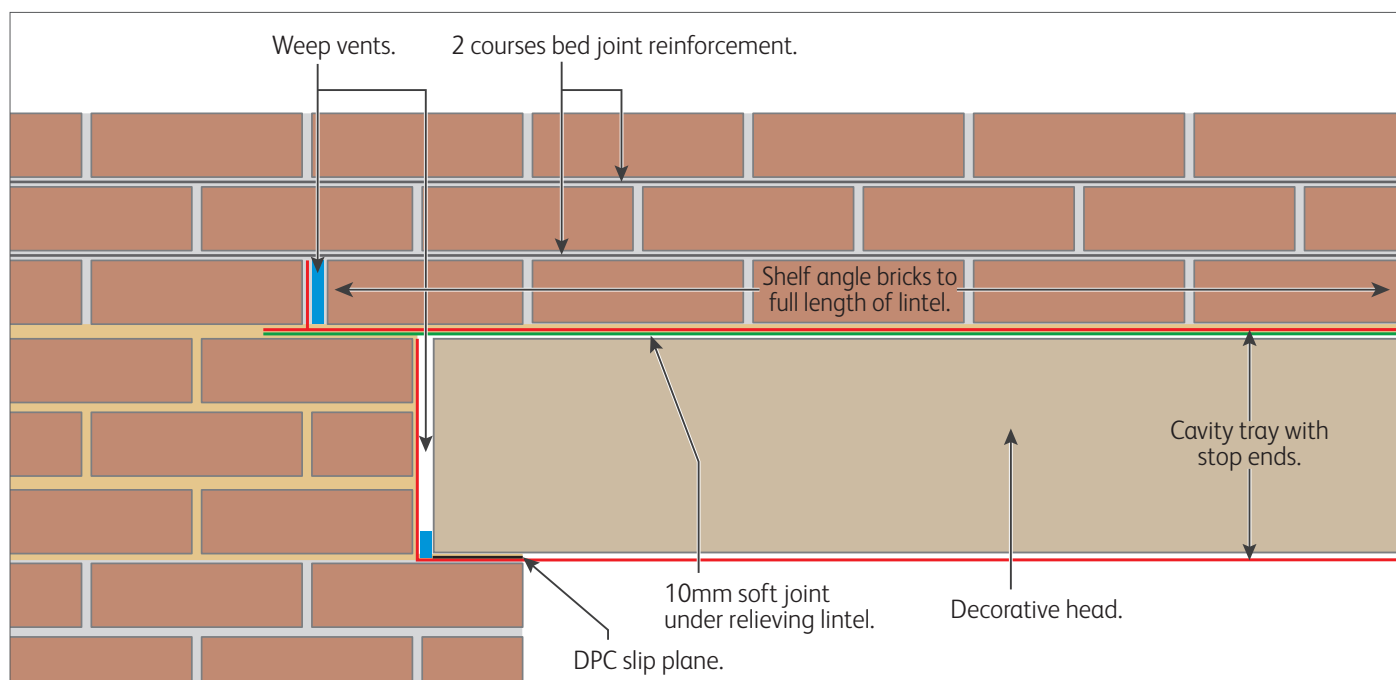

Laying the decorative head and DPC's

Brickwork setting out should allow a 10mm free joint at the end of the decorative head.

1. Bed a cavity tray with stop ends on to the supporting brickwork at each side of the opening with a 4mm mortar bed. Stop ends to run full height of unit.
2. Insert weepholes at each end. (The cavity tray will eventually need to be cut back to suit the window frame). Place DPC slip plane under bearing of head.
3. Bed the decorative head onto a further 4mm mortar ensuring it is level and in line with surrounding brickwork.
4. Leave the ends of the decorative head clear of mortar.
5. Construct the brick courses adjacent to the head.





CAST STONE **DECORATIVE HEAD WITH STEEL RELIEVING LINTEL**

Laying the lintel and secondary DPC

- 6.** Follow the lintel manufacturers installation advice. Lintels should be installed with a minimum end bearing of 150mm onto masonry past the end of the head, bedded on mortar and levelled along its length and across its width.
- 7.** In accordance with BS EN 1996-2 and NHBC requirements all external wall lintels **MUST** be installed with a flexible damp proof course. Stop ends should be provided to avoid moisture entering the cavity near the reveals.
- 8.** Either allow formation of an integral stop end at the end of the lintel or incorporate proprietary stop ends. Ensure weepholes are positioned at each end and at additional recommended spacings when required.
- 9. DO NOT BED THE LINTEL ONTO THE DECORATIVE HEAD.** A free space should be maintained between the lintel and Decorative head.
- 10.** Lay shelf angle bricks above lintel on top of the cavity tray as normal on a full bed of mortar ensuring it is in line and plumb.
- 11.** Push compressible backing cord or suitable compressible filler material into the space above and at the side of the decorative head and apply flexible sealant the same colour as surrounding.

Refer to Technical Information Sheet 5 for recommended associated materials, Technical Information Sheet 3 for mortar specification, and the Forticrete Sitework Guide for further

Note: Whilst PD6697 does not include bed joint reinforcement above and below windows/doors in brickwork (but it does in blockwork), it is now considered good practice by the BDA (Brick Development Association) and brick manufacturers to include it in brickwork. It is for this reason that we include it in our Installation Guides’.

Although the instructions contained in this publication and any other information published by Forticrete Ltd are believed to be accurate at the date of publication, they are strictly for guidance only and Forticrete Ltd accepts no liability in relation to their use or for any losses, howsoever caused. You are responsible for taking all reasonable steps to ensure your use of the product conforms to all applicable health and safety requirements from time to time. If in doubt, please consult appropriately qualified persons. All products sold by Forticrete are sold subject to Forticrete Terms and Conditions of Sale, a copy of which is available on request.

