

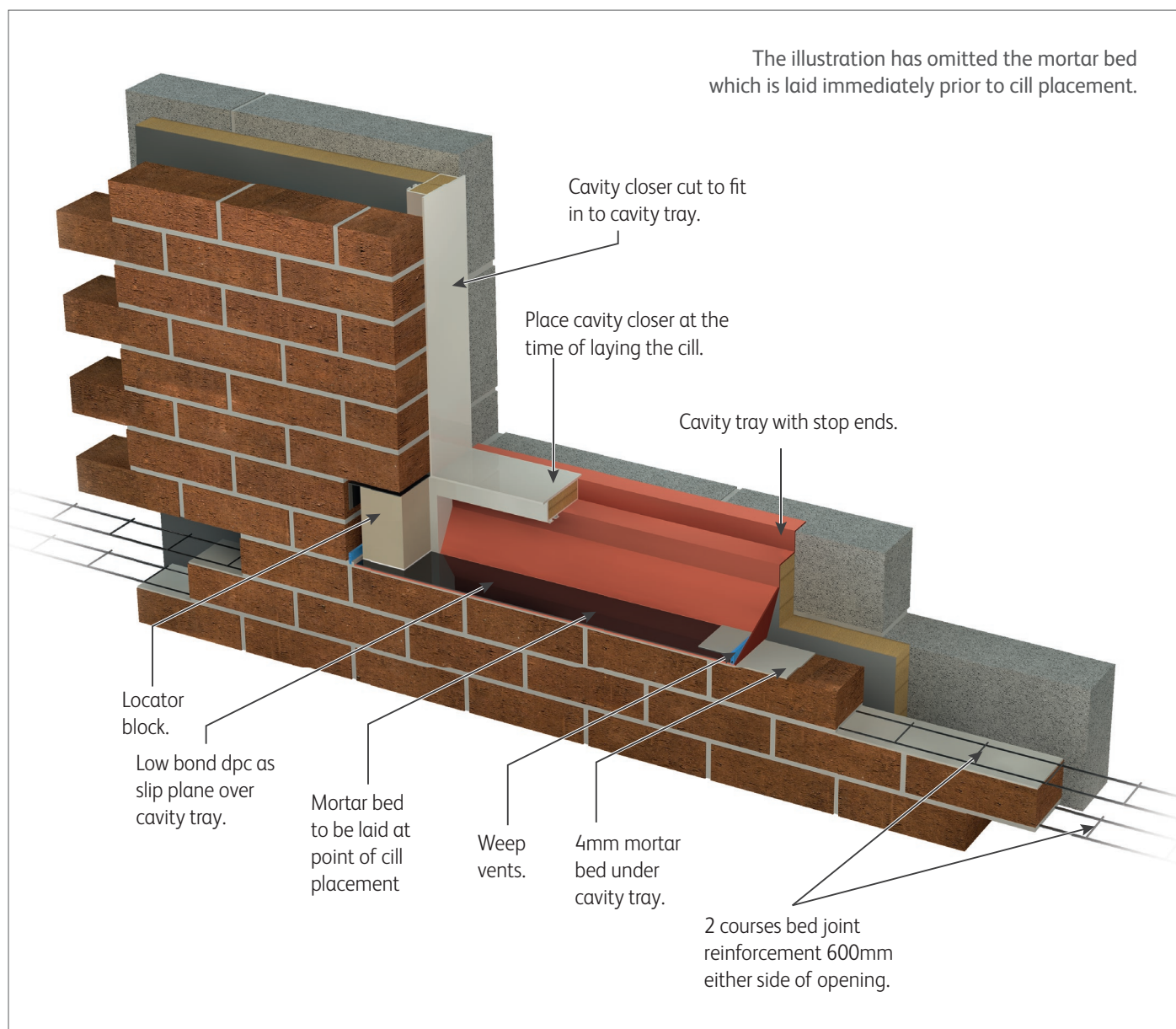

CAST STONE RETRO-FIT STOOLED CILL DETAIL

Cast stone retro-fit stooled cills are designed so each end appears to support masonry at each side of a window opening. However the main element of the cill can be fitted when construction of the building is near completion to minimise damage to the units from follow on trades.

The masonry reveals can be formed as normal with clay brick, stone block, decorative quoins or jambs resting on a pre-fitted block supplied by Forticrete. It is crucial that movement of cast stone components is accommodated.





CAST STONE RETRO-FIT STOOLED CILL DETAIL

To avoid stresses from differential movement the cill should be installed to the following guidance.

For one piece and 2 piece cills;

1. At the window opening sit the cavity tray (20mm wider than cill with stop ends), on a 4mm mortar bed.
2. Compressible weep vents should be positioned at each end of the cavity tray.
3. Place a length of low bond DPC material on top of the outer leaf surface of the cavity tray to act as a slip plane.
4. Butter the base (not side) of the Forticrete supplied supporting block and place at each end of the reveal on top of the second DPC layer. Ensure the block is bedded level with surrounding masonry and the rear side is in line with the internal cavity face.
5. To allow a slip plane, on top of the block place a 4mm mortar bed and smooth off. After hardening place a piece of low bond DPC cut to project out to the window side by 23mm, to the front by 20mm and allow enough to cover the masonry side of the locator block. Alternatively place a second square of DPC on the first and sandwich both in the top bedding mortar.
6. Construct window surround as normal ensuring masonry joints are in line and plumb.

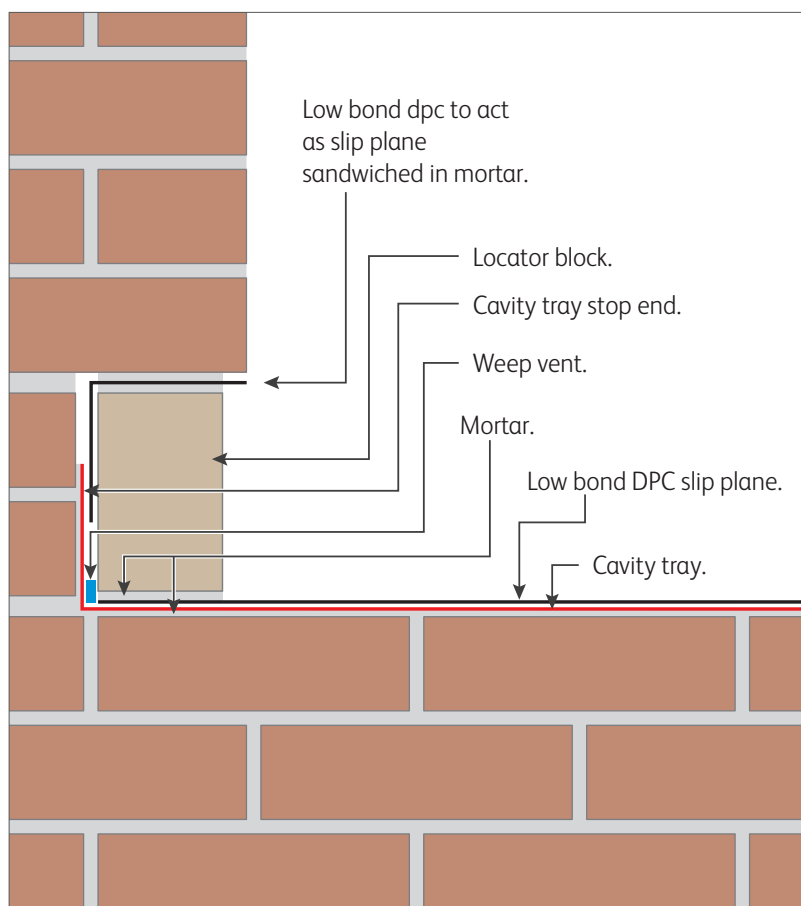

7. Protect DPC tray from follow on trades until retro-fit cills are inserted.
8. As scaffolding is removed lay 4mm mortar on the DPC layer and place the cill unit in position
9. The front of the cill should project 50mm from the facing masonry below.
10. To maintain free movement of the unit insert backing cord at the vertical ends to the unit above the weep vent and apply a suitably coloured flexible sealant.

Note: If fitting the window early temporarily prop window unit until the cill is fitted.





CAST STONE **RETRO-FIT STOOLED CILL DETAIL**

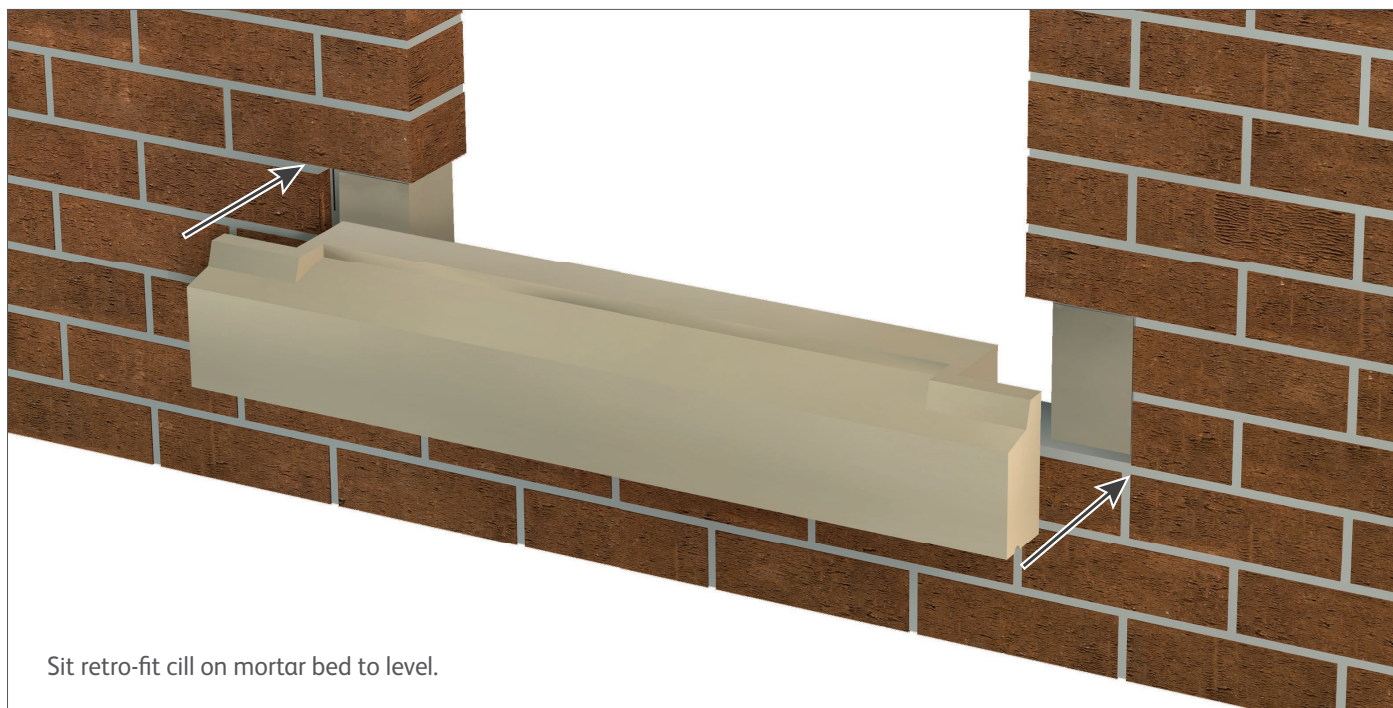

Generally when laying cast stone products mortar strength should not exceed designation (iii), 1:1:5/ 6 cement:lime:sand proportional mix. The use of lime is desirable to accommodate movement.

Mortar no stronger than strength class M4 can be specified however movement may be restricted if lime is not a constituent element.

Cracking can occur if mortar of a higher strength than recommended is used or if movement of the cill is restricted by mortar pointing.





CAST STONE RETRO-FIT STOOLED CILL DETAIL FOR RENDERED BUILDINGS

Follow guidance as per the Retro-Fit Stooled Cills for Brickwork, however at step 5 allow a greater projection of low bond DPC, acting as a slip plane, to project to the window side and front of block to accommodate the render. N.B. take DPC down wall side of locator block.

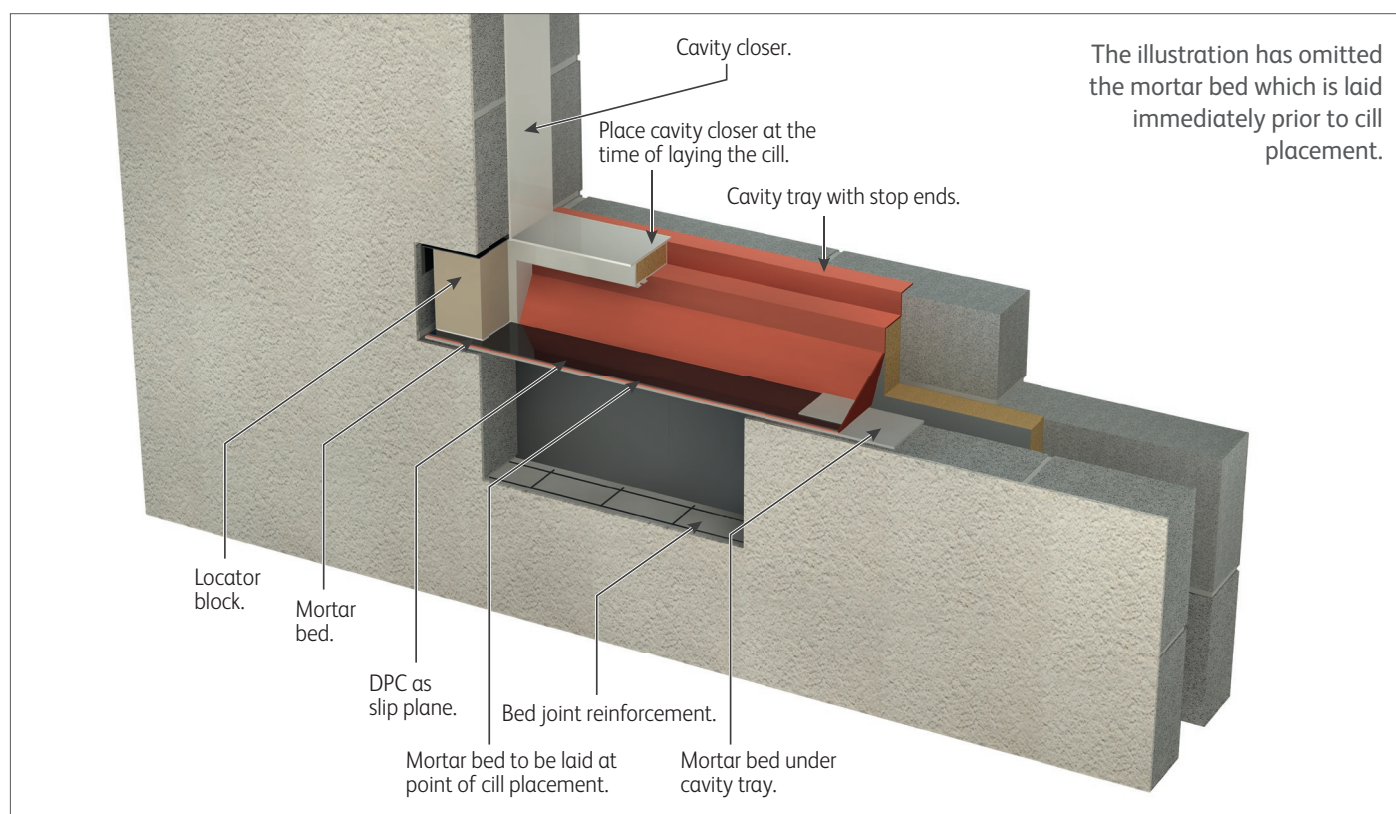

Refer to Technical Information Sheet 5 for recommended associated materials, Technical Information Sheet 3 for mortar specification, and the Forticrete Sitework guide for further information.

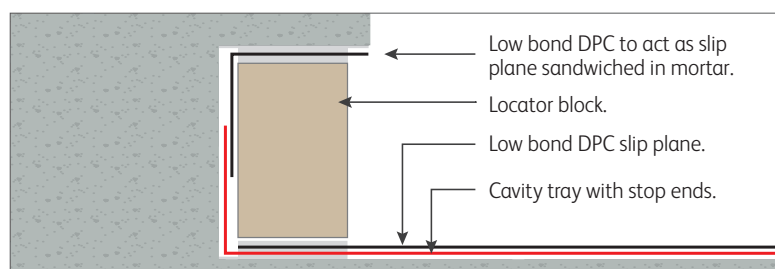

Note: Whilst PD6697 does not include bed joint reinforcement above and below windows/doors in brickwork (but it does in blockwork), it is now considered good practice by the BDA (Brick Development Association) and brick manufacturers to include it in brickwork. It is for this reason that we include it in our Installation Guides'.

Although the instructions contained in this publication and any other information published by Forticrete Ltd are believed to be accurate at the date of publication, they are strictly for guidance only and Forticrete Ltd accepts no liability in relation to their use or for any losses, howsoever caused. You are responsible for taking all reasonable steps to ensure your use of the product conforms to all applicable health and safety requirements from time to time. If in doubt, please consult appropriately qualified persons. All products sold by Forticrete are sold subject to Forticrete Terms and Conditions of Sale, a copy of which is available on request.

