

# What if the subsurface is wood ...

**Fundo Ligno® Plus & Fundo RioLigno®**

Maximum reliability when installed in or on wood



... **wedi®**



# Renovation instead of new construction

## Europe-wide decline in new residential buildings<sup>1</sup>

Renovation instead of new construction is the current trend in the construction industry.<sup>2</sup> Due to higher costs and high interest rates, the construction boom, especially for single-family homes, slowed down. **More and more people choose to buy and renovate or modernise their parents' or grandparents' house instead of buying a newly constructed building.**

Renovation projects, especially with suspended timber floors, can be full of unpleasant surprises. The extent of any possible moisture damage, instability and leaks is often only found out after stripping everything back to the substructure. In addition, renovation projects usually require quick solutions in order to make the rooms usable again.

Do you regularly face the challenge of renovating bathrooms with suspended timber floors where a flush-to-floor shower is required? The wedi Fundo range offers you safe, long-lasting and quick-to-implement solutions. Thanks to the factory-integrated slope, waterproof XPS core and thicknesses adapted to the surrounding wooden layer, you can install a new shower quickly and easily, without long drying times or waterproofing measures.

1 Source: Mercury, 20.02.2024, "Construction sector in crisis? Housing construction is taking a step backwards across Europe"

2 Source: Deutsche Handwerk Zeitung, 27.03.2024, "Construction industry: Refurbishments: the way out of the crisis"

## Our special solutions for suspended timber floors

Of course, reliable and secure: with wedi, you can **easily install floor-level showers, even in/on moisture-sensitive wooden surfaces**. Our special solutions with optimally matched components ensure maximum reliability.



- Low thickness on the outer edge (23 or 25 mm) for a flush-to-floor connection without affecting wooden beams or building up additional floor height
- Factory-integrated precise slope for appropriate water drainage despite the minimal element thickness
- Tested and waterproof overall system
- Very low weight for easy transport and handling
- wedi Fundo drain-substructure element for perfect alignment and appropriate support of the drainage

## Shower elements with point or linear drainage

Our Fundo Ligno Plus and Fundo RioLigno shower elements are perfect for suspended timber floors. The name 'Ligno', derived from the Latin word 'wood', already says everything there is to know about its special construction. These shower elements have been especially developed for installation in and on suspended timber floors. Thanks to their slim outer edges, they adapt perfectly to the wooden floor and thus ensure an aesthetic shower area with flush-to-floor access.

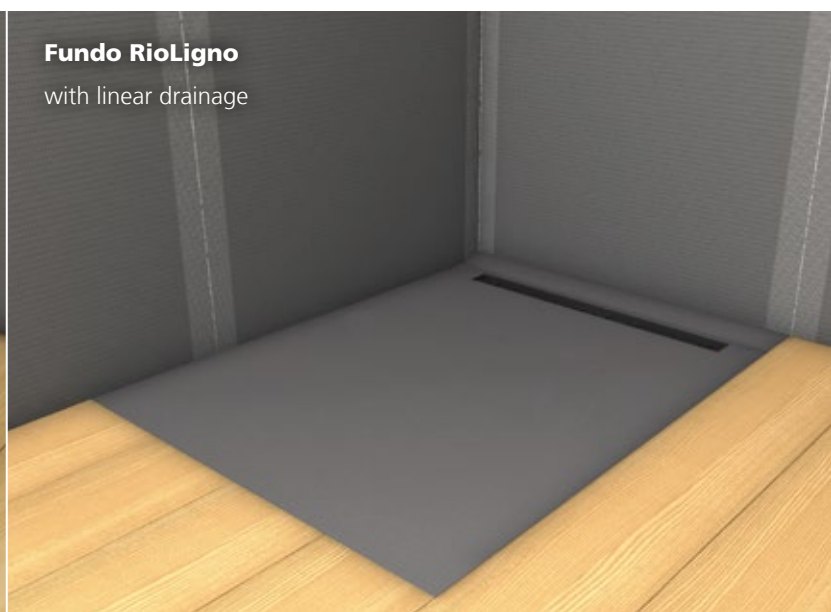
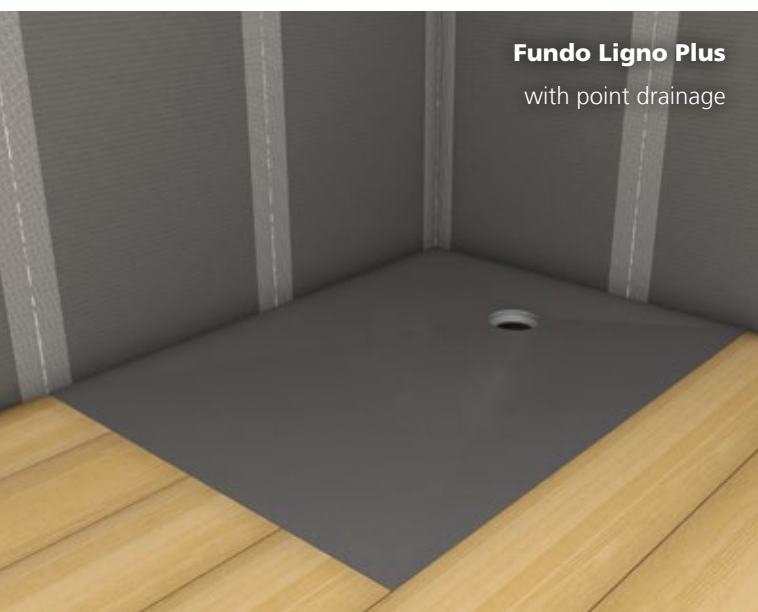



# Straight to the point: Fundo Ligno Plus®

The Fundo Ligno Plus with **point drainage** is the ideal solution for creating flush-to-floor showers on suspended timber floors. With its **thickness of only 23 mm at the outer edges**, this shower element is ideal for wooden constructions. It provides an optimal foundation for tiles or Fundo Top surfaces offering a high-quality and appealing shower solution for your customers.

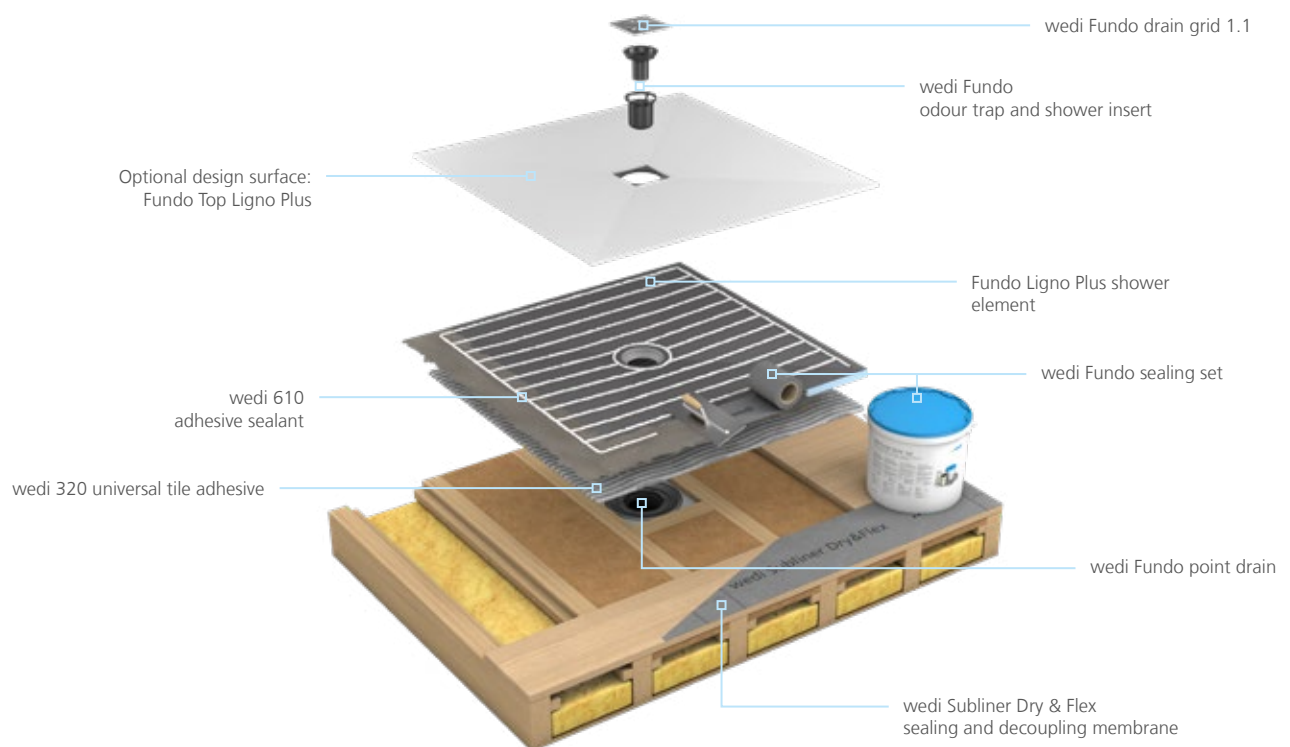

The complete installation instructions for the Fundo Ligno Plus can be found at [www.wedi.net/downloads](http://www.wedi.net/downloads)

## Installation on suspended timber floors with wedi Fundo point drain, horizontal DN 50

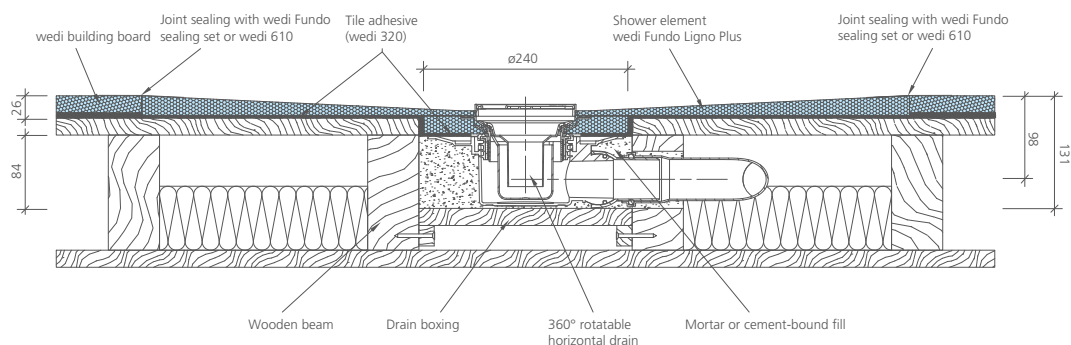

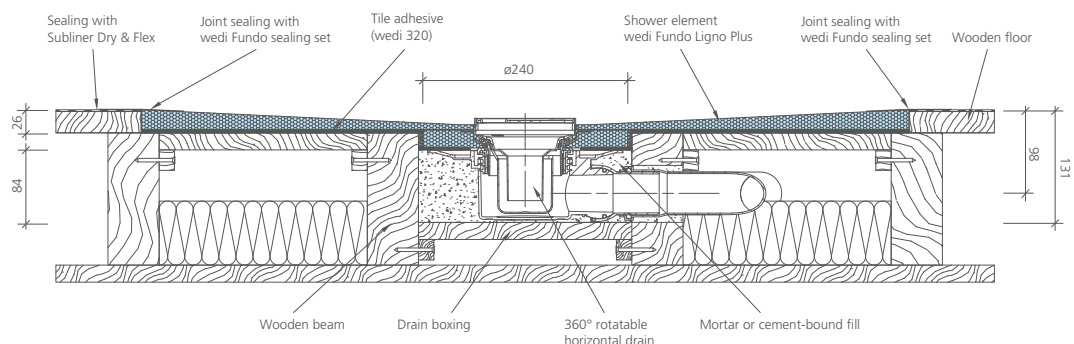

## Installation in suspended timber floors with wedi Fundo point drain, horizontal DN 50



wedi Fundo point drain	Performance measured according to DIN EN 1253	Height of drain body	Required installation height *	Height of the connecting pipe: from floor surface to middle of the pipe
horizontal DN 50	0,80 l/s; 48,0 l/min	84 mm	26/131 mm **	98 mm
Mini Max, DN 40	0,50 l/s; 30,0 l/min	55 mm	26/102 mm **	71 mm
vertical DN 50	1,10 l/s; 66,0 l/min	144 mm	26mm/191mm + HT tube connection	–

\* Installation heights listed above include 3 mm dried adhesive bed thickness

\*\* Installation height in the drainage area

	Fundo Ligno Plus	length × width × thickness	Part number
	<b>Square, drain central</b>	900 × 900 × 23 mm	072070010
		1.200 × 1.200 × 23 mm	072070017
		1.500 × 1.500 × 23 mm	072070018
	<b>Square, drain offset</b>	900 × 900 × 23 mm	072070063
		1.200 × 1.200 × 23 mm	072070064
	<b>Rectangular, drain offset</b>	1.200 × 900 × 23 mm	072070060
		1.400 × 900 × 23 mm	072070061
		1.600 × 900 × 23 mm	072070069
		1.600 × 1.000 × 23 mm	072070070
		1.800 × 900 × 23 mm	072070062

# The bottom line: Fundo RioLigno®

The Fundo RioLigno shower element with **its outer edges of just 25 mm** has been especially developed for use in wooden floors. The shower element is optimally adapted to the covering wood layer and can be easily integrated without building up additional floor height.

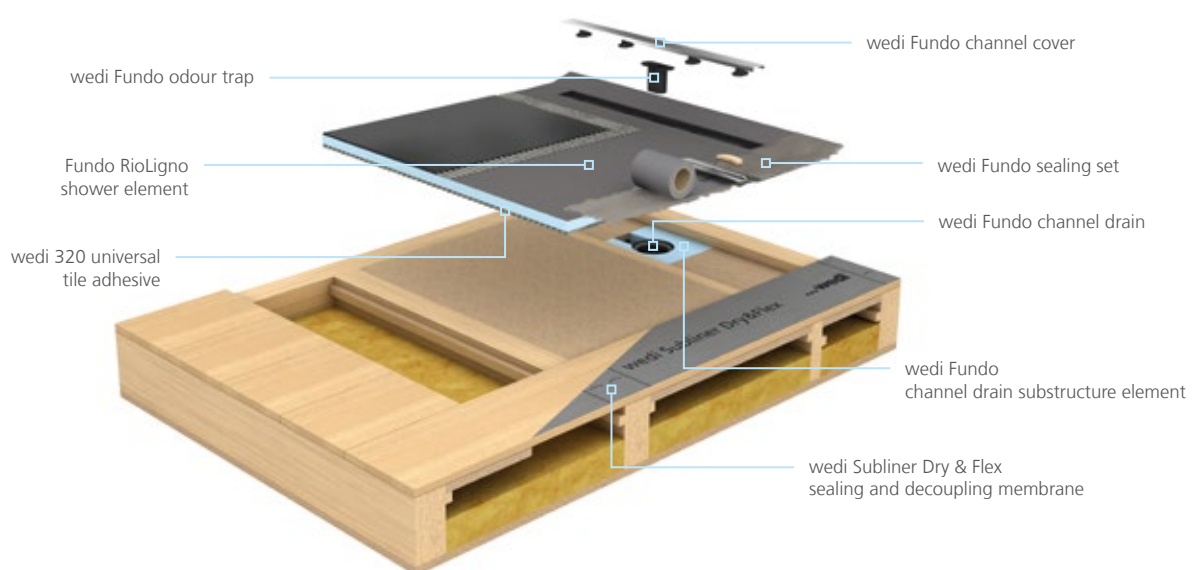

The complete installation instructions for the Fundo RioLigno can be found at [www.wedi.net/downloads](http://www.wedi.net/downloads)

## Installation on suspended timber floors with wedi Fundo channel drain, horizontal DN 50

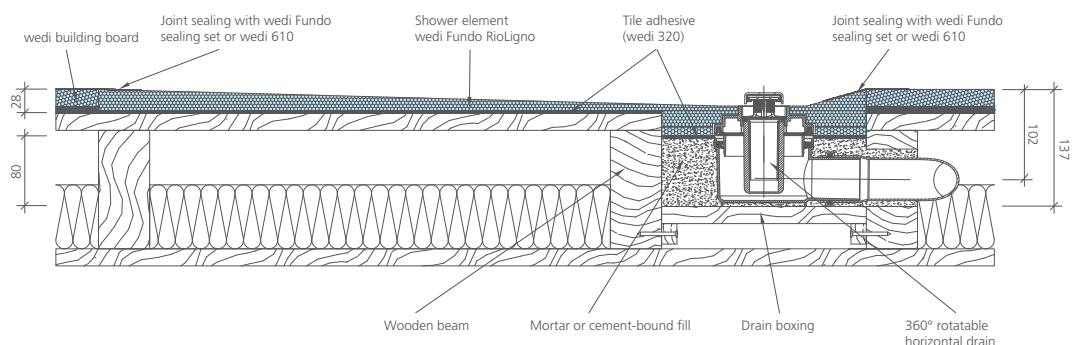

## Installation in suspended timber floors with wedi Fundo channel drain, horizontal DN 50

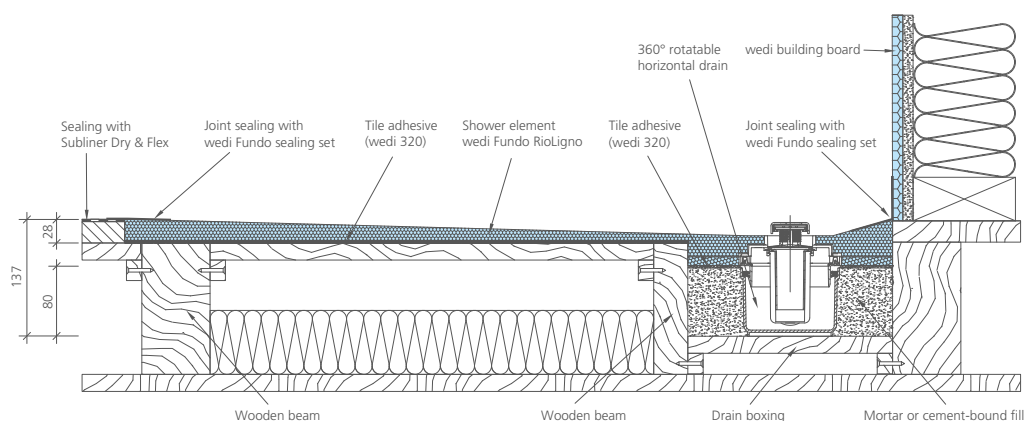

wedi Fundo channel drain	Performance measured according to DIN EN 1253	Height of drain body	Required installation height *	Height of the connecting pipe: from floor surface to middle of the pipe
horizontal DN 50	0,80 l/s; 48,0 l/min	80 mm	28/137 mm **	102 mm
Mini Max, DN 40	0,50 l/s; 30,0 l/min	49 mm	28/111 mm **	81 mm
vertical DN 50	1,10 l/s; 66,0 l/min	131 mm	28/188 mm + HT tube connection	—

\* Installation heights listed above include 3 mm dried adhesive bed thickness

\*\* Installation height in the drainage area

	Fundo RioLigno	length × width × thickness	Part number
	<b>Square, drain offset</b>		
	Channel length 700 mm	900 × 900 × 25 mm	075100200
	Channel length 900 mm	1.200 × 1.200 × 25 mm	075100202
	<b>Rectangular, drain offset</b>		
	Channel length 700 mm	1.200 × 900 × 25 mm	075100201
	Channel length 800 mm	1.600 × 1.000 × 25 mm	075100203

# Everything thought of: wedi system accessories

## wedi Fundo drain substructure element

Thanks to our close collaboration with experts such as architects, contractors and tradesmen, we are aware of how time-consuming the building of a secure and reliable drain housing can be. For this reason, so that you and your team can progress with your project in a timely manner, we offer special drain substructure elements. **Ensuring perfect alignment and appropriate support of drains in the ever moving timber floor, these elements enable a fast and secure installation** without the need for extensive formwork or filling with mortar and screed.



wedi Fundo drain-substructure element, round,  
for Fundo point drains

Length x width x thickness	224 x 224 x 82 mm
Part number	073732092



wedi Fundo linear drain substructure element,  
square, for Fundo channel drains

Length x width x thickness	240 x 240 x 85 mm
Part number	073732091



## wedi Fundo sealing set

Our wedi Fundo sealing set contains everything you need for the watertight connection of wedi Fundo shower elements to other materials. **Containing wedi 520 sealing slurry, wedi Tools sealing tape and wedi Tools sealing corners, the bucket set equips you with everything you need to securely seal 10 linear metres.** This means that you can easily connect your shower element to screed, plasterboard or other materials whilst also reliably seal the joints shared with other wedi system components.



Part number 073796000



## wedi building boards and Subliner membranes

As a planner, structural engineer or tradesman, you know that a timber construction poses special requirements that conventional building materials often cannot meet. This is where the wedi system comes into play: lightweight, waterproof and decoupling. With wedi, you have the ideal building materials to successfully master your projects and achieve the highest quality standards.

You can **use wedi building boards** in the wall and floor area as leveling, cladding and sealing. This does not only save valuable time on site, but gives you and your customers additional reassurance. The **wedi 610 adhesive sealant** guarantees a secure, waterproof butt joint between the wedi building boards in just a single step.

The **wedi Subliner range** complements the building boards; these membranes provide reliable sealing and decoupling for walls and floors alike.

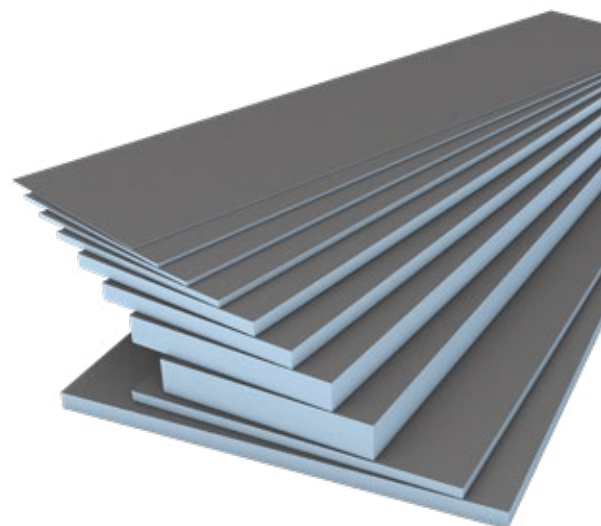

## Large selection of drain covers



wedi Fundo drain grid 1.1



wedi Fundo drain grid 1.2



wedi Fundo drain grid 1.3



wedi Fundo drain grid 4.1



wedi Fundo drain grid 4.2



wedi Fundo drain grid 5.1



wedi Fundo drain grid 2.1



wedi Fundo drain grid 2.2



wedi Fundo drain grid 2.3



wedi Fundo  
5.1 metallic black



wedi Fundo  
5.1 metallic gold



wedi Fundo  
5.1 metallic rose gold



wedi Fundo drain grid 3.1



wedi Fundo drain grid 3.2



wedi Fundo drain grid 3.3



wedi Fundo drain grid 6.1



wedi Fundo drain grid 7.1



wedi Fundo  
Top Inlay in 4 Colours



Standard wedi Fundo channel cover, stainless steel



Exclusive wedi Fundo channel cover



Standard wedi Fundo channel cover, metallic black



Tileable wedi Fundo channel cover



Standard wedi Fundo channel cover, metallic gold



wedi Fundo channel cover standard plus



Standard wedi Fundo channel cover, metallic rose-gold



wedi Fundo channel frame, in four colours as per standard versions to the left

# What if there is still more ...

The other shower elements in the Fundo range are also suitable for wooden surfaces, provided that there is enough space to allow for the required construction height. Their low weight makes it easy to move them between floors and only minimally affects the integrity of the suspended timber floor. **All Fundo shower elements are waterproof and have a factory-integrated slope, which does not only simplify installation but also minimises risks.** These elements can be combined with wedi building boards for perfect height compensation - this is how you create a flush-to-floor dream shower easily and safely!

## Classic systems with separate drain technology

Perfectly combined: with the classic Fundo shower systems, there is an appropriate drainage for every installation situation.



**Fundo Primo**  
Thickness: 40 mm

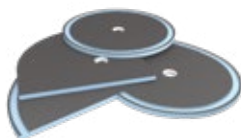

**Fundo Borgo, Fundo Trollo, Fundo Nautilo**  
Thickness: 40, 40, 50 mm



**Fundo Riolito Neo, Fundo Riolito**  
Thickness: 50/60 mm



**Fundo Riofino**  
Thickness: 50 mm

## Complete systems with integrated drain technology

Super practical, super safe: for all complete Fundo shower systems, the drainage is set, already integrated into the shower element during the manufacturing process.



**Fundo Integro**  
Thickness: 90 mm  
Pipe connection DN 50



**Fundo Plano**  
Thickness: 65 mm  
Pipe connection DN 40



**Fundo Plano Linea**  
Thickness: 70 mm  
Pipe connection DN 40

## Fundo benefits at a glance

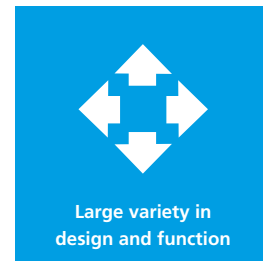
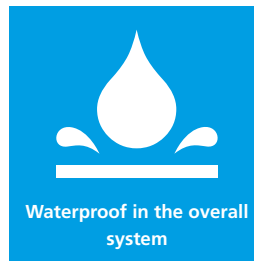
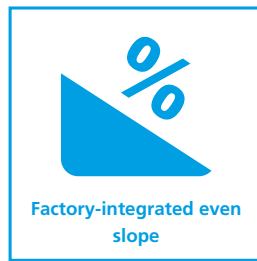
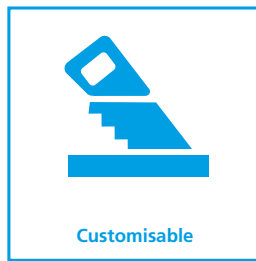

## wedi Shower Configurator

A flush-to-floor shower can be planned quickly and easily using the wedi Shower Configurator. It does not only guide you step-by-step through the many options, but also recommends wedi products suitable for the individual installation situation set by you.



Get started now at  
[www.wedi.net/uk/  
shower-configurator/](http://www.wedi.net/uk/shower-configurator/)

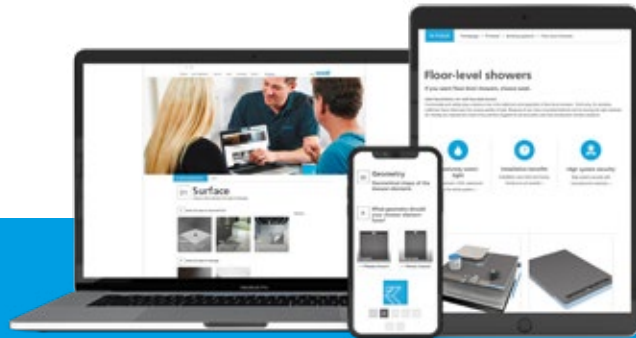

...wedi®

Unit 4 Mercury Park, Mercury Way  
Trafford Park, M41 7LY  
Great Britain

Phone + 44 (0) 161 864 2336

info@wedi.co.uk

www.wedi.net



AV/BAC  
Subject to technical modifications. Images similar.

UK