

AX95

SWING DOOR DRIVE UNIT



POWERFUL, BUT QUIET-RUNNING

The robust Axis AX95 swing door drive unit is designed for quiet, reliable operation.

MORE USER FRIENDLY

The Axis AX95 swing door drive unit is designed for the automation of new or existing doors - from light internal doors to heavyweight external doors.

The Axis AX95 makes doors significantly easier to operate. Contactless opening and closing also fulfils the most demanding hygiene requirements, while helping to ensure trouble-free entry and exit.

FLEXIBLE, FUNCTIONAL APPLICATIONS

Wherever people work, living and are cared for or congregate, there are doors that tend to hinder their comings and goings. The automation of these doors offers smooth access with hygienic, obstacle-free entry and exit.

Possible configurations

- Single leaf or double door
- Special solutions

Versatile Application

Axis swing door drive units are ideal for new installations or building upgrades. Lightweight doors, external doors and even fire doors can be automated with ease.

Individual

Thanks to the wide range of options available, the user is sure to obtain a fully-customised, automatic door.

Smooth, Quiet Operation

The electro-mechanical drive unit ensures that the door operates quietly and smoothly.

Maximum Reliability

The use of top-quality components guarantees reliability to match, plus a long service life and minimal maintenance.

Functional

The wide range of available options delivers customer-specific automatic solutions.

ONE DRIVE MECHANISM – MANY POSSIBLE APPLICATIONS

The Axis AX95 swing door drive unit is highly consistent when it comes to performance, long service life and quiet running. From light internal doors to heavyweight external doors designed to withstand high winds – the Axis AX95 is always the right choice! The smooth lines of the Axis AX95 make it compatible with any architectural design. It adds value to the various applications in which it is used, thereby enhancing the overall aesthetic approach. A reliable drive mechanism for virtually any application combined with the right accessories.

- Low energy and full automatic modes
- Single or Double Leaf installations
- Heavyweight external doors
- Interlock function



ADJUSTABLE FUNCTIONS

- Low-Energy / full-power
- Safety monitoring with automatic stop/reverse mechanism
- Wind-load regulation
- Control of opening and closing speed, hold-open time and motor power
- Push & Go Function
- Automatic closing sequence control for double leaf configurations
- Reinforced closure (forced engagement of lock)
- Acoustic signal during movement of the door leaf

OPTIONAL / EXTENDABLE

- Connection of electric locks / locking mechanism
- Remote-control systems
- Casing in stainless steel or aluminium
- Fully-enclosed housing
- Integrated opening end-stop
- Inverted drive configuration
- Operating-status display:
 - In the drive mechanism or on an external control unit
 - Acoustic: door opens/closes
 - Dry contact for transmission of data to the building's central control system

DAY-TO-DAY RELIABILITY

Axis automatic doors offer maximum user-friendliness combined with advanced safety features.

Automatic doors used in the public sector have to conform to EN 16005. Various configurations are possible, depending on the application. The specialists at Axis Automatic Entrance Systems will be pleased to answer any questions that you might have.

Swing door drive units supplied by Axis Automatic Entrance Systems are fully certified, and designed to conform to the highest quality and safety specifications. The robust design of the Axis AX95 makes it resistant to attack and the TÜV safety tested drive mechanism is designed to ensure smooth, automatic operation. A series of compatible safety elements ensures optimum protection. If the Low-Energy function is configured, the system can even do without safety sensors.

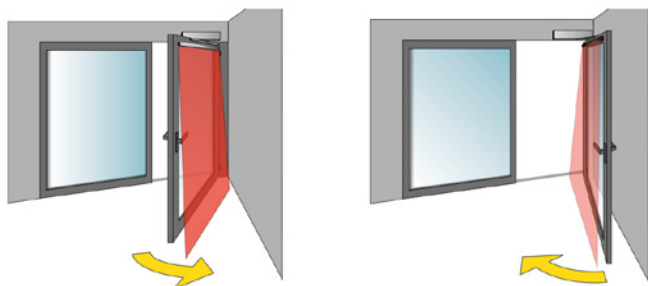

Safety sensors with "Reverse" and "Stop" functions offer additional protection for pinch points. The "blanking" function is configured via the drive unit to guarantee optimum performance.



Activ infrared safety sensor



Finger protection

CONTROL ELEMENTS



Sensor



Remote radio control



Range of push buttons



Integrated program selector keys



D-BEDIX (optional)

PROGRAM SELECTOR KEYS

The buttons on the side of the drive mechanism are used to select the desired operating mode. The selected button lights up to give an immediate indication of the active operating mode. The buttons can be disabled, depending on the situation. All settings can likewise be configured with the optional D-BEDIX control unit.



SELECTION AND PLANNING CRITERIA

Choose the right type of installation for your needs.

Various installation and configuration options are offered to match requirements. Find out which variant is the best for you:

Installation and arm configuration options

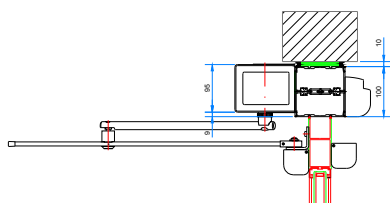

Outswing Rod Push Arm (100mm Section)

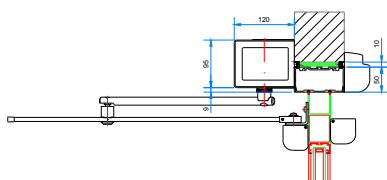

Outswing Rod Push Arm (50mm Section)

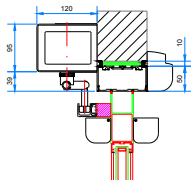

Inswing Tracked Pull Arm (50mm Section)

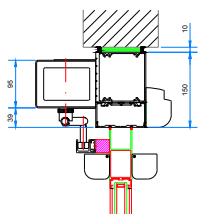

Inswing Tracked Pull Arm (150mm Section)

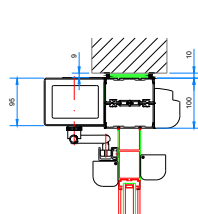

Outswing Tracked Push Arm (100mm Section)

TECHNICAL SPECIFICATIONS

Application limits:

Max. leaf weight	250 kg
Door sizes EN 3-7	(850 – 1600 mm)
Door sizes fire doors EN 4-6	(950 – 1400 mm)
Max. opening angle	105°
Tested in accordance with	DIN 18650, EN 16005
	Fire-prevention version included in approval procedure

Application limits with sensory system / low-energy

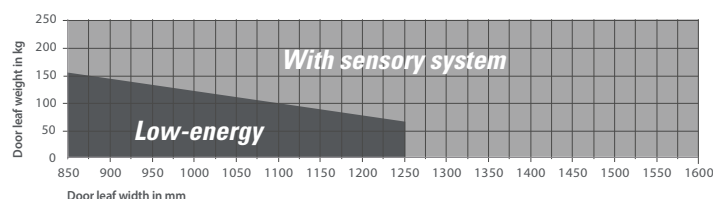

Power transfer: Standard rods (pushing function)

Sliding rods (pushing and pulling function)

Dimensions of drive mechanism: height 95 mm, width 690 mm, depth 120 mm

Weight of drive mechanism: 10,5 kg

Ambient temperature: -15 to +50 °C

Protection rating: IP 40

Operating voltage: 230 VAC (+10/-15 %), 50 Hz, 10/13 A

Power consumption of drive mechanism: max. 560 W

Rated motor capacity: 100 W

Power supply, external user: 24 VDC (±10 %), 2 A

Output shaft torque: max. 80 Nm

Lintel depth standard rods: max. 250 mm

Lintel depth sliding rods: -30 / +140 mm

Opening speed: max. 40°/s

Closing speed: max. 40°/s

Relative humidity: max. 85 %

Sliding Rod for inward opening door (and internal outward opening door)

Standard rod for outward opening door

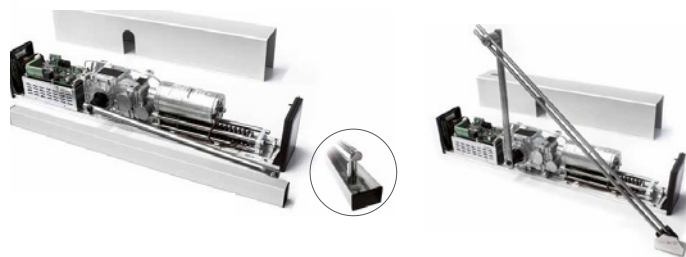

Axis Automatic Entrance Systems Ltd

Unit 6, Queens Park Industrial Estate, Studland Road,
Northampton, NN2 6NA.

Tel: 01604 212500 · Fax 01604 212495

Email: sales@axisautomatic.com

www.axisautomatic.com

