



**Brick faced external
wall cladding system**

P-Clad is a brick faced external wall cladding system. Developed by Eurobrick® for use as a rainscreen on structures requiring a cavity behind the cladding.

Benefits

- Versatile, fast and simple to install.
- Designed for installation to all construction types, including timber frame, masonry, light gauge steel, SIPS (with or without cavity), dense or no fines concrete.
- Ideal rainscreen for prefabricated structures.
- Indistinguishable from traditional brick work.
- Durable, with a life span of over 25 years.
- P-Clad is suitable for installation on residential buildings up to 11m high and commercial buildings up to 18m high.
- Wide range of kiln fired clay brick slips available. These include cut slips (Classic Range) and extruded slips (Britannia Range), please refer to our Product Guide for more information. All are FL Grade and suitable for internal and external applications. Slips can be cut from other bricks to suit project requirements if the standard selection is not suitable.
- Pointing mortar is available in eight standard colours to complement or contrast with the bricks.

Technical information

- Designed to be fixed to battens or metal rail systems
- The composite backer panel comprises a 10mm thick cement particle board with Eurobrick's high impact polystyrene ribbed skin pre-bonded to it. The horizontal ribs align and support the brick slips so that brick courses are formed accurately and easily.
- 10mm thick slimline profile of the backer panel provides system depth from 25mm and installed system weight from 53kg/m² (excluding supporting structure or mechanisms).
- System includes panels, fixings, adhesive, brick slips and pointing mortar. Ancillary products include corner bricks, base trim and installation tools such as adhesive guns and pointing bags.
- Euro Classification of Reaction to Fire EN13501-1: 2018; Class B-s1, d0

Installation

P-Clad can be fixed to timber or light gauge steel framed walls either with or without a drainable cavity. Please note that the studs must be positioned to meet the system fixing requirements. Please refer to Installation Instructions and fixing layout diagram.

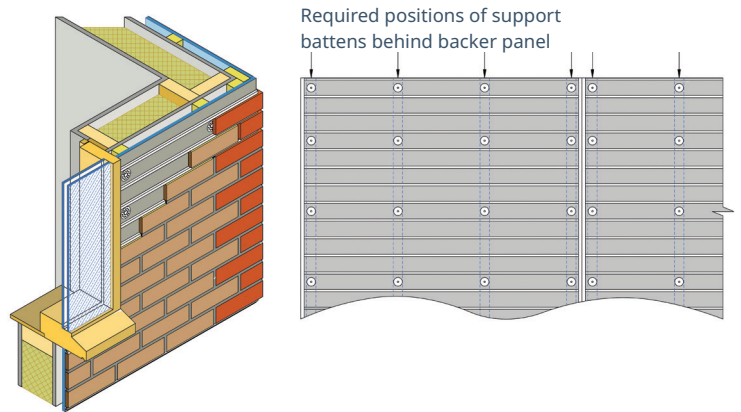

NB. Additional detail drawings are available on our website. Please note that Eurobrick cladding systems must be installed in accordance with the Installation Instructions.



1. The ribbed backing panel is fixed to the substrate.



2. Brick slips are attached with permanent bonding adhesive.



3. Specially formulated mortar is then piped into the brick joints.



4. Mortar is tooled in the manner of traditional pointing.



For technical queries or further advice on ordering please call
+44 (0)117 971 7117



For more information please visit our website at
www.eurobrick.co.uk