



**Brick faced external  
wall insulation system**



**X-Clad is a brick faced external wall insulation (EWI) system suitable for modular, new build and retrofit projects.**

## Benefits

- X-Clad is ideal for finishing new build structures. It is lightweight and has a slim profile.
- X-Clad can also be retrofitted to an existing substrate without the need for additional foundations or groundworks, reducing time and disruption on site.
- Indistinguishable from traditionally constructed brickwork, extremely low maintenance and has a life span of at least 25 years.
- Transforms not only the external appearance of the property but internal comfort conditions too. The building is warmer and drier as X-Clad can help to eliminate damp and condensation problems.
- Insulates: saving energy, reducing heating bills and carbon emissions.
- Wide range of kiln fired clay brick slips available. These include cut slips (Classic Range) and extruded slips (Britannia Range), please refer to our Product Guide for more information. All are FL Grade and suitable for internal and external applications. Slips can be cut from other bricks to suit project requirements if the standard selection is not suitable.
- Pointing mortar is available in eight standard colours to complement or contrast with the chosen brick.

## Technical information

- The composite backer panel comprises an extruded polystyrene sheet with Eurobrick's high impact polystyrene ribbed skin pre-bonded to it. The horizontal ribs align and support the brick slips so that brick courses are formed accurately and easily.
- The insulated backer panel of X-Clad is closed cell extruded polystyrene with a BRE Green Guide Rating of A. It can be provided in a range of thicknesses to provide 17-100mm insulation. The thermal conductivity of the panel, the K-Value, is 0.033W/mK. Project specific U-Value calculations can be provided if required.
- Using the 17mm thick backer panel the system provides a profile with a depth starting from 33mm and installed system weight from 36kg/m<sup>2</sup>.
- 17mm thick X-Clad Euro Classification of Reaction to Fire EN13501-1: 2018; Class B-s1, d0
- 50mm thick X-Clad with MS55 high grab adhesive achieved EN13501-1: 2018; Class B-s1, d0
- 100mm thick X-Clad Euro Classification of Reaction to Fire EN13501-1: 2018; Class E

## Installation

X-Clad can be fixed to masonry, concrete, timber or light gauge steel framed walls, SIPS and ICF, with or without a drainable cavity. When fixing direct to stud frames, the studs must be positioned to meet the system fixing requirements.

Please refer to Installation Instructions and fixings layout diagram.

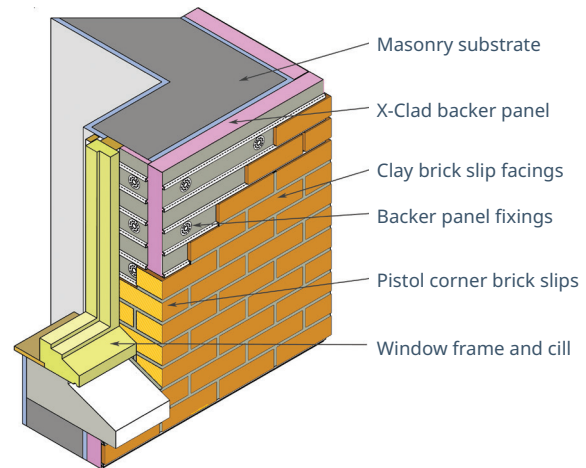

NB. Additional detail drawings are available on our website.

Please note that Eurobrick cladding systems must be installed in accordance with the Installation Instructions.



**1.** The ribbed backing panel is fixed to the substrate. (Fixings vary according to substrate.)



**2.** Brick slips are attached with permanent bonding adhesive.



**3.** Specially formulated mortar is then piped into the brick joints.



**4.** Mortar is tooled in the manner of traditional pointing.



For technical queries or further advice on ordering please call  
**+44 (0)117 971 7117**



For more information please visit our website at  
**www.eurobrick.co.uk**

©2024 Eurobrick System Limited. All rights reserved.