

SOFT TOUCH SELF CLOSING BASIN TAP

PRODUCT CODE
6810 TDH/C

AUGUST 2014



Special Features

- ▲ SOFT TOUCH OPERATION
- ▲ SELF CLOSING
- ▲ WATER AND ENERGY SAVING
- ▲ HIGH POLISH CHROME FINISH
- ▲ SUPPLIED WITH HOT AND COLD INDICES

Description

The soft touch self-closing non-concussive basin tap is particularly suitable for use by children, the elderly or disabled people as it requires less than half the normal force or hand pressure to operate when compared to traditional timed flow taps. The automatic timed flow shut off provides savings in both water usage and energy in all public, commercial and industrial environments. The tap provides approximately 9 seconds duration of flow when the push button top is depressed. The tap is sold singly and is suitable for either a hot or cold water supply with each tap being supplied with a choice of red (hot) or cold (blue) indices or a flow limiter to reduce flow to a maximum of 6 l/min. The tap projection is 105mm from the centre line of the inlet to the centre line of the outlet.

Construction

The soft touch self closing non-concussive basin tap is manufactured from brass and has a high polish chrome finish. Supplied with a 1/2 in BSP male inlet connection.

Dimensions

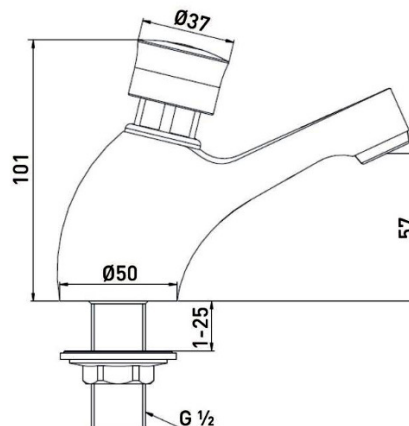

Pressures and Operating Conditions

Maximum operating pressure: 5.0 bar
 Minimum operating pressure: 0.5 bar
 Maximum inlet temperature: 65°C
 Timed flow: 9 seconds approximately
 Maximum basin thickness: 25 mm
 Operating force at 0.5 bar: 1.18 kg or 11.57 Nm
 Operating force at 5.0 bar: 1.70 kg or 16.67 Nm

Note:

Conventional timed flow taps typically require 3.00 Kg at 0.5 bar and in excess of 5.00 kg at 5 bar.

Order Code

6810TDH/C Soft touch self closing basin tap (single tap)

