

Framing Channel Systems

Flexible, versatile, and cost-effective solutions for modular steel frameworks, ensuring ease of installation and reliable performance. Engineered for durability and adaptability to meet the demands of modern construction projects.

Product Brochure - HAZ-BR-FR-EN/01.25

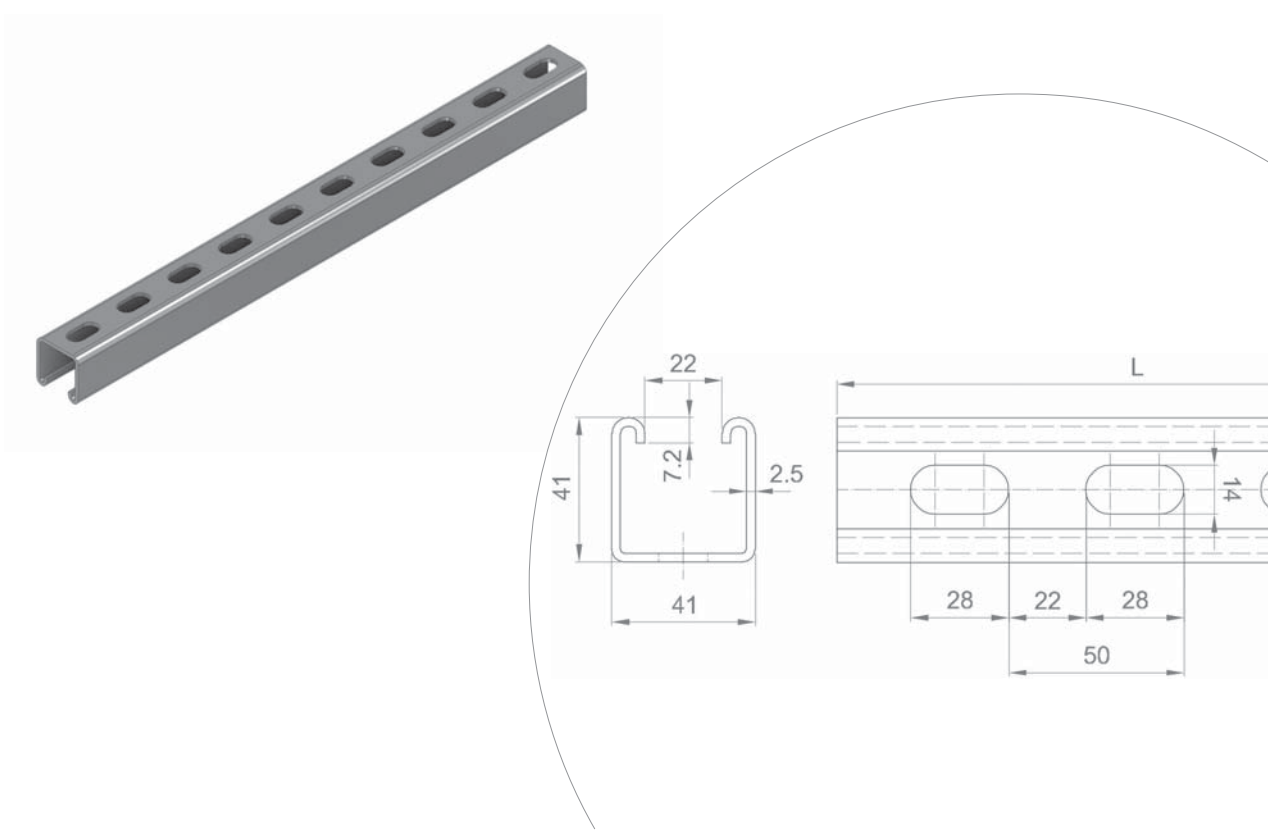



Contents



HAZ Metal Fixing Systems
is a member of HAZ Group of Companies

Framing channels - overview	1
Framing channels - product range	3
Framing channels - technical details	5
Cantilever brackets - Introduction	7
Cantilever brackets-technical details	8
Channel connections - Introduction	9
Channel connections - product details	10
T head bolt & lock nuts - product details	11
HMCI concrete inserts - product details	13
Accessories	14
Framing channels summary page	15



HAZ Metal is certified with integrated management
systems by TUV SUD for ISO 9001:2008, ISO 14001:2004
& OHSAS 18001:2007

HAZ Metal Fixing Systems. All rights reserved. February 2024. Reproduction and distribution of the
information contained in this catalogue is forbidden without prior written consent. HAZ Copyright.

Framing Channels - overview

HMP Framing systems with channels and various accessories are used to build steel framework constructions. Efficient modular support structures are built quickly and easily. Flexible and low cost application is achieved.

Framing systems consist of roll formed steel and stainless steel channels which are supplied with suitable T bolts and lock nuts to build secondary structures for various types of applications in construction.

Attachments of any kind of elements are achieved with T bolts or lock nuts. Bolting is made freely at the desired position along the length of the channels. Some of the areas of use consist of pipe and duct installation, machinery set ups, mechanical and electrical installations. The use of framing systems eliminates drilling and welding on site therefore resulting in safe and quick commencement of construction works.

Channels are supplied either plain or with perforated slotted or round drilled holes. Channels are available in stainless steel 1.4301 & 1.4401 and hot dip & electro galvanized galvanised mild steel 1.0038 & 1.0976 (S235JR & S355MC).



HMPB C Channels

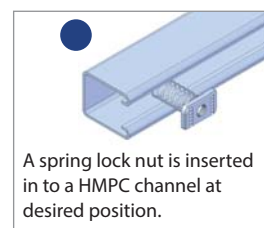

HMPC C Channels

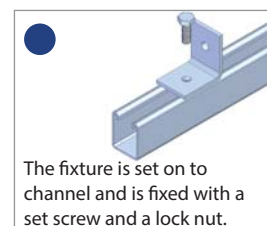
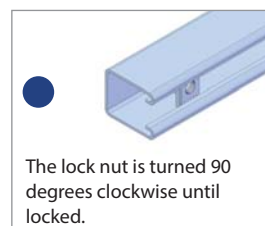

HMPD C Channels

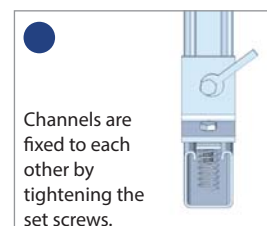
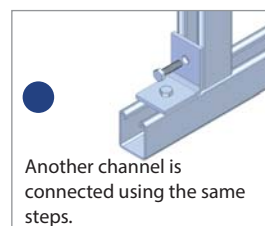

HMPA U Channels



HMPL L Channels



- a. HMPB Channel
- b. HMLN Lock nut
- c. HCC Channel connection
- d. DIN 933 Set screw

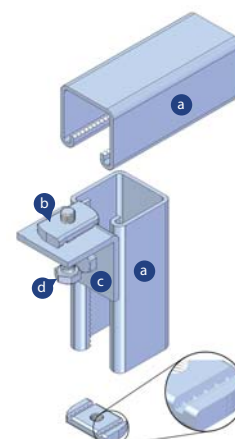



Advantages:

- Fast and Secure fixing.
- No time consuming welding and hole setting.
- No use of welding and drilling equipment.
- Adjustable and non-slip point fixing.
- Cost effective and flexible.
- Quick and easy fixing.
- Can be re-used.
- No special tools.

HAZ Metal manufactures cold rolled channels up to 6 metres in length in stainless steel and hot dip galvanised steel. Various accessories such as brackets, connection parts, lock nuts are available to complete the framing systems.



Framing systems are assembled without the need of welding. Suitable connection parts, lock nuts and DIN 933 set screws are used together to assemble the channels together formulating a steel construction. Various formations can be made to withstand the loads required.



Framing systems are widely used for the installation of pipes. Channels are fixed on to steel beams with connection elements. Fixing of pipe clamps with threaded rods are quickly and easily made on to the channels using lock nuts. The adjustability of this system is ideal for economic installation.



Mechanical, plumbing and electrical utilities are installed using framing systems. Channel systems and its accessories provide easy and efficient solutions to meet any project's requirement. The flexibility of the framing systems offers endless formation to suit any type of application.



The combination of channels, brackets and channel connections allows the building of frames that are self standing. The frame work can be fixed on to the concrete ground. The modular frame works provide efficient and reliable solutions for various applications such as pipeline installation, machinery assembly and electrical fittings.

HMP Framing channels - product range

HMPB type C channels - cold rolled

Cold rolled framing channels with 90 degree inclined lips suitable for light duty loadings. HMPB type C channels are available plain and slotted in maximum 6 metre lengths. Available in stainless steel grade 1.4301 & 1.4401 and hot dip & electro galvanized mild steel.

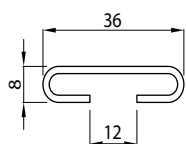
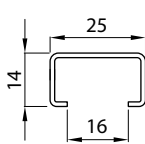
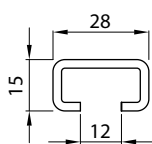
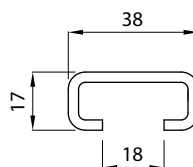
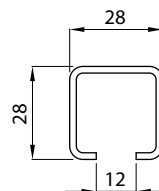
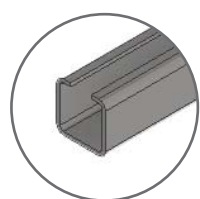
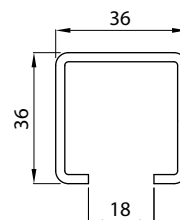
HMPB-36/8

HMPB-25/14

HMPB-28/15

HMPB-38/17

HMPB-28/28

HMPB-36/36

*Plain channels without
drilled holes (type P)*



*Channels with drilled holes
(type S)*



HMPC & HMPS type C channels - cold rolled

Cold rolled channels with 180 degree inclined lips suitable for medium duty loadings. HMPC channels are available plain, slotted and back to back versions. Channels are produced in maximum 6 metre lengths. Available in stainless steel grade 1.4301 & 1.4401 and hot dip & electro galvanized mild steel.

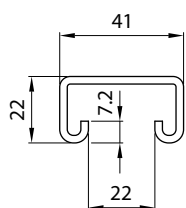
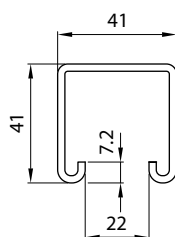
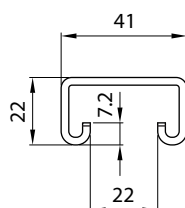
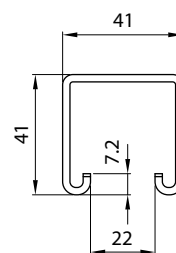
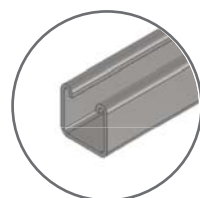
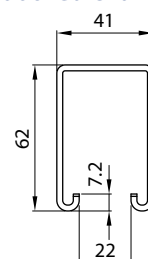
HMPC-41/22

HMPC-41/41

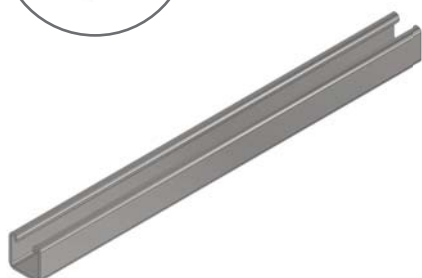
**HMPS-41/22
Toothed channel**

**HMPS-41/41
Toothed channel**

**HMPS-41/62
Toothed channel**

*Plain channels without
drilled holes (type P)*



*Channels with drilled holes
(type S)*



*Back to back channels
(type B)*

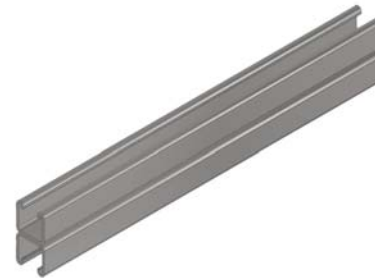

HMP Framing channels - product range

HMPD C Channels

Channels with 135 degree inclined lips. HMPD channels are available plain and slotted in maximum 6 metre lengths. Available in stainless steel grade 1.4301 & 1.4401 and hot dip & electro galvanized mild steel.

HMPD-40/25

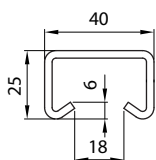

HMPD-49/30

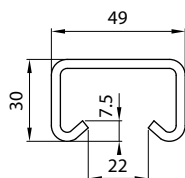

HMPD-54/33

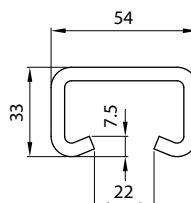

HMPD-72/49

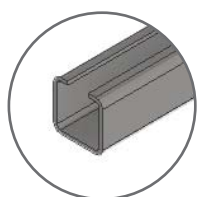
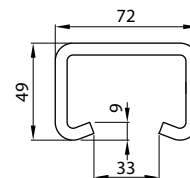

Plain channels without drilled holes (type P)

Channels with drilled holes (type S)

HMPD-H C Channels

HMPD-H hot rolled framing channels are supplied in up to a maximum 6 metres in lengths. Available in hot dip galvanized mild steel.

HMPD-H-40/22

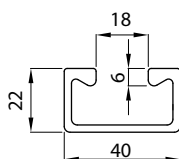

HMPD-H-50/30

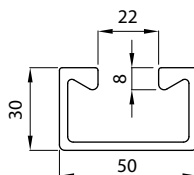

HMPD-H-52/34

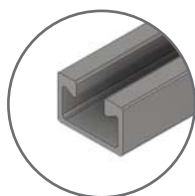
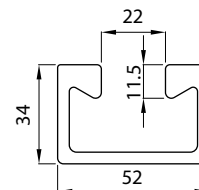

Plain channels without drilled holes (type P)



Channels with drilled holes (type S)



HMP-Z C Channels

HMP-Z toothed hot rolled framing channels are supplied in up to a maximum 6 metres in lengths. Available in hot dip galvanized mild steel.

HMPD-Z-29/20

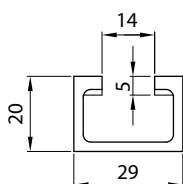

HMPD-Z-38/23

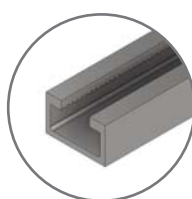
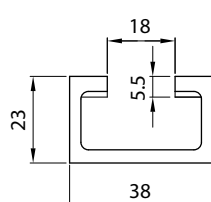



Plain channels without drilled holes (type P)

Channels with drilled holes (type S)

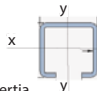

HMP Framing Systems - product details

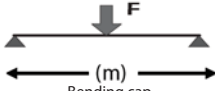
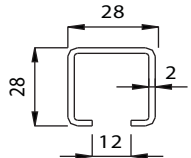
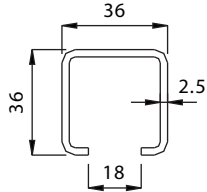
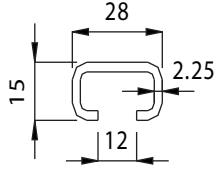
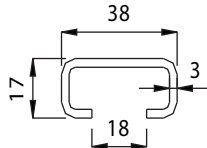
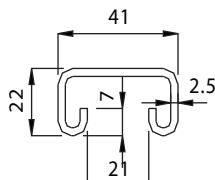
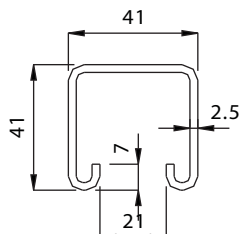
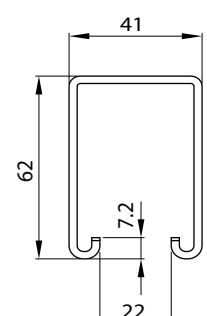
Channel Type	Technical Details									
	Product	Cross Section					 Point loading	 Bending cap.		
			A cm ²	I _x cm ⁴	I _y cm ⁴	W _x cm ³		W _y cm ³	kN Span cm	0.5 (kN)
	HMPB-S-28/28	1.48	1.32	2.10	0.95	1.50	3.00	1.50	0.70	0.30
	HMPB-P-28/28	1.73	1.70	2.13	1.08	1.52	3.00	1.90	0.90	0.40
	HMPB-S-36/36	2.39	3.55	5.68	1.92	3.15	4.40	3.30	1.60	0.80
	HMPB-P-36/36	2.76	4.40	5.75	2.12	3.19	4.40	3.90	1.90	1.00
	HMPB-S-28/15	1.16	0.31	1.35	0.39	0.96	3.90	0.69	0.17	0.08
	HMPB-P-28/15	1.36	0.37	1.37	0.42	0.98	3.90	0.81	0.21	0.09
	HMPB-S-38/17	1.76	0.60	3.93	0.68	2.07	4.80	1.28	0.36	0.18
	HMPB-P-38/17	2.22	0.76	4.02	0.75	2.12	4.80	1.40	0.40	0.19
	HMPB-S-41/22	1.99	1.15	5.34	0.89	2.60	5.60	1.50	0.50	0.20
	HMPB-P-41/22	2.36	1.39	5.40	0.99	2.63	5.60	1.80	0.60	0.20
	HMPB-B-41/22	4.75	6.02	11.11	2.91	5.38	5.60	2.20	1.40	0.80
	HMPB-S-41/41	2.96	5.90	8.88	2.82	4.33	5.60	4.70	2.30	1.40
	HMPB-P-41/41	3.31	7.00	8.93	3.04	4.36	5.60	5.40	2.70	1.70
	HMPB-B-41/41	6.81	37.60	18.80	9.10	9.14	5.60	6.90	4.50	3.10
	HMPB-S-41/62	4.18	12.20	18.70	5.10	8.90	5.60	4.50	2.20	1.30
	HMPB-P-41/62	4.46	13.10	20.90	7.20	8.60	5.60	5.30	2.60	1.60
	HMPB-B-41/62	8.88	112.88	26.68	18.21	12.92	5.60	6.90	4.50	3.10

•Standard lengths are 3 or 6 meters

•Load values are according to Euro codes EN 1993-1

•Point load capacity is of the channel lips

•Structural calculations submitted upon request

•For more detailed technical information refer to the technical catalogue

•Standard lengths are 3 or 6 meters

•Load values are according to Euro codes EN 1993-1



•Point load capacity is of the channel lips

•Structural calculations submitted upon request

•For more detailed technical information refer to the technical catalogue

•Available in Stainless steel grade 1.4301 & 1.4401 and galvanized mild steel.

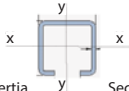
HMP Framing systems - product details

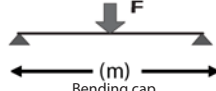
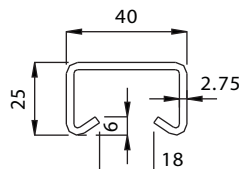
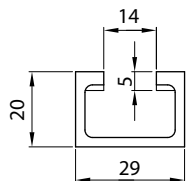
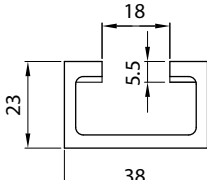
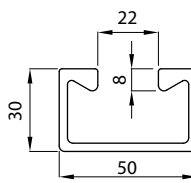
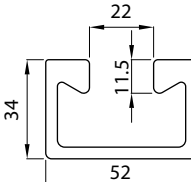
Channel Type	Technical Details									
	Product	Cross Section					 Point loading	 Bending cap.		
			Moment of inertia		Section Modulus					
		A cm ²	I _x cm ⁴	I _y cm ⁴	W _x cm ³	W _y cm ³	kN Span cm	0.5 (kN)	1 (kN)	1.5 (kN)
	HMPD-P-40/25	2.66	2.02	6.08	1.37	3.04	8.00	2.40	1.20	0.60
	HMPD-P-49/30	3.85	4.27	13.10	2.50	5.35	12.00	4.50	2.20	1.40
	HMPD-P-54/33	6.12	7.74	23.66	3.98	8.76	25.00	7.10	3.60	2.40
	HMPZ-P-29/20	1.98	1.02	2.42	0.91	1.66	8.00	2.41	0.70	0.30
	HMPZ-B-29/20	3.97	5.12	4.84	2.56	3.34	8.00	3.20	0.90	0.40
	HMPZ-P-38/23	3.09	2.11	6.17	1.59	3.25	12.8	4.20	1.40	0.60
	HMPZ-P-38/23	6.19	10.04	12.35	4.36	6.50	12.8	5.50	1.70	0.7
	HMPH-P-40/22	2.70	1.98	5.77	1.59	2.92	10.3	2.60	1.30	0.60
	HMPH-B-40/22	5.33	10.06	11.61	4.38	5.88	10.3	3.50	1.70	0.80
	HMPH-P-50/30	4.15	5.19	13.99	3.24	5.67	15.10	5.30	2.70	1.6
	HMPH-B-50/30	8.27	26.56	28.14	8.85	11.49	15.10	7.00	3.50	2.00
	HMPH-P-52/34	6.35	9.33	23.74	5.36	9.04	27.00	8.80	4.40	2.80
	HMPH-B-52/34	12.70	51.49	47.48	15.37	18.09	27.00	12.50	6.20	3.80
	•Standard lengths are 3 or 6 meters									
	•Load values are according to Euro codes EN 1993-1									
•Point load capacity is of the channel lips										
•Structural calculations submitted upon request										

•Standard lengths are 3 or 6 meters

•Load values are according to Euro codes EN 1993-1

•Point load capacity is of the channel lips

•Structural calculations submitted upon request

•For more detailed technical information refer to the technical catalogue

•Available in Stainless steel grade 1.4301 & 1.4401 and galvanized mild steel.

Cantilever brackets - Introduction

HMC Cantilever brackets are used to install framing systems on to backing walls. The brackets are installed on to concrete walls with expansion bolts and also with T head bolts on to framing channels or cast in channels. The brackets act as load transferring unit to the substrate where various types of installation methods can be made.

Each item has a certain load capacity and can be applied for different offset distances. High quality welding is made in order to guarantee load bearing capacity.

Materials available are stainless steel type 1.4301 & 1.4401 and hot dip galvanized mild steel.

Advantages

- Fast and Secure fixing.
- Adjustable and easy fixing.
- Cost effective and flexible.
- Can be re-used.
- Compatible with HMP framing.
- Assembly with T bolts or lock nuts.

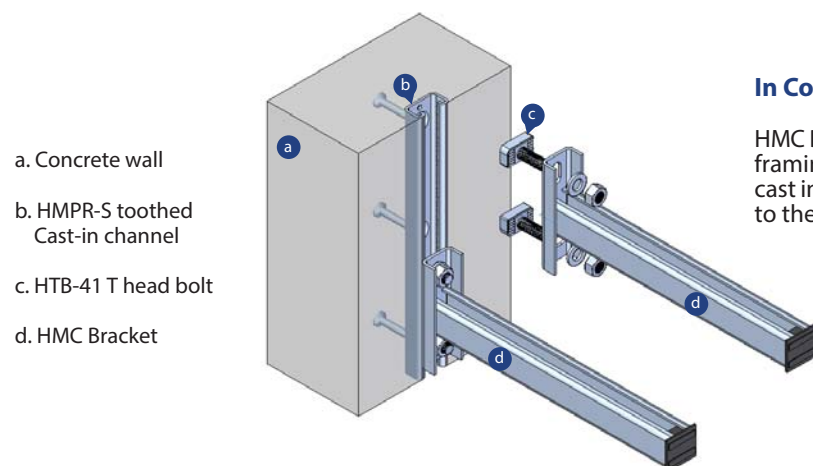

In Combination With HMP and HMPR Channels

HMC Brackets provide full adjustability when used with HMP framing and HMPR cast in channels. When installing on to cast in channels with lock nuts or T bolts, no damage occurs to the concrete walls.

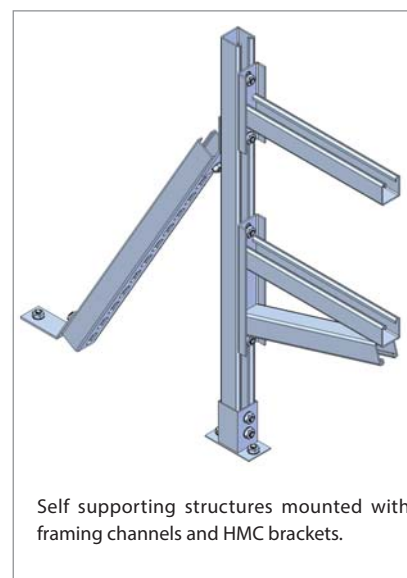
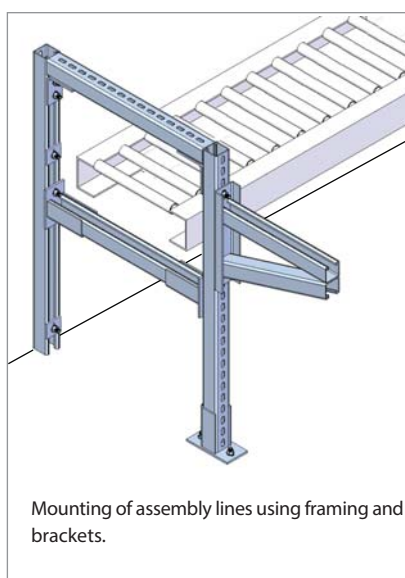
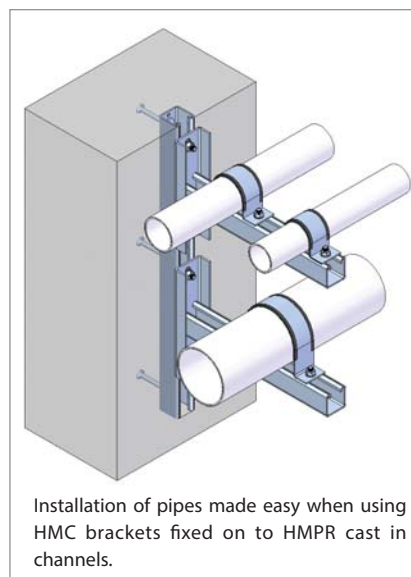

Cantilever brackets - product details

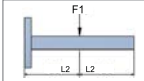
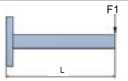
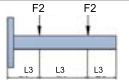
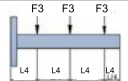
Product	Product Code			Allowable Loads (kN)			
	Type	Height	Length				
HMC-A 41 Bracket	HMC-A 41	180	175	5.35	2.65	2.65	1.75
			325	2.65	1.30	1.30	0.85
			475	1.75	0.85	0.85	0.55
HMC-B 41 Bracket	HMC-B 41	180	325	5.60	2.80	2.80	1.85
			475	3.70	1.85	1.85	1.20
			625	2.80	1.40	1.40	0.90
HMC-C 41 Bracket	HMC-C 41		270	7.50	4.90	4.80	3.40
			330	5.00	4.75	3.70	2.45
			380	3.50	3.50	2.75	1.85
			430	2.65	2.65	2.05	1.40
HMC-A 36 Bracket	HMC-A 36	180	300	2.00	1.00	1.00	0.70
			400	1.50	0.75	0.75	0.50
			500	1.20	0.60	0.60	0.40
			600	1.00	0.50	0.50	0.33
HMC-B 36 Bracket	HMC-B 36	180	300	4.20	2.00	2.00	1.50
			400	3.00	1.60	1.60	1.00
			500	2.50	1.30	1.30	0.80
			600	2.10	1.10	1.10	0.70
HMC-C 36 Bracket	HMC-C 36		225	5.00	4.20	4.00	2.65
			280	4.15	4.10	3.15	2.10
			310	3.15	3.05	2.50	1.65
			340	2.55	3.35	2.00	1.30
			370	2.10	3.15	1.65	1.10

- Material: Stainless Steel 1.4301 (A2) & 1.4401 (A4) & Hot dip galvanzied mild steel
- Table above is prepared according to Eurocode standards
- Loads stated are working resistance loads
- Other sizes are available for production upon request
- Bolts are provided separately
- Structural calculation reports are available upon order

Channel connections - Introduction

HCC channel connections are used to mount framing systems together. Lock nuts and set screws are used to build support structures for various applications.

The HC channel connections are available in three series to be used with channels HMPB & HMPC. The series are 28 for channel type 28/15 and 28/28; 36 for channel type 36/36; and series 41 for channel type 41/41 and 41/21.

Material Available are stainless steel type 1.4301 & 1.4401 and galvanized mild steel.

Advantages

- Fast and secure fixing.
- Adjustable and easy fixing.
- Cost effective and flexible.
- Can be re-used.
- Compatible with HMP framing.
- Assembly with T bolts or lock nuts.



In Combination With HMP and HMPR Channels

HCC channel connections are used in combination with the HMP and HMPR channels to build structures to be used in a wide range of construction applications. HCC channel connections and HMP channels and HMPR cast in channels are connected to each other with HTB T bolts or HMLN lock nuts.

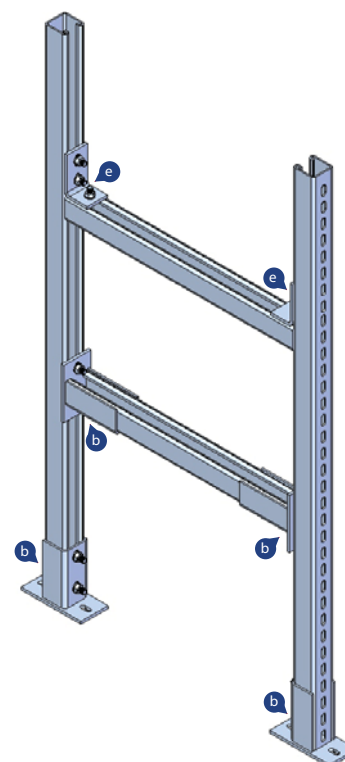
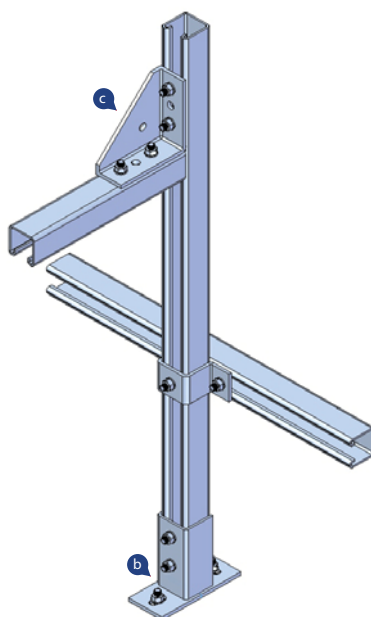
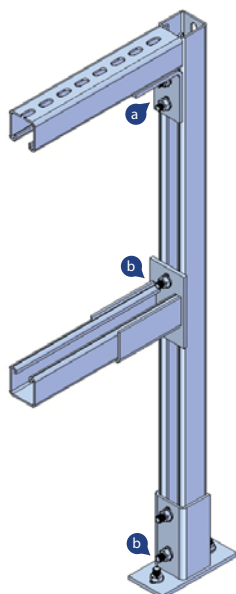

a. HCC-I Channel Connection

b. HCC-B Channel Connection

c. HCC-O Channel Connection

d. HCC-K Channel Connection

e. HCC-H Channel Connection

HCC Channel connections - product Details

Channel connections are available in three series which are used with channels HMPC-41/41, HMPC 41/21; HMPB 36/36; HMPB 28/28 and HMPB 28/15. The following product codes should be used when ordering.

Product Code

HCC - A - 41
 └──┬── Series
 └──┬── Type
 └──┬── Code

Series 41

For channels:
 HMPC 41/41
 HMPC 41/21

Series 36

For channels:
 HMPB 36/36

Series 28

For channels:
 HMPB 28/28
 HMPB 28/15

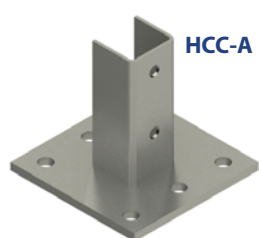

HCC-A

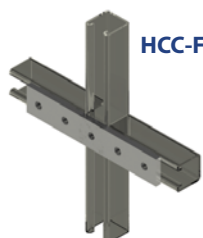

HCC-F

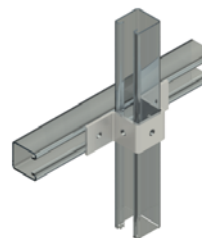

HCC-K



HCC-P



HCC-B



HCC-G



HCC-L

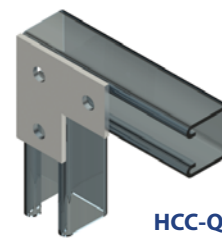

HCC-Q



HCC-C



HCC-H

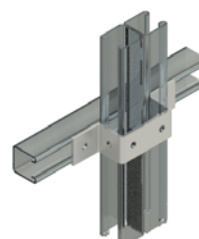

HCC-M



HCC-R

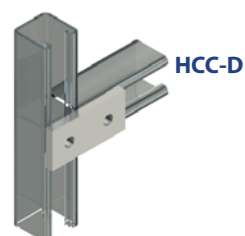

HCC-D



HCC-I

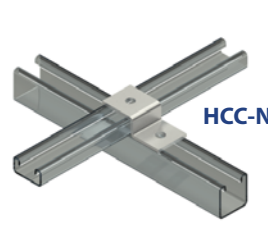

HCC-N



HCC-S



HCC-E

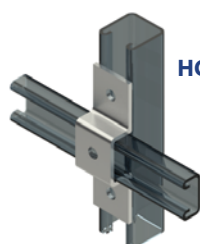

HCC-J



HCC-O



HCC-T

HTB T head bolts & HMLN lock nuts - product details

HTB T-bolts and HMLN lock nuts are designed for secure attachment to HMP channels. Each type features a head geometry that ensures a precise fit within the channel sections. Installation involves inserting the bolt and turning it 90 degrees clockwise to secure it. A nut and washer must be used for tightening the fixture in to place. To achieve reliable connections, it is essential to apply the correct torque values. For further technical details, please refer to the HAZ framing channel technical catalogue.



HTB-28 & 38 type T head bolts

T head bolts with head geometry to suit channels types 28/28, 28/15, 36/36 & 38/17. Supplied in stainless steel 1.4401 and hot dip galvanised steel strength class 8.8.

HTB-28

a: 4 mm
b: 10.5 mm
c: 23 mm

Code	Size (MxL) mm
HTB-28-8/30	M8x30
HTB-28-10/40	M10x40
HTB-28-12/50	M12x50

For channel types HMP-28/15 & 28/28

HTB-38

a: 7 mm
b: 13 mm
c: 30.5 mm

Code	Size (MxL) mm
HTB-38-10/40	M10x40
HTB-38-12/50	M12x50
HTB-38-16/60	M16x60

For channel type HMP-38/17 & 36/36

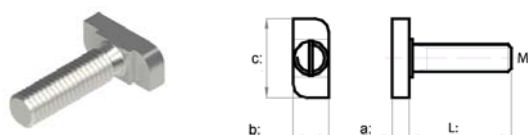

HTB-40, 50 & 72 type T head bolts

T head bolts with head geometry to suit channels types 40/22, 40/25, 49/30, 50/30, 53/34, 52/34 & 72/49. Supplied in stainless steel 1.4401 and hot dip galvanised steel strength class 8.8.

HTB-40

a: 12 mm
b: 14 mm
c: 34 mm

Code	Size (MxL) mm
HTB-40-10/40	M10x40
HTB-40-12/50	M12x50
HTB-40-16/60	M16x60

For channel type HMP-40/25 & HMPH-40/22

HTB-50

a: 13 mm
b: 17.5 mm
c: 42 mm

Code	Size (MxL) mm
HTB-50-12/50	M12x50
HTB-50-16/60	M16x60
HTB-50-20/80	M20x80

For channel type HMP-49/30, 54/33 & HMPH-50/30 & 52/34

HTB-72

a: 19 mm
b: 23.5 mm
c: 58 mm

Code	Size (MxL) mm
HTB-72-20/60	M20x60
HTB-72-20/80	M20x80
HTB-72-20/100	M20x100

For channel type HMP-72/49

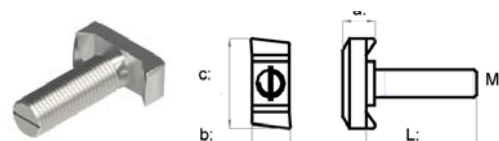

HTB-41 type T head bolts

T head bolts with head geometry to suit channels type 41/21, 41/41 and 41/62. Supplied in stainless steel 1.4401 and hot dip galvanised steel strength class 8.8.

HTB-41 - T Bolt

a: 10 mm
b: 20 mm
c: 34 mm

Code	Size (MxL) mm
HTB-C-41-12/50	M12x50
HTB-C-41-16/60	M16x60

For toothed channel type HMP-41/22, 41/41 & 41/62

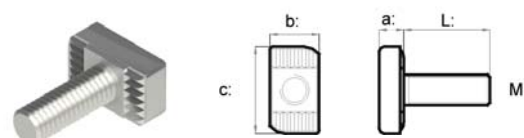

HTB T head bolts & HMLN lock nuts - product details

HTB-N-40 & 50 type T head bolts

Nibbed T head bolts with head geometry to suit hot rolled channel types 40/22, 50/30 & 52/34. Supplied in hot dip galvanised steel strength class 8.8.

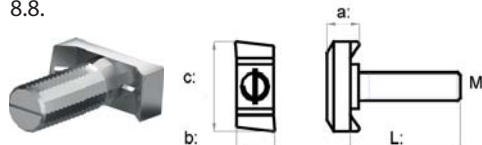

HTB-N-40

a: 11.1mm
b: 14mm
c: 34,5mm

Code	Size (MxL) mm
HTB-N-40-10/40	M10x40
HTB-N-40 -12/50	M12x50

For channel type HMPH-40/22

HTN-N-50

a: 14.5mm
b: 17mm
c: 43mm

Code	Size (MxL) mm
HTB-N-50-12/50	M12x50
HTB-N-50 -16/60	M16x60

For channel type HMPH-50/30 & 52/34

HTB-Z 29 & 38 type T head bolts

Toothed T head bolts with head geometry to suit toothed and hot rolled channel types 29/20 & 38/23. Supplied in hot dip galvanised steel strength class 8.8.

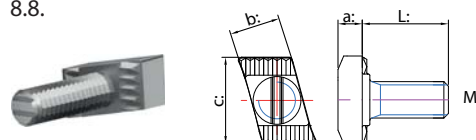

HTB-Z-29

a: 6,5mm
b: 13,4mm
c: 21 mm

Code	Size (MxL) mm
HTB-Z-29-10/40	M10x40
HTB-Z-29 -12/50	M12x50

For channel type HMPZ-29/20

HTB-Z-38

a: 8mm
b: 17,2mm
c: 29 mm

Code	Size (MxL) mm
HTB-Z-38-12/50	M12x50
HTB-Z-38 -16/60	M16x60

For channel type HMPZ-38/23

HMLN-28 & 38 type lock nuts

Lock nuts to suit channel types 28/15, 28/28, 38/17 & 36/36. Supplied in stainless steel and galvanzied steel.

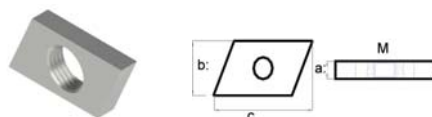

HMLN-28

a: 4 mm
b: 13 mm
c: 24.5 mm

Code	Size (M) mm
HTB-28-6	M6
HTB-28-8	M8
HTB-28-10	M10

For channel type HMP-28/15 & 28/28

HMLN-38

a: 6 mm
b: 17.5 mm
c: 31.5 mm

Code	Size (M) mm
HTB-38-10	M10
HTB-38-12	M12
HTB-38-16	M16

For channel type HMPR-38/17 & 36/36

HMLN-40 & 50 type lock nuts

Lock nuts to suit channel types 40/22, 50/30, 52/34. Supplied in hot dip galvanzied steel.

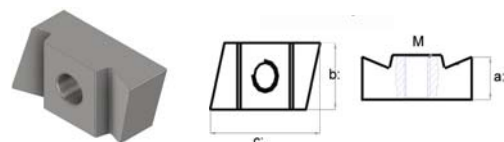

HMLN-40

a: 10.8 mm
b: 17 mm
c: 34.5 mm

Code	Size (M) mm
HTB-28-6	M6
HTB-28-8	M8
HTB-28-10	M10

For channel type HMP-40/25 & HMPH-40/22

HMLN-50

a: 11.7 mm
b: 21 mm
c: 43.5 mm

Code	Size (M) mm
HTB-49-10	M10
HTB-49-12	M12
HTB-49-16	M16

For channel type HMP-49/30, HMP-54/33, HMPH-50/30 & HMPH-52/34

HMLN-Z type lock nuts

Lock nuts to suit channel types 41 series. Supplied in stainless steel and galvanzied steel.

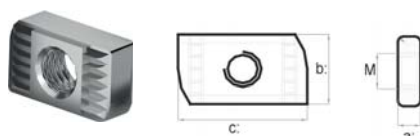

HMLN-Z 41

Code	Size (axbxc) mm	M
HMLN-Z 41-6	6x20x34	M6
HMLN-Z 41-8	8x20x34	M8
HMLN-Z 41-10	10x20x34	M10
HMLN-Z 41-12	10x20x34	M12

For toothed channel type HMPS-41/22, 41/41 & 41/62

HMLN-S-41



HMCI Concrete inserts - product details

HMCI concrete inserts are produced from 41/41 & 41/21 C channels with pressed out strips that are punched out at 100 mm centres. These channels are used for casting in to concrete to enable connections without drilling. Various applications for connections to floors, walls and ceilings are made for the installation of secondary structures. HMLN lock nuts can be inserted anywhere along the length of the channels. The channels are supplied with an easily removable strip, which prevents the ingress of grout and cement. Concrete insert can be supplied in electro galvanised, hot dip galvanised and stainless steel finishes.

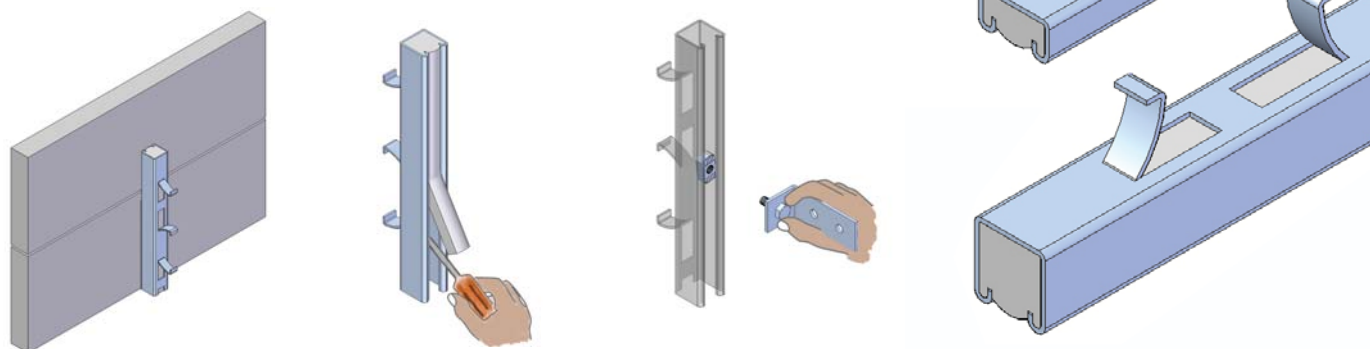

Installation Instruction

1.) HMCI concrete inserts are nailed on to the form work at the required location, prior to casting of the concrete.

2.) After the concrete has dried, then the filler is removed by using a screw driver or similar tool.

3.) Fixing is done at the desired position along the length of the channel. Installation is made with lock nuts and set screws.

Advantages

- No drilling
- Fast and easy fixing
- No need for electricity
- No dust when constructing
- Economic through less workmanship

HMCI-41/21 Concrete Insert

6.7 kN pull out admissible load per 300 mm span

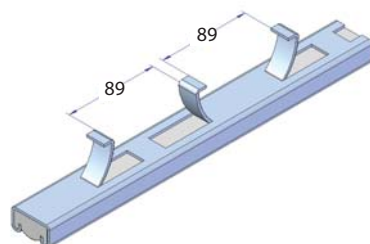
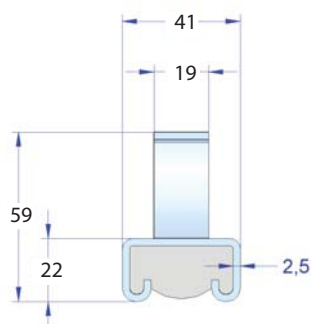

HMCI-41/41 Concrete Insert

8.8 kN pull out admissible load per 300 mm span

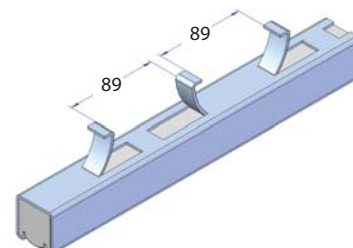
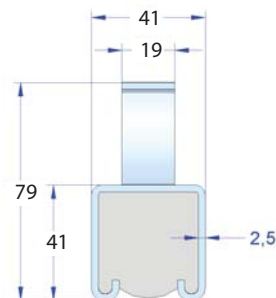

Code	Size	Length
HMCI-41/21	2,5x41/21	6000
HMCI-41/41	2,5x41/41	6000

- M6, M8, M10, M12 size lock nuts are used for fastening fixtures on to the concrete inserts.
- Standard stock lengths are 6000 mm. Special length fabrication can be made upon request.
- Material: A2: Stainless steel EN 1.4301, A4 Stainless steel EN 1.4401, HDG hot dip galvanized mild steel 1.0038 (S235JR), EG Electro galvanized mild steel 1.0038 (S235JR).

Accessories - Product Details

HLW3 Lock Washer



- Lock nut used to firmly stabilize any fixture made on the channels with lock nuts or T bolts.
- For Channels 28/15, 28/28, 38/17, 36/36, 41/21 & 41/41



HUB U Shape Bolt



- U Bolts are used for the connection of pipes to structures for lateral fixing.
- Sizes available in M6, M8, M10, M12, M16 to suit diameter sizes up to 355mm



HBC-P Beam Clamp



- Beam clamp is used for connection of slotted channels to steel beams.
- Applicable for all channels with slotted holes.
- Maximum load is 7.0 kN.

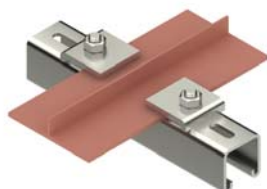

HBC-M Beam Clamp

- Beam clamp is used for the connection of threaded rods to steel beams.
- Applicable for M8 and M10 threaded rods.
- Maximum load is 2.5 kN.



HBC-U Beam Clamp



- Beam clamps for the connection of channels without slotted holes.
- For Channels 41/41 B & 40/25 B.

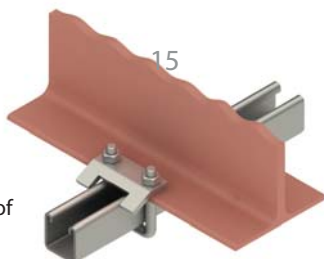

HBC-U 127 Beam Clamp



- Beam clamps for the connection of channels without slotted holes.
- For Channels 41/21, 41/41 and 40/25.

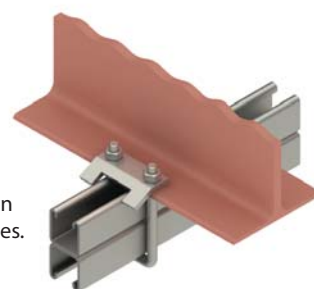

HEC-1 End Cap



- Channel end caps available for channels 28/28, 36/36, 41/21, 41/41 & 40/25.



HEC-2 End Cap



HSI Sound Isolator

- Sound isolator sleeve available for channels 28/28, 36/36, 41/21 & 41/41.



HAZ Metal Product range offers a wide range of products and solutions. HAZ Design department designs and propose to most suitable HMPR anchor channel for the project requirement. Bespoke system solutions for special applications can also be designed upon request.

This catalog includes the standardized products for the anchor channel systems. Additional types and sizes of products are available to offer.

More details can be found about Anchor Channels in our technical product catalogue which can be downloaded at www.hazmetal.com.



Framing channel technical catalogue is downloadable at www.hazmetal.com

HMC Cantilever Brackets

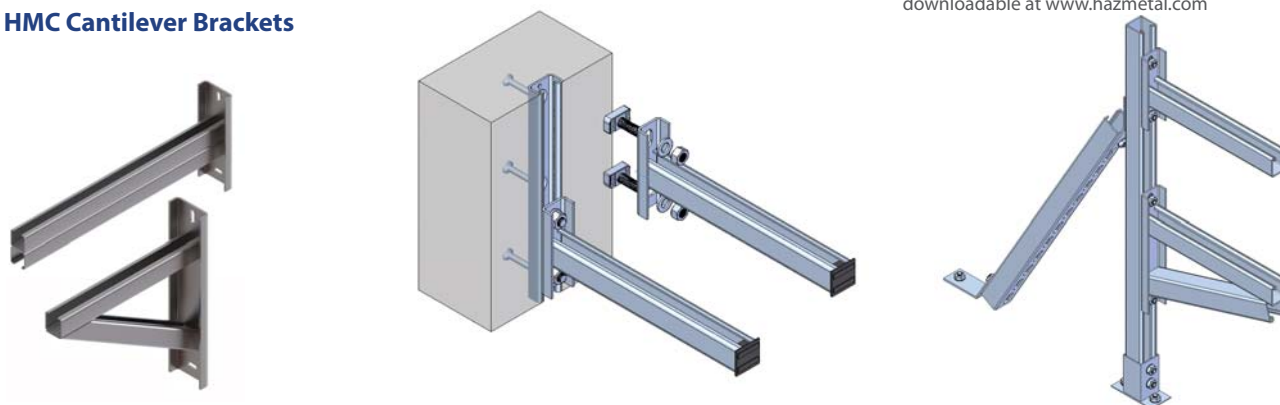

HCC Channel Connections

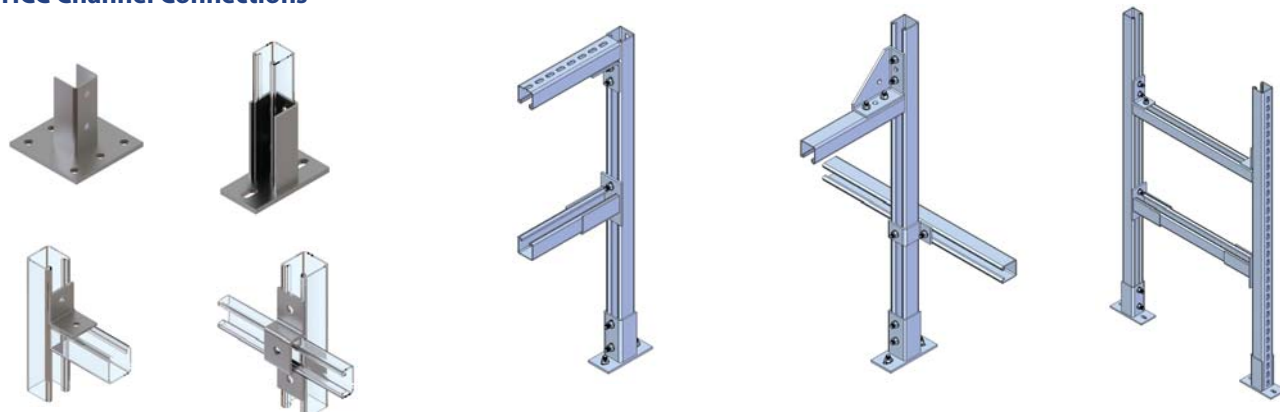

Suspension systems

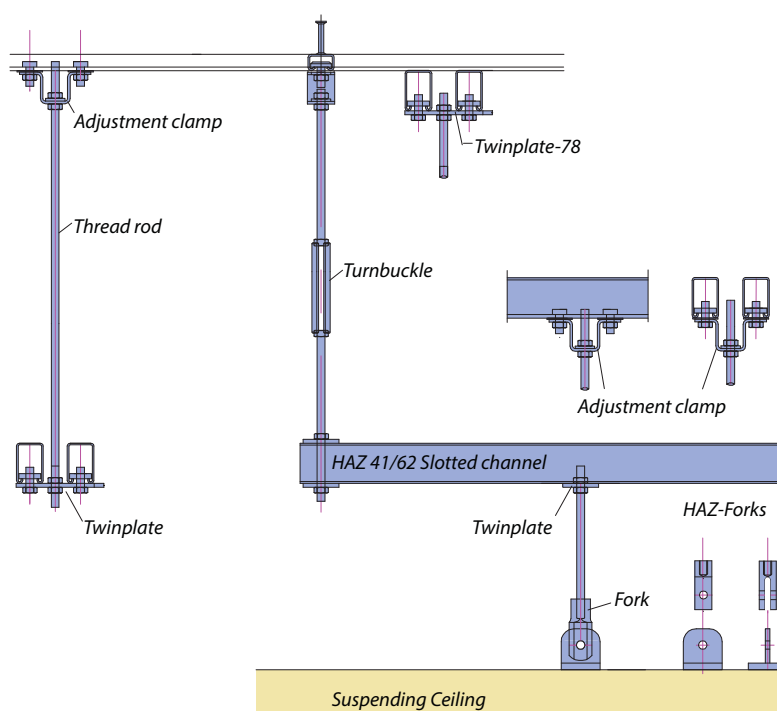



HAZ Metal San. ve Tic. A.Ş.

Güzelçay Mah. Şehit Er Ali Çıracı Cad.

No: 10 İskenderun

Türkiye

Telefon: 0 326 626 20 45

info@hazmetal.com

www.hazmetal.com

HAZ Metal Deutschland GmbH

Alfred-Zippe-Straße 1

D-97877 Wertheim

Germany

Telefon: +49 (0) 93 42 - 93 59 - 0

info@haz.eu

www.haz.eu

HAZ Metal Fixing Systems UK LTD

154 Great North Road Hatfield

Hertfordshire AL9 5JN

Tel: +44 1707 260 180

info@hazmetal.co.uk

www.hazmetal.co.uk