

GRP CANOPIES

Derby - Flat Plain

Fitting Instructions



*Gallows brackets supplied at extra cost

STORAGE

Brickfab GRP canopies should be stored in a secure area, laid down on the pallet provided and protected from wind and rain whenever possible.

DO NOT stack or place weight on top of the canopy or store anything directly onto the canopy surface.

MAINTENANCE

- ◆ Clean the canopy occasionally with soapy water or an ammonia free detergent
- ◆ A non-abrasive damp cloth should be used to avoid any damage to the canopy surface
- ◆ Brickfab GRP canopies are low maintenance and do not require painting

BRICKFAB GRP CANOPIES ARE NON-STRUCTURAL. DO NOT IN ANY CIRCUMSTANCE STAND ON THE CANOPY OR USE IT TO BEAR ANY LOAD/WEIGHT

UNPACKING & FIXINGS



Lift the canopy upright and cut open the packaging at the rear. Taking care not to damage the finished surface slide the packaging off the canopy. Only fully remove the canopy from the packaging when fitting is imminent.



Brickfab recommends using Fischer SXR 10x80, or similar fixings to secure the fixing frame and canopy flange to brick work. For all other substrates please contact Brickfab. Use 6.0 x 75/46 screws for the canopy underside.

FIXING FRAME INSTALLATION



Centre the fixing frame in desired position on the wall, choosing a suitable surface. The bottom of the frame should be a minimum of 50mm above the top of door opening. Using a 10mm drill bit, drill through the frame and wall and secure fixing in one side of the top of the frame. Ensure frame is level and repeat on other side. Level using shims if necessary.



Repeat fixings in the bottom part of the frame and secure. See table for recommended number of fixings. Once frame is fixed re-check level.

Canopy Size	No. of fixings
Up to 1700mm	4
1700-2400mm	6
2400 & above	Contact us

CANOPY FIXING



Pre-drill holes in the fixing upstand at maximum 450mm centres and 50mm from the top edge.
If required add mastic sealant to the rear face.



Carefully lift and slide the canopy onto the fixing frame.



Whilst supporting the canopy, drill through the pre-drilled holes in the upstand and into the wall.



Secure all fixings in the upstand and finish using appropriate coloured bolt caps.



Using a 6mm drill bit, drill through the underside soffit face at maximum 450mm centres, 20mm from the wall. Use screws to fix the canopy to the fixing frame and finish with screw head plastic caps.



Once canopy is fixed, lead flash over the fixing upstand if required. Alternatively seal the canopy along the top edge of the upstand using appropriate coloured mastic sealant.

GALLOWES BRACKETS INSTALLATION

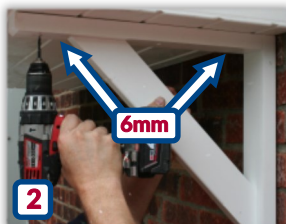

1. Mark and pre-drill 3 holes with a 6mm (x2) and 10mm bit (x1).
2. Using pre-drilled holes, drill through canopy underside, then fix screws.
3. Check vertical level and drill through the wall using a 10mm bit.
4. Use Fischer SXR 10x80 fixing or similar to secure the bracket to the wall.
5. Finish using screw caps and white bolt cap. Repeat 1-5 for other bracket.