

Welding Hinges

A range of hinges specially designed
for weld fixing suitable for steel doors,
grilles, security cabinets and more.



www.barrier-components.co.uk
01708 891 515

barrier
components

Welding hinges

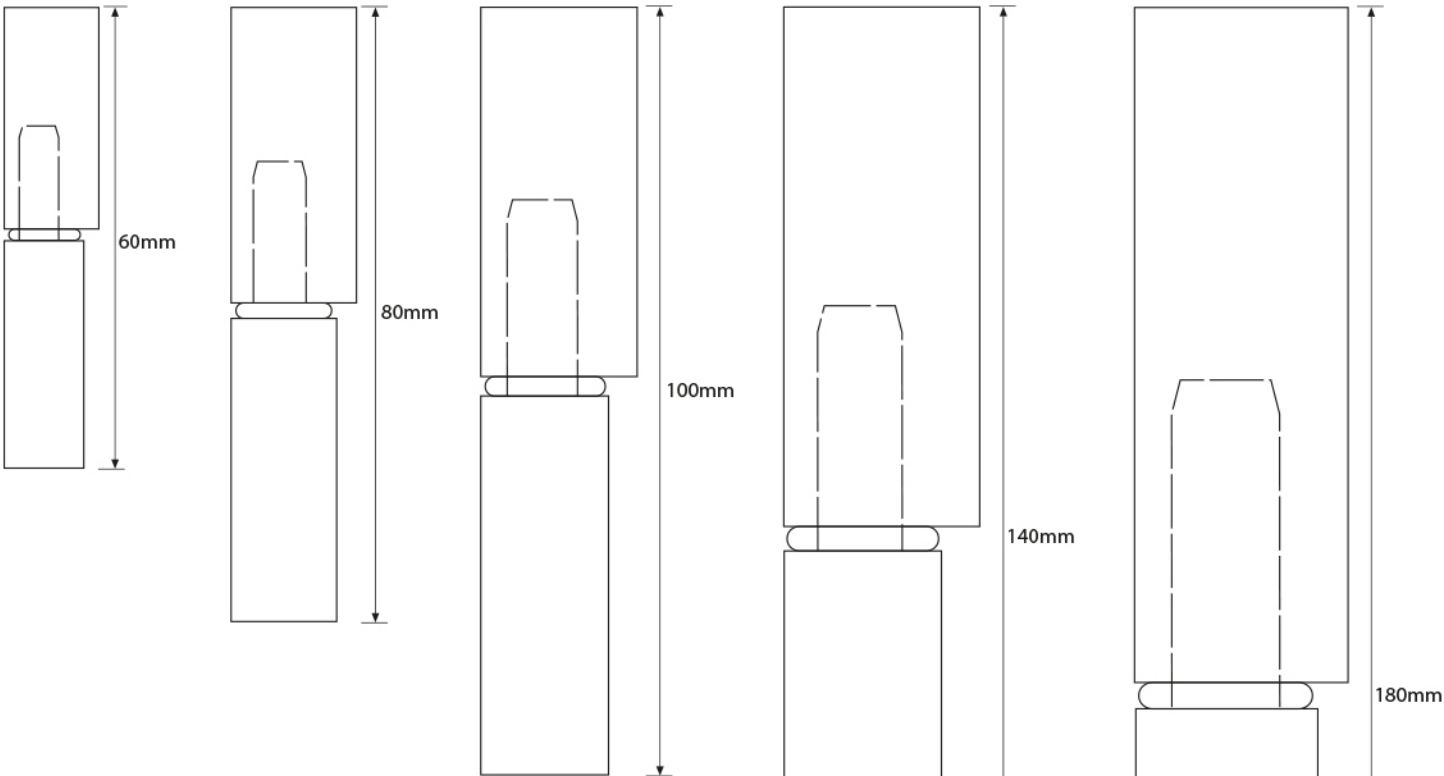

UNIVERSAL HINGES

These two part lift off hinges are available in nine sizes from 45mm to 200mm and can be used on doors of either hand. The tear-drop knuckle profiles are machined from hot rolled easy weld steel sections and are fitted with a fixed steel pin. All sizes are complete with a brass washer but as an alternative, a limited range can be fitted with a ball bearing washer. Five sizes are also available in stainless steel. (Grade 304L)

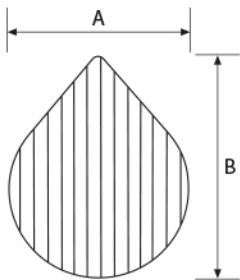

Note: Ball bearing washer increases overall height by 4mm approx. Ball bearing washers are recommended for heavy duty doors and doors which are in constant use. The bearing assembly consists of 2 hardened steel cones in a steel case.

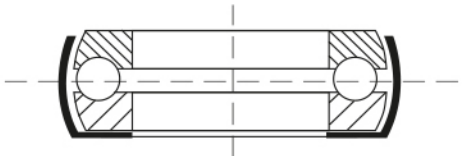

Height mm	45	60	80	100	120	140	160	180	200
Cross Section A x B mm	10 x 12.5	10 x 12.5	13 x 16	16 x 20	16 x 20	20 x 25	20 x 25	23 x 29	23 x 29
Pin ø mm	5.5	5.5	7	9	9	11	12	14	14
Steel with brass washer	✓	✓	✓	✓	✓	✓	✓	✓	✓
Ball bearing				✓	✓	✓	✓	✓	
Grease nipple					✓		✓		
All stainless steel		✓	✓	✓	✓				



SPRING HINGE 551/257

Code	A	B	C	D	ø
551	250	22	25	2	16
257	150	22	25	7	14

A simple and economical system for single action, self-closing, steel doors. Both the spring unit and hinges are weld fixed to the door and frame. The spring unit has an adjustable strength spring whilst the hinges have brass pins and ball bearing washer.

Two hardware kits are available:

For doors up to 60kg/1000mm wide

Kit 551/60/257 consisting of 1 spring unit and 2 hinges.

For doors up to 100kg/1200mm wide

Kit 551/100/257 consisting of 2 spring units and 2 hinges.

The hardware can be fitted to doors of either hand.

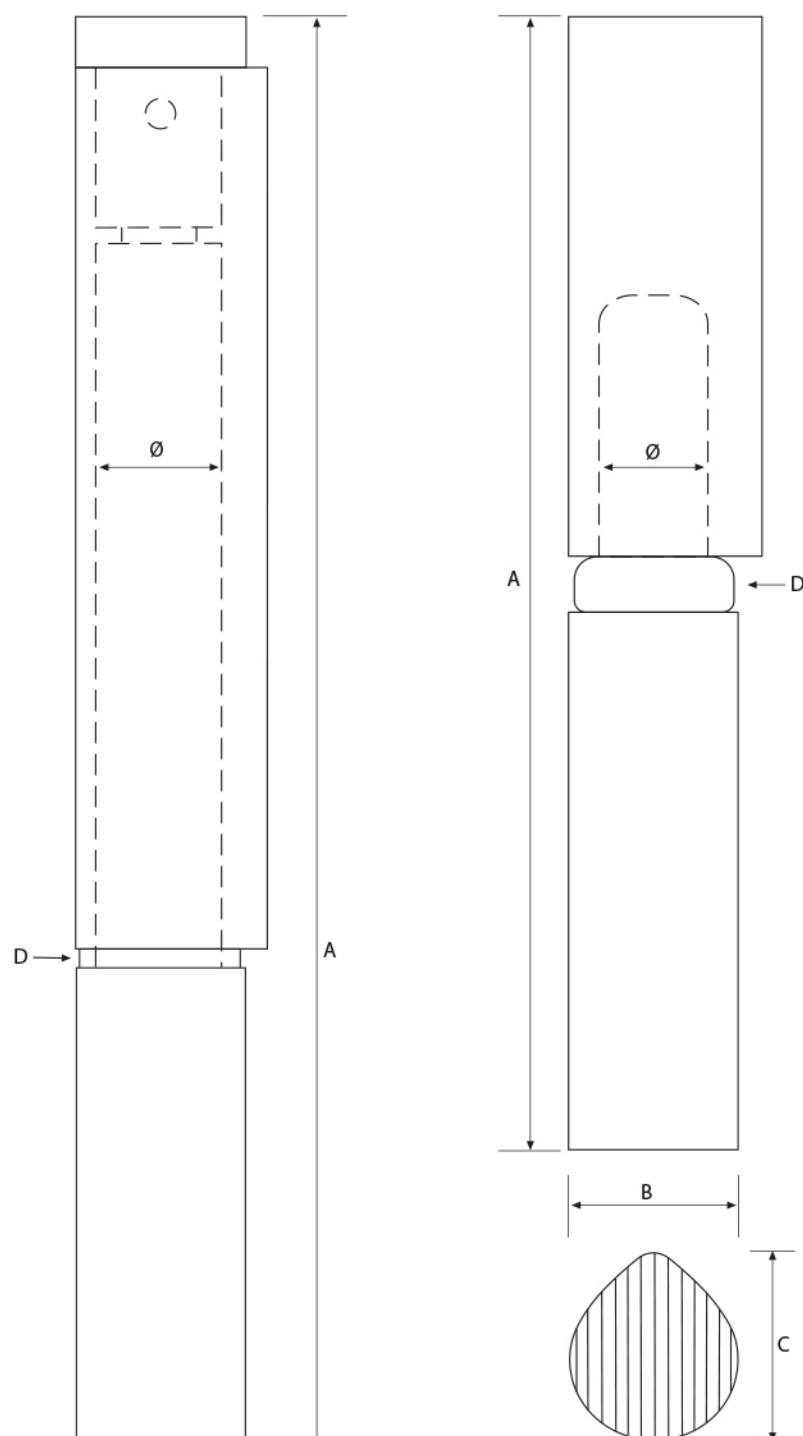

Hinge No. 257

All dimensions in millimeters

Spring unit No. 551

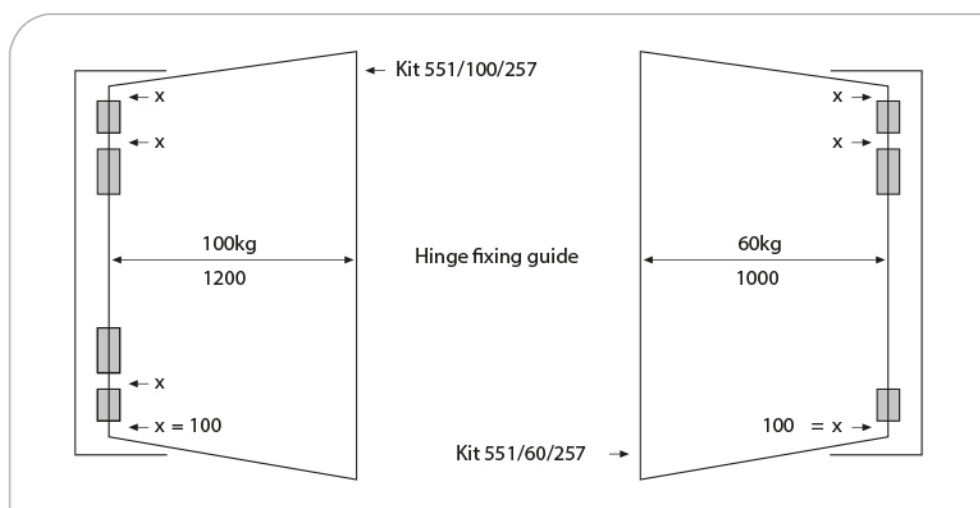



FLAG HINGE

These two part lift-off hinges are available in eight sizes and because the flag plates are not offset they can be fitted to doors of either hand.

The mild steel flag plates are electrically welded to the round, steel knuckle which is fitted with a steel pin. All sizes are complete with a brass washer but as an alternative a limited range can be fitted with a ball bearing washer. All sizes include an oiling hole and cap.

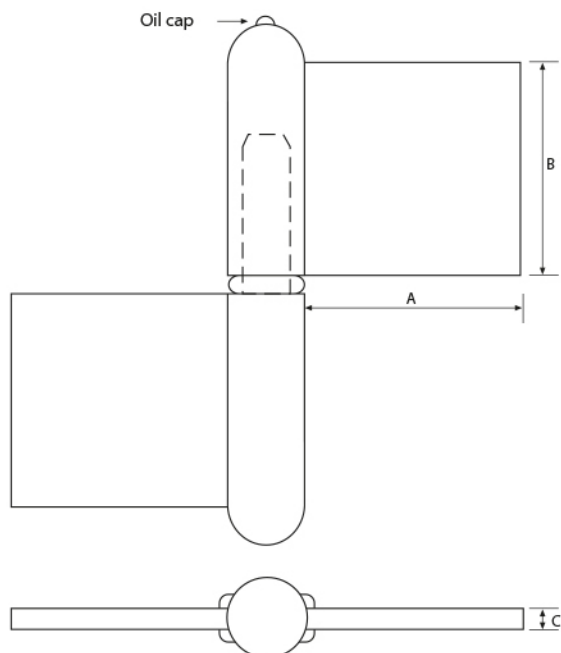

Size mm	60	70	80	90	100	120	140	160
Plate size A x B mm	30 x 30	35 x 35	40 x 40	45 x 45	50 x 50	60 x 60	70 x 70	70 x 80
Plate thickness C mm	5	5	5	5	5	6	6	6
Knuckle ø mm	14	16	18	20	20	22	22	23
Pin ø mm	7	8	9	10	12	12	12	14
Steel with brass washer	✓	✓	✓	✓	✓	✓	✓	✓
Ball bearing			✓	✓	✓	✓	✓	✓



FLAG HINGE 1150RR

A	B	C	D	E	F
140	65	67	6	ø22	ø14

A heavy duty lift-off hinge with offset flags.

The hinge parts are machined from a hot rolled mild steel profile and supplied unplated for either welding or bolt fixing. The adjustable 14mm ø zinc plated steel pin is fitted with a ball bearing washer. As these hinges are handed - please specify when ordering.

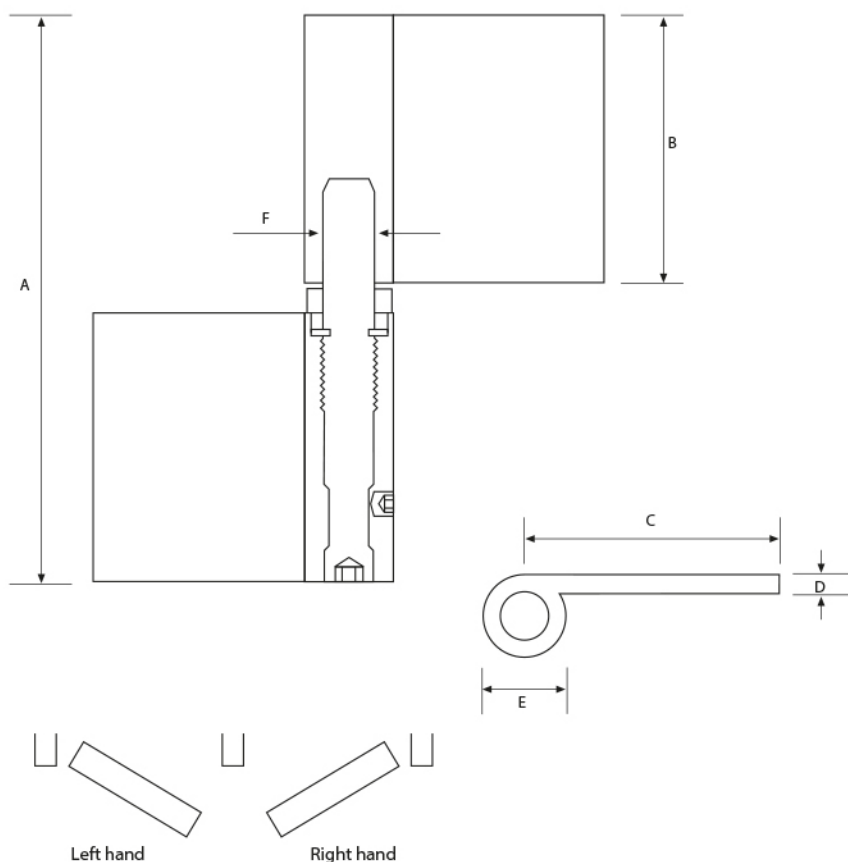

Industrial hinges

A range of hinges designed for sheet metal and other types of steel door fabrication. Normally fixing is by welding but bolt fixing is an alternative for certain hinges. All hinges are manufactured from mild steel and are not galvanized. Hinge parts are undrilled.

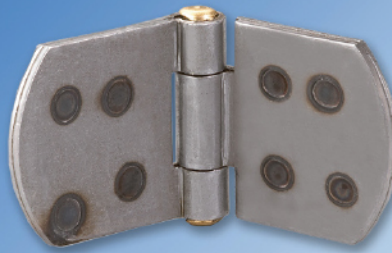

BACKFLAP HINGE 579

Double welded plates and brass pin

A 50mm	B 45mm	C 5mm
A 50mm	B 90mm	C 7mm
A 75mm	B 90mm	C 9mm
A 75mm	B 140mm	C 10mm

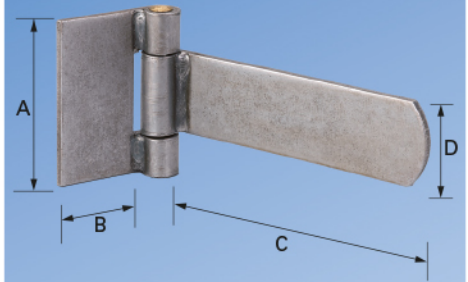

TEE HINGE 580

Welded knuckle

A 115mm	B 55mm	C 195mm	D 55mm
---------	--------	---------	--------

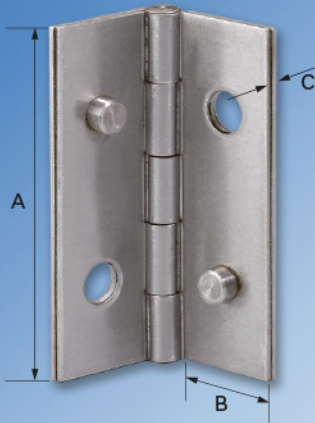

SECURITY BUTT HINGE 899X

Double pressed plates with security pins

A 100mm	B 30mm	C 4mm
---------	--------	-------

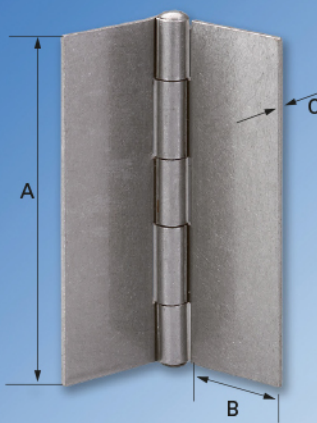

BUTT HINGE 1838T

Cranked plates

A 50mm	B 15mm	C 1.2mm
A 75mm	B 20mm	C 1.5mm
A 100mm	B 23mm	C 1.8mm

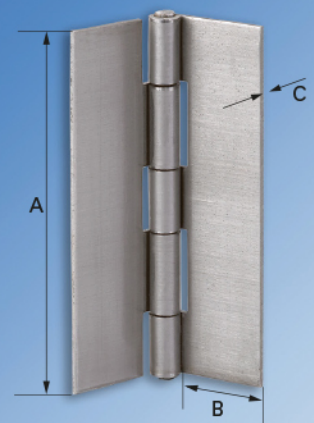

BUTT HINGE 5050T

Uncranked plates

A 50mm	B 15mm	C 1.2mm
A 75mm	B 20mm	C 1.5mm
A 100mm	B 23mm	C 1.8mm
A 150mm	B 32mm	C 2mm

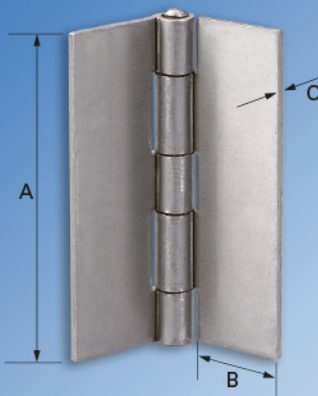

BUTT HINGE 451T

Cranked plates

A 100mm	B 30mm	C 3mm
---------	--------	-------

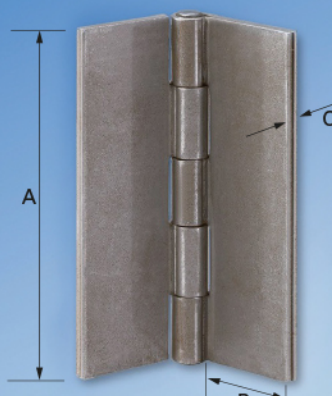

BUTT HINGE 899T

Uncranked, double pressed plates

A 100mm	B 30mm	C 4mm
A 150mm	B 40mm	C 7mm

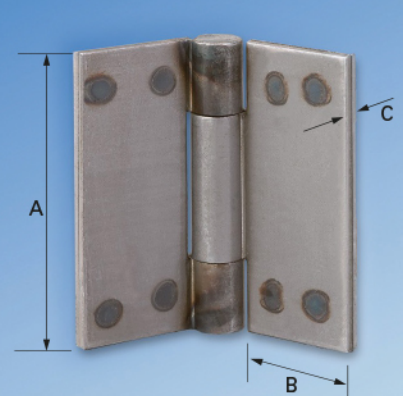

BUTT HINGE 575

Uncranked, double welded plates

A 100mm	B 40mm	C 6mm
A 150mm	B 65mm	C 6mm



FLAG HINGE 220/280

Size mm	220	280
Plate size A x B mm	50 x 70	75 x 90
Plate thickness C mm	10	12
Knuckle ø mm	28	32
Pin ø mm	18	20

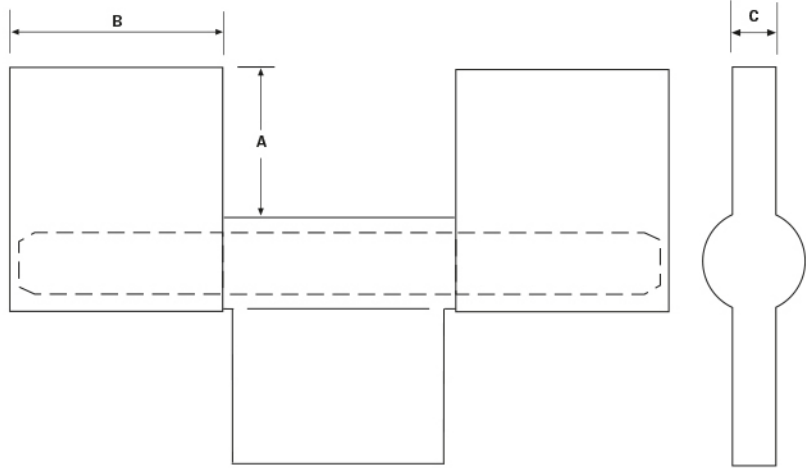

Three flag hinge: These are specially designed for heavy steel doors. The large diameter steel pin is removable to make the door easier to hang. They are supplied with special ball bearing washers. Made to order only, in mild steel. This is not a stock item.



SS FLAG HINGE

Size mm	80	100
Plate size A x B mm	40 x 40	50 x 50
Plate thickness C mm	5	5
Knuckle ø mm	18	20
Pin ø mm	9	12

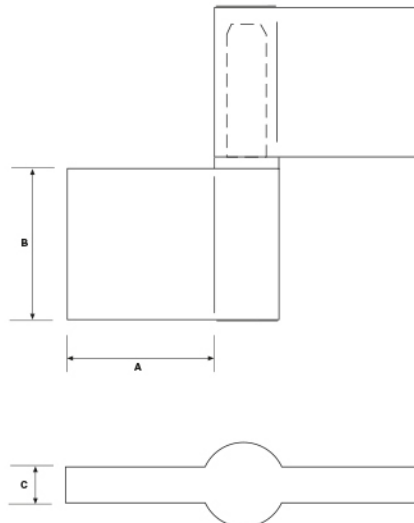

Stainless steel two flag hinge: These hinges are fabricated in stainless steel (grade 304) with the flags electronically welded to the round profile knuckle. They are fitted with a fixed stainless steel pin and washer.



STAMPED HINGE

Length: 150mm	
Plate size:	10mm x 47mm
Material thickness:	4mm
Knuckle diameter:	28mm
Pin diameter:	19.8mm

Pin 115.90 Stamped Hinge with removeable Pin and brass washer.

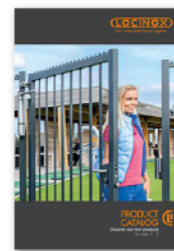

Barrier Components Ltd

Unit 8 Dolphin Way Dolphin Point Purfleet
Essex RM19 1NR
t: 01708 891 515 f: 01708 891 516
sales@barrier-components.co.uk
www.barrier-components.co.uk

