

# PRODUCT DATA SHEET

## ISO-CONNECT OUTSIDE EPDM

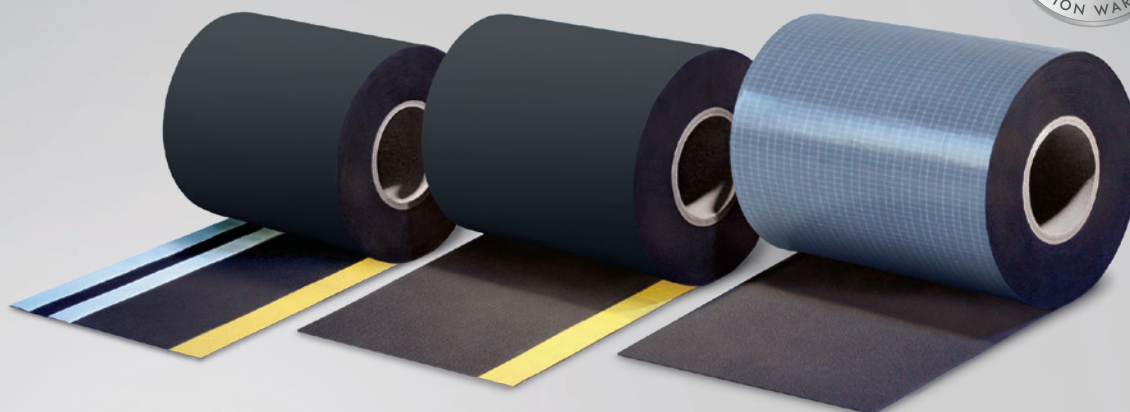

### PRODUCT DESCRIPTION

ISO-CONNECT OUTSIDE EPDM is a bitumen-compatible elastomer-based sealing band which serves as an external durable sealant on windows and facades in accordance with DIN 18531 and DIN 18533. ISO-CONNECT OUTSIDE EPDM is extremely temperature and weather resistance as well as having the ability to compensate for joint movement.

### APPLICATION

ISO-CONNECT OUTSIDE EPDM is a special outer sealant, designed in accordance with DIN 18195 and DIN 18533, for metal and window and façade structures and used as the complete perimeter seal and/or the base seal for doorways and floor fitting windows.

### FINISHES

In addition to the tried and tested standard version ISO-CONNECT EPDM we also offer a COMPLETE version with full-surface adhesive film for easy fitting. ISO-CONNECT EPDM FLEECE offers further advantages, enabling it to be plastered, painted and covered over.

### PRODUCT ADVANTAGES

- permanent outer sealant
- high elasticity – compensates for joint movement
- extreme temperature and weather resistant
- bitumen compatible
- complies with the requirements of the Building Energy Act (EnEV was valid 31.10.20) and the recommendations of the RAL "installation guide"
- 10 Year Function Warranty\*

\* On the conditions of the manufacturer (available on request).

### DIMENSIONS

width: 100, 150, 200, 250, 300, 400, 500, 600, 700 mm  
alternative dimensions available on request

### PACKAGING

rolls, roll length: 25 m



# ISO-CONNECT OUTSIDE EPDM



Technical data	Standard	Classification
Material description		synthetic caoutchouc on EPDM basis
Colour		black
Building material class	DIN EN 13501	E
Impermeable to driving rain	DIN EN 1027	≥ 1,050 Pa
Air permeability coefficient	DIN EN 12114	airtight $\alpha \leq 0.1 \text{ m}^3/[\text{h} \cdot \text{m} \cdot (\text{daPa})^{2/3}]$
Bitumen compatible	DIN 7864 T1	bitumen compatible
UV stability	DIN 7864 T1	UV resistant; FLEECE-Surface finish approx. 12 months
Ozone resistance	DIN 7864 T1	ozone resistant
sd-value	DIN EN ISO 12572	0.8 mm approx. 25.6 m / 1.2 mm approx. 38.4 m FLEECE Finish: 0.8 mm approx. 26 m / 1.2 mm approx. 39 m
Water vapour diffusion resistance $\mu$	DIN EN 1931	≈ 32,000
Material thickness		0.8 mm and 1.2 mm
Elongation at break	DIN 53504	≥ 300 %
Tensile strength	DIN 53504	≥ 6.5 mPa
Maximum tear resistance	DIN 53504	≥ 25 kN/m
Temperature stability range		-30 °C to +100 °C
Handling temperature		+5 °C to +35 °C
Dimension tolerance	DIN 7715 T5 P3	requirements fulfilled
Storage temperature		+1 °C to +25 °C
Shelf life		unlimited (EPDM), finishes with adhesive strips 12 months, dry and in original packing

Finishes	
A	
B	
C	
D	
COMPLETE	
COMPLETE DUO	
FLEECE	
FLEECE DUO	
FLEECE COMPLETE	
FLEECE COMPLETE DUO	

All COMPLETE-variants with 2-way or 3-way split liner.

EPDM foil Butyl-adhesive strip   
Self-adhesive strip Fleece

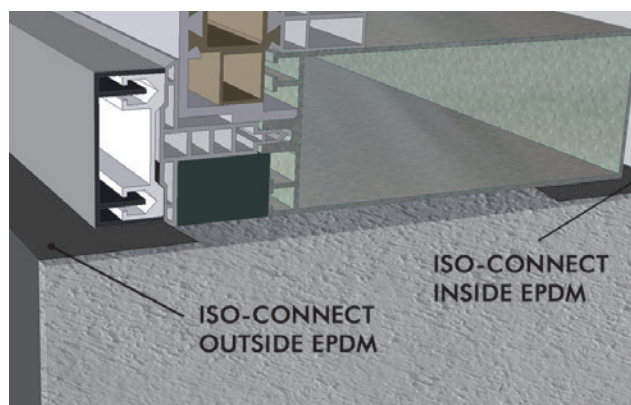

Installation example: ISO<sup>3</sup>-WINDOW SEALING SYSTEM

## REMARKS

EPDM films only fulfil the requirements of DIN SPEC 20000-202 for sealing with a thickness of ≥ 1.1 mm.

## ACCESSORIES

- ISO-TOP ROLL
- ISO-TOP FLEX ADHESIVE XP
- ISO-CONNECT EPDM SEALING CORNERS
- ISO-CONNECT EPDM SEALING TRAY