

DELTA[®]-FASSADE DELTA[®]-FASSADE S

Safe protection from wind and moisture.

Breathable UV-resistant insulation protection sheet.
Permanently dry heat insulation.

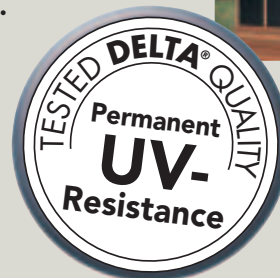

PLUS variants feature
integrated self-adhesive borders.

■ Facing sheet

■ For wooden
post and
beam or metal
constructions

■ New
construction
refurbishment

The optimum solution
for any requirement?
DELTA® System, of course!

A pleasant and healthy climate in the home:

DELTA®-FASSADE/D

For a variety of constructions.



■ Outside:

DELTA®-FASSADE

DELTA®-FASSADE PLUS

Wood or metal facings often feature open joints to improve the structure of a facade. However, these joints expose underlying insulation layers to more dirt and moisture. DELTA®-FASSADE offers assured protection in all back-vented facing constructions featuring open joints up to 20 mm wide that cover no more than 20 % of the surface.

DELTA®-FASSADE S

DELTA®-FASSADE S PLUS

Facing constructions featuring very wide open joints offer new design options – at the same time, they increase the risk of the insulation layer being impaired in its function by dust or rain. DELTA®-FASSADE S is a safe package for the heat insulation in all back-vented facing constructions featuring open joints up to 50 mm wide that cover no more than 40 % of the surface.

■ Inside:

DELTA®-REFLEX/DELTA®-REFLEX PLUS

Vapour barrier sheet. Provides 10 % increase in thermal insulation, 50 % heat reflection, 100 % barrier against air and vapour.

DELTA® quality branded products made by Dörken.

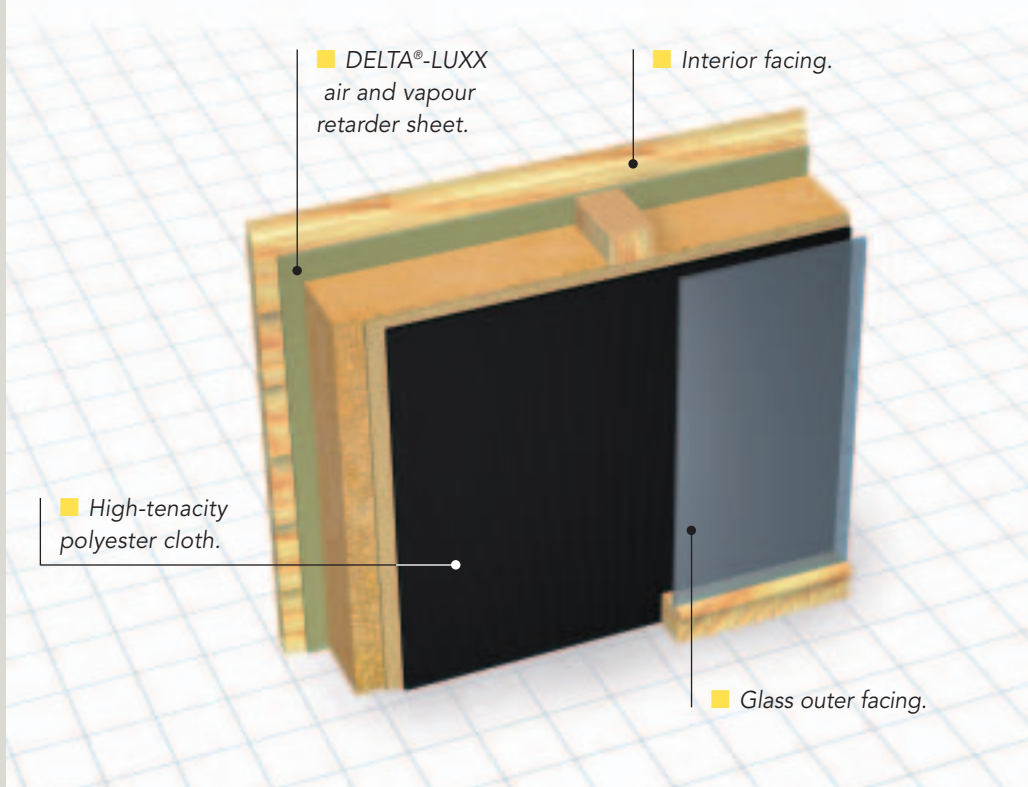
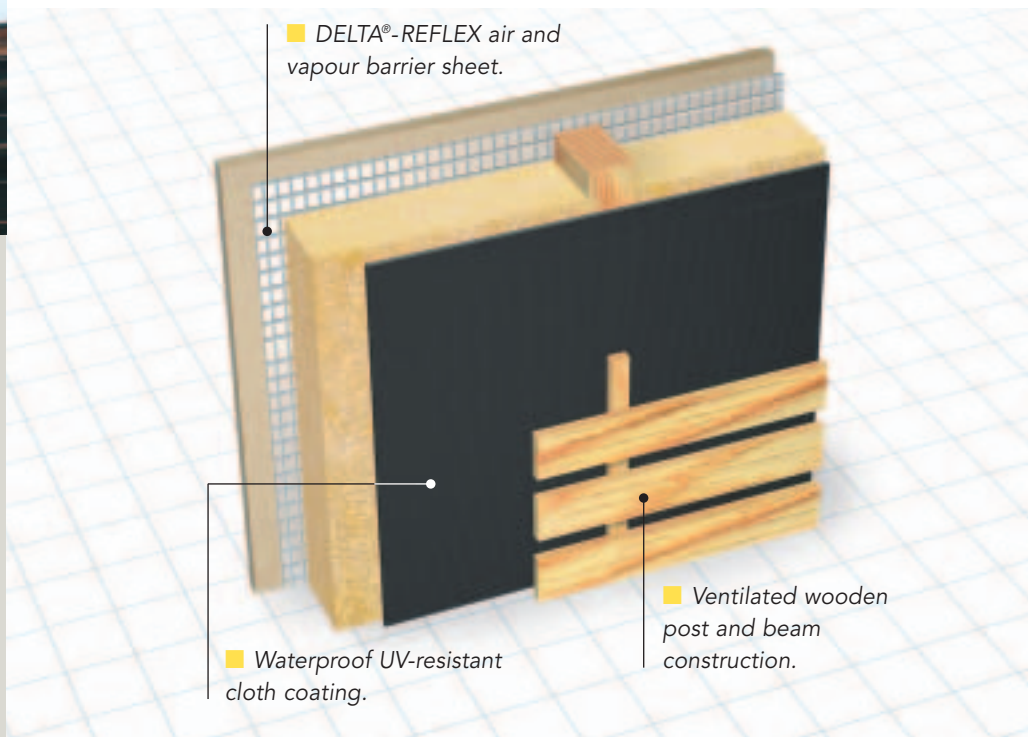

PREMIUM QUALITY



Ideal solution for wooden post and beam constructions.

DELTA®-FASSADE PLUS with integrated self-adhesive borders.

Lay sheets with an overlap of 10 cm.

DELTA®-FASSADE S

Waterproof. Highly tear-resistant.

DELTA®-FASSADE ...

- ... consists of a highly tear-resistant polyester cloth with a waterproof special coating.
- ... may be used as a breathable insulation-protection sheet in all back-vented facing constructions featuring open joints up to 20 mm wide that cover no more than 20 % of the surface.
- ... is permanently UV-resistant.
- ... offers high permeability to inside vapour through its S_d value of approx. 0.02 m.
- ... ensures a thoroughly agreeable interior climate in wooden post and beam constructions because of its excellent physical properties.
- ... represents the optimum solution for windproof facings in rehabilitation projects.
- ... may be used in metal constructions.

DELTA®-FASSADE S ...

- ... may be installed in all back-vented facing constructions featuring open joints up to 50 mm wide that cover no more than 40 % of the surface.
- ... is highly tear-resistant.
- ... is very easy to lay out.

DELTA®-FASSADE PLUS and DELTA®-FASSADE S PLUS feature integrated self-adhesive borders for fast windproofing.



DELTA®-FASSADE S offers safe protection under open facings with joints up to 50 mm wide.

Why not profit from the DELTA®System?

Outside ...

... DELTA®-FASSADE/DELTA®-FASSADE S breathable high-tenacity insulation-protection sheets. Safe protection from moisture from outside combined with optimum vapour permeability to transport moisture generated by residential use that penetrates the construction from inside.

Inside ...

... a DELTA®-REFLEX air and vapour barrier; as DELTA®-REFLEX PLUS with integrated self-adhesive border. An energy-saving sheet made of rugged, highly flexible 4-ply material. Reflects heat and saves on heating costs. Provides protection from electrical smog.



Needless to say, we have a range of perfect accessories, of which you find additional information on the next page.

DELTA®-FASSADE DELTA®-FASSADE S

Technical Data Overview:

Material	Highly tear-resistant polyester felt with a special waterproof plastic coating.
Application	Open facings featuring joints up to 20 mm wide that cover no more than 20 % of the surface. DELTA®-FASSADE S for open facings featuring joints up to 50 mm wide that cover no more than 40 % of the surface.
Fire resistance	Class E (EN 13501-1)
Tensile strength	approx. 270/230 N/5 cm approx. 370/270 N/5 cm (DELTA®-FASSADE S) (EN 12311-2)
Watertightness	Watertight W 1 (EN 13859-2) Watertight W 1 (EN 13859-1+2) (DELTA®-FASSADE S)
S _d value	approx. 0.02 m
Vapour flow resistance	approx. 0.028 m ² hPa/mg
Weight	approx. 210 g/m ² approx. 270 g/m ² (DELTA®-FASSADE S)
Roll weight	approx. 16 kg approx. 20 kg (DELTA®-FASSADE S)
Roll size	50 m x 1.5 m

Due to variable weather and UV conditions we recommend the efficient covering of our sheets.

DELTA®-Accessories for DELTA®-FASSADE/DELTA®-FASSADE S.

Dörken makes your life easier – systematically.

You are sure to appreciate these handy DELTA®-Accessories:



DELTA®-THAN

Permanently elastic sealing compound for fixing and seam jointing of DELTA® sheet products. Also can be used to secure connections.

DELTA®



DELTA® System ...

... for owners:

" ... What I get is a mature problem solution provided at a fair price by the top specialist in quality branded products!"

... for workers:

" ... What I get is a complete system made by a single manufacturer that enables me to do anything to the owner's entire satisfaction. There is no safer way!"

... for planners:

" ... I can be certain that both innovative and standard products will be used in implementing my roof and cellar plans in a systematic and forward-looking way."



Dörken GmbH & Co. KG
Wetterstraße 58
D-58313 Herdecke
Tel.: +49 23 30/63-0
Fax: +49 23 30/63-355
bvfd@doerken.de
www.doerken.de

A company of the Dörken Group.

■ Standard requests for tender and detailed installation instructions for all DELTA® products may be obtained from www.doerken.de as PDF files for you to print out and save.

Delta Membrane Systems Ltd.
Delta House, Merlin Way, North Weald, Epping, Essex CM16 6HR
TEL: 01992 523 523 • FAX: 01992 523 250