

FREE

call off +
scheduling
service

CAVITY TRAYS

Leaded and unleaded cavity trays for
brickwork, **blockwork**, **stonework** and more.

timloc
building products

CAVITY TRAYS

Timloc Building Products is one of the UK's leading manufacturers of building products for the residential market. Based in Howden, East Yorkshire, we design, manufacture and supply building product solutions from ground level right up to the roof ridge. Trust Timloc to deliver with our unrivalled NEXT DAY delivery service with a low carriage paid order value of just £100 to branch or £150 direct to site.

At Timloc, we offer a wide range of preformed leaded and unleaded cavity trays to meet almost any application requirement and type of masonry. We also have a wealth of experience in designing and manufacturing non-standard cavity trays for project requirements. Our cavity tray service also comes with free product specification, project scheduling and plot specific delivery consignments as needed.

timloc
building products

SALES

EMAIL: SALES@TIMLOC.CO.UK

TEL: 01405 765 567

TECHNICAL

EMAIL: TECHNICAL@TIMLOC.CO.UK

TEL: 01405 782 769



Visit the Timloc website for product information, data sheets, technical support and more:
WWW.TIMLOC.CO.UK

WHY TRUST TIMLOC WITH THE FULL PACKAGE?

- Quality, reliable and durable products
- Leaded and unleaded options available on certain products
- Free cavity tray specification and scheduling service

- Expert Technical support
- Full data sheets available on our website
- Unrivalled next working day delivery service on selected products

Timloc Building Products offer a plot specific delivery service to site for Unleaded and Polystrip cavity trays. Should this service be required, an additional 25% surcharge will be applied. Please specify on your order if you require this service.

Timloc Building Products is a **carbon neutral manufacturer**

At Timloc, we manufacture and supply sustainable building products designed to be integrated into the fabric of a building from ground level right up to the roof ridge. 75% of the products we manufacture are made from recycled materials and all of our products are made to last.



OUR JOURNEY TO **CARBON NEUTRALITY**

In 2021, Timloc became the **first building products manufacturer in the UK to achieve a carbon neutral status** after implementing various green initiatives to reduce and offset our carbon emissions to zero. 100% of our electricity is now generated from renewable energy sources, electric cars have been added to our fleet, and we have invested heavily in energy-efficient machinery, all of which contribute to our carbon neutral status.

Approximately 70% of our packaging is produced from recycled materials and **100% of our packaging is recyclable**.

All Timloc products experience a rigorous testing process prior to launch to ensure we only supply the highest quality products to market. The recycled materials we use originate from a variety of sources including plastic bottles, plastic trays and plastic car parts, such as bumpers and dashboards. The raw material produced as a result of the recycling process is robust, versatile, and environmentally friendly.

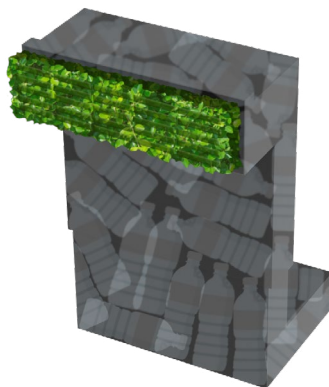

Trust Timloc to know the score...

100%

of our

Waste
is diverted from
landfill

Electricity
is generated from
renewable energy

Packaging
is recyclable



CAVITY TRAYS



Use the table below to establish **which Timloc cavity tray is best suited** to your project specification. Alternatively, get in touch with our Technical department who will be happy to assist with your enquiry.

Cavity Tray Type Application ▾	Everdry	Inter-loc	System 2000	System 2000E	Over Lintel	General Purpose	Parapet Horizontal	Purpose Made	Door & Window	Lintel Stopend
Pitched Roof	✔									
Flat Roof		✔	✔	✔						
Lean-to		✔	✔	✔						
Mono-pitch		✔	✔	✔						
Concrete Ring Beams		✔	✔	✔		✔				
Airbricks, Ducts, Liners, Meter Boxes etc.		✔	✔	✔		✔				
Existing Walls (Remedial Work)		✔		✔						
Steel Lintels					✔					✔
Parapet Walls							✔			
DPC Applications								✔		
Door & Window Arches									✔	
Circular Windows									✔	
Leaded Options	✔	✔	✔							

Timloc Building Products offer a wide range of preformed leaded and unleaded cavity trays to meet almost any application requirement and type of masonry. The product descriptions below provide a brief overview of the cavity tray types within the Timloc range:



Everdry Stepped Cavity Trays

Stepped cavity tray system for multi cavity options. Variable bed thickness options for brick/block/stone work. Leaded and unleaded options available.

Inter-loc Horizontal Cavity Trays

Pre-formed horizontal cavity tray system for new build and existing walls. Leaded and unleaded options available.



System 2000 Horizontal Cavity Trays

Horizontal cavity tray system suitable for new build brick/block/stone work constructions.

System 2000E Horizontal Cavity Trays

Horizontal cavity tray system suitable for remedial work on existing brick/block/stone work constructions.



Over Lintel Cavity Trays

For installation directly above modern steel lintels in external cavity walls.

Lintel Stopends

For installation where fair-faced masonry is supported by lintels, cavity trays or combined lintels.



General Purpose Cavity Trays

For installation in various applications such as above floor beams, roof abutments and meter boxes

Parapet Horizontal Cavity Trays

For installation directly into the internal wall of parapet wall applications.

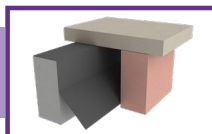

Purpose Made Cavity Trays

Special made-to-measure damp proof course units for DPC applications.

Door & Window Cavity Trays

Made-to-measure cavity tray systems for all types of door and window arches and circular windows.



EVERDRY ADJUSTABLE STEPPED CAVITY TRAYS FOR BRICKWORK

Stepped cavity tray system for multi cavity options in brick wall construction of 75mm course heights.

USE

- At the abutment of a pitched roof with a cavity wall
- On external walls - not exceeding 120mm thickness - built from standard brickwork or similar sized components with regular course heights, including mortar of approx. 75mm
- On roof pitches of 15 degrees and above
- Contact Timloc Technical for larger cavity widths



PRODUCTS IN THE RANGE

Intermediate trays: Suits all cavity options - forms main tray run with one tray on each course of brickwork running the full length of the abutting roof slope.

Stopend starters: First component to be installed and fitted at the lowest point on a standard abutment. It collects water gathered by the rest of the system and discharges it from the wall through a weep unit.

Corner starter trays: Has the same function as stopend starter tray but is used where the abutting roof comes up to, or beyond, the corner of the main building. Designed to return around the corner of the building to provide complete protection.

Ridge trays: Used where a right hand and left hand roof slope come together at an apex to straddle the top two intermediate trays.



Intermediate tray (LH)



Stopend starter tray (LH/RH)

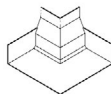

Corner starter tray (LH/RH)

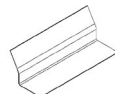

Ridge tray

Stepped cavity trays sloping measurement Roof pitch	Coursing height 75mm brick
10°	2.3
12.5°	2.9
15°	3.5
17.5°	4.0
20°	4.6
22.5°	5.1
25°	5.6
27.5°	6.2
30°	6.7
32.5°	7.2
35°	7.7
37.5°	8.1
40°	8.6
42.5°	9.0
45°	9.4

Stepped cavity trays horizontal measurement Roof pitch	Coursing height 75mm brick
10°	2.4
12.5°	3.0
15°	3.6
17.5°	4.2
20°	4.9
22.5°	5.5
25°	6.2
27.5°	7.0
30°	7.7
32.5°	8.5
35°	9.3
37.5°	10.2
40°	11.2
42.5°	12.2
45°	13.3

Description	Length	Handing	75mm Brick Coursing Product Codes to suit clear cavity widths of 50mm - 110mm	Lead Time
Intermediate tray	225mm	RH	10001	Next Working Day
Intermediate tray	225mm	LH	10002	Next Working Day
Intermediate tray	420mm*	RH	10011	Next Working Day
Intermediate tray	420mm*	LH	10012	Next Working Day
Stopend starter tray	225mm	RH/LH	10031	Next Working Day
Corner starter tray	225mm	RH/LH	10041	Next Working Day
Ridge tray	225mm	N/A	10061	Next Working Day
Ridge tray	420mm	N/A	10062	Next Working Day

For trays featuring the polystyrene strip mortar barrier insert 'P' at the end of the required product code. This may incur additional charge.

N.B Stopend starter, corner starter and ridge trays suit all roof pitches

* For roof pitches 15°-22.5°

525mm long tray available "fixed cavity" for roof pitches 10°-15°

Full datasheet and installation advice available at www.timloc.co.uk

EVERDRY STEPPED CAVITY TRAYS FOR STONEMWORK

Stepped cavity tray system for multi cavity options in stone wall construction of 150mm course heights.

USE

- At the abutment of a pitched roof with a cavity wall
- On external walls - not exceeding 150mm thickness - built from natural or reconstituted stone with regular course heights, including mortar of approx. 150mm
- On roof pitches of 7.5 degrees and above
- Contact Timloc Technical for larger cavity widths



PRODUCTS IN THE RANGE

Intermediate trays: Forms main tray run with one tray on each course of stonework running the full length of the abutting roof slope.

Stopend starters: Suits all roof pitches - first component to be installed and fitted at the lowest point on a standard abutment. It collects water gathered by the rest of the system and discharges it from the wall through a weep hole.

Corner starter trays: Suits all roof pitches - has same function as stopend starter tray but is used where the abutting roof comes up to, or beyond, the corner of the main building. Designed to return around the corner of the building to provide complete protection.

Ridge trays: Suits all roof pitches - used where a right hand and left hand roof slope come together at an apex to straddle the top two intermediate trays.

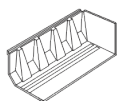

Intermediate tray (LH)



Stopend starter tray (LH/RH)

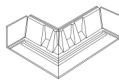

Corner starter tray (RH)



Ridge tray

150mm stone coursing - 100mm external wall thickness (bed)

Description	Length	Product Codes to suit clear cavity widths of:					
		50 - 74mm	Lead Time	75 - 99mm	Lead Time	100 - 125mm	Lead Time
Intermediate tray RH	450mm	7101	Next Working Day	7103	3 - 5 Working Days	7105	3 - 5 Working Days
Intermediate tray LH	450mm	7102	Next Working Day	7104	3 - 5 Working Days	7106	3 - 5 Working Days
Intermediate tray RH	625mm	7111	3 - 5 Working Days	7113	3 - 5 Working Days	7115	3 - 5 Working Days
Intermediate tray LH	625mm	7112	3 - 5 Working Days	7114	3 - 5 Working Days	7116	3 - 5 Working Days
Intermediate tray RH	1250mm	7121	3 - 5 Working Days	7123	3 - 5 Working Days	7125	3 - 5 Working Days
Intermediate tray LH	1250mm	7122	3 - 5 Working Days	7124	3 - 5 Working Days	7126	3 - 5 Working Days
Stopend starter tray RH/LH	450mm	7131	Next Working Day	7133	3 - 5 Working Days	7135	3 - 5 Working Days
Corner starter tray RH	550mm	7141	Next Working Day	7143	3 - 5 Working Days	7145	3 - 5 Working Days
Corner starter tray LH	550mm	7142	Next Working Day	7144	3 - 5 Working Days	7146	3 - 5 Working Days
Ridge tray	450mm	7161	Next Working Day	7162	3 - 5 Working Days	7163	3 - 5 Working Days

150mm stone coursing - 125mm external wall thickness (bed)

Description	Length	Product Codes to suit clear cavity widths of:					
		50 - 74mm	Lead Time	75 - 99mm	Lead Time	100 - 125mm	Lead Time
Intermediate tray RH	450mm	7103	3 - 5 Working Days	7105	3 - 5 Working Days	7107	3 - 5 Working Days
Intermediate tray LH	450mm	7104	3 - 5 Working Days	7106	3 - 5 Working Days	7108	3 - 5 Working Days
Intermediate tray RH	625mm	7113	3 - 5 Working Days	7115	3 - 5 Working Days	7117	3 - 5 Working Days
Intermediate tray LH	625mm	7114	3 - 5 Working Days	7116	3 - 5 Working Days	7118	3 - 5 Working Days
Intermediate tray RH	1250mm	7123	3 - 5 Working Days	7125	3 - 5 Working Days	7127	3 - 5 Working Days
Intermediate tray LH	1250mm	7124	3 - 5 Working Days	7126	3 - 5 Working Days	7128	3 - 5 Working Days
Stopend starter tray RH/LH	450mm	7133	3 - 5 Working Days	7135	3 - 5 Working Days	7137	3 - 5 Working Days
Corner starter tray RH	550mm	7143	3 - 5 Working Days	7145	3 - 5 Working Days	7147	3 - 5 Working Days
Corner starter tray LH	550mm	7144	3 - 5 Working Days	7146	3 - 5 Working Days	7148	3 - 5 Working Days
Ridge tray	450mm	7162	3 - 5 Working Days	7163	3 - 5 Working Days	7164	3 - 5 Working Days

For trays featuring the polystyrene strip mortar barrier insert 'P' at the end of the required product code. This may incur additional charge.

Contact Technical for wider cavities/bed widths: technical@timloc.co.uk

EVERDRY STEPPED CAVITY TRAYS FOR STONework CONTINUED

150mm stone coursing - 150mm external wall thickness (bed)

Description	Length	Product Codes to suit clear cavity widths of:					
		50 - 74mm	Lead Time	75 - 99mm	Lead Time	100 - 125mm	Lead Time
Intermediate tray RH	450mm	7105	3 - 5 Working Days	7107	3 - 5 Working Days	7109	3 - 5 Working Days
Intermediate tray LH	450mm	7106	3 - 5 Working Days	7108	3 - 5 Working Days	7110	3 - 5 Working Days
Intermediate tray RH	625mm	7115	3 - 5 Working Days	7117	3 - 5 Working Days	7119	3 - 5 Working Days
Intermediate tray LH	625mm	7116	3 - 5 Working Days	7118	3 - 5 Working Days	7120	3 - 5 Working Days
Intermediate tray RH	1250mm	7125	3 - 5 Working Days	7127	3 - 5 Working Days	7129	3 - 5 Working Days
Intermediate tray LH	1250mm	7126	3 - 5 Working Days	7128	3 - 5 Working Days	7130	3 - 5 Working Days
Stopend starter tray RH/LH	450mm	7135	Next Working Day	7137	3 - 5 Working Days	7139	3 - 5 Working Days
Corner starter tray RH	550mm	7145	3 - 5 Working Days	7147	3 - 5 Working Days	7149	3 - 5 Working Days
Corner starter tray LH	550mm	7146	3 - 5 Working Days	7148	3 - 5 Working Days	7150	3 - 5 Working Days
Ridge tray	450mm	7163	3 - 5 Working Days	7164	3 - 5 Working Days	7165	3 - 5 Working Days

For trays featuring the polystyrene strip mortar barrier insert 'P' at the end of the required product code. This may incur additional charge.

Contact Technical for wider cavities/bed widths: technical@timloc.co.uk

Full datasheet and installation advice available at www.timloc.co.uk

EVERDRY STEPPED CAVITY TRAYS FOR BLOCKWORK/STONEWORK

Stepped cavity tray system for blockwork/stonework construction of 225mm course heights.

USE

- At the abutment of a pitched roof with a cavity wall
- On external walls - not exceeding 150mm thickness - built from blockwork or stone with regular course heights, including mortar of approx. 225mm
- On roof pitches of 12.5 degrees and above
- Contact Timloc Technical for larger cavity widths



PRODUCTS IN THE RANGE

Intermediate trays: Forms main tray run with one tray on each course of blockwork/stonework running the full length of the abutting roof slope.

Stopend starters: Suits all roof pitches - first component to be installed and fitted at the lowest point on a standard abutment. It collects water gathered by the rest of the system and discharges it from the wall through a weep hole.

Corner starter trays: Suits all roof pitches - has same function as stopend starter tray but is used where the abutting roof comes up to, or beyond, the corner of the main building. Designed to return around the corner of the building to provide complete protection.

Ridge trays: Suits all roof pitches - used where a right hand and left hand roof slope come together at an apex to straddle the top two intermediate trays.

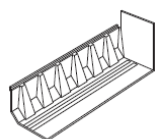

Intermediate tray (LH)

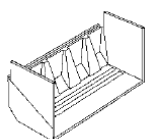

Stopend starter tray (LH/RH)

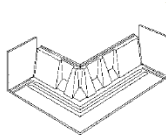

Corner starter tray (RH)

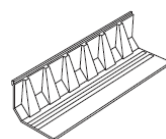

Ridge tray

EVERDRY STEPPED CAVITY TRAYS FOR BLOCKWORK/STONework

225mm block/stone coursing - 100mm external wall thickness (bed)

Description	Length	Product Codes to suit clear cavity widths of:					
		50 - 74mm	Lead Time	75 - 99mm	Lead Time	100 - 125mm	Lead Time
Intermediate tray RH	625mm	7201	Next Working Day	7203	3 - 5 Working Days	7205	3 - 5 Working Days
Intermediate tray LH	625mm	7202	Next Working Day	7204	3 - 5 Working Days	7206	3 - 5 Working Days
Intermediate tray RH	1250mm	7211	3 - 5 Working Days	7213	3 - 5 Working Days	7215	3 - 5 Working Days
Intermediate tray LH	1250mm	7212	3 - 5 Working Days	7214	3 - 5 Working Days	7216	3 - 5 Working Days
Stopend starter tray RH/LH	450mm	7231	Next Working Day	7233	3 - 5 Working Days	7235	3 - 5 Working Days
Corner starter tray RH	550mm	7241	3 - 5 Working Days	7243	3 - 5 Working Days	7245	3 - 5 Working Days
Corner starter tray LH	550mm	7242	3 - 5 Working Days	7244	3 - 5 Working Days	7246	3 - 5 Working Days
Ridge tray	625mm	7261	Next Working Day	7262	3 - 5 Working Days	7263	3 - 5 Working Days

225mm block/stone coursing - 125mm external wall thickness (bed)

Description	Length	Product Codes to suit clear cavity widths of:			Lead Time
		50 - 74mm	75 - 99mm	100 - 125mm	
Intermediate tray RH	625mm	7203	7205	7207	3 - 5 Working Days
Intermediate tray LH	625mm	7204	7206	7208	3 - 5 Working Days
Intermediate tray RH	1250mm	7213	7215	7217	3 - 5 Working Days
Intermediate tray LH	1250mm	7214	7216	7218	3 - 5 Working Days
Stopend starter tray RH/LH	450mm	7233	7235	7237	3 - 5 Working Days
Corner starter tray RH	550mm	7243	7245	7247	3 - 5 Working Days
Corner starter tray LH	550mm	7244	7246	7248	3 - 5 Working Days
Ridge tray	625mm	7262	7263	7264	3 - 5 Working Days

225mm block/stone coursing - 150mm external wall thickness (bed)

Description	Length	Product Codes to suit clear cavity widths of:			Lead Time
		50 - 74mm	75 - 99mm	100 - 125mm	
Intermediate tray RH	625mm	7205	7207	7209	3 - 5 Working Days
Intermediate tray LH	625mm	7206	7208	7210	3 - 5 Working Days
Intermediate tray RH	1250mm	7215	7217	7219	3 - 5 Working Days
Intermediate tray LH	1250mm	7216	7218	7220	3 - 5 Working Days
Stopend starter tray RH/LH	450mm	7235	7237	7239	3 - 5 Working Days
Corner starter tray RH	550mm	7245	7247	7249	3 - 5 Working Days
Corner starter tray LH	550mm	7246	7248	7250	3 - 5 Working Days
Ridge tray	625mm	7263	7264	7265	3 - 5 Working Days

For trays featuring the polystyrene strip mortar barrier insert 'P' at the end of the required product code. This may incur additional charge.

Contact Technical for wider cavities/bed widths: technical@timloc.co.uk

Full datasheet and installation advice available at www.timloc.co.uk

EVERDRY STEPPED CAVITY TRAYS FOR BRICKWORK - LEAD ATTACHED

Stepped leaded cavity tray system for multi cavity options in brickwall constructions of 75mm course heights.

USE

- At the abutment of a pitched roof with a cavity wall
- On external walls - not exceeding 120mm thickness - built from standard brickwork or similar sized components with regular course heights, including mortar of approx. 75mm
- On roof pitches of 15 degrees and above
- Contact Timloc Technical for larger cavity widths



**Free cavity tray specification
and scheduling service**

Contact Technical on
01405 782 769

PRODUCTS IN THE RANGE

Intermediate trays: Suits all cavity options - forms main tray run with one tray on each course of brickwork running the full length of the abutting roof slope.

Stopend starters: First component to be installed and fitted at the lowest point on a standard abutment. It collects water gathered by the rest of the system and discharges it from the wall through a weep unit.

Corner starter trays: Has same function as stopend starter tray but is used where the abutting roof comes up to, or beyond, the corner of the main building. Designed to return around the corner of the building to provide complete protection.

Ridge trays: Used where a right hand and left hand roof slope come together at an apex to straddle the top two intermediate trays.



**Intermediate tray
short lead (LH)**



**Intermediate tray
long lead (LH)**



**Stopend starter
tray short lead (LH)**

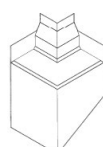

**Corner starter tray
long lead (LH)**



Ridge tray

Stepped cavity trays sloping measurement Roof pitch	Coursing height 75mm brick
10°	2.3
12.5°	2.9
15°	3.5
17.5°	4.0
20°	4.6
22.5°	5.1
25°	5.6
27.5°	6.2
30°	6.7
32.5°	7.2
35°	7.7
37.5°	8.1
40°	8.6
42.5°	9.0
45°	9.4

Stepped cavity trays horizontal measurement Roof pitch	Coursing height 75mm brick
10°	2.4
12.5°	3.0
15°	3.6
17.5°	4.2
20°	4.9
22.5°	5.5
25°	6.2
27.5°	7.0
30°	7.7
32.5°	8.5
35°	9.3
37.5°	10.2
40°	11.2
42.5°	12.2
45°	13.3

Description	Length	Handing	75mm Brick Coursing Product Codes to suit clear cavity widths of 50mm - 110mm	Lead Time
Intermediate tray	Varies	RH	20001	Next Working Day
Intermediate tray	Varies	LH	20002	Next Working Day
Stopend starter tray	225mm	RH/LH	20031/32	Next Working Day
Corner starter tray	225mm	RH/LH	20041/42	Next Working Day
Ridge tray	225mm	N/A	20061	Next Working Day
Ridge tray	420mm	N/A	20062	Next Working Day

Contact Technical for wider cavities/bed widths: technical@timloc.co.uk

N.B Intermediate trays are 225mm in length at roof pitches of 27.5 degrees and above. Below this pitch the length increases to 420mm and 525mm.

When ordering, please state roof pitch and whether long or short leads are required.

Full datasheet and installation advice available at www.timloc.co.uk

EVERDRY STEPPED CAVITY TRAYS FOR STONEMWORK - LEAD ATTACHED

Stepped cavity tray system for stonework constructions of 150mm course heights.

USE

- At the abutment of a pitched roof with a cavity wall
- On external walls - not exceeding 150mm thickness - built from natural or reconstituted stone with regular course heights, including mortar of approx. 150mm
- On roof pitches of 15 degrees and above
- Contact Timloc Technical for larger cavity widths



PRODUCTS IN THE RANGE

Intermediate trays: Forms main tray run with one tray on each course of stonework running the full length of the abutting roof slope.

Stopend starters: Suits all roof pitches - first component to be installed and fitted at the lowest point on a standard abutment. It collects water gathered by the rest of the system and discharges it from the wall through a weep hole.

Corner starter trays: Suits all roof pitches - has same function as stopend starter tray but is used where the abutting roof comes up to, or beyond, the corner of the main building. Designed to return around the corner of the building to provide complete protection. Corner starter trays are not supplied with factory fitted lead flashings due to the size and weight of lead flashing that would be required. Flashing in this area should be dealt with separately in the traditional way.

Ridge trays: Suits all roof pitches - used where a right hand and left hand roof slope come together at an apex to straddle the top two intermediate trays.

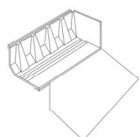

**Intermediate tray
long lead (LH)**

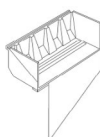

**Stopend starter tray
short lead (LH)**

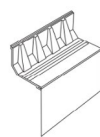

Ridge tray

150mm stone coursing - 100mm external wall thickness (bed)

Description	Length	Product Codes to suit clear cavity widths of:					
		50 - 74mm	Lead Time	75 - 99mm	Lead Time	100 - 125mm	Lead Time
Intermediate tray RH	Varies	8101	3 - 5 Working Days	8103	3 - 5 Working Days	8105	3 - 5 Working Days
Intermediate tray LH	Varies	8102	3 - 5 Working Days	8104	3 - 5 Working Days	8106	3 - 5 Working Days
Stopend starter tray RH	450mm	8131	3 - 5 Working Days	8133	3 - 5 Working Days	8135	3 - 5 Working Days
Stopend starter tray LH	450mm	8132	3 - 5 Working Days	8134	3 - 5 Working Days	8136	3 - 5 Working Days
Corner starter tray RH*	550mm	7141	Next Working Day	7143	3 - 5 Working Days	7145	3 - 5 Working Days
Corner starter tray LH*	550mm	7142	3 - 5 Working Days	7144	3 - 5 Working Days	7146	3 - 5 Working Days
Ridge tray	450mm	8161	3 - 5 Working Days	8162	3 - 5 Working Days	8163	3 - 5 Working Days

150mm stone coursing - 125mm external wall thickness (bed)

Description	Length	Product Codes to suit clear cavity widths of:			Lead Time
		50 - 74mm	75 - 99mm	100 - 125mm	
Intermediate tray RH	Varies	8103	8105	8107	3 - 5 Working Days
Intermediate tray LH	Varies	8104	8106	8108	3 - 5 Working Days
Stopend starter tray RH	450mm	8133	8135	8137	3 - 5 Working Days
Stopend starter tray LH	450mm	8134	8136	8138	3 - 5 Working Days
Corner starter tray RH*	550mm	7143	7145	7147	3 - 5 Working Days
Corner starter tray LH*	550mm	7144	7146	7148	3 - 5 Working Days
Ridge tray	450mm	8162	8163	8164	3 - 5 Working Days

150mm stone coursing - 150mm external wall thickness (bed)

Description	Length	Product Codes to suit clear cavity widths of:			Lead Time
		50 - 74mm	75 - 99mm	100 - 125mm	
Intermediate tray RH	Varies	8105	8107	8109	3 - 5 Working Days
Intermediate tray LH	Varies	8106	8108	8110	3 - 5 Working Days
Stopend starter tray RH	450mm	8135	8137	8139	3 - 5 Working Days
Stopend starter tray LH	450mm	8136	8138	8140	3 - 5 Working Days
Corner starter tray RH*	550mm	7145	7147	7149	3 - 5 Working Days
Corner starter tray LH*	550mm	7146	7148	7150	3 - 5 Working Days
Ridge tray	450mm	8163	8164	8165	3 - 5 Working Days

Contact Technical for wider cavities/bed widths: technical@timloc.co.uk

When ordering state roof pitch and whether long or short leads are required.

* Not supplied with factory fitted lead flashings.

Full datasheet and installation advice available at www.timloc.co.uk

EVERDRY STEPPED CAVITY TRAYS FOR BLOCKWORK - LEAD ATTACHED

Stepped leaded cavity tray system for blockwork/stonework constructions of 225mm course heights.

USE

- At the abutment of a pitched roof with a cavity wall
- Clear cavity widths of between 50mm-125mm
- On external walls - not exceeding 150mm thickness - built from blockwork with regular course heights, including mortar of approx. 150mm
- Contact Timloc Technical for larger cavity widths



PRODUCTS IN THE RANGE

Intermediate trays: Forms main tray run with one tray on each course of blockwork/stonework running the full length of the abutting roof slope.

Stopend starters: Suits all roof pitches - first component to be installed and fitted at the lowest point on a standard abutment. It collects water gathered by the rest of the system and discharges it from the wall through a weep hole.

Corner starter trays: Suits all roof pitches - has same function as stopend starter tray but is used where the abutting roof comes up to, or beyond, the corner of the main building. Designed to return around the corner of the building to provide complete protection. Corner starter trays are not supplied with factory fitted lead flashings due to the size and weight of lead flashing that would be required. Flashing in this area should be dealt with separately in the traditional way.

Ridge trays: Suits all roof pitches - used where a right hand and left hand roof slope come together at an apex to straddle the top two intermediate trays.

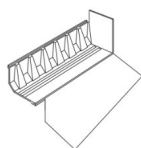

**Intermediate tray
long lead (LH)**

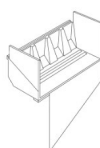

**Stopend starter tray
short lead (LH)**

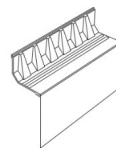

Ridge tray

225mm block/stone coursing - 100mm external wall thickness (bed)

Description	Length	Product Codes to suit clear cavity widths of:			Lead Time
		50 - 74mm	75 - 99mm	100 - 125mm	
Intermediate tray RH	Varies	8201	8203	8205	3 - 5 Working Days
Intermediate tray LH	Varies	8202	8204	8206	3 - 5 Working Days
Stopend starter tray RH	450mm	8231	8233	8235	3 - 5 Working Days
Stopend starter tray LH	450mm	8232	8234	8236	3 - 5 Working Days
Corner starter tray RH*	550mm	7241	7243	7245	3 - 5 Working Days
Corner starter tray LH*	550mm	7242	7244	7246	3 - 5 Working Days
Ridge tray	450mm	8261	8262	8263	3 - 5 Working Days

225mm block/stone coursing - 125mm external wall thickness (bed)

Description	Length	Product Codes to suit clear cavity widths of:			Lead Time
		50 - 74mm	75 - 99mm	100 - 125mm	
Intermediate tray RH	Varies	8203	8205	8207	3 - 5 Working Days
Intermediate tray LH	Varies	8204	8206	8208	3 - 5 Working Days
Stopend starter tray RH	450mm	8233	8235	8237	3 - 5 Working Days
Stopend starter tray LH	450mm	8234	8236	8238	3 - 5 Working Days
Corner starter tray RH*	550mm	7243	7245	7247	3 - 5 Working Days
Corner starter tray LH*	550mm	7244	7246	7248	3 - 5 Working Days
Ridge tray	450mm	8262	8263	8264	3 - 5 Working Days

225mm block/stone coursing - 150mm external wall thickness (bed)

Description	Length	Product Codes to suit clear cavity widths of:			Lead Time
		50 - 74mm	75 - 99mm	100 - 125mm	
Intermediate tray RH	Varies	8205	8207	8209	3 - 5 Working Days
Intermediate tray LH	Varies	8206	8208	8210	3 - 5 Working Days
Stopend starter tray RH	450mm	8235	8237	8239	3 - 5 Working Days
Stopend starter tray LH	450mm	8236	8238	8240	3 - 5 Working Days
Corner starter tray RH*	550mm	7245	7247	7249	3 - 5 Working Days
Corner starter tray LH*	550mm	7246	7248	7250	3 - 5 Working Days
Ridge tray	450mm	8263	8264	8265	3 - 5 Working Days

Contact Technical for wider cavities/bed widths: technical@timloc.co.uk

When ordering state roof pitch and whether long or short leads are required.

* Not supplied with factory fitted lead flashings.

Full datasheet and installation advice available at www.timloc.co.uk

INTER-LOC HORIZONTAL CAVITY TRAYS

Preformed horizontal cavity tray system for **new build** and **existing walls**.

USE

- At the abutment of a flat roof with a cavity wall
- At the abutment of a lean-to or mono pitch roof with a cavity wall
- Over concrete ring beams
- Over airbricks, cavity liners, ducts, meter boxes, etc.
- On external walls - not exceeding 102.5mm in thickness - built from standard brick, block or stone
- Clear cavity widths of between 50mm-125mm



**Free cavity tray specification
and scheduling service**

Contact Technical on
01405 782 769

PRODUCTS IN THE RANGE

Horizontal Inter-loc cavity trays: The main cavity tray component. Sections join together by means of a lapped interlocking join, to form the main cavity tray run. Water is gathered by the cavity tray and is discharged from the wall through a series of weep holes - one weep hole per Inter-loc tray is required.

Corner units: Allows the integrity of the main cavity tray run to be maintained when it is necessary to turn a corner on a building. Available in either external or internal format.

Stopends: Fitted at the start and finish of the cavity tray run to seal off the open ends and prevent water running back into the cavity.



**Existing build
horizontal tray
IL2/E**

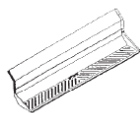

**New build
horizontal tray
IL4**



**New build
external corner
EXT90**



**New build
internal corner
INT90**

New build applications - Inter-loc horizontal cavity trays

Description	Effective Length	Product Code	Lead Time
Inter-loc horizontal tray	4 brick/900mm	IL4	Next Working Day
Inter-loc horizontal tray	2 brick/450mm	IL2	Next Working Day
External 90° corner	1 brick/220mm	Ext 90	Next Working Day
Internal 90° corner	1 brick/220mm	Int 90	Next Working Day
External 135° corner	330mm	Ext 135	3 - 5 Working Days
Internal 135° corner	150mm	Int 135	3 - 5 Working Days
Stopend RH	-	SERH	Next Working Day
Stopend LH	-	SELH	Next Working Day

Existing applications - Inter-loc horizontal cavity trays

Description	Effective Length	Product Code	Lead Time
Inter-loc horizontal tray	2 brick/450mm	IL2/E	Next Working Day
External 90° corner	1 brick/220mm	Ext 90/E	Next Working Day
Internal 90° corner	1 brick/220mm	Int 90/E	Next Working Day
External 135° corner	330mm	Ext 135/E	3 - 5 Working Days
Internal 135° corner	150mm	Int 135/E	3 - 5 Working Days
Stopend RH	-	SERH	Next Working Day
Stopend LH	-	SELH	Next Working Day

For trays featuring the polystyrene strip mortar barrier insert 'P' at the end of the required product code. This may incur additional charge.

Full datasheet and installation advice available at www.timloc.co.uk

SYSTEM 2000 HORIZONTAL CAVITY TRAYS

Horizontal cavity tray system for all types of brick, block and stone **new build constructions**.

USE

- At the abutment of a flat roof with a cavity wall
- At the abutment of a lean-to or mono pitch roof with a cavity wall
- Over concrete ring beams
- Over airbricks, cavity liners, ducts, meter boxes, etc.
- Clear cavity widths of between 50mm-150mm



PRODUCTS IN THE RANGE

Horizontal cavity trays: The main cavity tray component. Sections join together by means of a lapped joint, sealed with factory applied butyl mastic tape, to form the main cavity tray run. Water is gathered by the cavity tray and is discharged from the wall through a series of weep holes.

Corner units: Allows the integrity of the main cavity tray run to be maintained when it is necessary to turn a corner on a building. External or internal.

Stopends: Fitted at the start and finish of the cavity tray run to seal off the open ends and prevent water running back into the cavity.

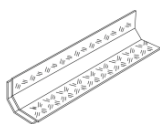

**Horizontal
cavity tray**



External corner



Internal corner

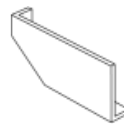

Stopend (LH)

System 2000 horizontal cavity trays (new build)

Description	Length	Product Codes to suit clear cavity widths of:			
		50 - 74mm	Lead Time	75 - 99mm	Lead Time
Horizontal tray	880/830mm	2075/880/50	Next Working Day	2075/880/75	Next Working Day
Horizontal tray	460/410mm	2075/460/50	Next Working Day	2075/460/75	Next Working Day
External 90° corner	N/A	2010/50	Next Working Day	2010/75	Next Working Day
Internal 90° corner	N/A	2011/50	Next Working Day	2011/75	Next Working Day
External 135° corner	N/A	2012/50	3 - 5 Working Days	2012/75	3 - 5 Working Days
Internal 135° corner	N/A	2013/50	3 - 5 Working Days	2013/75	3 - 5 Working Days
Stopend RH	N/A	2003/50	Next Working Day	2003/75	Next Working Day
Stopend LH	N/A	2004/50	Next Working Day	2004/75	Next Working Day

System 2000 horizontal cavity trays (new build)

Description	Length	Product Codes to suit clear cavity widths of:			
		100 - 124mm	Lead Time	125 - 150mm	Lead Time
Horizontal tray	880/830mm	2075/880/100	Next Working Day	2075/880/150	3 - 5 Working Days
Horizontal tray	460/410mm	2075/460/100	Next Working Day	2075/460/150	3 - 5 Working Days
External 90° corner	N/A	2010/100	Next Working Day	2010/150	Next Working Day
Internal 90° corner	N/A	2011/100	Next Working Day	2011/150	Next Working Day
External 135° corner	N/A	2012/100	3 - 5 Working Days	2012/150	3 - 5 Working Days
Internal 135° corner	N/A	2013/100	3 - 5 Working Days	2013/150	3 - 5 Working Days
Stopend RH	N/A	2003/100	Next Working Day	2003/150	Next Working Day
Stopend LH	N/A	2004/100	Next Working Day	2004/150	Next Working Day

For trays featuring the polystyrene strip mortar barrier insert 'P' at the end of the required product code. This may incur additional charge.

Full datasheet and installation advice available at www.timloc.co.uk

SYSTEM 2000E HORIZONTAL CAVITY TRAYS FOR REFURBISHMENT

Horizontal cavity tray system for remedial work on **existing walls**.

USE

- For remedial work where a horizontal cavity tray must be inserted into an existing wall
- At the abutment of a flat roof with a cavity wall
- At the abutment of a lean-to or mono pitch roof with a cavity wall
- Over airbricks, cavity liners, ducts, meter boxes, etc.
- On external walls - not exceeding 102.5mm in thickness - built from standard brick, block or stone
- Contact Timloc Technical for larger cavity widths



PRODUCTS IN THE RANGE

Horizontal cavity trays: The main cavity tray component. Sections join together by means of a lapped joint, sealed with factory applied butyl mastic tape, to form the main cavity tray run. Water is gathered by the cavity tray and is discharged from the wall through a series of weep holes.

Corner units: Allows the integrity of the main cavity tray run to be maintained when it is necessary to turn a corner on a building. Available in either external or internal format.

Stopends: Fitted at the start and finish of the cavity tray run to seal off the open ends and prevent water running back into the cavity.



**E-horizontal
cavity tray**



External corner

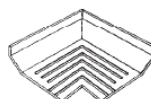

Internal corner



Stopend (LH)

System 2000E horizontal cavity trays (existing walls)

Description	Length	Product Codes to suit clear cavity widths of:			
		50 - 74mm	Lead Time	75 - 99mm	Lead Time
Horizontal tray	460/440mm	2005/50	Next Working Day	2005/75	Next Working Day
External 90° corner	N/A	2006/50	3-5 Working Days	2006/75	3-5 Working Days
Internal 90° corner	N/A	2007/50	3-5 Working Days	2007/75	3-5 Working Days
Stopend RH	N/A	2003/50	Next Working Day	2003/75	Next Working Day
Stopend LH	N/A	2004/50	Next Working Day	2004/75	Next Working Day

Description	Length	Product Codes to suit clear cavity widths of: 100 - 125mm	Lead Time
Horizontal tray	460/440mm	2005/100	Next Working Day
External 90° corner	N/A	2006/100	3-5 Working Days
Internal 90° corner	N/A	2007/100	3-5 Working Days
Stopend RH	N/A	2003/100	Next Working Day
Stopend LH	N/A	2004/100	Next Working Day

Contact Technical for wider cavities/bed widths: technical@timloc.co.uk

The Inter-loc Cavity Tray system is also suitable for remedial work. **See P. 20**

For trays featuring the polystyrene strip mortar barrier insert 'P' at the end of the required product code. This may incur additional charge.

Full datasheet and installation advice available at www.timloc.co.uk

INTER-LOC HORIZONTAL CAVITY TRAYS - LEAD ATTACHED

Preformed leaded cavity tray system for new build.

USE

- At the abutment of a flat roof with a cavity wall
- At the abutment of a lean-to or mono pitch roof with a cavity wall
- On external walls - not exceeding 102.5mm in thickness - built from standard brick, block or stone
- Clear cavity widths of between 50mm-125mm



PRODUCTS IN THE RANGE

Horizontal cavity trays: The main cavity tray component sections join together by means of a lapped interlocking joint, to form the main cavity tray run. Water is gathered by the cavity tray and is discharged from the wall through a series of weep holes - one weep hole per Inter-loc tray is required.

Corner units: Allows the integrity of the main cavity tray run to be maintained when it is necessary to turn a corner on a building. Available in either external or internal format.

Stopends: Fitted at the start and finish of the cavity tray run to seal off the open ends and prevent water running back into the cavity.



4 brick (300mm drop lead) IL4



2 brick horizontal cavity tray (150mm drop lead) IL2



External corner (300mm drop lead)



Internal corner 150mm (drop lead range)

New build applications with lead attached - 150mm drop lead - Inter-loc horizontal leaded cavity trays

Description	Effective Length	Product Code	Lead Time
Inter-loc horizontal tray	4 brick/900mm	IL4L150	Next Working Day
Inter-loc horizontal tray	2 brick/450mm	IL2L150	Next Working Day
External 90° corner	1 brick/220mm	EXT90L150	Next Working Day
Internal 90° corner	1 brick/220mm	INT90L150	Next Working Day
External 135° corner	330mm	EXT135L150	3 - 5 Working Days
Internal 135° corner	150mm	INT135L150	3 - 5 Working Days
Stopend RH		SERH	Next Working Day
Stopend LH		SELH	Next Working Day

New build applications with lead attached - 300mm drop lead - Inter-loc horizontal leaded cavity trays

Description	Effective Length	Product Code	Lead Time
Inter-loc horizontal tray	4 brick/900mm	IL4L300	Next Working Day
Inter-loc horizontal tray	2 brick/450mm	IL2L300	Next Working Day
External 90° corner	1 brick/220mm	EXT90L300	Next Working Day
Internal 90° corner	1 brick/220mm	INT90L300	Next Working Day
External 135° corner	330mm	EXT135L300	3 - 5 Working Days
Internal 135° corner	150mm	INT135L300	3 - 5 Working Days
Stopend RH		SERH	Next Working Day
Stopend LH		SELH	Next Working Day

Full datasheet and installation advice available at www.timloc.co.uk

SYSTEM 2000 HORIZONTAL CAVITY TRAYS - LEAD ATTACHED

Horizontal leaded cavity tray system for all types of brick, block and stone new build constructions.

USE

- At abutment of a lean-to, flat or mono pitch roof and cavity wall
- On external walls - not exceeding 102.5mm in thickness - built from standard brickwork, blockwork or stone
- Contact Timloc Technical for larger cavity widths



PRODUCTS IN THE RANGE

Horizontal cavity trays: The main cavity tray component. Sections join together by means of a lapped joint, sealed with factory applied butyl mastic tape, to form the main cavity tray run. Water is gathered by the cavity tray and is discharged from the wall through a series of weep holes.

Corner units: Allows the integrity of the main cavity tray run to be maintained when it is necessary to turn a corner on a building. External or internal.

Stopends: Fitted at the start and finish of the cavity tray run to seal off the open ends and prevent water running back into the cavity.

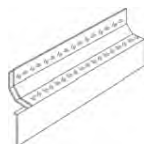

Horizontal cavity tray

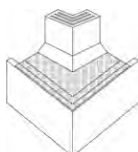

External corner

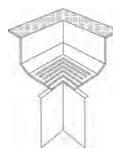

Internal corner

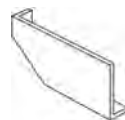

Stopend (LH)

System 2000 horizontal cavity trays (new build)

Description	Length	Product Codes to suit clear cavity widths of:			
		50 - 74mm	Lead Time	75 - 99mm	Lead Time
Horizontal tray	880/830mm Short lead	2075/880/50/L150	3 - 5 Working Days	2075/880/75/L150	3 - 5 Working Days
Horizontal tray	880/830mm Long lead	2075/880/50/L300	3 - 5 Working Days	2075/880/75/L300	3 - 5 Working Days
Horizontal tray	460/440mm Short lead	2075/460/50/L150	3 - 5 Working Days	2075/460/75/L150	3 - 5 Working Days
Horizontal tray	460/440mm Long lead	2075/460/50/L300	3 - 5 Working Days	2075/460/75/L300	3 - 5 Working Days
External 90° corner	Short lead	2010L150/50	3 - 5 Working Days	2010L150/75	3 - 5 Working Days
External 90° corner	Long lead	2010L300/50	3 - 5 Working Days	2010L300/75	3 - 5 Working Days
Internal 90° corner	Short lead	2011L150/50	3 - 5 Working Days	2011L150/75	3 - 5 Working Days
Internal 90° corner	Long lead	2011L300/50	3 - 5 Working Days	2011L300/75	3 - 5 Working Days
External 135° corner	Long lead	2012L300/50	3 - 5 Working Days	2012L300/75	3 - 5 Working Days
Internal 135° corner	Long lead	2013L300/50	3 - 5 Working Days	2013L300/75	3 - 5 Working Days
Stopend RH	N/A	2003/50	Next Working Day	2003/75	Next Working Day
Stopend LH	N/A	2004/50	Next Working Day	2004/75	Next Working Day

Description	Length	Product Codes to suit clear cavity widths of: 100 - 125mm	Lead Time
Horizontal tray	880/830mm Short lead	2075/880/100/L150	3 - 5 Working Days
Horizontal tray	880/830mm Long lead	2075/880/100/L300	3 - 5 Working Days
Horizontal tray	460/440mm Short lead	2075/460/100/L150	3 - 5 Working Days
Horizontal tray	460/440mm Long lead	2075/460/100/L300	3 - 5 Working Days
External 90° corner	Short lead	2010L150/100	3 - 5 Working Days
External 90° corner	Long lead	2010L300/100	3 - 5 Working Days
Internal 90° corner	Short lead	2011L150/100	3 - 5 Working Days
Internal 90° corner	Long lead	2011L300/100	3 - 5 Working Days
External 135° corner	Long lead	2012L300/100	3 - 5 Working Days
Internal 135° corner	Long lead	2013L300/100	3 - 5 Working Days
Stopend RH	N/A	2003/100	Next Working Day
Stopend LH	N/A	2004/100	Next Working Day

*State whether long (300mm) or short (150mm) leads are required. Long leads are used where flashing is required to dress directly over the top of the roof tile. Short leads are used where there is a soaker or secret gutter detail.

OVER LINTEL, GENERAL PURPOSE AND PARAPET HORIZONTAL CAVITY TRAYS

A range to protect modern steel lintels, general purpose horizontal and parapet cavity applications.

USE

- Over steel lintels in external cavity walls (LCT)
- General purpose horizontal cavity applications such as floor beams, abutments and meter boxes (GCT)
- For parapet walls (HPT)

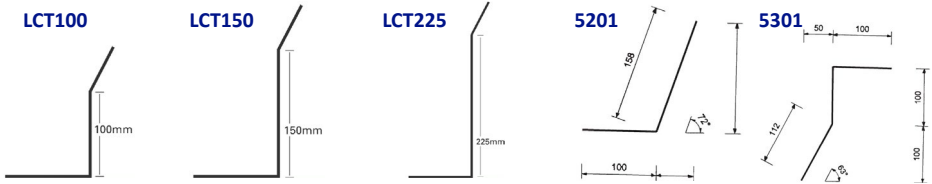

Description	Product Codes to suit clear cavity widths of:			Lead Time
	50mm	75mm	100mm	
LCT100 Lintel tray	5001	5002	5003	3 - 5 Working Days
LCT150 Lintel tray	5004	5005	5006	3 - 5 Working Days
LCT225 Lintel tray	5007	5008	5009	3 - 5 Working Days
GCT50 Horizontal tray	5201	-	-	3 - 5 Working Days
GCT75 Horizontal tray	-	5202	-	3 - 5 Working Days
GCT100 Horizontal tray	-	-	5203	3 - 5 Working Days
HPT50 Horizontal tray	5301	-	-	3 - 5 Working Days
HPT75 Horizontal tray	-	5302	-	3 - 5 Working Days
HPT100 Horizontal tray	-	-	5303	3 - 5 Working Days

Full datasheet and installation advice available at www.timloc.co.uk

PURPOSE MADE CAVITY TRAYS

Special made to measure damp proof course units for DPC applications.

USE

- Wherever DPC is used to form a horizontal cavity tray
- To substitute the cutting, moulding and sealing of a DPC when forming cavity trays, angles, stop ends and column cloaks

PRODUCTS IN THE RANGE

- Cavity trays for brick support systems
- Pier, column and corner cloaks
- Threshold trays
- Change of level units
- Stop end and junction cappings
- Radius units
- Ring beam cavity tray systems
- Parapet cavity tray systems

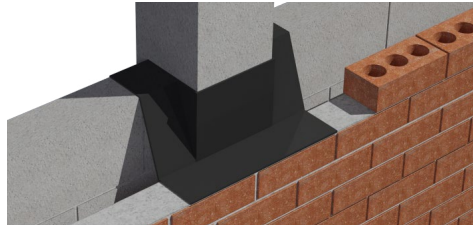

**Threshold
trays**

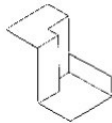

**Corner / column
stopends**

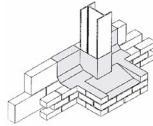

**Pier and column
cloaks**

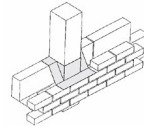

**Straight column
cloaks**

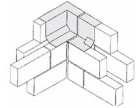

**Corner
expansion joints**

HOW TO ORDER

These cavity trays are made to order, so please supply full construction details. Ideally these will include a fully dimensioned drawing.

Full datasheet and installation advice available at www.timloc.co.uk

LINTEL STOPEND

Profile to protect modern steel lintels.

USE

- On steel lintels situated in external walls
- On external walls - not exceeding 102.5mm in thickness - built in standard brick, block or stone

HOW TO ORDER

- Two stopends are required per lintel

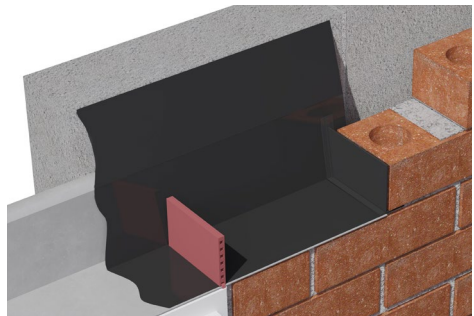

Product Code	Description	Lead Time
LS01	Lintel stopend	Next Working Day

Full datasheet and installation advice available at www.timloc.co.uk

CAVITY TRAYS FOR **DOOR** AND **WINDOW** OPENINGS

Tailor-made cavity tray systems for all types of door/window arches and circular windows.

USE

- Around the opening of an external door or window with an arched top or a circular external window
- On external walls - built from brick, block or stone as well as timber frame constructions - of any thickness and any cavity width

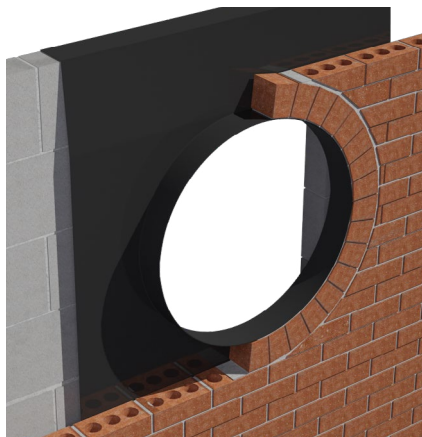
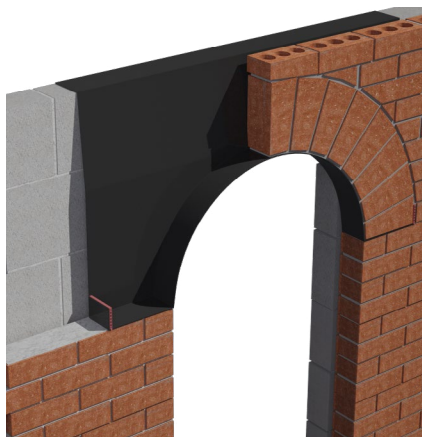

Free cavity tray specification and scheduling service

Contact Technical on 01405 782 769

HOW TO ORDER

Arch cavity trays are made to order, so please supply full construction details.

Ideally these will include a fully dimensioned drawing showing door/window opening size and wall construction details. If this is not possible the minimum information required is:

- Thickness of outer leaf and cavity width
- Clear opening width and height of door/window opening
- Radius of curvature
- Position of spring line
- With this data Timloc will be able to produce and despatch a dimensioned drawing for your approval

Full datasheet and installation advice available at www.timloc.co.uk

Product Code	Description	Lead Time	Page No.
10001	Everdry 225mm Intermediate Brickwork Cavity Tray Right Hand	Next Working Day	6
10002	Everdry 225mm Intermediate Brickwork Cavity Tray Left Hand	Next Working Day	6
10011	Everdry 420mm Intermediate Brickwork Cavity Tray Right Hand	Next Working Day	6
10012	Everdry 420mm Intermediate Brickwork Cavity Tray Left Hand	Next Working Day	6
10031	Everdry 225mm Stop End Starter Brickwork Cavity Tray Right & Left Handed	Next Working Day	6
10041	Everdry 225mm Corner Starter Brickwork Cavity Tray Right & Left Handed	Next Working Day	6
10061	Everdry 225mm Ridge Brickwork Cavity Tray	Next Working Day	6
10062	Everdry 420mm Ridge Brickwork Cavity Tray	Next Working Day	6
10001P	Poly Strip Everdry 225mm Intermediate Brickwork Cavity Tray Right Hand	Next Working Day	6
10002P	Poly Strip Everdry 225mm Intermediate Brickwork Cavity Tray Left Hand	Next Working Day	6
10011P	Poly Strip Everdry 420mm Intermediate Brickwork Cavity Tray Right Hand	Next Working Day	6
10012P	Poly Strip Everdry 420mm Intermediate Brickwork Cavity Tray Left Hand	Next Working Day	6
10031P	Poly Strip Everdry 225mm Stop End Starter Brickwork Cavity Tray Right & Left Handed	Next Working Day	6
10041P	Poly Strip Everdry 225mm Corner Starter Brickwork Cavity Tray Right & Left Handed	Next Working Day	6
10061P	Poly Strip Everdry 225mm Ridge Brickwork Cavity Tray	Next Working Day	6
10062P	Poly Strip Everdry 420mm Ridge Brickwork Cavity Tray	3 - 5 Working Days	6
7101-7102	Everdry 450mm Intermediate Stonework Cavity Tray	Next Working Day	8
7103-7104	Everdry 450mm Intermediate Stonework Cavity Tray	3 - 5 Working Days	8
7105-7106	Everdry 450mm Intermediate Stonework Cavity Tray	3 - 5 Working Days	8
7107-7110	Everdry 450mm Intermediate Stonework Cavity Tray	3 - 5 Working Days	8
7111-7120	Everdry 625mm Intermediate Stonework Cavity Tray	3 - 5 Working Days	8
7121-7130	Everdry 1250mm Intermediate Stonework Cavity Tray	3 - 5 Working Days	8
7131	Everdry 450mm Stop End Starter Stonework Cavity Tray Right & Left Handed	Next Working Day	8
7132-7134	Everdry 450mm Stop End Starter Stonework Cavity Tray Right & Left Handed	3 - 5 Working Days	8
7135	Everdry 450mm Stop End Starter Stonework Cavity Tray Right & Left Handed	3 - 5 Working Days	8
7136-7139	Everdry 450mm Stop End Starter Stonework Cavity Tray Right & Left Handed	3 - 5 Working Days	8
7141 - 7142	Everdry 550mm Corner Starter Stonework Cavity Tray Right & Left Handed	Next Working Day	8
7143-7150	Everdry 550mm Corner Starter Stonework Cavity Tray Right & Left Handed	3 - 5 Working Days	8
7161	Everdry 450mm Ridge Stonework Cavity Tray	Next Working Day	8
7162-7165	Everdry 450mm Ridge Stonework Cavity Tray	3 - 5 Working Days	8
7101P-7102P	Poly Strip Everdry 450mm Intermediate Stonework Cavity Tray	Next Working Day	8
7103P-7110P	Poly Strip Everdry 450mm Intermediate Stonework Cavity Tray	3 - 5 Working Days	8
7111P-7120P	Poly Strip Everdry 625mm Intermediate Stonework Cavity Tray	3 - 5 Working Days	8
7121P-7130P	Poly Strip Everdry 1250mm Intermediate Stonework Cavity Tray	3 - 5 Working Days	8
7131P	Poly Strip Everdry 450mm Stop End Starter Stonework Cavity Tray Right & Left Handed	Next Working Day	8
7132P-7139P	Poly Strip Everdry 450mm Stop End Starter Stonework Cavity Tray Right & Left Handed	3 - 5 Working Days	8
7141P-7150P	Poly Strip Everdry 550mm Corner Starter Stonework Cavity Tray Right & Left Handed	3 - 5 Working Days	8
7161P	Poly Strip Everdry 450mm Ridge Stonework Cavity Tray	Next Working Day	8
7162P-7165P	Poly Strip Everdry 450mm Ridge Stonework Cavity Tray	3 - 5 Working Days	8
7201-7202	Everdry 625mm Intermediate Blockwork Cavity Tray	Next Working Day	11
7203-7210	Everdry 625mm Intermediate Blockwork Cavity Tray	3 - 5 Working Days	11
7211-7220	Everdry 1250mm Intermediate Blockwork Cavity Tray	3 - 5 Working Days	11
7231	Everdry 450mm Stop End Starter Blockwork Cavity Tray Right & Left Handed	Next Working Day	11
7232-7239	Everdry 450mm Stop End Starter Blockwork Cavity Tray Right & Left Handed	3 - 5 Working Days	11
7241-8250	Everdry 550mm Corner Starter Blockwork Cavity Tray Right & Left Handed	3 - 5 Working Days	11
7261	Everdry 625mm Ridge Blockwork Cavity Tray	Next Working Day	11
7262-7265	Everdry 625mm Ridge Blockwork Cavity Tray	3 - 5 Working Days	11
7201P-7210P	Poly Strip Everdry 625mm Intermediate Blockwork Cavity Tray	3 - 5 Working Days	11
7211P-7220P	Poly Strip Everdry 1250mm Intermediate Blockwork Cavity Tray	3 - 5 Working Days	11
7231P-7239P	Poly Strip Everdry 450mm Stop End Starter Blockwork Cavity Tray Right & Left Handed	3 - 5 Working Days	11
7241P-8250P	Poly Strip Everdry 550mm Corner Starter Blockwork Cavity Tray Right & Left Handed	3 - 5 Working Days	11
7261P-7265P	Poly Strip Everdry 625mm Ridge Blockwork Cavity Tray	3 - 5 Working Days	11
IL2	Inter-loc Horizontal Cavity Tray New Build 2 Brick 50-125mm Cavity	Next Working Day	20
IL4	Inter-loc Horizontal Cavity Tray New Build 4 Brick 50-125mm Cavity	Next Working Day	20
EXT90	Inter-loc Horizontal 90° External Corner Cavity Tray New Build	Next Working Day	20
INT90	Inter-loc Horizontal 90° Internal Corner Cavity Tray New Build	Next Working Day	20
EXT135	Inter-loc Horizontal 135° External Corner Cavity Tray New Build	3 - 5 Working Days	20
INT135	Inter-loc Horizontal 135° Internal Corner Cavity Tray New Build	3 - 5 Working Days	20
SERH	Inter-loc Horizontal Cavity Tray Right Hand Stop End for New Build and Refurb	Next Working Day	20
SELH	Inter-loc Horizontal Cavity Tray Left Hand Stop End for New Build and Refurb	Next Working Day	20
IL2/E	Inter-loc Horizontal Cavity Tray Refurb 2 Brick 50-125mm Cavity	Next Working Day	20
EXT90/E	Inter-loc Horizontal 90° External Corner Cavity Tray Refurb	Next Working Day	20

Product Code	Description	Lead Time	Page No.
INT90/E	Inter-loc Horizontal 90° Int Corner Cavity Tray Refurb	Next Working Day	20
IL2P	Poly Strip Inter-loc Horizontal Cavity Tray New Build 2 Brick 50-125mm Cavity	Next Working Day	20
IL4P	Poly Strip Inter-loc Horizontal Cavity Tray New Build 4 Brick 50-125mm Cavity	Next Working Day	20
EXT90P	Poly Strip Inter-loc Horizontal 90° External Corner Cavity Tray New Build	Next Working Day	20
INT90P	Poly Strip Inter-loc Horizontal 90° Internal Corner Cavity Tray New Build	Next Working Day	20
2075/460/50	System 2000 Horizontal Unleaded Cavity Tray New Build 460mm 50-74mm Cav	Next Working Day	22
2075/460/75	System 2000 Horizontal Unleaded Cavity Tray New Build 460mm 75-99mm Cav	Next Working Day	22
2075/460/100	System 2000 Horizontal Unleaded Cavity Tray New Build 460mm 100-125mm Cav	Next Working Day	22
2075/460/150	System 2000 Horizontal Unleaded Cavity Tray New Build 460mm 125-150mm Cav	3 -5 Working Days	22
2075/880/50	System 2000 Horizontal Unleaded Cavity Tray New Build 880mm 50-74mm Cav	Next Working Day	22
2075/880/75	System 2000 Horizontal Unleaded Cavity Tray New Build 880mm 75-99mm Cav	Next Working Day	22
2075/880/100	System 2000 Horizontal Unleaded Cavity Tray New Build 880mm 100-125mm Cav	Next Working Day	22
2075/880/150	System 2000 Horizontal Unleaded Cavity Tray New Build 880mm 125-150mm Cav	3 -5 Working Days	22
2010/50	System 2000 Horizontal External 90° Corner Cavity Tray 50-99 Cav	Next Working Day	22
2010/75	System 2000 Horizontal External 90° Corner Cavity Tray 75-99 Cav	Next Working Day	22
2010/100	System 2000 Horizontal External 90° Corner Cavity Tray 100-125 Cav	Next Working Day	22
2010/150	System 2000 Horizontal External 90° Corner Cavity Tray New Build	Next Working Day	22
2011/50	System 2000 Horizontal Internal 90° Corner Cavity Tray 50-74 Cav	Next Working Day	22
2011/75	System 2000 Horizontal Internal 90° Corner Cavity Tray 74-99 Cav	Next Working Day	22
2011/100	System 2000 Horizontal Internal 90° Corner Cavity Tray 100-125 Cav	Next Working Day	22
2011/150	System 2000 Horizontal Internal 90° Corner Cavity Tray 126-150 Cav	Next Working Day	22
2012/50	System 2000 Horizontal External 135° Corner Cavity Tray 50-74 Cav New Build	3 -5 Working Days	22
2012/75	System 2000 Horizontal External 135° Corner Cavity Tray 75-99 Cav New Build	3 -5 Working Days	22
2012/100	System 2000 Horizontal External 135° Corner Cavity Tray 100-125 Cav New Build	3 -5 Working Days	22
2013/50	System 2000 Horizontal Internal 135° Corner Cavity Tray 50-74 Cav New Build	3 -5 Working Days	22
2013/75	System 2000 Horizontal Internal 135° Corner Cavity Tray 75-99 Cav New Build	3 -5 Working Days	22
2013/100	System 2000 Horizontal Internal 135° Corner Cavity Tray 100-125 Cav New Build	3 -5 Working Days	22
2003/50	System 2000 Horizontal Cavity Tray Stop End Right Hand 50mm Cav	Next Working Day	22
2003/75	System 2000 Horizontal Cavity Tray Stop End Right Hand 75mm Cav	Next Working Day	22
2003/100	System 2000 Horizontal Cavity Tray Stop End Right Hand 100mm Cav	Next Working Day	22
2003/150	System 2000 Horizontal Cavity Tray Stop End Right Hand 150mm Cav	Next Working Day	22
2004/50	System 2000 Horizontal Cavity Tray Stop End Left Hand 50mm Cav	Next Working Day	22
2004/75	System 2000 Horizontal Cavity Tray Stop End Left Hand 75mm Cav	Next Working Day	22
2004/100	System 2000 Horizontal Cavity Tray Stop End Left Hand 100mm Cav	Next Working Day	22
2004/150	System 2000 Horizontal Cavity Tray Stop End Left Hand 150mm Cav	Next Working Day	22
2005/50	System 2000 Horizontal Unleaded Cav Tray Refurb 460mm 50-74mm Cav	Next Working Day	24
2005/75	System 2000 Horizontal Unleaded Cavity Tray Refurb 460mm 75-99mm Cav	Next Working Day	24
2005/100	System 2000 Horizontal Unleaded Cavity Tray Refurb 460mm 100-125mm Cav	Next Working Day	24
2006E/50	System 2000 Horizontal Unleaded External 90° Corner Cavity Tray Refurb 50-74 Cav	3 -5 Working Days	24
2006E/75	System 2000 Horizontal Unleaded External 90° Corner Cavity Tray Refurb 75-99 Cav	3 -5 Working Days	24
2006E/100	System 2000 Horizontal Unleaded External 90° Corner Cavity Tray Refurb 100-125 Cav	3 -5 Working Days	24
2007E/50	System 2000 Horizontal Unleaded Internal 90° Corner Cavity Tray Refurb 50-74 Cav	3 -5 Working Days	24
2007E/75	System 2000 Horizontal Unleaded Internal 90° Corner Cavity Tray Refurb 74-99 Cav	3 -5 Working Days	24
2007E/100	System 2000 Horizontal Unleaded Internal 90° Corner Cavity Tray Refurb 100-125 Cav	3 -5 Working Days	24
2075/460P50	System 2000 Horizontal PolyStrip Cavity Tray New Build 460mm 50-74mm Cav	Next Working Day	22
2075/460P75	System 2000 Horizontal PolyStrip Cavity Tray New Build 460mm 75-99mm Cav	Next Working Day	22
2075/460P100	System 2000 Horizontal PolyStrip Cavity Tray New Build 460mm 100-125mm Cav	Next Working Day	22
2075/460P150	System 2000 Horizontal PolyStrip Cavity Tray New Build 460mm 125-150mm Cav	3 -5 Working Days	22
2075/880P50	System 2000 Horizontal PolyStrip Cavity Tray New Build 880mm 50-74mm Cav	Next Working Day	22
2075/880P75	System 2000 Horizontal PolyStrip Cavity Tray New Build 880mm 75-99mm Cav	Next Working Day	22
2075/880P100	System 2000 Horizontal PolyStrip Cavity Tray New Build 880mm 100-125mm Cav	Next Working Day	22
2010P/50	System 2000 Horizontal External 90° Corner Cavity Tray New Build PolyStrip 50-74 Cav	Next Working Day	22
2010P/75	System 2000 Horizontal External 90° Corner Cavity Tray New Build PolyStrip 75-99Cav	Next Working Day	22
2010P/100	System 2000 Horizontal External 90° Corner Cavity Tray New Build PolyStrip 100-25Cav	Next Working Day	22
2011P/50	System 2000 Horizontal Int 90° Corner Cavity Tray New Build Poly Strip 50-74Cav	Next Working Day	22
2011P/75	System 2000 Horizontal Int 90° Corner Cavity Tray New Build Poly Strip 75-99Cav	Next Working Day	22
2011P/100	System 2000 Horizontal Int 90° Corner Cavity Tray New Build PolyStrip 100-25Cav	Next Working Day	22
2012P/50	System 2000 Horizontal External 135° Corner Cavity Tray New Build PolyStrip 75-99Cv	3 -5 Working Days	22
2012P/75	System 2000 Horizontal External 135° CornCavity Tray New Build PolyStrip 100-125	3 -5 Working Days	22
2012P/100	System 2000 Horizontal External 135° Corner Cavity Tray New Build PolyStrip 50-74Cv	3 -5 Working Days	22
2013P/50	Poly Strip System 2000 Horizontal Internal 135° Corner Cavity Tray New Build 50-74 Cav	3 -5 Working Days	22
2013P/75	Poly Strip System 2000 Horizontal Internal 135° Corner Cavity Tray New Build 75-99 Cav	3 -5 Working Days	22
2013P/100	Poly Strip System 2000 Horizontal Internal 135° Corner Cavity Tray New Build 100-125 Cav	3 -5 Working Days	22
LS01	Lintel Stop End Splay Angle 90° Black	Next Working Day	31

timloc building products PRODUCT & CATEGORY GUIDES

Did you know we have the following guides available for the Timloc range of products:



**Construction
Accessories**



**Cavity
Closers**

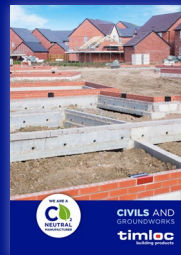

**Civils &
Groundworks**

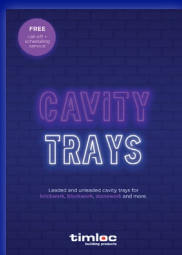

Cavity Trays



Meter Boxes



Roofline

Sustainability and **Product Guides** also available:



Scan the **QR code** to view the digital product guide, category guides and datasheets. For print copies please email sales@timloc.co.uk



LOW CARRIAGE PAID ORDER VALUES



**£100
TO BRANCH**
**£150
TO SITE**

CAVITY TRAYS

timloc
building products



Sales | Phone: **01405 765 567** Email: sales@timloc.co.uk Web: www.timloc.co.uk

Technical | Phone: **01405 782 769** Email: technical@timloc.co.uk Web: www.timloc.co.uk

Timloc Building Products | Timloc House, Ozone Park, Howden, East Yorkshire DN14 7SD
Cavity Trays - Edition 1