

We're Here To Help

To find out more about our Commercial range of products please visit our website at www.richardburbidge.com or to be put in contact with an area sales manager please call +44 (0) 1691 678268.

DECKPLANNER™

This is the unique and easy way to plan your balustrade requirements for external areas such as decks and balconies. DECKPLANNER™ calculates all the parts you require by asking a series of questions such as strength category, range and spindle or panel design you wish to use.
Web - www.richardburbidge.com

Bespoke Planning Service

Our Technical Team offer a bespoke planning service to help at all stages of your project, from the parts you need, where to purchase, to how to install and finish.
Available from 8.30 - 17.30 weekdays.
Tel - +44 (0) 1691 678212
Fax - +44 (0) 1691 672863
E-mail - technical@richardburbidge.co.uk

CAD Drawings

Richard Burbidge balustrade components and configurations are available, suitable for architects and specifiers. CAD drawings can be downloaded online or from the CD available on request from customer services.
Tel - +44 (0) 1691 678300
Fax - +44 (0) 1691 657694
E-mail - info@richardburbidge.co.uk
Web - www.richardburbidge.com



Whittington Road
Oswestry
Shropshire SY11 1HZ
t +44 (0) 1691 655131
f +44 (0) 1691 657694

5 Fitzwilliam Place
Dublin 2, Eire
t +353 (0)1 6622788
f +353 (0)1 6760438

e info@richardburbidge.co.uk
w www.richardburbidge.com

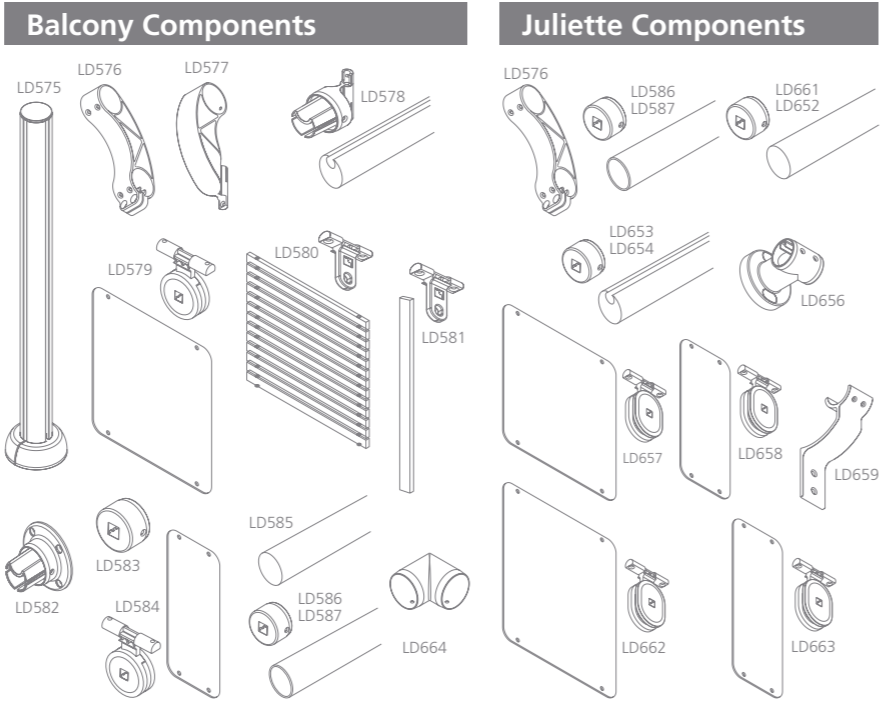

Code	Description	Size (mm)
Balcony Components		
LD575	Newel Post	1000 x Ø80
LD576	Rail to Rail Bracket	N/A
LD577	Newel to Timber Rail Support Bracket	N/A
LD578	Rail & 2 x Rail to Newel Brackets	900 x Ø46
LD579	Glass Panel†	800 x 750 x 6
LD580	Slatted Panel†	800 x 750 x 21
LD581	6 x Balusters (pack)†	46 x 750 x 21
LD582	Aluminium Rail to Wall Brackets	N/A
LD583	2 x End Caps (pack)	N/A
LD584	Small Glass Panel†	350 x 750 x 6
LD585	2.2m Hardwood Handrail	2200 x Ø45
LD586	1.2m Metal Handrail†	1200 x Ø46
LD587	2.4m Metal Handrail†	2400 x Ø46
LD664	Metal Rail Half Turn Bracket	N/A
Juliette Components		
LD576	Rail to Rail Bracket	N/A
LD586	1.2m Metal Handrail†	1200 x Ø46
LD587	2.4m Metal Handrail†	2400 x Ø46
LD661	1.2m Hardwood Handrail†	1200 x Ø45
LD652	2.4m Hardwood Handrail†	2400 x Ø45
LD653	1.2m Aluminium Rail†	1200 x Ø45
LD654	2.4m Aluminium Rail†	2400 x Ø45
LD656	4 x Return to Wall Bracket (pack)	N/A
LD657	Glass Panel†	800 x 850 x 8
LD658	Small Glass Panel†	350 x 850 x 8
LD659	Base Support	N/A
LD662	Oversize Glass Panel†	800 x 970 x 8
LD663	Oversize Small Glass Panel†	350 x 970 x 8

† All panels are supplied with 4 x fixing brackets, Baluster packs are supplied with 2 x fixing brackets per baluster
‡ Supplied with 2 x end caps

Key features of the FUSION® Commercial Outdoor System

- Tested by FIRA to British Standards to withstand loadings of 1.5kN/m (balcony), 0.74kN/m (Juliette)
- Compliant with UK Building Regulations
- Approved for use on commercial or domestic balconies and raised or ground level decks
- Available with glass panels, hardwood timber balusters or hardwood slatted panels
- Glass panels available in various sizes for greater flexibility
- Toughened glass, manufactured to EN12150-2
- Bracket fixings and newel post support bar provide structural strength (balcony range)
- Newel posts suitable for use on concrete surfaces or timber boards
- All brackets powder coated with Fusion Powder Coatings Silver 03
- Straight forward to install, delivering labour, time and cost savings
- Available ex-stock

CY001

nssPlus



FUSION® Commercial Outdoor Balustrade Range



Including our new Juliette Balustrade Range

“ We were drawn to the FUSION® Commercial range because of its instant aesthetic appeal and the glass system really stood out, as the panels enable holiday home owners to take full advantage of the spectacular views. We have sold all three plots, as the finished look is so impressive and the real added bonus was the ease of installation. Michael Holgate, Managing Director Holgates Holiday Park ”

Juliette Option

Ideal for apartments and townhouses, the new Juliette system offers modern styling plus flexibility of design and installation, without bespoke costs and lead times.



Based on FUSION®'s popular combination of metal, timber and glass, the new Juliette system features different sized glass panels and a range of handrail options.

For an alternative look, the system can be installed with a metal handrail in place of the timber one or without any additional handrail, thus utilising the extra glass panel option.

The easy-to-fit system is assembled into one piece that can then be offered up to the wall and secured using specially designed fixing brackets, helping to save time on site.

The Juliette system has been tested by FIRA to resist loadings of 0.74kN/m in line with Building Regulations.



Balcony Range

Available in:
Timber Panel:



Timber Baluster:



Glass Panel:



The Richard Burbidge range of commercial outdoor balustrade offers flexible and innovative systems that are suitable for heavy and light commercial situations, and elevated domestic decks and balconies.

FUSION® Commercial takes a strong minimalist metal frame and incorporates a range of timber or glass panels and baluster options, perfect for high-level balconies, restaurants or bars.

Tested to British standards for strength and quality, this balustrade system is designed to be used in areas where people may congregate, and areas with tables or fixed seating, but which are not susceptible to overcrowding. This makes it a perfect solution not only for bars, restaurants and outdoor dining areas, but also for high level decks and balconies in the home environment.

For further information on the range, our technical support and other services we offer please use the contact details provided on the back of this literature.



The combination of timber, aluminium and glass creates a stunning outdoor feature that can be used with most hard landscaping surfaces including timber decking, composite decking and concrete.