

COOKER HOOD CPD

TECHNICAL CATALOGUE

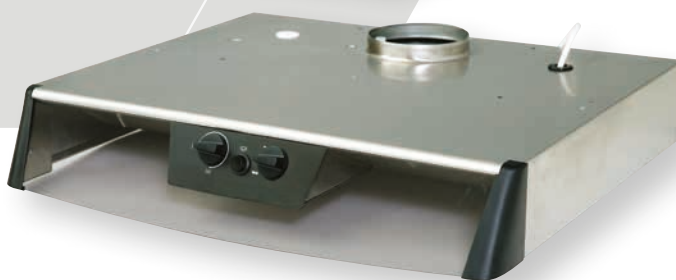

COOKER HOOD CPD



The CPD is our standard cooker hood. It is available with a white, black or stainless steel finish and has easily accessible controls located in the middle of the front.

The hood is available in a number of variants, for instance for apartment buildings with a central air extraction system, for our heat recovery units and extract air fans or for replacing older cooker hoods.

CPD CAN BE USED WITH THE FOLLOWING UNITS/EXHAUST AIR FANS

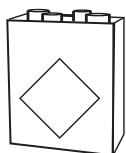

RDKG

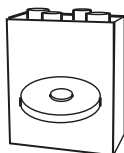

RDKR/RDKS

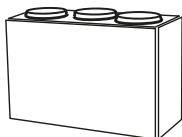

JBDH

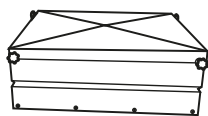

JBFG

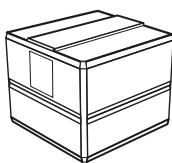

*STEF and other
central extract air
fans and units*

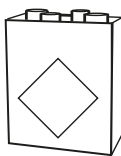

*Other older
units and
extract air fans*

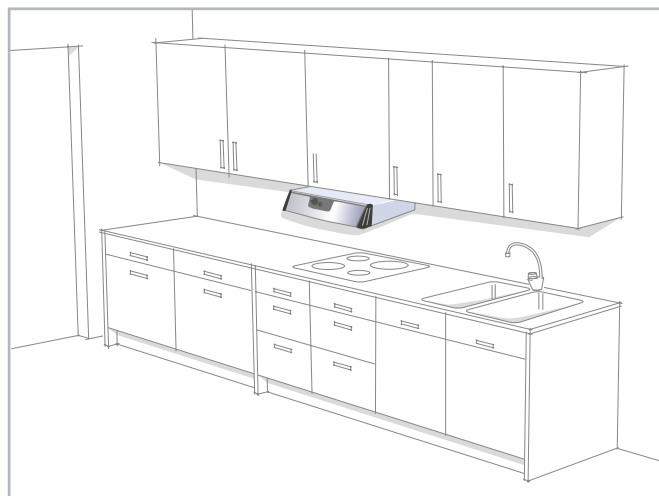

PRODUCT DATA

- High odour extraction capacity
- Controls easily accessible on the cooker hood front panel
- Lighting with low-energy bulb
- Effective grease filter
- Available in several widths as standard
- Low height providing plenty of work space under the hood

PRODUCT CODE EXAMPLE

CPDA-2-03-6-3-1

DESCRIPTION, MATERIALS, HANDLING, MODELS

DESCRIPTION

The cooker hood is suitable for installation either under or between high level top cabinets. There are pre-drilled holes for mounting under the cabinets. Brackets for mounting between the cabinets are available as accessories.

When the hood is used together with a heat recovery unit it is installed directly under the unit.

The lighting consists of an 11 W low energy light bulb (E14 holder) which can be replaced without tools.

MATERIALS

The cooker hood is available in white or stainless steel. The front panel and the lamp glass are made of polycarbonate.

The handles and corners are made of black ABS plastic. The grease filter is made of woven aluminum surrounded by rib mesh and an aluminum frame.

OPERATION

There is a damper for forced air flow (boosting). It is opened through a handle on the front and has a manually or timercontrolled return (60 min).

Some cooker hoods also have a basic air flow, both basic and forced air flow are adjustable. When cleaning the kitchen flue the throttling device can be removed without tools.

Cooker hoods controlling a heat recovery unit or an exhaust air fan also have a handle for fan speed. The cooker hood CPDJ for RDKR/RDKS has an automatic function that control the fan speed when the throttling device is opened.

The lighting of the cooker hood is lit by a separate switch, see illustrations below.

CPDA, CPDJ, CPDR

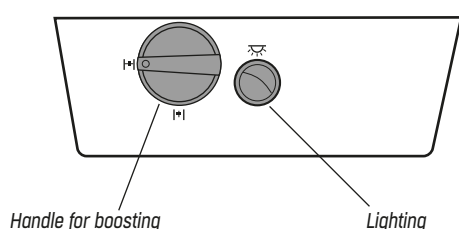

OTHER CPD-HOODS

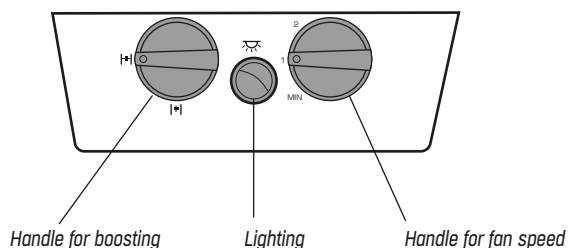

DELIVERY

The cooker hood is delivered in cardboard and expanded polystyrene packaging. Assembly, operating and maintenance instructions are included.

MODELS

CPDA

For apartment buildings with a central air extraction fan or heat recovery unit. (Can be used with new products or for replacing older cooker hoods.)

CPDB

Replacement hood for extract air fan JBDD generation 1 (manufactured before 2007, with capacitor box), with code JBDD-01 or JBDD-02.

NOTE! Only two digits in the code signifies generation 1.

CPDC

Replacement hood for older heat recovery unit RDKG generation 1, without by-pass, with code RDKG-a-1-c-d-1.

NOTE! b = 1 indicates that the unit is without by-pass; the last digit indicates generation 1.

CPDD

Replacement hood for older heat recovery unit ACF and older BAF extract air fan.

CPDG

Cooker hood with transformer for extract air fan JBFG and JBDD generation 2, with code JBDD-00-1-2 or JBDD-01-1-2. **NOTE! Four digits in the code and a 2 as the last digit signifies generation 2.**

Also suitable as a replacement hood for controlling certain older extract air fans and units, including JBDB, JBDC and RDAA.

NOTE! In this case, installation must be carried out by a qualified electrician (the quick connector cannot be used).

CPDH

Replacement hood for older heat recovery unit RDKG generation 1, with by-pass, with code RDKG-a-2-c-d-1.

NOTE! b = 2 indicates that the unit is with by-pass; the last digit indicates generation 1.

CPDJ

For heat recovery units RDKR and RDKS.

CPDK

For heat recovery unit RDKG generation 2, with by-pass, with code RDKG-a-b-c-d-2. **NOTE! The last digit indicates generation 2.**

CPDL

Replacement hood for older heat recovery unit types RDKB and RDKE.

CPDR

Compatible with ILOX and RDAS heat recovery units with a 5th mounting ring, or for apartment buildings with a central air extraction system.

NOTE! Certain installations must be carried out by a qualified electrician.

AIR FLOW, PRESSURE DROP, SOUND DATA, ODOUR EXTRACTION, DIMENSIONS AND WEIGHT

AIR FLOW, PRESSURE DROP, SOUND DATA, ODOUR EXTRACTION

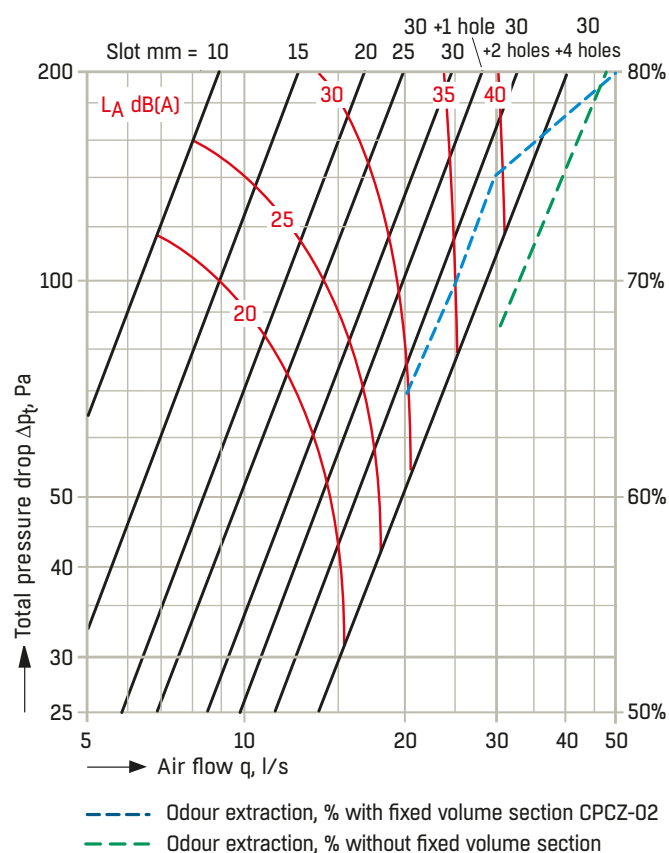

Basic ventilation and odour extraction. The throttling device is factory set to sprint mode 7 and air gap 15 mm.

In the above diagram the following applies:

Pressure drop: Applies to air with a density of 1.2 kg/m³.

Self generated noise for hoods with throttling devices when installed according to the figure below.

The indicated sound level L_A at a room damping of 4 dB, which corresponds to a damping of the reverberant field in a room with a sound absorption area equivalent to 10 m².

Sound value tolerance ± 2 dB(A).

The cooker hood has been tested for odour extraction by Swedish National Testing and Research Institute in accordance with test standard SS-EN 61:591.

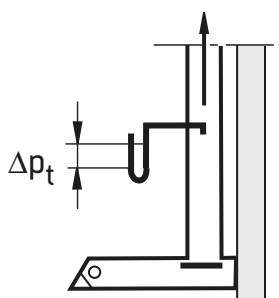

DIMENSIONS AND WEIGHT

All dimensions in mm.

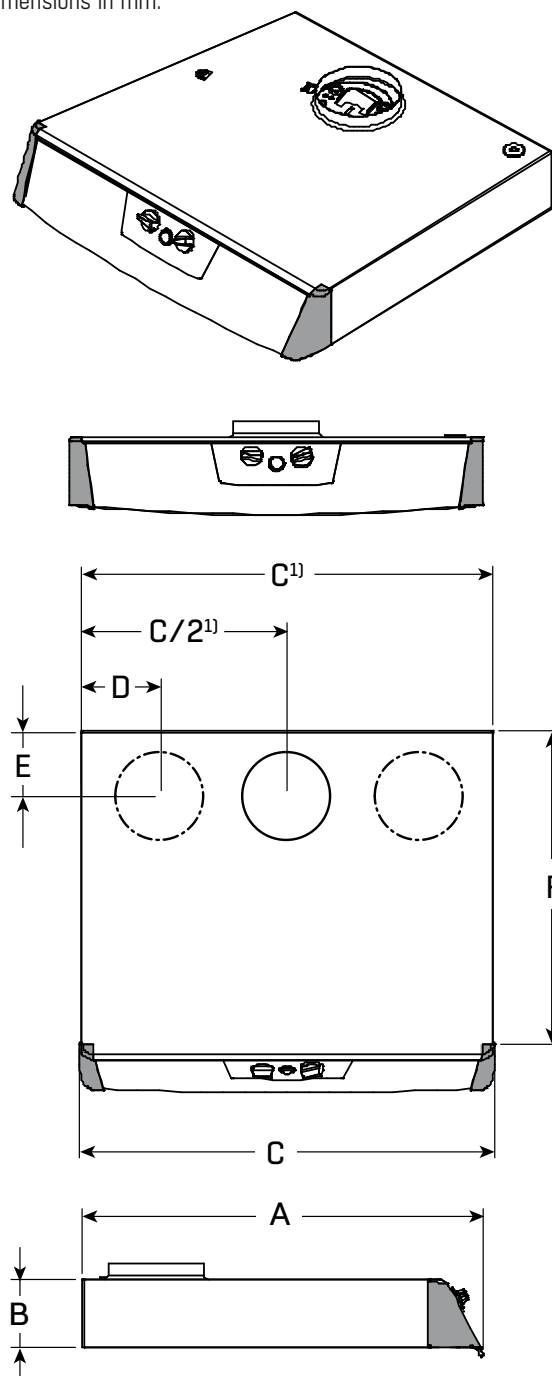

Width	A	B	C	C ¹⁾	D ¹⁾	E ¹⁾	F	Weight, kg
500	524	100	502	498	114	96	453	4,4
600	524	100	602	598	114	96	453	5,0
700	524	100	702	698	214	96	453	5,9

1) When connecting to the right-hand side, the D measurement from the right of the hood applies. For the models (CPD) C, D, H, J, K and L these dimensions are adapted to each unit.

ACCESSORIES, PRODUCT CODES

ACCESSORIES

CONNECTION KIT CPAZ-25

For flexible connection between cooker hood and kitchen flue. The tube is type-approved. Two tube clamps are included.

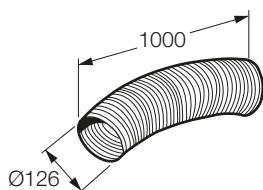

BRACKET SET CPAZ-27

Mounting of cooker hood CPDA, CPDK, CPDJ and CPDG between cabinets.

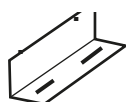

FIXED VOLUME SECTION

WHITE CPDZ-02, TRANSPARENT PLASTIC CPDZ-07

This accessory consists of two side pieces mounted on the hood to increase its volume.

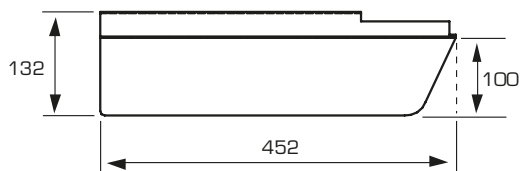

PRODUKT CODE

Cooker hood

CPDa-b-cc-d-e-f

Model (a)

A
B
C
D
G
H
J
K
L
R

Lighting (b)

2 = LED 8 W (E14)

Throttling device (cc)

03 = Forcing with timer return

Width (c)

5 = 500 mm (only models A, B and G)

6 = 600 mm

7 = 700 mm (not for model L or R)

Connection (d)

For model A, B, D, G, L and R

1 = Left-hand side

2 = Right-hand side (Not model D, L and R)

3 = Middle (Not model B, D, L and R)

For model C, H, J and K the unit's full product code is always needed for the correct connection;

1 = 1 = unit where the first digit = 1

(For example RDKS-1 -....., RDKG-1 -.....)

2 = The unit where the first digit = 2

(For example RDKS-2 -....., RDKG-2 -.....)

Material (f)

1 = White

2 = Stainless steel

ACCESSORIES

Connection kit

CPAZ-25-000

Bracket set

CPAZ-27-000

Fixed volume section, white

CPDZ-02-000

Fixed volume section, transparent plastic

CPDZ-07-000

EXCELLENCE IN SOLUTIONS

FläktGroup is the European market leader for smart and energy efficient Indoor Air and Critical Air solutions to support every application area. We offer our customers innovative technologies, high quality and outstanding performance supported by more than a century of accumulated industry experience. The widest product range in the market, and strong market presence in 65 countries worldwide, guarantee that we are always by your side, ready to deliver Excellence in Solutions.

PRODUCT FUNCTIONS BY FLÄKTGROUP

Air Treatment | Air Movement | Air Diffusion | Air Distribution | Air Filtration
Air Management & ATD's | Air Conditioning & Heating | Controls | Service

» Learn more on www.flaktgroup.com
or contact one of our offices