

PermaQuik

Standard Protection Sheet XL

Product Data Sheet

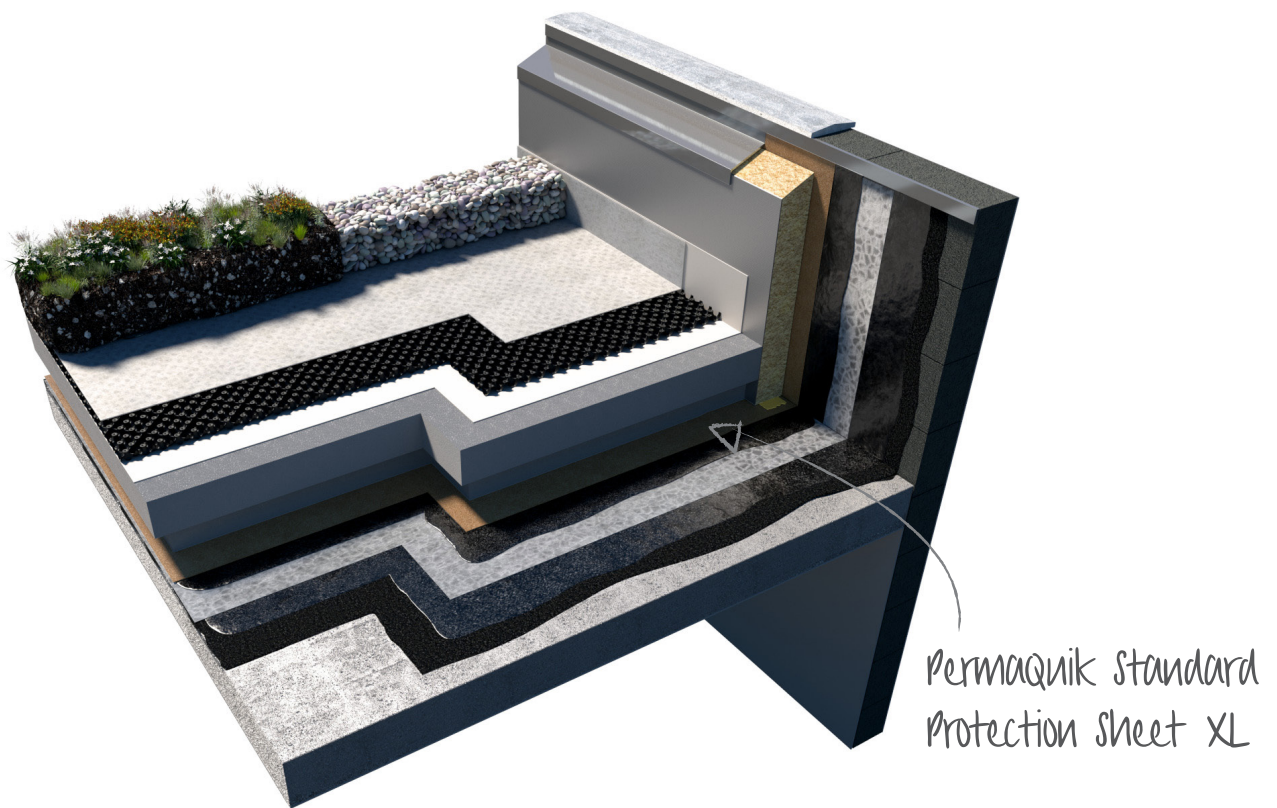

PermaQuik

Standard Protection Sheet XL

General Information

Standard Protection Sheet XL is a high performance polyester based modified bitumen membrane. Standard Protection Sheet is used as secondary layer or a top surface over PermaQuik PQ6100. For a comprehensive NBS J31 specification contact Radmat Building Products.

Certificates

BBA Certification No. 97/3336

Installation Instructions

Standard Protection Sheet XL is laid into the upper surface of the PermaQuik PQ6100 whilst the PermaQuik PQ6100 is still hot.

Standard Protection Sheet XL is cut and formed using sharp hand tools.

Do not expose the Sheet to hydrocarbon based solvent products.

Installation to be according to guidelines and specifications supplied by Radmat Building Products Ltd.

Side overlaps	End Overlaps
80mm	100mm

Delivery Conditions

Delivery form

30 rolls Standard Protection Sheet XL in vertical position, shrink-wrapped on a one-way pallet (100 X 120cm).

Storage and transport

Standard Protection Sheet XL must be transported stood on end on a dry and flat level surface.

Rolls should be stored upright on a dry surface. Do not drag rolls across rough surfaces, always lift.

During colder periods it is recommended that rolls are store in a temperature above 10°C for 24 hours prior to use. During storage exposure to direct sunlight is to be avoided. Do not use in temperatures below 5°C.'

Product identification

Information on the roll; Product name. Dimensions. Approvals. Production date.



Application Method

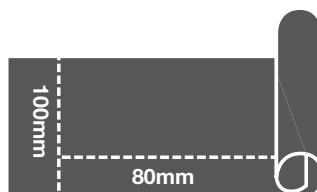

Overlaps



PermaQuik

Standard Protection Sheet XL

PRODUCT DESCRIPTION

Appearance top side	Silica Sand
Coating top side	Modified bitumen
Reinforcement	Polyester mat
Coating bottom side	Modified bitumen
Appearance bottom side	Sand

DECLARED PERFORMANCE

Essential characteristics	Performance	Units	Tolerance	Test Method
Roll length	16	m	±150mm	BS EN 1848-1
Roll width	1	m	±1.5%	BS EN 1848-1
Roll weight	32	kg	±7.5%	BS EN 1849-1
Mass per unit area	2	kg m ²	±0.2	BS EN 1849-1
Visible defects	PASS	-	-	BS EN 1850-1
Watertightness	PASS	-	-	BS EN 1928 (A)
Straightness	PASS	-	-	BS EN 1848-1
Tensile strength	450 (LD); 315 (TD)	N/50mm	-	BS EN 12311-1
Elongation at maximum load	24 (LD); 40 (TD)	%	-	BS EN 12311-1
Resistance to tearing	125 (LD); 140 (TD)	N	-	BS EN 12310-1
Reaction to fire	CLASS F	-	-	BS EN 13501-1
Cold Bend Flexibility	≤ -5	°C	-	BS EN 1109
Flow resistance at elev. temp	>90	°C	-	BS EN 1110

NPD = No Performance Declared. LD = Longitudinal. TD = Transverse Direction.

STANDARD PRODUCT LENGTH & WEIGHT

Protection sheet	16m	32kg	30 Rolls Per Pallet
------------------	-----	------	---------------------

*Other lengths available upon request, dependent upon volume

Compatibility

The Stand Protection Sheet XL may be cut and formed using techniques described in BS8217: 2004. There are no harmful side effects associated with this material. Hydrocarbon solvent based products, such as naphtha, paraffin and creosote will have a harmful effect and should not be allowed to come into contact with the material.

Contact Radmat Building Products for compatibility of other products.

This information given in good faith and is based on the latest knowledge available to Radmat Building products Ltd. Whilst every effort has been made to ensure that the contents of the publication are current while going to press, customers are advised that products, techniques and codes of practice are under constant review and liable to change without notice.

For further information on Radmat products and services please call **01858 410372**, email tech enquiries@radmat.com or visit our website www.radmat.com

NOV 22



Radmat Building Products Ltd Holland House, Valley Way, Rockingham Road, Market Harborough, Leicestershire, LE16 7PS **T** : 01858 410 372 **E** : tech enquiries@radmat.com