

DREAM
EXTENSIONS

made simple

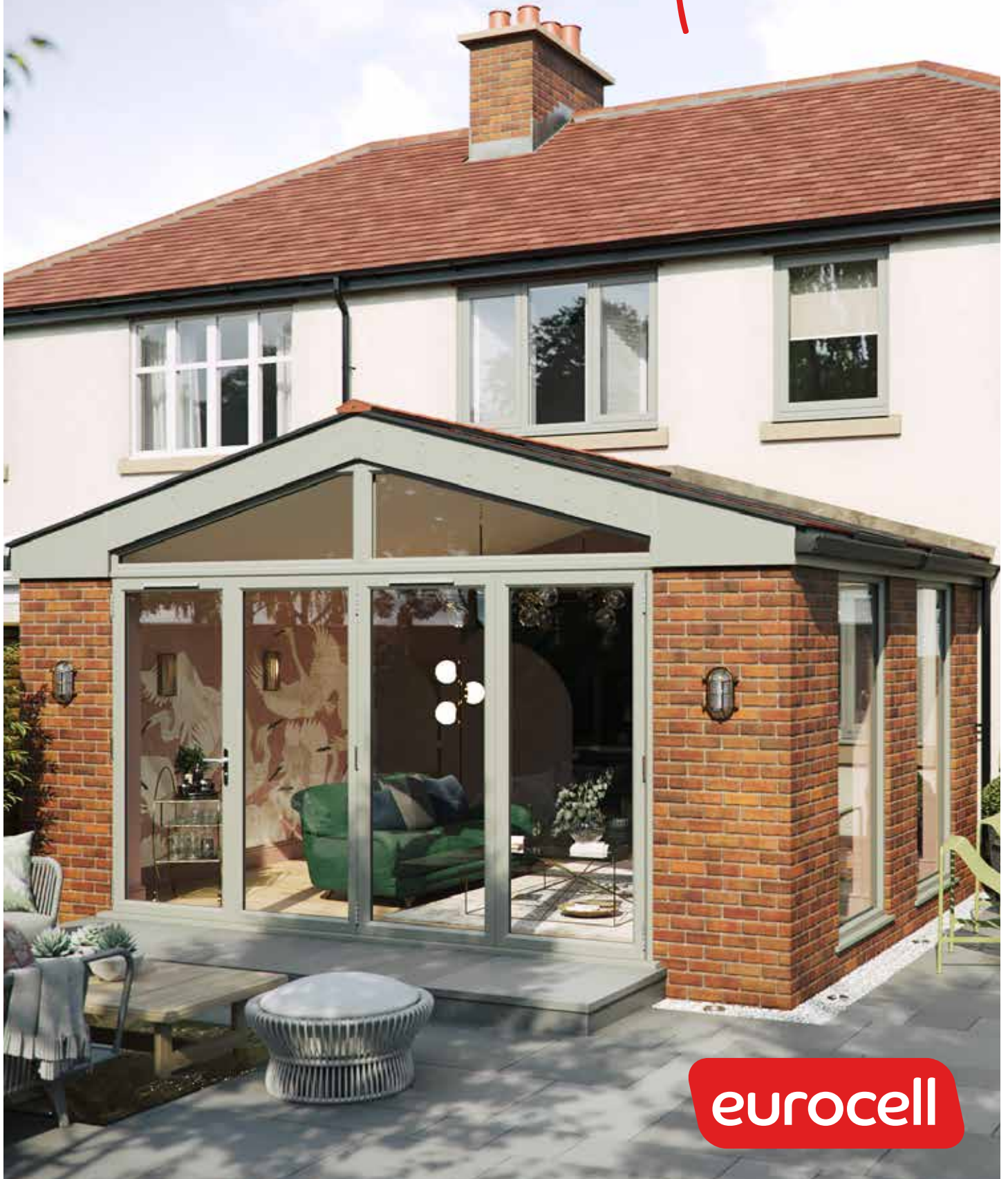

eurocell

The hassle-free way to

build your dream extension

Enhance your home and life with an extension

Imagine having more space in your home. A whole new room that's just for you. Where you can relax, unwind, and bask in glorious natural light flooding through stylish floor-to-ceiling windows. Bringing the outdoors in to fill your energy cup. Imagine that space has been designed specifically for you... to suit your lifestyle and the style of your property. And then, imagine enjoying that room in just a few weeks.

Extending your home has never been easier. Our EurXtension system is a revolutionary new way to add an extra room to your home. Using modern construction methods, they're designed and built to your specific needs and you can be enjoying your extra living space in weeks, not months. Our fully managed service means we deal with everything.

CONTENTS

DISCOVER...

EURXTENSIONS 6

THE SMART CHOICE 6

GUARANTEED FOR PEACE OF MIND 7

THE EUROCELL DIFFERENCE 8

CONSERVATORY REPLACEMENTS 10

NEW EXTENSIONS 12

EURXTENSIONS EXPLAINED

BUILDING MADE EASY 14

BUILDING FROM THE BASE UP 14

EURXTENSIONS MADE EASY 16

DESIGN CHOICES

ROOF TYPE & STYLE 18

WINDOWS & DOORS 20

EXTERIOR FINISH 24

INTERIORS 26

CUSTOMER HOMES

ALEX & LISA'S EURXTENSION 28

LET'S TALK ABOUT

FINANCE OPTIONS 33

SUSTAINABILITY 34

FREQUENTLY ASKED QUESTIONS 36

DISCOVER...

Introducing EurXtensions

our new extension system

built in weeks not months

Would you love to extend your home but are put off by the lengthy and often complex process? Planning rules, architect drawings, finding a reliable builder and building regulations sign off. And then there are months of disruption and mess before you can finally enjoy your new space. Not to mention spiralling costs!

EurXtensions eliminates all that hassle and stress.

EurXtensions is a new and revolutionary way to build

The EurXtension system uses prefabricated structural insulated panels, or SIPs for short. Although SIPs date back to the 1950s, they've only become more popular recently. Technical innovations mean they now outperform traditional buildings for strength, sustainability, thermal performance and energy efficiency.

With EurXtensions, building work isn't impacted by the availability of trades or weather conditions. And, as they're manufactured offsite, the build process is significantly quicker than conventional brick and block methods.

What's more, they don't require traditional extension foundations, which often means minimal mess and disruption for you. If you're replacing a conservatory we build onto your existing concrete base. Or we'll create a new base for you.

A EurXtension will not only increase your living space and enhance your lifestyle, but it will add value to your home too.



Quick Installation

Up to three times faster to build than traditional methods



Building Regulations Approved

Our extension roof system is pre-approved by JHAI*



Added Home Value

Add space and increase the value of your home



Energy Efficient

Five times more energy efficient than the average UK home



Fully Managed Service

So you don't have to worry about a thing



Finance Available

Guaranteed Price made affordable

Let us
inspire you

Browse this brochure to learn more about the benefits of the EurXtension system. And to see our style and design options and be inspired. But don't forget, when you're ready, we'll be on hand to take you through the process every step of the way.



*JHAI are a national approved inspector licensed to carry out building regulations approvals.



DISCOVER...

EurXtensions *The smart choice*

Using modern methods of construction, our home extensions combine stunning good looks with the latest technological advancements. Providing you with all the benefits of a brick-built extension without the disruption and hassle.

Up to three times faster to build than traditional methods

Why wait months for your extension when we can do it in a few weeks? EurXtensions are manufactured off-site and delivered in sections, ready for our build team to assemble. There's minimal disruption on-site. And we can even work in wet weather. So, you can rest assured any delays will be minimal, and you'll be enjoying your new space in no time.

Stronger than timber frame and brick-built extensions

EurXtension wall panels are made from high-performance SIP panels that don't degrade or deteriorate over time. The result is a building that's seven times stronger than timber frame and three times stronger than brick and block buildings.

Five times more energy efficient than the average UK home

EurXtensions have excellent thermal efficiency throughout every component of the building. With low U-values* on both the wall panels and roof and A-rated double or triple glazed windows and doors. SIPs are also airtight, with reduced cold bridging. This means your extension will be lovely and warm, and you'll also save money on energy bills.

Guaranteed Price made affordable

Once we've surveyed your home and provided a design and quote, we guarantee that is the price you will pay, so you can rest assured there will be no spiralling costs. What's more we can help you to finance your build see pages 32-33 for our finance packages.

Ultimate design flexibility and more internal space than traditional builds

EurXtensions are tailor-made to your specific requirements. Choose your shape, the position and style of the windows and doors, the incline angle of your roof, and even your exterior finish. And, because our wall panels are much thinner than brick and block walls, you get a bigger room inside to enjoy, whilst still providing higher thermal performance so you get a warmer room too.

Fully managed service from one small team of experts

A EurXtension cuts out the headache and time taken to deal with different trades for different parts of the build. We manage the whole project for you, from design to completion. You'll have one point of contact who will deal with your project and any queries you may have throughout the installation.

Guaranteed for *your peace of mind*

10
YEAR

Building

5
YEAR

Glazing

3
YEAR

Hardware

*A U-value is the overall rate of heat transfer throughout the fabric of a building, in other words how much heat is lost through roofs, walls, windows and doors.

THE EUROCELL DIFFERENCE

Here at Eurocell, we believe making improvements to your home should be easy. And you shouldn't have to break the bank to do them either. That's why we've worked tirelessly for years to produce premium-quality products that offer excellent value for money.

Our EurXtension system has been carefully designed to give you choice and flexibility. It's been built to

the latest standards, using the best technology and comes with a 10-year guarantee. We use up to 29% end-of-life recycled PVC-U in our products. And our extension wall panels are made from material that doesn't degrade or deteriorate over time.

In addition, we're on hand with help and advice whenever you need it.

EurXtensions

in five easy steps

We've made extending your home easy with EurXtensions. Follow these simple steps to get started straight away!



BOOK A HOME CONSULTATION



Call us on **0333 015 3560**, email **extensions@eurocell.co.uk** or visit **eurocell.co.uk/extensions** and discuss your requirements



WE'LL CARRY OUT A FREE SITE SURVEY



Our technical advisor will visit your home at a time to suit you to carry out a free survey and give you advice and inspiration.

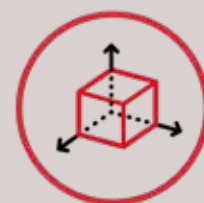

WE'LL DESIGN & QUOTE FOR YOUR EURXTENSION



We'll design your extension and provide a no-obligation quote. Your installer will guide you through creating your own unique space, draw detailed specifications and provide you with a quote.



WE'LL PRE-FABRICATE YOUR BESPOKE EURXTENSION



We'll manufacture your bespoke extension. To minimise mess and disruption to you, pre-fabricate your extension offsite, which is delivered in sections so it's ready to be installed.



WE'LL BUILD YOUR EURXTENSION



Our team of installers will expertly assemble your extension and complete the interior finish. They'll treat your home with respect and minimise disruption and mess.

We'll design your extension and provide you with 3D visuals of exactly how it will look against your existing home

Then, sit back, relax and enjoy your new space.

Call us on **0333 015 3560**, email **extensions@eurocell.co.uk** or visit **eurocell.co.uk/extensions** and get started today!

CONSERVATORY REPLACEMENTS

Convert your conservatory into a modern energy-efficient building

If your conservatory has seen better days, is too hot in summer and cold and draughty in winter, then EurXtensions is the solution for you.

We'll replace your old conservatory with a brand-new extension that's highly energy-efficient and incredibly strong. It will have new insulated wall panels, A-rated windows and doors, a warm, tiled roof and a finished interior, ready for you to decorate. So, not only is a EurXtension as good as a brick-built extension, but it's better than a brick-built extension! What's more, we'll

even recycle your old window frames and conservatory roof, creating new window frames and ensuring minimum waste.

In most cases EurXtensions can be built onto your existing concrete base, which cuts out an often tricky, time-consuming and weather-dependent part of the job. And everything is pre-fabricated offsite, brought to your home in sections, and quickly installed. This means your old conservatory is transformed into a warm, welcoming, usable space within weeks.



NEW EXTENSIONS

A new room built up to three times faster than traditional methods

Are you dreaming of a spacious new dining room for entertaining? Or an organised playroom to get the kids' toys out from under your feet? Or perhaps you want a bright home office where you can focus on your work? Then, EurXtension is your dream come true!

A EurXtension is the easiest and fastest way to extend your home. Planning permission isn't usually required, and you don't need an architect. Because we'll design

your extension to your exact specifications, ensuring it complements the style of your home.

Then everything is pre-fabricated offsite, brought to your home in sections, and quickly installed. This means your new room will be ready to enjoy within weeks.



or create a new extension



replace your conservatory



EURXTENSIONS EXPLAINED

With EurXtensions

building is easy

**Forget about dealing with different trades.
We do it all, from design to completion.**

Planning an extension is exciting but daunting too. It can be difficult to know where to start. And dealing with architects, builders, potential planning permission, local authorities and building regulations can quickly become overwhelming.

But with EurXtensions, you don't have to worry about any of that. Because we take care of it all for you.



You simply meet with our technical advisor to design your dream space. Then agree a price, place your order and see your extension transform your home within weeks.

**It couldn't be easier. There's minimum fuss,
no spiralling costs and a quick build.**

one

The base

EurXtension SIP panels are lighter than traditional building materials so they usually don't require traditional trench extension foundations, which cuts out a very costly and lengthy part of the building process. Instead, they're built directly onto a concrete base. We'll use your existing base if you're upgrading an old conservatory. Or, for new extensions, we'll create a new base for you.

two

The walls

Our SIP wall panels are fitted with a concrete board and in your choice of finish. So, we can create an extension that blends seamlessly with your home using matching brick-slips. Or choose from our range of cladding options if you want to make a statement.



three
The Roof

EurXtensions have a fully insulated solid tiled roof system to keep your room warm in winter and cool in summer. There's a choice of tile type and colour, plus fascia boards and guttering. And why not add some roof lights too? They let in three times more light than windows, so your space will feel beautifully bright and airy.

four

The windows and doors

Choose from our vast range of window and door styles and colours. Large expanses of floor-to-ceiling doors look incredible and allow natural light to flood the space, even on dark days. Or choose smaller windows and more wall space to accommodate furniture instead.

five

The interior

Your interior will be expertly finished off inside with everything you'd expect. Plastered walls and ceiling, electrics and lighting – ready for you to decorate in your own style.

Building

from the base up

EURXTENSIONS MADE EASY

Your new space *made easy*

Our extensions are designed to be versatile. That means you can create a bespoke design that suits your home.

The following few pages take you through all the options available, so you can start to plan your dream space. Our technical advisers will visit your home to guide you through your journey when you're ready. Giving expert advice and inspiration as you go.

How to design your bespoke EurXtension

Step *one* Decide on your footprint



Choose the size, shape and footprint of your proposed new space. We can use your current floor plan if you're replacing your existing conservatory or create a new design that suits your needs.

Step *two* Add windows and doors



Decide where you would want your daylight openings. Choose your windows and doors for the access you need and where you need walls to place furniture.

Step *three* Add your roof and rooflights



Choose the style of your roof to suit your existing home. Decide whether you want to add glazing, opening roof windows or rooflights.

Step *four* Choose your exterior finish



Choose your exterior finishes which are applied to our energy efficient SIPs panels. Complement and match your existing home or make a contrasting style statement.

How we use your existing base and check its suitability

If you're replacing your existing conservatory it's likely you already have a concrete base. We'll check the existing bases suitability and that it complies with building regulations. If it doesn't we'll remove and create a suitable base for you.



Step *five* The finishing touches

Decide where you'll need electric points and lighting. Choose your finishing options internally, such as optional skirting, ready for you to decorate.

To arrange a home consultation at a time to suit you
Call us on **0333 015 3560**, email **extensions@eurocell.co.uk**
or visit **eurocell.co.uk/extensions** and get started today!

DESIGN CHOICES ROOF TYPE & STYLE

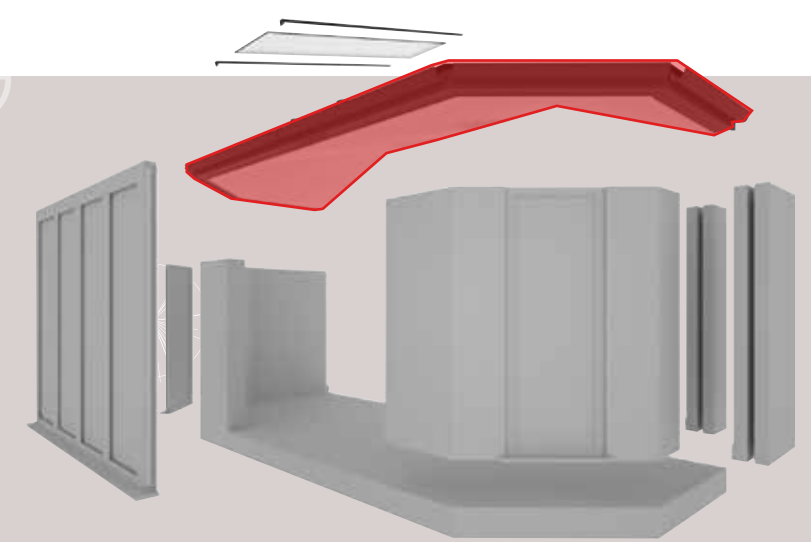
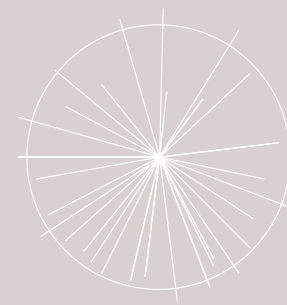

Choose an ultra-efficient roof to suit your needs and finish it with the tile style and colour to suit your home

The innovative multi-layered roof design can transform your space and your lifestyle. Enjoy your extension whatever the weather! Come rain or shine, you will experience comfortable temperatures all year round with a EurXtension roof.

The fully insulated roof design achieves U-values as low as 0.15. This exceptional thermal performance minimises heat loss – which translates into reduced energy bills.



Solid tiled roofs

Choose our Equinox solid tiled roof with a traditional appearance and the ability to add standard roof windows for natural daylight.

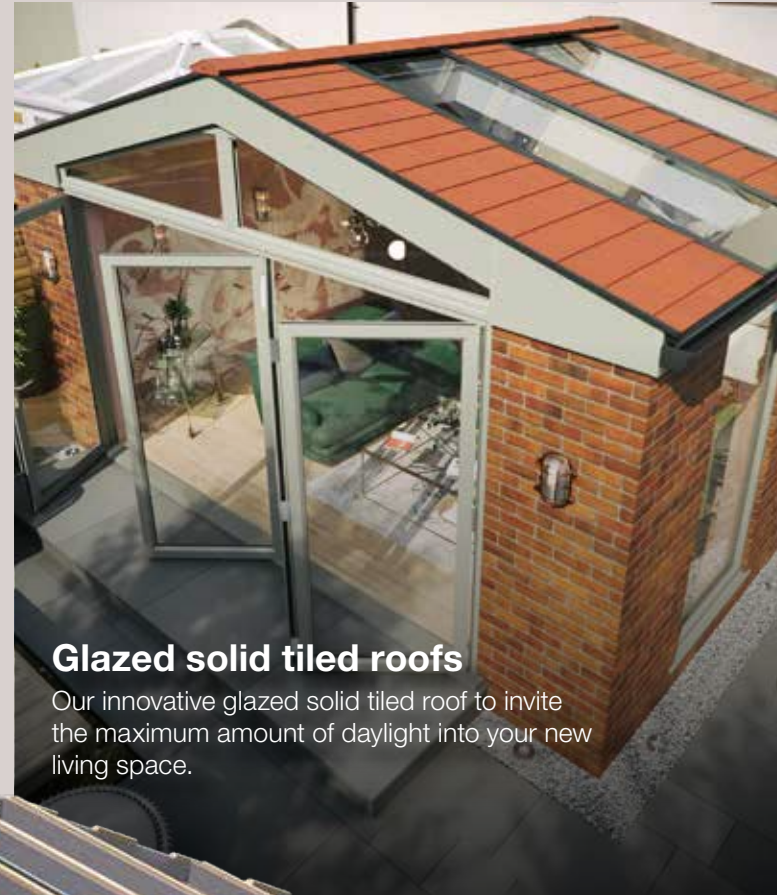

Glazed solid tiled roofs

Our innovative glazed solid tiled roof to invite the maximum amount of daylight into your new living space.



If you want to transform an existing conservatory that you already love, speak to us about our Equinox roof replacement

Enjoy your conservatory all year round with an Equinox tiled conservatory roof. With a tiled roof, you can use your conservatory whatever the weather – because it won't become too hot in summer or too cold in winter.

Thanks to the Equinox system, you can turn your extra space into an integral part of your house, while still enjoying the added light a conservatory provides. And it can be installed in as little as two days.



Lean-to roofs

A lean-to roof is a simple, fuss-free roof with a minimalist style and clean lines.



Glazed roofs

If you're looking to create an orangery style extension, our glazed roofs provide the perfect solution.

You can create a roof in a variety of styles or match up the style of the conservatory you are replacing

GABLE END

Proud and imposing.

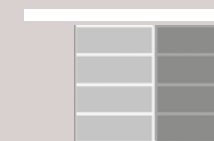

EDWARDIAN

Classic, clean-lines and maximum space.



LEAN-TO

The simple, affordable way to improve your home.



VICTORIAN

A classical, period extension to your home.

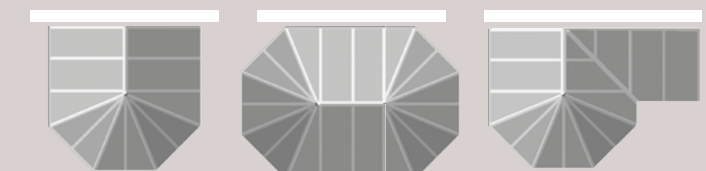

DESIGN CHOICES WINDOWS & DOORS

Refresh your outlook on your world with our range of energy efficient windows

Windows are the showcase feature of your home. They enhance the character and appearance of your property, whether it's a traditional Victorian terrace or a stylish new-build house. Windows frame your view of the world from within and define the appearance of your home from the outside.

It's essential to choose windows that complement the style of your home and your extension, provide long-life protection against the elements and improve the security and energy efficiency of your property.



There's a colour and style to suit your home

With a wide range of colour options available, matching your new extension windows with your current windows will be easily taken care of.

When it comes to window styles we've got you covered, choose from chamfered, ovolo or flush sash to match your extension windows seamlessly to your existing windows.

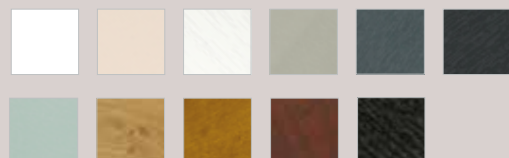

Comfortable homes with lower running costs

Our A-rated multi-chambered window design delivers exceptional energy efficiency helping to keep your home warm and comfortable all year round as well as reducing your energy consumption.

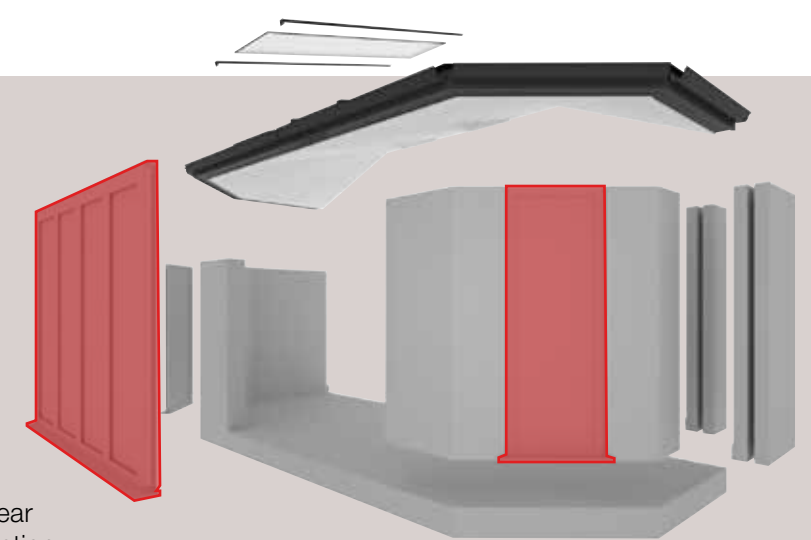

Make a whole home style statement

If your new extension is the start of a full window and door upgrade, why not be bold and go for a whole new colour to totally transform the appearance of your home – whatever style you have in mind we have a solution for you!

DESIGN CHOICES WINDOWS & DOORS

Open up the gateway to your outdoor living space with our range of lifestyle and entrance doors

Your extension doors are the gateway to your garden and the perfect addition to your home. They reflect your taste and create that all-important first impression. It's important that the doors complement the style of your property as well as being functional and secure, durable enough to withstand regular use and secure enough to protect your property against intruders.

Our versatile choice of styles and colours mean your doors will complement the existing design of your home, providing a smooth transition between indoors and outdoors. Whether you want maximum opening width, traditional French elegance or smooth, simple lines, nothing makes a better impression than a beautifully crafted, lifestyle door.

With a choice of contemporary colours and styles, you can create a look that is perfect for your home. Whether you want to match your existing décor, or make a stylish contrast, our doors offer the ultimate walkway from indoor to outdoor living.

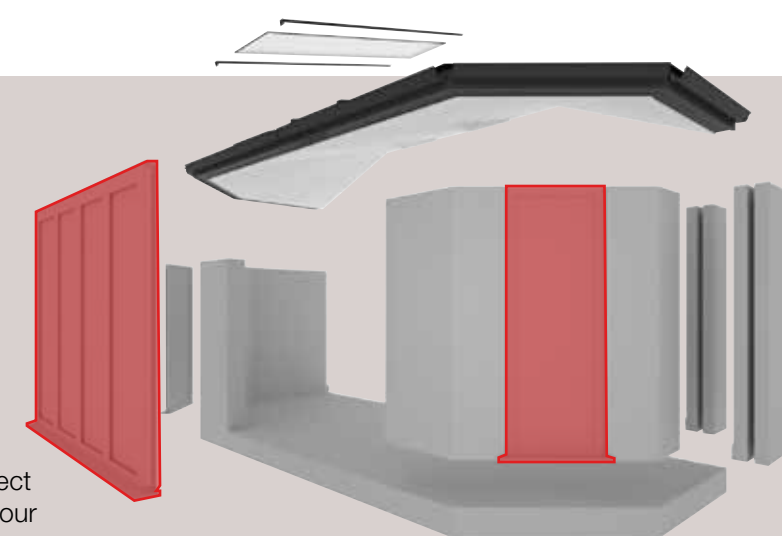

French doors

On a warm summer's day, there's nothing quite like throwing open your French doors and letting the fresh air and sunshine come flooding in. French doors are a more traditional style of door, full of charm and character and unlike timber, PVC-U gives you more options to customise your French doors to your individual taste.

French doors are ideal for a wide range of uses and can be beautifully suited to open up your extension, our doors have a classic appearance with all the benefits of contemporary PVC-U double-glazing. Like all our door options, they also bring some real benefits, including the latest security and superior energy efficiency.



Sliding patio doors

Our Patio doors open up a world of possibilities. They allow you to beautifully coordinate with the latest interior and exterior designs, while keeping your home snug, secure and full of natural light. With the largest opening sizes available, triple glazing capability, plus grey substrate and soft close options, our sliding doors are perfect for your extension.

Bi-fold doors

Completely versatile to meet all your requirements, bi-fold doors offer a range of features to add beauty and value to your home. Imagine open, wide spaces allowing air and light to flood into your home and linking your extension more with your outdoor space, instantly generating a contemporary look and feel. Made to provide maximum viewing areas, our bi-fold doors add the 'wow' factor to any extension.



DESIGN CHOICES EXTERIOR FINISHES

Blend in seamlessly or make a style statement – the choice is yours

Whatever the style of your home you can choose to create an extension that either blends in seamlessly, looking like it's always been there or add an extension with a contrasting but complementary finish, after all, this is your extension your way!

Choose your finish from our range of brick slips and cladding options

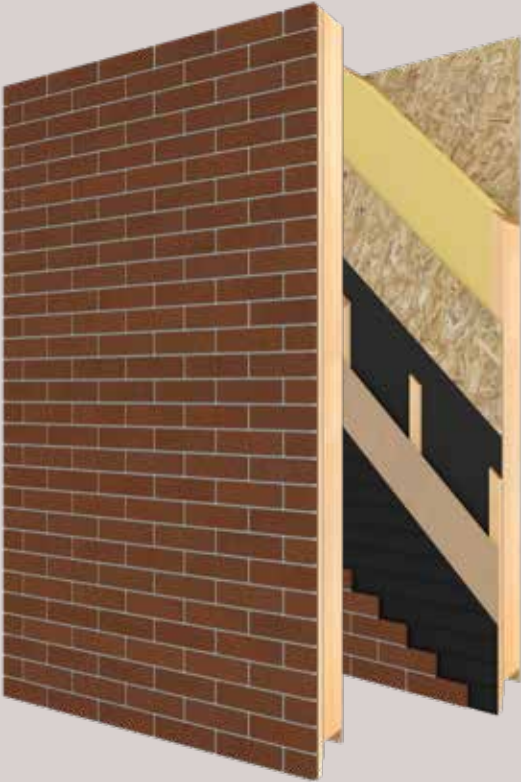

Brick slips

We have a wide range of brick slips available to ensure that we can match the brick colour and texture of your home to your new extension creating a seamless look, or pair a brick slip finish alongside a rendered house to create a beautiful complementary addition to your home.



Cladding

A range of vertical and horizontal cladding options allow you to add a modern contemporary finish to your extension.



Help is at hand to find your perfect exterior finish

Not sure what the best option is for you, don't worry, all finish options can be discussed during your survey, our expert select installers will be happy to help you find the right finish for you and your home. We even have a brick matching service to ensure your extensions complements your home.



What is a brick slip?

Brick slips are either cut from full bricks, or made in the same way as bricks, but just thinner and are fitted onto a special systems to ensure the are perfectly uniform.



DESIGN CHOICES INTERIOR FINISHES

Our extensions are finished off ready for you to decorate in the style of your choice

Internally your new extension will be finished as standard with plastered walls and ceilings, you can opt for adding electrical sockets, lighting, heating panels and low maintenance PVC-U skirting to complete the build. Simply discuss the finishing touches options with your technical advisor during your home consultation and survey.

Then it's over to you to decorate and accessorize your dream extension your way, whatever the style you prefer.



CUSTOMER HOMES ALEX & LISA



How we transformed Alex and Lisa's unusable conservatory into a fantastic room that looks and feels like part of their home

The problem

Alex and Lisa had an old conservatory they could only use during spring because it was too hot in summer and cold, damp, and mouldy in winter. They wanted an energy-efficient room to use all year round.

They chose the EurXtension system because it used their existing conservatory base to save unnecessary time and expense. They were also impressed by the level of insulation in the walls and roof and knew that would help keep their energy bills down.



The design and ordering process

Our technical advisor visited Alex and Lisa's home to conduct a site survey and design their EurXtension with them.

“ The whole process of ordering our EurXtension was really easy and smooth from start to finish, with plenty of support from trained Eurocell staff. We even received an image of what the finished extension would look like, which was amazingly accurate.

Lisa

Their only concern was whether the brick-slip panels would match the bricks on their home.

“ We needn't have worried because they look identical to the original bricks. They all line up and look like they've always been there.

Alex

The build

Once the order was placed and the building components were pre-fabricated, we set to work on the build. The old conservatory was dismantled within hours. And the PVC, plus the old dwarf wall bricks, went straight into the recycling skip with minimal mess. The extension was up and watertight within two days. And the complete build, including the interior electrics and plastering, took around 10 days.

“ The builders were great. There was minimal disruption and mess, considering we had to live there while the work was carried out.

Alex



View the time-lapse of this install to see how quickly you can add your dream extension to your home

CUSTOMER HOMES ALEX & LISA

The results

Alex and Lisa now have a beautiful new room that's noticeably warmer in winter and cooler in summer. They love throwing open the doors to enjoy barbecues in the summer and just sitting down and chilling out after a long day.

“ The end results are amazing! We now have an additional family room that's a pleasure to be in. We would recommend EurXtension to anybody considering it as an option.

Lisa



added value

Cost of EurXtension: £28,500

Home value:

Before: £270 - £280,000

After: £305 - 315,000

added warmth

Measured weekly temperature

Average Before: 2.3°

Average After: 4.7°

And the added bonus!

We asked an independent estate agent to value Alex and Lisa's home before and after the work. There was a 10% increase in its value.

We also took temperature readings across a week prior to the new extension and again post the build, and we measured the property to be twice as warm.*

*Temperatures were recorded pre and post build January 2023.

LET'S TALK ABOUT...

Your extension *the affordable way*

Looking to spread the cost of your Extension?
Here's how we can help.

Pay Upfront
If you'd prefer to pay upfront for your extension, we'll simply take a minimum 10% deposit to place your order and then you'll clear the remaining balance prior to delivery.

Pay Monthly
Choosing to pay monthly means you can place your order with a 10% deposit, then spread the remaining balance over 4-15 years in monthly instalments at 11.9% APR Representative.

- How it works**
- When you're ready to place your extension order, we'll take your deposit payment.
 - The remaining balance will be due two days prior to your extension delivery.
 - A member of our team will contact you to process your payment by credit or debit card.

- How it works**
- When you are ready to place your extension order, we'll take your deposit payment
 - A member of our team will contact you to agree your repayment plan and process your application*
 - Your first repayment will be due approximately one month following your installation

Representative Example
Here's how your Pay Monthly repayment plan could look

Finance Term	60 Months	84 Months	120 Months	180 Months
Order Total	£30,000	£30,000	£30,000	£30,000
Deposit 10%	£3,000	£3,000	£3,000	£3,000
Amount of Credit	£27,000	£27,000	£27,000	£27,000
Interest Rate	11.9% p.a. fixed	11.9% p.a. fixed	11.9% p.a. fixed	11.9% p.a. fixed
Representative APR	11.9% APR	11.9% APR	11.9% APR	11.9% APR
Number of Repayments	60	84	120	180
Monthly Repayment	£591.00	£466.48	£376.41	£311.85
Total Amount Payable	£38,460.18	£42,184.24	£48,168.84	£59,133.00

*The approval of your application depends on your financial circumstances and borrowing history

Eurocell Building Plastics, High View Road, Alfreton, Derbyshire, DE55 2DT (Company No. 03071407) FRN: 936746 are Authorised and Regulated by the Financial Conduct Authority. We are a credit broker, not a lender- credit is subject to status and affordability and is provided by Mitsubishi HC Capital UK PLC. Terms & Conditions Apply.

LET'S TALK
ABOUT...

Your extension *the sustainable way*

EurXtensions are naturally more eco-friendly than other build types

At Eurocell, we're committed to producing high-quality products that reduce our environmental impact. That's why we've been at the forefront of sustainable developments in the PVC-U industry for decades. And it's also the reason why we've worked hard to ensure our EurXtensions are built to the same high standards.

Our windows and doors are made and recycled in the UK

We recycle over 2.4 million waste windows and conservatory frames every year, which would otherwise go to landfill. We then use some of that material to make new windows and conservatories. And this process is all completed in the UK – reducing CO₂ emissions in the manufacturing process and cutting down travel miles.

EurXtensions offer excellent thermal performance

Every component of our extensions is designed to keep the heat in. In fact, they're up to five times more energy efficient than the average UK home. U-values can be as little as 0.10 W/m²K on wall panels and 0.15 W/m²K on the roof. And our windows are all A-rated as standard. For comparison, the standard demanded by current Building Regulations is a C-rating.

That means less heat escapes in winter, and the temperature is regulated in summer. So, your room will be comfortable to use all year round. Plus, you'll save money on heating bills and reduce your carbon footprint.

EurXtensions use 60% less timber than traditional build methods

We all know trees are vital to the earth's survival. So, the less wood we use to build, the better. EurXtension wall panels and high performance roofs are made from high-performance materials, so there's significantly less timber used compared to a brick-built building.

Our extensions represent a genuinely sustainable option. So, choosing to buy from us is good for your home, your pocket and the environment.



LET'S
TALK ABOUT...

Frequently asked questions *answered by the experts*

Why should I choose a EurXtension?

Because a EurXtension is your dream extension made simple! We fully manage the process for you from design to completion and you can be enjoying your new energy efficient space in weeks not months; not to mention a fixed price and a finance solution to help you spread the cost.

Will I need planning approval and building regulations?

In most cases planning approval is not required, and we'll work with Building Control surveyors to ensure the work is compliant with building regulations.

What makes a EurXtension faster to build than a traditional build extension?

EurXtensions can be built up to three times faster than using traditional building methods as the main structural elements are pre-fabricated off-site and

delivered ready to be installed directly onto the extension base. Saving time and creating much less mess and disruption to your home.

Will my EurXtension be energy efficient?

Yes, each component of the EurXtension system plays a part in delivering an energy efficient space. SIPs panels provide unrivalled insulation and airtightness; combining SIPs panels with our A-rated windows and doors, and our insulated roof solution you can be confident that your new space is working hard to save you money on your energy bills.

Will I be able to use my EurXtension all year round?

Yes, our EurXtension system allows you to create a space that is welcoming and comfortable whatever the weather!

Why should I choose a EurXtension over a warm roof solution?

Choosing to replace your existing conservatory with a EurXtension gives you an opportunity to create a tailor-made, thermally efficient space, perfect for your needs. However, if your current conservatory is already a space you love but you're looking to resolve the age old too hot in summer and too cold in winter issue, then our Equinox roof system might be what you're looking for, fully insulated, suitable to install on any existing conservatory in as little as 48 hours and the option of adding roof lights to ensure that your conservatory is still a light and bright space for you to enjoy.

Who will install my EurXtension?

Eurocell have a team of dedicated Select Installers who are experts at installing our EurXtension system.

Will a EurXtension add value to my home?

Whether you're looking to add a new extension or replace an old conservatory, a EurXtension will undoubtedly add value to your home. Adding additional rooms to a house will always increase the value of the property and with recent reports indicating that an old conservatory can de-value a home by as much as £15,000 due to their reputation of being too cold in the winter and too hot in the summer choosing to add a EurXtension to your home will add value.

Can I customise my EurXtension?

Absolutely! EurXtensions can be tailor-made to create your dream space. Match your existing home or make a style statement from our range of external finishes. Decide where you want your windows and doors and choose from our range of styles and colours. Complete your extension with your chosen roof style, tile colour and if you like, why not add roof lights for that extra flood of natural light!

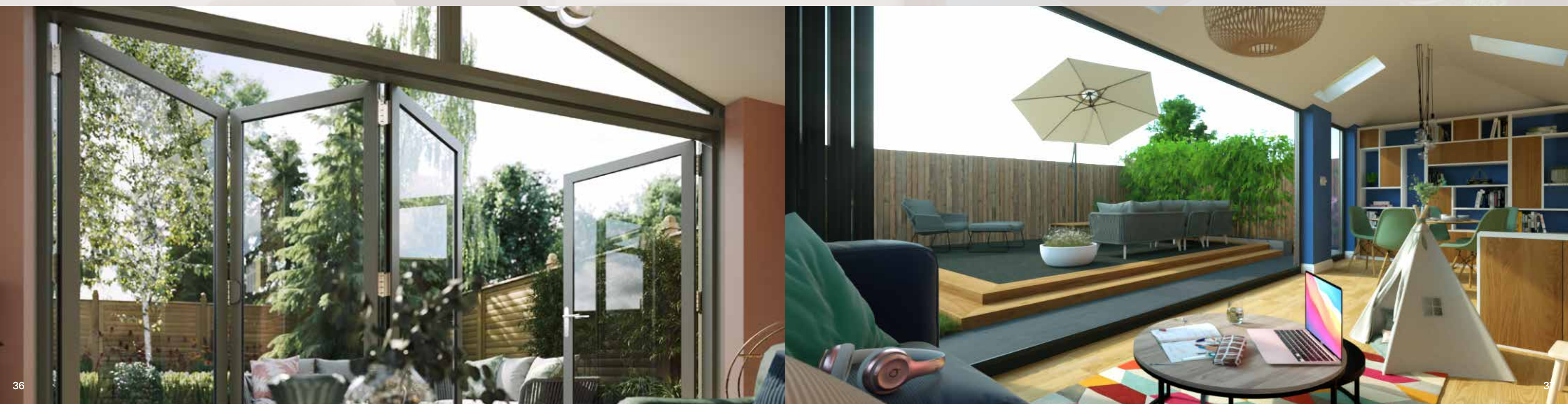

LET US
INSPIRE YOU



Let there be
The space of your dreams

Then, sit back, relax and enjoy your new space.

Call us on **0333 015 3560**, email **extensions@eurocell.co.uk**
or visit **eurocell.co.uk/extensions** and get started today!



For more information or to get a free quote:



0333 015 3560



extensions@eurocell.co.uk



eurocell.co.uk/extensions

eurocell.co.uk



**MADE & RECYCLED
IN THE UK**

eurocell