

WICONA®

By  Hydro



Engineered for fire protection
and smoke control

» WICSTYLE 65 N NG

THE NEW GENERATION OF ALUMINIUM DOORS

» The new generation of non-thermally broken doors





Safety & security

One of the primary functions of the building envelope is to protect the people and assets inside a building. Which is why the design emphasis for the WICSTYLE 65 N NG door system, a new generation of non-thermally broken doors, is placed on safety and security. Compliant with statutory regulations, the modular concept of the WICSTYLE 65 N NG means that it is also simple to upgrade the standard door with smoke or fire protection. The reinforced door can also be upgraded into a burglar resistant version up to RC 3.

Modular concept

The WICSTYLE 65 N NG is a non-thermally broken one-chamber door system with a 65 mm profile – developed as a modular system. This provides multiple solutions for a variety of applications. The system can also be combined with the WICSTYLE evo series – our thermally broken door range. The gaskets, glazing beads, connection profiles and other basic components are standardised. The doors can be fully integrated into WICTEC façade and WICLINE window systems, delivering architectural freedom and design consistency. Besides visual consistency, the range-wide modular concept (WICONA Unisys) enables fabricators to enhance profitability by streamlining inventories and manufacturing time – making use of the same processing steps, accessories, sealants and tools. The WICTOUCH handle completes the door system.

Designed for the circular economy and visual harmony

Specifically designed for use inside buildings or applications with no thermal insulation requirement, the WICSTYLE 65 N NG door can be tailor-made to any configuration. Engineered for busy buildings like hospitals, museums, airports, supermarkets, commercial or administrative buildings, it also suits those exposed to damage such as educational buildings or sport centres. Following our path to the circular economy, WICSTYLE 65 N NG is made of 75% recycled and 95% recyclable materials and components. It's an efficient way to drastically reduce the impact of materials on a building's lifecycle.



WICONA Unisys



Easy to install & fabricate



Uniform appearance



Safety & Security

» Safety & security

The focus in the design of the WICSTYLE 65 N NG door system is placed on safety and security.



- Emergency exit



- Fire protection
- Smoke control
- Burglar resistance

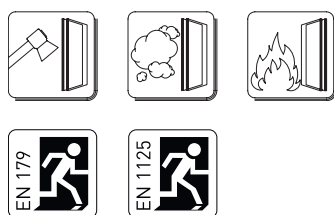

The WICSTYLE 65 N NG door range offers tailor-made configurations in the field of security and safety technology, for every construction situation and every level of aspiration.

Public buildings, healthcare facilities, and schools must be designed to keep the people and its assets safe - every day. Compliant with statutory regulations, the modular concept of WICSTYLE 65 N NG means that it is simple to upgrade the standard door with smoke or fire protection. The reinforced door can also be upgraded into a burglar resistant version up to RC 3.

For design continuity, all WICSTYLE 65 N NG applications are visually compatible with the standard system.

Depending on the configuration, the WICSTYLE 65 N NG doors meet the requirements of:

- Burglar protection classes RC 1N, RC 2N, RC 2, RC 3 according to EN 1627
- Fire protection EW 30 according to EN 13501
- Smoke classification Sa/S200 according to EN 13501 and to DIN 18095-RS-1 and RS-2
- Emergency exit according to EN 179 and EN 1125
- For schools and nurseries, a finger protection solution is available
- Sound insulation up to 44 dB



» Modular concept

Applications

The WICSTYLE 65 N NG is a non-thermally broken one-chamber door system with a 65 mm profile – developed as a modular system. Besides its focus on safety and security, the WICSTYLE 65 N NG provides multiple solutions for a variety of applications.

Depending on the use, location, operation and performance needs, the WICSTYLE 65 N NG standard door can be upgraded to meet project-specific applications. Door system options include:

Single-action doors



- Circumferential leaf or bottom rail



- Reinforced doors for high traffic areas



- Finger protection



- Doors integrated in windows and façades



- Doors with fanlight and sidelight



- Simultaneous doors

Double-action doors



- Push-pull doors



- Double-action doors / double-action doors with finger protection

Automatic doors



- Non-thermally insulated automatic sliding doors

WICONA Unisys – the secret to success

WICONA aluminium door systems are synonymous with quality, design freedom, process reliability and simplicity of fabrication. Whatever the requirements may be, WICSTYLE profiles coupled with your own specialist expertise ensure a project-specific solution. What's more, our products are always simple to install.

The reason: The WICONA Unisys principle, which takes a platform approach to the design of all WICONA systems.

The result: A modular range. Standardised individual parts that can be used across all WICONA façade, window and door series. This simplifies specification and detailing, minimising time, components and cost, and means WICONA constructions are safer and quicker to install.



WICSTYLE 75 evo



WICSTYLE 65 evo



WICSTYLE 65 N NG

The WICSTYLE 65 N NG non-thermally broken door system is based on our WICONA Unisys principle to ensure a unified door design within the building, irrespective of additional functions.

» Design and appearance

For design flexibility, a wide range of profiles is available for the WICSTYLE 65 N NG door system. In fact, the external view of the frame profiles can range from 48 mm up to 225 mm.

A profile height of up to 2.7 metres is achievable, with a reinforced option up to 3 metres now offered.

Outer sight line frames:

- Combination frame profiles: from 48 mm up to 225 mm
- Special frame profiles: from 48 mm up to 98 mm
- Neutral frame profiles: from 30 mm up to 240 mm

The profiles are extruded from Hydro CIRCAL 75R – prime quality aluminium made with a minimum of 75% recycled end-of-life aluminium (post-consumer scrap).

Hydro CIRCAL has a carbon footprint among the lowest in the world: 2.3 kg CO₂ per kilo of aluminium.



- Inward opening with bottom rail profile



- Inward opening with circumferential leaf

This new generation of non-thermally broken door is designed as a symmetrical concept:

- The same frame profile can be used for inward and outward opening.
- The door can be built with circumferential (all-around) leaf or bottom rail profiles.
- The meeting stiles of double leaf doors are optionally available with or without supplementary profiles.



- Reinforced door inward opening with circumferential leaf

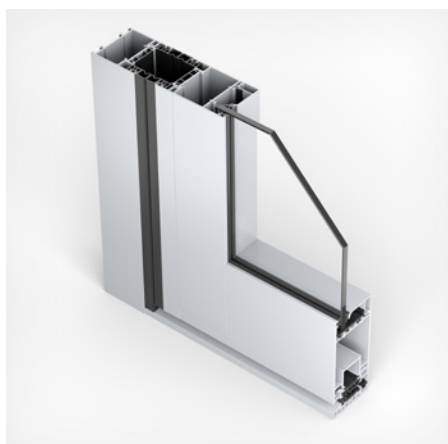

- Inward opening with finger protection

The WICSTYLE 65 N NG also exists in a three-chamber system with reinforced walls (total construction depth 67 mm profile). The wall thickness of the frame and sash profile are reinforced by 1 mm on the outside compared to the standard series.



▪ Screwed hinge



▪ Butt hinge



▪ Concealed hinge

WICTOUCH handle

To complete the uniform appearance of a building, the WICTOUCH door handles offer a comprehensive and minimalistic design to cover all needs. A regular or fixed door handle can be complemented with matching escutcheons for profile and round locking cylinders, which are available in two thicknesses: 3 and 6 mm. Produced in solid, extruded Hydro CIRCAL 75R low carbon aluminium, the handles provide a great combination of aesthetics, functionality and sustainability for your doors.



Surfaces and colours

Whether anodised or powder-coated – almost all optical requirements can be met thanks to the exclusive shades of WICONA's extensive colour range. Exclusive shades and coatings with high scratch resistance and heat reflecting properties are available for all WICONA system solutions. Additionally, the fittings come in a choice of surfaces – either anodised, lacquered or high-quality stainless steel. The WICTOUCH handles are also optionally available* with an antibacterial and antiviral coating – for anodised as well as for powder-coated finishes. The coatings provide a solution for active protection where it is needed the most. Schools, hospitals, industry and leisure facilities, and all other public places where safety is priority number one.

* Special prices, delivery times and minimum order quantities adhere.



Optimising ease of use and access

The WICSTYLE range offers hardware with many variants and extensions to meet additional requirements. For example the locks are available in different options: with hook bolts or hook bolts with dual round bolts for an optimised security or with automatic deadlocking latches.

The WICSTYLE 65 N NG also offers accessible solutions and can be enhanced with access control and drive systems.



▪ Hook bolt



▪ Hook bolt with dual round bolts



▪ Automatic deadlocking latches

Locks

- 1-point, 2-point and multi-point locks
- With and without self-locking
- With or without E-opener
- Motorised solutions
- Solutions for smoke, fire and burglary resistance
- Panic / escape door according to EN 179 / EN 1125 function E and function B



Gaskets

It is a multiple sealing gasket concept:

- Stop gaskets with pre-formed corner pieces
- Glazing gasket circumferential, without mitre cut
- Threshold stop gasket with pre-formed corners for efficient installation
- User-friendly threshold gasket completely covering the threshold

Thresholds

For thresholds, different options are available:

- Barrier-free threshold with non-thermally separated threshold profile (14 mm high) and centre seal stopper
- Barrier-free with threshold profile with no thermal separation (6 mm high) and sliding threshold seal
- Barrier-free with crescent threshold profile with no thermal separation (4 mm high) and lowering gasket

Covers

The special aesthetical covers, for all rebate areas, provide the finishing touch to the perfect door design:

- The result: A complete, surrounding flush surface in the rebate area
- All fitting parts are flush integrated

Opening limiter

- Fully concealed mechanical opening limiter
- Max. opening angle about 130°
- Opening angle with accessories individually adjustable
- 100 % barrier free
- Suitable for doors opening inwards and outwards



» Technology in detail

Anodised, powder-coated and stainless steel finishes available as well as concealed hinges

Stainless steel faceplate aspect over the total height of the door

Special aesthetical covers

Antibacterial and antiviral coatings optionally available

Fitting parts are flush integrated

Faceplate of the lock aligned with the corner piece to give a nice aesthetical view

» WICSTYLE 65 N NG Hinged door

The WICSTYLE 65 N NG series is a non-thermal broken series with a 65 mm profile based on the successful concept of the WICSTYLE evo doors. All configurations of the WICSTYLE 65 N NG aluminium door range can be combined with other WICONA ranges. They can be fully integrated into WICTEC façade systems and WICLINE window systems.

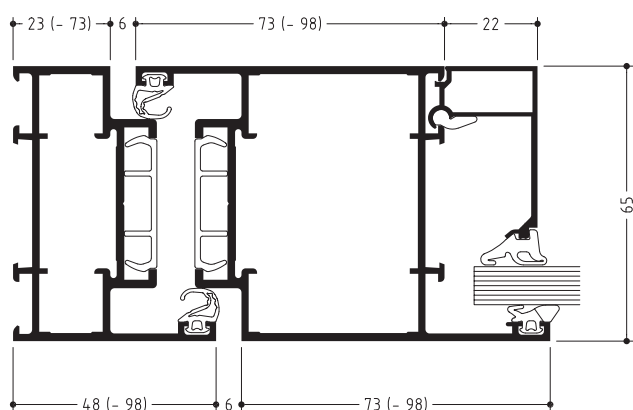

WICSTYLE 65 N NG Hinged door with special frame profile

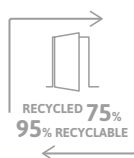

Test results for product standard EN 14351-1

Air permeability:	Up to class 4
Water tightness:	Up to 7A
Resistance to wind load:	Class C2
Acoustic performance:	$R_{w, (C; C_{tr})}$ until 44 (-2; -6) dB
Operating forces:	Class 2
Load bearing capacity of safety devices:	Fulfilled
Mechanical strength:	Class 3
Repeated opening / closing:	Up to class 7 (500,000 cycles)
Impact resistance:	Class 1



Integration in windows and façades



Technical performance:

Profile technology:

- For single and double leaf hinged doors
- For inward and outward opening
- For glass or panels with infill thickness from 3 mm to 50 mm
- Various threshold profiles with or without thermal break, also barrier free
- Fanlights, lateral glazings fixed or opening

Outer sight lines frames:

- Combination frame profiles from 48 mm up to 225 mm
- Door frame profiles: from 48 mm up to 98 mm
- Neutral frame profiles from 30 mm up to 240 mm

Hardware:

- Aluminium and stainless steel butt hinge
- Screwed hinge
- Concealed hinge
- Leaf sizes (w x h):
1400 mm x 2700 mm for internal applications
1400 mm x 2520 mm for external applications
- Max. leaf weight: until 200 kg

Additional designs:

- Double action doors
- Integration frame for stick façades
- Smoke control doors S_a/S_{200}
- Fire protection doors EW 30

Sustainable performance:

- Extruded aluminium profiles in Hydro CIRCAL 75R
- Made of 75% recycled and 95% recyclable materials and components
- Currently in certification for Cradle to Cradle Certified

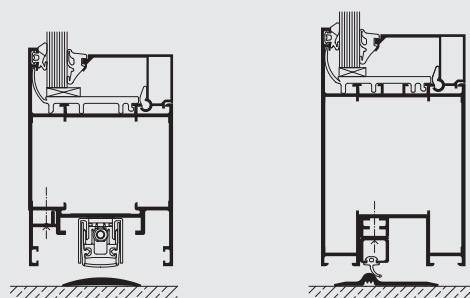

» WICSTYLE 65 N NG FP Fire protection doors

The WICSTYLE 65 N NG FP fire protection door complies the classification EW 30 according to EN 13501. The profiles are identical with those for the WICONA standard door series.

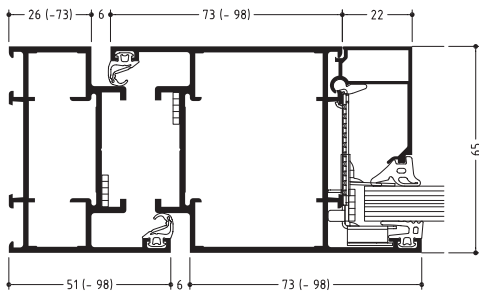

WICSTYLE 65 N NG FP Fire protection door EW 30

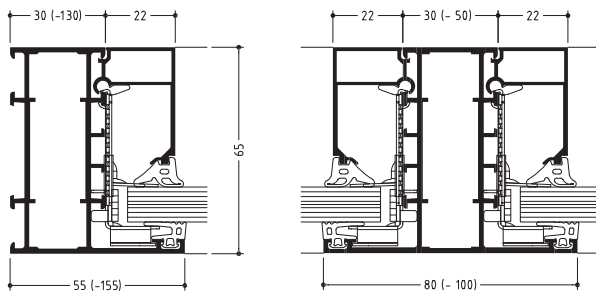

WICSTYLE 65 N NG FP Fire protection partition wall EW 30

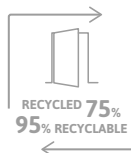

Unit combinations as T-component



Technical performance:

Profile technology:

- The profiles are identical with those for the standard door series
- Execution in fire protection class EW 30 with the simple addition of accessories
- For single and double leaf hinged doors
- For inward and outward opening
- Fixed side lights and fanlights
- Test glass types: PYRODUR 30-201 and CONTRAFLAM lite 30

Outer sight lines frames:

- Combination frame profiles from 55 mm up to 155 mm
- Door frame profiles: from 51 mm up to 98 mm

Hardware:

- Aluminium and stainless steel butt hinge
- Screwed hinge
- Leaf sizes (w x h): 1400 mm x 2500 mm
- Max. leaf weight: until 180 kg
- Max. height fire protection wall 3000 mm, no length limit

Additional designs:

- In combination with smoke protection up to 1400 mm x 2500 mm

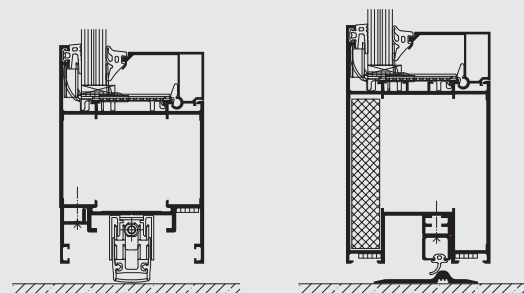

» WICSTYLE 65 N NG Smoke control doors

The WICSTYLE 65 N NG smoke control door complies the classification S_a/S_{200} according to EN 13501 and to DIN 18095-RS-1 and RS-2. The profile sections are identical with those for the WICONA standard door series.

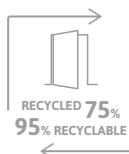
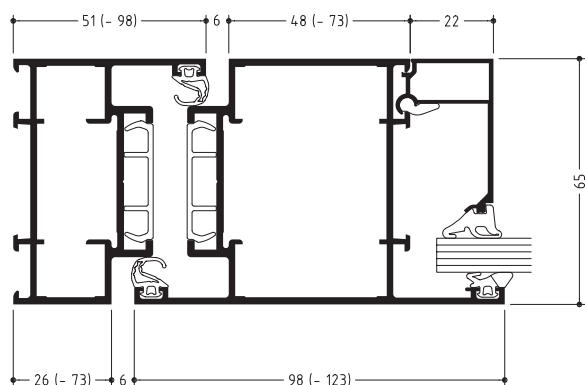

Test results for product standard EN 14351-1

Air permeability:	Up to class 2
Water tightness:	Up to 7A
Resistance to wind load:	Class C2
Acoustic performance:	R_w (C; C_{tr}) until 44 (-2; -6) dB
Operating forces:	Class 2
Load bearing capacity of safety devices:	Fulfilled
Mechanical strength:	Class 3
Impact resistance:	Class 1



Integration in windows and façades



Technical performance:

Profile technology:

- For single and double leaf hinged doors
- For inward and outward opening
- For glass or panels with infill thickness from 6 mm to 42 mm
- Various threshold profiles, also barrier free
- Fanlights, lateral glazings fixed

Outer sight lines frames:

- Combination frame profiles from 55 mm up to 225 mm
- Door frame profiles: from 51 mm up to 98 mm

Hardware:

- Aluminium and stainless steel butt hinge
- Screwed hinge
- Leaf sizes (w x h):
 - 1400 mm x 2700 mm (EN 13501)
 - 1400 mm x 3000 mm (DIN 18095-RS-1 and RS-2)
- Max. leaf weight: until 200 kg

Additional designs:

- Integration frame for stick façades
- Fire protection doors EW 30 up to 1400 mm x 2500 mm

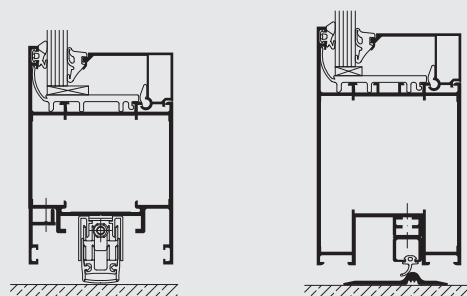

» WICSTYLE

Door systems

Emergency exit

In panic situations the safety and evacuation of people in the building are the main concern. In Europe uniform standards for emergency exit door fittings are applicable. Within the meaning of these standards, emergency exit door systems are subdivided in emergency exit devices according to EN 179, and panic door exit devices according to EN 1125. Emergency exits acc. to EN 179 are designated to buildings to which the general public does not have access and whose visitors understand the function of the emergency doors.

Panic door exit devices acc. to EN 1125 are used in public buildings where the visitors are not familiar with the function of emergency doors, like schools, hospitals, shopping malls. WICSTYLE door systems offer a comprehensive range of applications, which can also be combined with other functions and design options.



Technical performance:

Profile technology:

- Doors in accordance with EN 179 (emergency exit devices) or with EN 1125 (panic exit devices)
- Many system options for the emergency application, allowing for a unified door design within the building, irrespective of additional functions
- Single or double leaf possible
- Combination with burglar resistance in classes RC1, RC2 and RC3 possible
- Execution in combination with fire protection in classes EI30/T30 and EI60/T60 and in combination with smoke control possible (national regulations must be respected)



WICSTYLE systems for exit doors according to EN 179 (emergency exit device) and according to EN 1125 (panic exit device)

WICSTYLE 65 evo hinged door

WICSTYLE 75 evo hinged door

WICSTYLE evo finger protection door

WICSTYLE 65 N NG non-insulated

WICSTYLE 77 FP fire protection door

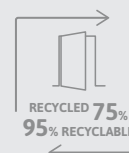

» WICSTYLE

Door systems

Burglar resistance

The various levels of resistance classes can be achieved with all WICSTYLE door series without visual alterations of the constructions, with only a minimum of additional measures on the basis of the standard design.

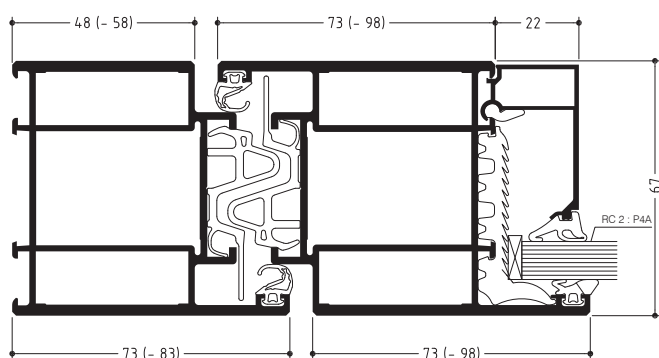

WICSTYLE 65 N NG Reinforced door in class RC2

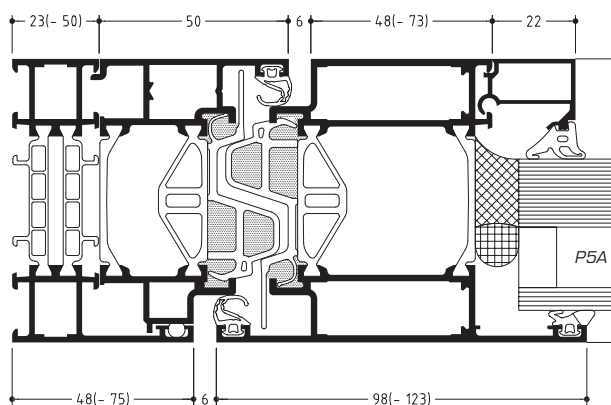

WICSTYLE 75 evo in class RC3

System test results / CE product pass in accordance with EN 14351-1:2006+A2:2016

See classification of the respective WICSTYLE door series



Technical performance:

Burglar resistance according to DIN EN 1627:

- Depending on the built-in elements, WICSTYLE doors meet requirements of burglar protection classes RC 1N, RC 2N, RC 2, RC 3 according to EN 1627 with or without panic function. Double leaf full panic doors have also been successfully tested up to RC 3
- For the burglar protection special polyamide profiles were expanded, which prevent objects such as, for example, crowbars being levered into the door, thus acting as a deterrent to burglars.
- Multipoint locks and suitable burglar-resistant glazing complete the security features.

Burglar resistance according to DIN EN 1627 classifications:

WICSTYLE 65 evo / 75 evo Hinged doors	RC1N, RC2N, RC2, RC3
WICSTYLE 65 N NG reinforced door	RC1N, RC2N, RC2, RC3

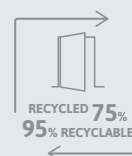

» Are you ready to benefit from the new generation?

Download the entire technical documentation or dedicated tender text to start the planning of your project using WICSTYLE 65 N NG

WICTIP

The technical information platform WICTIP gives you quick and easy access to the entire WICONA product documentation, which is necessary for planning right through to processing the WICONA system solutions. Product ranges, workshop manuals, hardware installation plans, test certificates, planning information, documents on CE marking, sectional CAD drawings and many more information have been perfectly prepared in WICTIP.

In addition to the technical documentation, WICTIP offers helpful tools for calculating technical data, e.g. for calculating static values or U_w values. The comprehensive library of tender texts with technical specifications on WICONA systems and extensive text modules, including fittings, surfaces, types of glazing provides architects, in particular, with a valuable source of support in their day-to-day work.

WICTIP offers access to the WICONA 3D BIM objects, depending on the objects in Revit and/or in Archicad format, and thus supports architects, planners and fabricators with the new BIM planning methods.

www.wictip.com

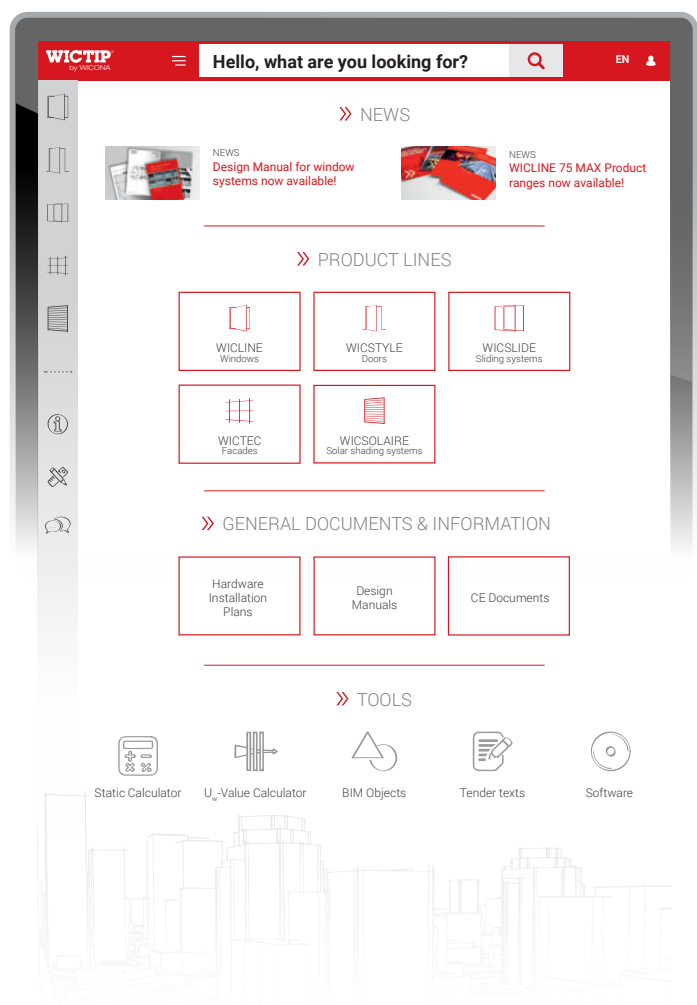

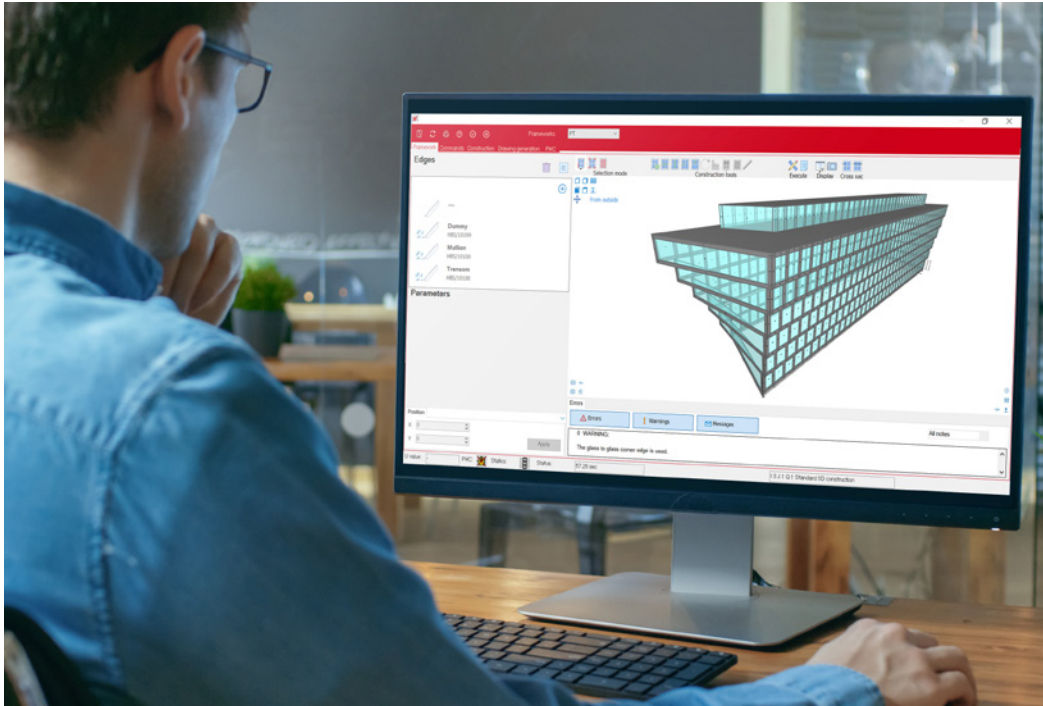

WICTOP

Developed in collaboration with our partners the three-dimensional design software combines all essential features, that provides maximum support in all processes. Ranging from planning and calculation to ordering and activation of inventory management systems right through to the production of WICONA designs – everything in one software.

WICTOP checks all technical requirements during the creation of 3D models and calculations, providing required U values, whose method of calculation is validated by ift Rosenheim. Additionally, you can measure the carbon footprint of the product and print the corresponding environmental declaration sheets (EPD).

The software enables to create and edit building designs both from WICONA systems and from other products, systems or software publishers. Guaranteed up-to-date data on a regular basis helps the user to create technically accurate designs.

www.wictip.com/en/software

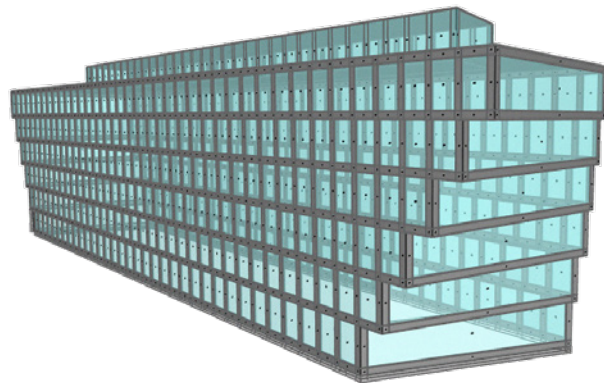

Download the latest version of WICTOP to calculate e.g. the EPD for your project using WICSTYLE 65 N NG

» Sustainability 2025: BUILD BEYOND TOMORROW



From 2018 to 2021, the Hydro aluminium building system brands have reduced their carbon emissions by 25% and are working towards an overall target of 50% by 2025.



POSITIVE PROGRESS

As an industry leader and part of the Hydro group, WICONA's sustainability strategy, BUILD BEYOND TOMORROW, focuses on **cutting carbon emissions by half by 2025**, striving towards **100% circularity** and **empowering 10,000 people with education and**

skills in the same year, in line with the UN Sustainability Goals. We go beyond world-class low-carbon aluminium and recycled materials, to run every part of our business as sustainably as possible.

Our holistic strategy is based on three pillars:

Products: We go beyond materials to reduce the carbon emission in the use phase.

Company: We go beyond products to reduce the upfront and embodied emissions.

Society: We go beyond our company to see the bigger picture.

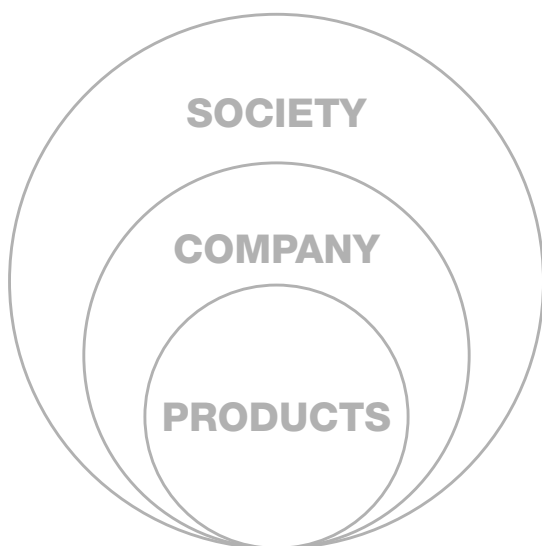

PRODUCTS

- Responsible and recycled material
- Circular and high performance products
- Transport and packaging
- Transparency and traceability

COMPANY

- Production and site emissions
- Water and waste reduction
- Responsible workplaces
- Employee engagement, inclusion and diversity

SOCIETY

- Market
- Value chain
- Human rights
- Local communities

BEYOND MATERIALS

The most efficient way to reduce the operational emissions of buildings is to offer high performance products to optimize energy consumption once the building enters the use-phase. Produced using at least 75% recycled and 95% recyclable content, our high-performance products are easily reusable, dismantlable and recyclable.

By using responsibly sourced and recycled material, such as our low-carbon aluminium Hydro CIRCAL and our recycled polyamide, we aim to reduce the carbon footprint of our aluminium by 50% and that of our accessories by 35% by 2025. Fulfilling the idea of sustainability, we go beyond materials. By optimising transport and packaging of our circular products, we aim to halve the carbon footprint of transport and packaging by 2025. To ensure maximum transparency, we provide EPDs for all our products and projects.



About 75% of all aluminium ever produced is still in use today.

The Process

The production process is fully traceable, and the product is certified by an independent third party (DNV-GL). The certified production is nothing short of a revolution in the building industry.

Hydro CIRCAL

Hydro CIRCAL 75R contains a minimum of 75% post-consumer scrap. When guaranteeing more than 75% recycled content, Hydro exclusively refers to aluminium that has reached its end-of-life as a product in use and is brought back into the loop.

100 % Opportunities. 5 % Energy.

Aluminium is infinitely recyclable. Its quality and material properties are never lost. Furthermore, melting down end-of-life aluminium uses just 5 % of the energy required for primary aluminium production. So the higher recycled content of post-consumer scrap, the better it is for our cities and the environment.

Minimum CO2 footprint

Hydro CIRCAL has a carbon footprint among the lowest in the world: 2.3 kg CO2 per kilo of aluminium, 73% less than the European average).

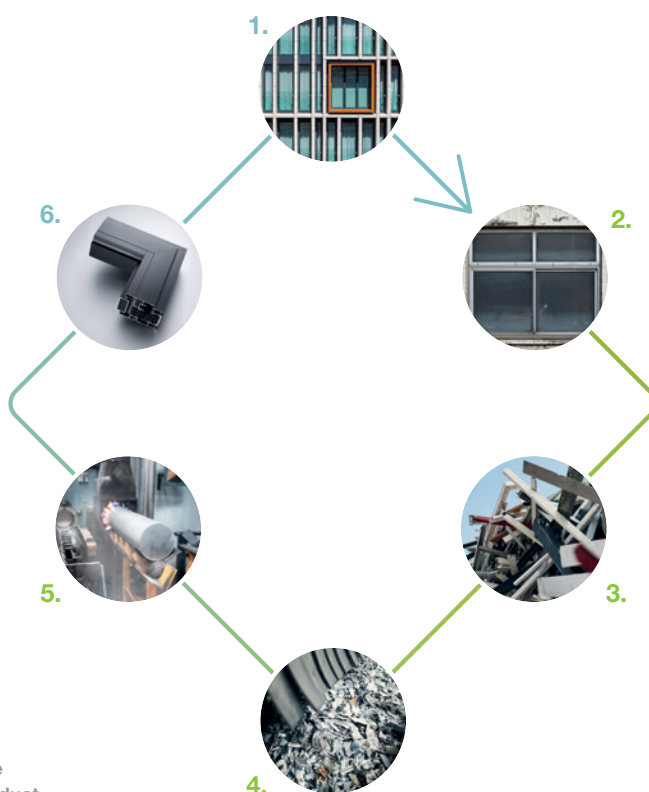

1. Product in use
2. End of life product
3. Scrap sorting and pre-processing
4. Scrap processing and recycling
5. HYDRO CIRCAL 75R billets
6. Product Manufacture

All of our key products contain at least 75% recycled and 95% recyclable content – reducing the impact of materials on a building's lifecycle.

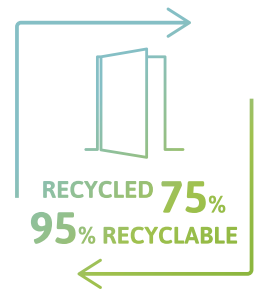

100% RECYCLED POLYAMIDE

Sustainability doesn't stop at the kind of aluminium we use, WICONA is one of the first system supplier to use thermal insulation strips made from recycled polyamide for the thermal insulation of its systems. Available as standard right away, no extra cost, with outstanding mechanical and physical properties and an excellent environmental performance.



CRADLE TO CRADLE CERTIFIED®

Cradle to Cradle Certified® is the global standard for products that are safe, circular and responsibly made. In 2017, WICONA systems were Cradle to Cradle Certified® at the Bronze level. Since then 14 system solutions have achieved C2C Certified Silver and 5 other systems, C2C Certified Bronze. WICONA is working continually to improve production standards to the next level.



ALUMINIUM STEWARD INITIATIVE (ASI)

ASI is the most internationally recognised standard to address environmental, social and governance (ESG) across the entire aluminium value chain. From bauxite mining to the production of semi-fabricated products, including the recycling of pre- and post-consumer scrap, the ASI assessment is based around sustainable aluminium production. Hydro was one of the first companies to achieve ASI certification and also the entire WICONA aluminium value chain is ASI certified.



EPD

Environmental Product Declaration (EPD) certificates are available for a WICONA system or design using our WICTOP software. Useful for many different applications, including public procurement and green building rating schemes, like BREEAM, LEED and DGNB, EPDs allow architects and other stakeholders to compare life-cycle environmental impacts of products (windows), materials (an aluminium billet), assembly parts and even services (like maintenance).

CERTIFICATIONS FOR SUSTAINABLE BUILDINGS

WICONA offers certifications of materials, products and manufacturing processes, which are helpful to certify the sustainability of buildings, with seals such as **LEED**, **BREEAM**, **DGNB**, **WELL**.





Pictures: © MEDIASHOTS

BEYOND PRODUCTS

By approaching sustainability holistically, we go beyond products to reduce the upfront and embodied emissions of the building's carbon footprint. By improving our operations, we aim to reduce our footprint by cutting CO2 emissions of our sites by 15% while reducing water consumption and waste.

We cannot improve our impact as a company if we do not create safe and responsible workplaces. By rethinking our commuting and business trips and by improving every detail in our workplace, from artificial light usage, to printing, recycling bins, or single-use plastics, we aim to reduce the carbon footprint of our activities and how we run our business by 50%.

We also take responsibility within our company by creating an engaging, inclusive and diverse working environment for our employees, who also pursue a responsible mindset in their activities.

BEYOND OUR COMPANY

We go beyond our company by contributing to create a fair society and a circular market together with our customers, suppliers and non-governmental organisations.

We take responsibility to have a positive influence on the market. By collecting post- and pre-consumer scrap from our customers, we are able to deliver recycled low-carbon aluminium with one of the lowest carbon footprints worldwide. Furthermore, in our value chain, we work together with suppliers, who share the same values, such as high standards for working conditions and the use of materials without hazardous components.

Focusing on society, WICONA is committed to empower 10,000 people with education and skills by 2025, as a positive impact on our community is crucial when it comes to being truly sustainable. To support the development of local communities we're sponsoring programs, leading presentations and courses at schools and supporting the construction of educational buildings. That's why WICONA has decided to cooperate with the Non-Governmental Organisations like UNICEF and WEbuilding. Our joint project with WEbuilding, an international group of



Pictures: © WEbuilding

architects, in Haiti is the construction of a school for the children in the Grand'Anse region, which is prone to natural disasters. WICONA's contribution will help to build an entire classroom for 30 children.

Together with the building system brands of Hydro we aim to cut by 50% our carbon emissions by 2025

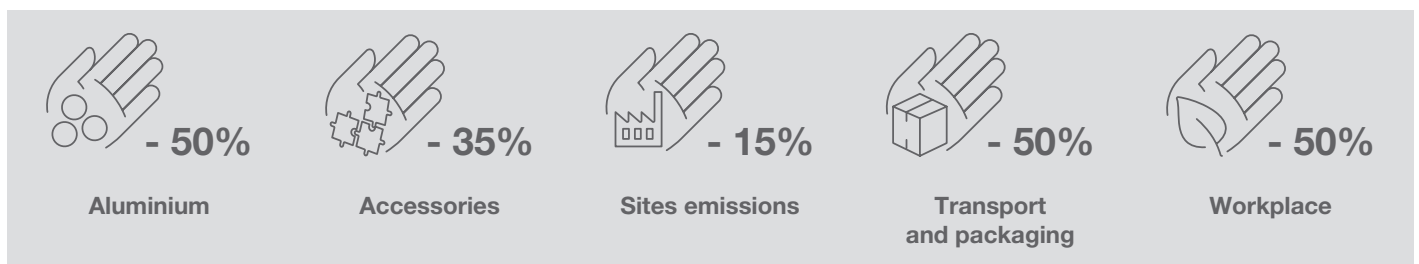



Pictures: © Yakobchuk Olena - stock.adobe.com

GOING FORWARD

Recyclability and dismantlability are key when it comes to further reducing product-related carbon emissions. We will continue to:

- Develop circular products by using recycled and recyclable materials
- Develop products that can be easily disassembled and sorted
- Embrace the challenges of the circular economy by reusing materials for the same purpose as in their first lifecycle
- Ensure our systems are produced within a responsible supply chain and certified by external organisations for maximum transparency

All of our key products will contain at least 80% recycled and 100% recyclable content by 2030.

» YOUR PARTNER FROM THE START

The WICONA support team has many years' experience, and will support you through your project – with planning, technical drafts, calculations and drawings.

At WICONA, we know the importance of local contacts and fast, efficient support in project planning and implementation. We also know that a global reference and knowledge base is invaluable in all phases of the construction process. WICONA combines both of these strengths.

With our local presence, we make sure you always get the support you need for efficient, optimum planning. We will work together to design the perfect solution for your specific project, with regular meetings and a close dialogue.

We offer you a strong reference portfolio of global WICONA projects realised worldwide. With our know-how and support, you can rely on us throughout the whole process, whatever the nature of your project.

Beyond the richness of its catalogue, WICONA has developed a renowned know-how and established a team for special projects situated in Germany and Poland. More than 30 engineers are working on special projects with bespoke designs for large international architectural projects. This guarantees the quality and homogeneity of the WICONA range, gathering, adapting and approving all the products in accordance with the technical requirements and test certificates.

For each design, its experts control the process from start to finish, ensuring that all performance commitments are met.



Photo : © Gilles ARROYO



Photos : © Conné van d'Grachten

Test Centre Bellenberg

The Test Centre in Bellenberg in Germany was founded in 2009 and is one of the most modern Test Centres in Europe. In two areas of 100 square metres each, you have the possibility to test your windows, doors and façades according to a wide range of test specifications.

Individual tests are required for special designs, project solutions and generally for requirements that deviate from the system tests according to the product standards within the scope of CE marking. If the façades pass all tests, they receive the CE certificate, which confirms that the façade complies with the European guidelines and may be sold throughout Europe. The test facilities are coordinated with the renowned institute ift Rosenheim. On this basis, individual test programs according to customer specifications are possible, as well as tests by ift Rosenheim as an accredited/notified testing institute.

As a competent partner with extensive experience in testing of system products and project solutions, we can support you with our knowledge and expertise. The WICONA Technology Centre with its workshop is directly located next to the Test Centre, so that any necessary measures can be implemented immediately on site. Our modular test rigs for curtain walls, windows and fittings are flexible and can be adapted up to maximum sizes of 10 x 10 metres. On these test rigs we can execute various tests, such as air permeability, tightness, wind resistance and much more. In addition, we can offer a compression/tension tester and a hot box.

Overall, we are able to deliver quickly and on time as our "inhouse" test rig enables to carry out tests throughout the year, irrespective of the weather, ensuring that we reliably meet deadlines.

Austria

5201 Seekirchen
☎ +43 6212 2000
✉ info@wicona.at

Benelux

3400 Landen
☎ +32 11 690316
✉ info.hbs.be@hydro.com
✉ info.hbs.nl@hydro.com
✉ info.hbs.lu@hydro.com

Croatia

10010 Zagreb
☎ +385 01 2048 217
✉ info@wicona.de

Czech Republic

619 00 Brno
☎ +420 602 745 407
✉ info@wicona.cz

Denmark

8240 Risskov
☎ +45 7020 2048
✉ wicona.dk@hydro.com

Estonia / Latvia

75312 Rae vald Harjumaa
☎ +372 657 66 35
✉ info@wicona.ee

France

02200 Courmelles
☎ +33 3 23598200
✉ wicona.fr@wicona.com

Germany

89077 Ulm
☎ +49 731 3984-0
✉ info@wicona.de

Hungary

1031 Budapest
☎ +36 (1) 4533457
✉ info@wicona.hu

Ireland

Dublin D22 X286
☎ +353 1 4105766
✉ info.hbs.ie@hydro.com

Italy

20063 Cernusco sul Naviglio MI
☎ +39 02 924291
✉ info@wicona.it

Kosovo-Albania

Prishtina 10000, Kosovo
☎ +38 349 28 02 22
✉ info@wicona.de

Lithuania / Latvia

02244 Vilnius
☎ +370 5 2102587
✉ baltics.lt@wicona

Norway

2007 Kjeller
☎ +47 22 42 22 00
✉ wicona.no@hydro.com

Poland

92-620 Łódź
☎ +48 42 683 63 73
✉ wicona.pl@hydro.com

Romania

032332 Bucharest
☎ +40 724 743 070
✉ info@wicona.de

Serbia

11070 Beograd
☎ +381 11 312 18 35
✉ info@wicona.de

Slovakia

82105 Bratislava
☎ +421 918 725 098
✉ info@wicona.sk

Slovenia

2201 Zg. Kungota
☎ +386 2 620 99 70
✉ info@wicona.de

Spain

08195 Sant Cugat del Vallès
Barcelona
☎ +34 93 573 77 76
✉ wicona.es@hydro.com

Sweden

574 81 Vetlanda
☎ +46 470 78 74 00
✉ wicona.se@hydro.com

Switzerland

5506 Mägenwil
☎ +41 62 887 41 41
✉ info@wicona.ch

Turkey

34149 Istanbul IDTM A1/16
☎ +90 212 4657650
✉ info@wicona.tr

United Kingdom

Tewkesbury, GL20 8SF
☎ +44 1684 853500
✉ info.uk@wicona.com

China

Beijing 100005, P.R.C
☎ +86 10 6059 5686 ext. 805
✉ contact.wicona.international@hydro.com

Singapore

608831 Singapore
☎ +65 6513 2126
✉ contact.wicona.international@hydro.com

United Arab Emirates

Dubai
☎ +971 4 887 00 96
✉ contact.wicona.international@hydro.com

United States of America

☎ +1 (516) 519-4635
✉ info.na@wicona.com

Other countries

31037 Toulouse
☎ +33 5 61312626
✉ contact.wicona.international@hydro.com